

Replacement Parts Diagram

Model - HBH650-CE (Series A-E)

PROPRIETARY RIGHTS NOTICE This document and all information contained within it is the property of Hamilton Beach Brands, Inc. (HBB). It is confidential and proprietary and has been provided to you for a limited purpose. It must be returned or destroyed upon request. Disclosure, reproduction or use of this document and any information contained within it, in full or in part, for any purpose is forbidden without the prior written consent of HBB. No photographs may be taken of any article fabricated or assembled from this document without the prior written consent of HBB.

+7(812)987-08-81

Quiet Shield QS850 Lower Housing 990071500 Container (only) 990075400 Container, Complete 6126-650 Lid with Filler Cap 990029800

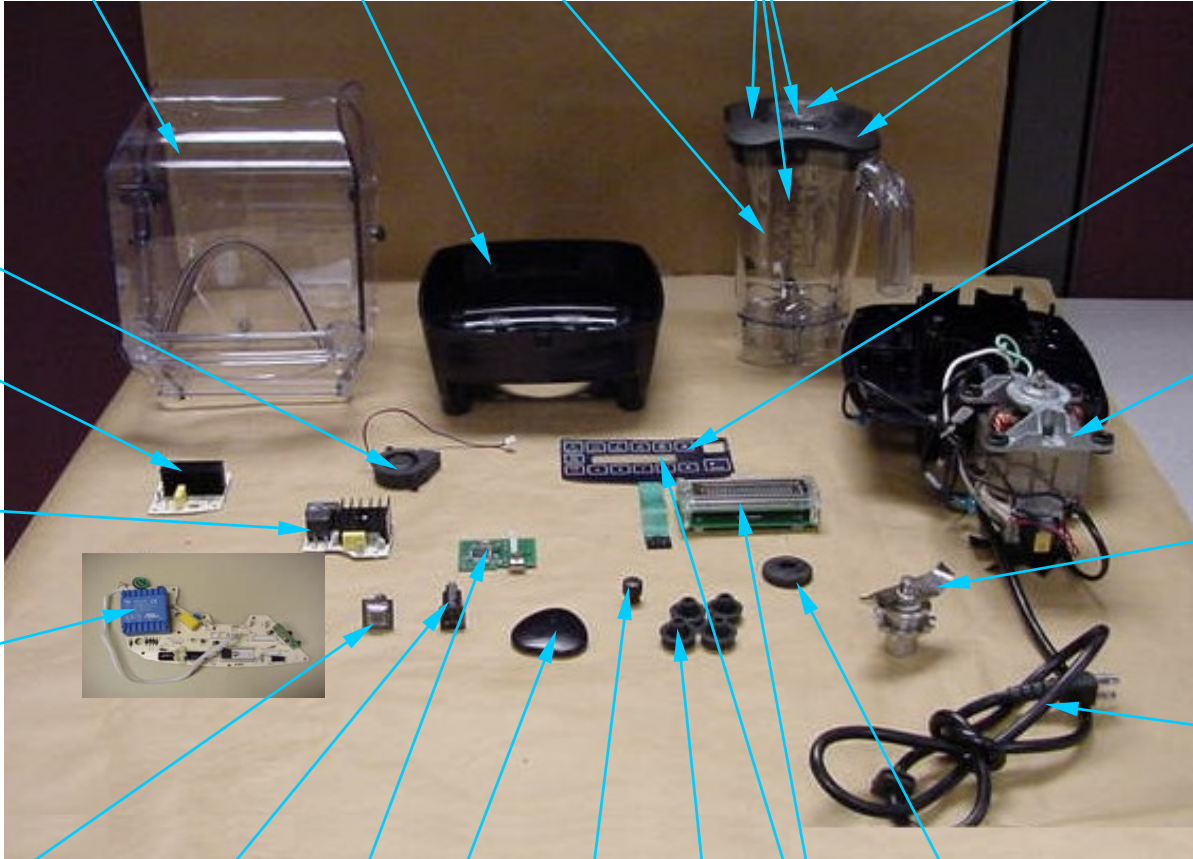

Fan 990071900
 TRIAC Board 990071700
 Relay/Rectifier Board 990072200
 Main Board With Jar Sensor 990078700

Touch Pad 990072300
 Motor 990069700
 Cutter Assembly 98650
 Cordset 990050001

Power Switch 990060100 Circuit Breaker 990079200 USB Board 990072000 USB Cover 990071400 Feet 990036100 Motor Seal 990060800

Drive Coupling 990060700 VFD Board with Touch Pad 990079300

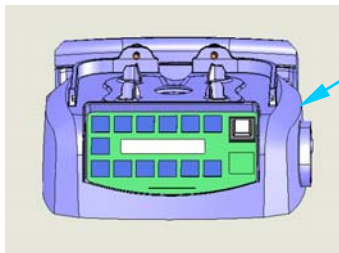

Upper Housing 990073700



Quiet Shield Thumb Screw 990072700



Jar Pad 990071300

| | | | | | | | |
|---|-----------------------|---------------------------------|----------------|---------|--------------|-----------|------|
| 4421 Waterfront Drive Glen Allen, VA 23060 | Revision Description: | Added Brush Motor Kit on page 2 | | | | | |
| | Request Number: | CME-2723 | Revision Date: | 3/25/09 | Approved by: | | |
| | Issue Code(s): | SP, CS | Page: | 1 of 2 | Document #: | 510019600 | Rev: |

Replacement Parts Diagram

Model - HBH650-CE (Series A-E)

PROPRIETARY RIGHTS NOTICE This document and all information contained within it is the property of Hamilton Beach Brands, Inc. (HBB). It is confidential and proprietary and has been provided to you for a limited purpose. It must be returned or destroyed upon request. Disclosure, reproduction or use of this document and any information contained within it, in full or in part, for any purpose is forbidden without the prior written consent of HBB. No photographs may be taken of any article fabricated or assembled from this document without the prior written consent of HBB.

+7(812)987-08-81

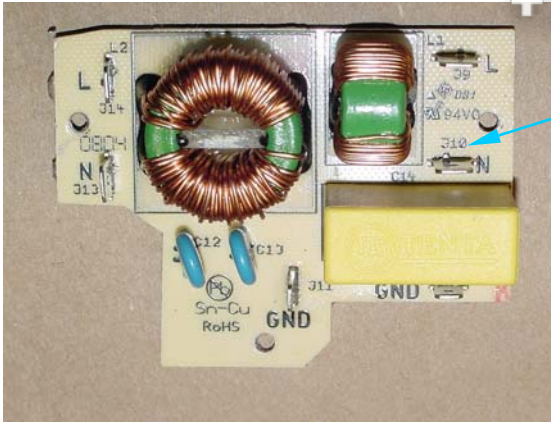

RFI Board
990078800

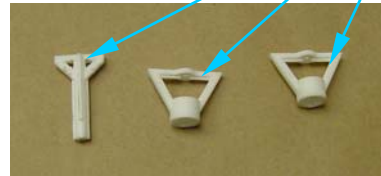

Post
990078900



Brush Motor Kit
990075300
(Set is 2 pcs)

| | | | | | | | | |
|--|-----------------------|----------|---------------------------------|---------|--------------|-----------|------|---|
|  4421 Waterfront Drive Glen Allen, VA 23060 | Revision Description: | | Added Brush Motor Kit on page 2 | | | | | |
| | Request Number: | CME-2723 | Revision Date: | 3/25/09 | Approved by: | | | |
| | Issue Code(s): | SP, CS | Page: | 2 of 2 | Document #: | 510019600 | Rev: | H |