

Зип Общепит

DESPIECE TECNICO

vsezip.ru

+7(812)987-08-81

**Hornos Mixtos  
Fours Mixtes  
Combi Ovens  
HeiBluftdämpfer  
Forno Misti**

**Modelos:**

**HMM-6/11**

**HMM-10/11**

**HMM-10/21**

**HMM-2-10/11**

**MFHMM-6/11**

**MFHMM-10/11**

**MFHMM-10/21**

**HMM-6/11 UL**

**HMM-10/11 UL**

**HMM-10/21 UL**

**VECM-6/11**

**VECM-10/11**

**VECM-10/21**

**VECM-2-10/11**

*Noviembre 2003 November*



**Fagor Industrial**

Зип Ощепит

vsezip.ru

+7(812)987-08-81

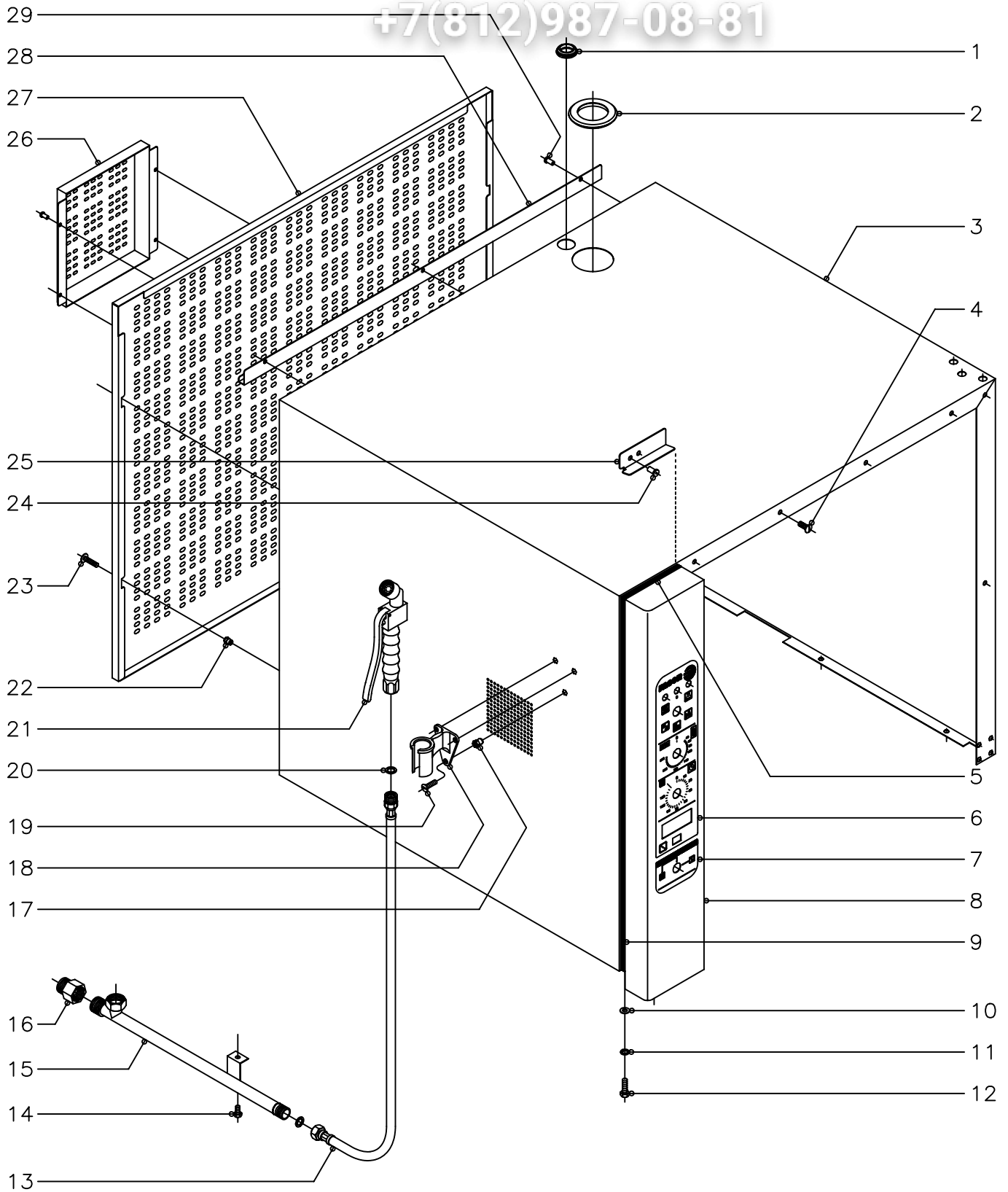

|                   |           |                  |  |        |             |  |
|-------------------|-----------|------------------|--|--------|-------------|--|
| N plano<br>C-1443 | Firma<br> | Fecha<br>11-2003 | Aparato<br>HORNOS MIX. ELECTROMECAICOS | MUEBLE | Lamina<br>1 | Fagor Industrial S.Coop. <b>FAGOR</b><br>Oñate |
|-------------------|-----------|------------------|--|--------|-------------|--|

# Зип Ощепит

vsezip.ru

+7(812)987-08-81

| MOD. |         | HORNOS MIXTOS ELECTROMECHANICOS  |       | ZONA     | MUEBLE    |           |             |             |  |
|------|---------|----------------------------------|-------|----------|-----------|-----------|-------------|-------------|--|
| ITEM | CODIGO  | DENOMINACION                     | TEXTO | HMM-6/11 | HMM-10/11 | HMM-10/21 | HMM-2-10/11 | HMM-6/11 UL |  |
| 1    | N503017 | Soporte termostato               |       | 1        | 1         | 1         | 1           | 1           |  |
| 2    | R662813 | Pasamuros chimenea               |       | 1        | 1         | 1         | 1           | 1           |  |
| 3    | R662819 | Cuerpo exterior de horno 6/11    |       | 1        | -         | -         | -           | 1           |  |
| 3    | R672816 | Cuerpo exterior de horno 10/11   |       | -        | 1         | -         | -           | -           |  |
| 3    | R682812 | Cuerpo exterior de horno 10/21   |       | -        | -         | 1         | 1           | -           |  |
| 4    | Q152017 | Tornillo amarre M-6x13           |       | 6        | 6         | 6         | 6           | 6           |  |
| 5    | 3715400 | Junta panel portamandos L=130    |       | 1        | 1         | 1         | 1           | 1           |  |
| 6    | R743012 | Serigrafia superior (FAGOR)      |       | 1        | 1         | 1         | 1           | -           |  |
| 6    | R743070 | Serigrafia superior (FAGOR - UL) |       | -        | -         | -         | -           | 1           |  |
| 6    | R743020 | Serigrafia superior (MF)         |       | -        | -         | -         | -           | 1           |  |
| 7    | R663014 | Serigrafia inferior (FAGOR)      |       | 1        | -         | -         | -           | 1           |  |
| 7    | R693000 | Serigrafia inferior (FAGOR)      |       | -        | 1         | 1         | 1           | -           |  |
| 7    | R693057 | Serigrafia inferior (MF)         |       | -        | -         | -         | -           | 1           |  |
| 7    | R693031 | Serigrafia inferior (MF)         |       | -        | -         | -         | -           | -           |  |
| 8    | R742807 | Panel portamandos 6/11           |       | 1        | -         | -         | -           | 1           |  |
| 8    | R752805 | Panel portamandos 10/11 y 10/21  |       | -        | 1         | 1         | 1           | -           |  |
| 9    | 3715400 | Junta panel portamandos L=530    |       | 2        | -         | -         | -           | 2           |  |
| 9    | 3715400 | Junta panel portamandos L=770    |       | -        | 2         | 2         | 2           | -           |  |
| 10   | Q232040 | Arandela plana A-6               |       | 2        | 2         | 2         | 2           | 2           |  |
| 11   | Q262040 | Arandela muelle A-6              |       | 2        | 2         | 2         | 2           | 2           |  |
| 12   | Q012042 | Tornillo exagonal M-6x15         |       | 2        | 2         | 2         | 2           | 2           |  |
| 13   | R095006 | Flexible de ducha                |       | *        | *         | *         | *           | 1           |  |
| 14   | Q012042 | Tornillo exagonal M-6x15         |       | *        | *         | *         | *           | 1           |  |
| 15   | R675002 | Suplemento ducha                 |       | *        | *         | -         | -           | 1           |  |
| 15   | R685003 | Suplemento ducha                 |       | -        | -         | *         | *           | -           |  |
| 16   | T125033 | Adaptador a rosca UL             |       | -        | -         | -         | -           | 1           |  |
| 17   | Q221342 | Remache exagonal M-4             |       | *        | *         | *         | *           | 3           |  |
| 18   | R095007 | Soporte de ducha                 |       | *        | *         | *         | *           | 1           |  |
| 19   | Q042022 | Tornillo avellanado M-4x15       |       | *        | *         | *         | *           | 3           |  |



Зип Общепит

vsezip.ru

+7(812)987-08-81

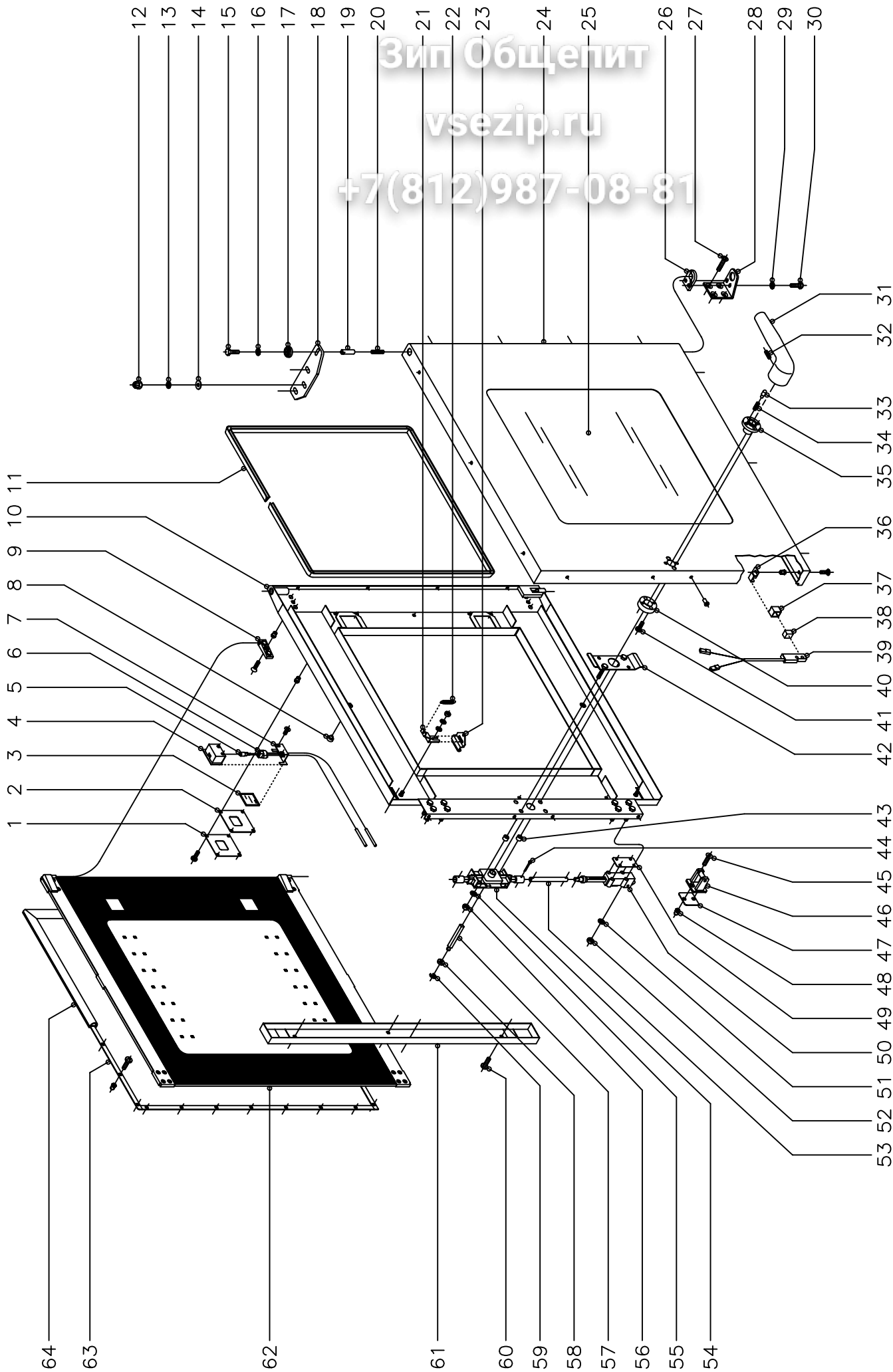

N plano  
C-1444

Firma

Fecha  
11-2003

Aparato  
HORNOS MIX. ELECTROMECANICOS

PUERTA

Lamina  
2

Fagor Industrial S.Coop. **FAGOR**  
Oñate

| MOD. |            | HORNOS MIXTOS ELECTROMECHANICOS |       | ZONA     | PUERTA    |           |             |             |  |
|------|------------|---------------------------------|-------|----------|-----------|-----------|-------------|-------------|--|
| ITEM | CODIGO     | DENOMINACION                    | TEXTO | HMM-6/11 | HMM-10/11 | HMM-10/21 | HMM-2-10/11 | HMM-6/11 UL |  |
|      | 1100002594 | KIT Puerta completa 6/11        |       | 1        | -         | -         | -           | 1           |  |
|      | 1100002595 | KIT Puerta completa 10/11       |       | -        | 1         | -         | -           | -           |  |
|      | 1100002596 | KIT Puerta completa 10/21       |       | -        | -         | 1         | 1           | -           |  |
| 1    | R670608    | Tapa cierre lampara             |       | 2        | 2         | 2         | 2           | 2           |  |
|      | Q152004    | Tornillo aplastado M-5x13       |       | 8        | 8         | 8         | 8           | 8           |  |
|      | Q222011    | Remache exagonal M-5            |       | 8        | 8         | 8         | 8           | 8           |  |
| 2    | R670609    | Junta cierre lampara            |       | 2        | 2         | 2         | 2           | 2           |  |
| 3    | R670618    | Cristal de lampara              |       | 2        | 2         | 2         | 2           | 2           |  |
| 4    | R670610    | Deflector de lampara            |       | 2        | 2         | 2         | 2           | 2           |  |
| 5    | R663013    | Lampara 10 W. 12 V.             |       | 2        | 2         | 2         | 2           | 2           |  |
| 6    | R663058    | Portalamparas                   |       | 2        | 2         | 2         | 2           | 2           |  |
| 7    | R670611    | Suplemento deflector            |       | 2        | 2         | 2         | 2           | 2           |  |
|      | Q042031    | Tornillo avellanado M-5x10      |       | 4        | 4         | 4         | 4           | 4           |  |
| 8    | R670617    | Tope cristal interior           |       | 6        | 6         | 6         | 6           | 6           |  |
| 9    | R670615    | Base de bisagra                 |       | 2        | 2         | 2         | 2           | 2           |  |
|      | Q042032    | Tornillo avellanado M-5x15      |       | 2        | 2         | 2         | 2           | 2           |  |
|      | Q222011    | Remache exagonal M-5            |       | 2        | 2         | 2         | 2           | 2           |  |
| 10   | T080500    | Contrapuerta completa 6/11      |       | 1        | -         | -         | -           | 1           |  |
| 10   | T110500    | Contrapuerta completa 10/11     |       | -        | 1         | -         | -           | -           |  |
| 10   | T120500    | Contrapuerta completa 10/21     |       | -        | -         | 1         | 1           | -           |  |
| 11   | 3715200    | Junta cristal L=1700            |       | 1        | -         | -         | -           | 1           |  |
| 11   | 3715200    | Junta cristal L=2000            |       | -        | 1         | -         | -           | -           |  |
| 11   | 3715200    | Junta cristal L=2300            |       | -        | -         | 1         | 1           | -           |  |
| 12   | Q212051    | Tuerca sombrerete M-8           |       | 3        | 3         | 3         | 3           | 3           |  |
| 13   | Q242050    | Arandela abanico A-8            |       | 3        | 3         | 3         | 3           | 3           |  |
| 14   | Q302025    | Arandela plana Ø8,4xØ20x1,5     |       | 3        | 3         | 3         | 3           | 3           |  |
| 15   | Q012042    | Tornillo exagonal M-6x15        |       | 1        | 1         | 1         | 1           | 1           |  |
| 16   | Q242040    | Arandela abanico A-6            |       | 1        | 1         | 1         | 1           | 1           |  |

| MOD. |         | HORNOS MIXTOS ELECTROMECHANICOS    |       | ZONA     | PUERTA    |           |             |             |  |
|------|---------|------------------------------------|-------|----------|-----------|-----------|-------------|-------------|--|
| ITEM | CODIGO  | DENOMINACION                       | TEXTO | HMM-6/11 | HMM-10/11 | HMM-10/21 | HMM-2-10/11 | HMM-6/11 UL |  |
| 17   | R662807 | Arandela amarre puerta             |       | 1        | 1         | 1         | 1           | 1           |  |
| 18   | T130500 | Bisagra superior                   |       | 1        | 1         | 1         | 1           | 1           |  |
| 19   | R660534 | Eje superior                       |       | 1        | 1         | 1         | 1           | 1           |  |
| 20   | Z850519 | Resorte                            |       | 1        | 1         | 1         | 1           | 1           |  |
| 21   | R670612 | Base de pestillo                   |       | 2        | 2         | 2         | 2           | 2           |  |
|      | Q302022 | Arandela plana Ø16xØ6x1,2          |       | 2        | 2         | 2         | 2           | 2           |  |
|      | Q242040 | Arandela abanico A-6               |       | 2        | 2         | 2         | 2           | 2           |  |
|      | Q162040 | Tuerca exagonal M-6                |       | 2        | 2         | 2         | 2           | 2           |  |
| 22   | R660605 | Muelle tensor pestillo             |       | 2        | 2         | 2         | 2           | 2           |  |
| 23   | R670613 | Pestillo sujecion cristal interior |       | 2        | 2         | 2         | 2           | 2           |  |
| 24   | R660600 | Panel puerta 6/11                  |       | 1        | -         | -         | -           | 1           |  |
| 24   | R670600 | Panel puerta 10/11                 |       | -        | 1         | -         | -           | -           |  |
| 24   | R680600 | Panel puerta 10/21                 |       | -        | -         | 1         | 1           | -           |  |
|      | Q412002 | Remache tubular Ø4x7,5             |       | 14       | 14        | 14        | 14          | 14          |  |
| 25   | R660606 | Cristal exterior 6/11              |       | 1        | -         | -         | -           | 1           |  |
| 25   | R670625 | Cristal exterior 10/11             |       | -        | 1         | -         | -           | -           |  |
| 25   | R680609 | Cristal exterior 10/21             |       | -        | -         | 1         | 1           | -           |  |
| 26   | R660549 | Guia eje inferior                  |       | 1        | 1         | 1         | 1           | 1           |  |
| 27   | Q062040 | Tornillo avellanado M-6x16         |       | 4        | 4         | 4         | 4           | 4           |  |
| 28   | R660551 | Bisagra inferior                   |       | 1        | 1         | 1         | 1           | 1           |  |
| 29   | Q242040 | Arandela abanico A-6               |       | 2        | 2         | 2         | 2           | 2           |  |
| 30   | Q012041 | Tornillo exagonal M-6x10           |       | 2        | 2         | 2         | 2           | 2           |  |
| 31   | T130502 | Manilla                            |       | 1        | 1         | 1         | 1           | 1           |  |
| 32   | Q132042 | Varilla roscada M-6x15             |       | 1        | 1         | 1         | 1           | 1           |  |
| 33   | T130507 | Piton enganche                     |       | 2        | 2         | 2         | 2           | 2           |  |
| 34   | T130506 | Resorte                            |       | 2        | 2         | 2         | 2           | 2           |  |
| 35   | T130515 | Guia manilla                       |       | 1        | 1         | 1         | 1           | 1           |  |
| 36   | T130513 | Soporte iman                       |       | 1        | 1         | 1         | 1           | 1           |  |
| 37   | Z200507 | Protector iman                     |       | 1        | 1         | 1         | 1           | 1           |  |

# Зип Общепит

vsezip.ru

+7(812)987-08-81

| MOD. |            | HORNOS MIXTOS ELECTROMECHANICOS     |       | ZONA     | PUERTA    |           |             |             |  |
|------|------------|-------------------------------------|-------|----------|-----------|-----------|-------------|-------------|--|
| ITEM | CODIGO     | DENOMINACION                        | TEXTO | HMM-6/11 | HMM-10/11 | HMM-10/21 | HMM-2-10/11 | HMM-6/11 UL |  |
| 38   | Z200506    | Iman                                |       | 1        | 1         | 1         | 1           | 1           |  |
| 39   | Z100522    | Interruptor magnetico               |       | 1        | 1         | 1         | 1           | 1           |  |
| 40   | T130514    | Soporte resortes                    |       | 1        | 1         | 1         | 1           | 1           |  |
| 41   | Q032032    | Tornillo alomado M-5x15             |       | 2        | 2         | 2         | 2           | 2           |  |
| 42   | T130511    | Suplemento fijacion cerradura       |       | 1        | 1         | 1         | 1           | 1           |  |
| 43   | Z608410    | Casquillo                           |       | 2        | 2         | 2         | 2           | 2           |  |
| 44   | Q352001    | Pasador de aletas Ø2x15             |       | 4        | 4         | 4         | 4           | 4           |  |
| 45   | Q042043    | Tornillo avellanado M-6x20          |       | 4        | 4         | 4         | 4           | 4           |  |
| 46   | R260545    | Enganche                            |       | 2        | 2         | 2         | 2           | 2           |  |
| 47   | R660538    | Calzo de enganche                   |       | 4        | 4         | 4         | 4           | 4           |  |
| 48   | Q221343    | Remache exagonal M-6                |       | 4        | 4         | 4         | 4           | 4           |  |
| 49   | T080503    | Suplemento elemento cierre          |       | 6        | 6         | 6         | 6           | 6           |  |
| 50   | T080504    | Elemento de cierre                  |       | 2        | 2         | 2         | 2           | 2           |  |
| 51   | Q262040    | Arandela muelle A-6                 |       | 8        | 8         | 8         | 8           | 8           |  |
| 52   | Q162040    | Tuerca exagonal M-6                 |       | 8        | 8         | 8         | 8           | 8           |  |
| 53   | R020502    | Tubo alargadera                     |       | -        | 2         | 2         | 2           | -           |  |
| 54   | T130509    | Mecanismo de cierre                 |       | 1        | 1         | 1         | 1           | 1           |  |
| 55   | Q262040    | Arandela muelle A-6                 |       | 2        | 2         | 2         | 2           | 2           |  |
| 56   | Q162040    | Tuerca exagonal M-6                 |       | 2        | 2         | 2         | 2           | 2           |  |
| 57   | T130508    | Eje de manilla                      |       | 1        | 1         | 1         | 1           | 1           |  |
| 58   | T130505    | Casquillo                           |       | 1        | 1         | 1         | 1           | 1           |  |
| 59   | Q271033    | Arandela de seguridad Ø6            |       | 1        | 1         | 1         | 1           | 1           |  |
| 60   | Q032031    | Tornillo alomado M-5x10             |       | 2        | 2         | 2         | 2           | 2           |  |
| 60   | Q032021    | Tornillo alomado M-4x10             |       | 2        | 2         | 2         | 2           | 2           |  |
| 61   | T080502    | Tapa cierre puerta                  |       | 1        | -         | -         | -           | 1           |  |
| 61   | T110502    | Tapa cierre puerta                  |       | -        | 1         | 1         | 1           | -           |  |
| 62   | 1100002806 | KIT Cristal interior completo 6/11  |       | 1        | -         | -         | -           | 1           |  |
| 62   | 1100002807 | KIT Cristal interior completo 10/11 |       | -        | 1         | -         | -           | -           |  |
| 62   | 1100002808 | KIT Cristal interior completo 10/21 |       | -        | -         | 1         | 1           | -           |  |





Зип Общепит

vs/10/10

+7(844)987-08887

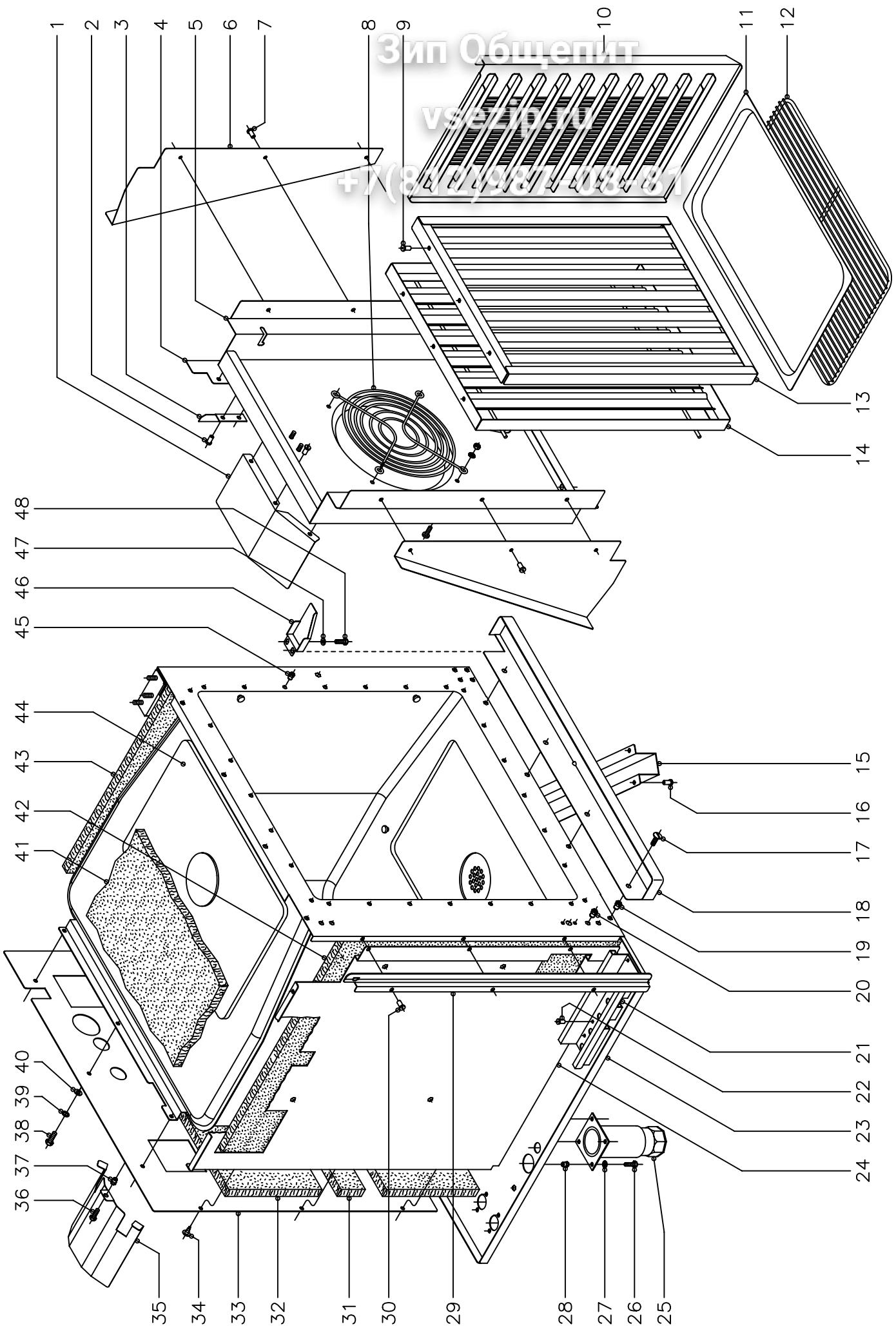

|                   |           |                  |  |             |  |
|-------------------|-----------|------------------|--|-------------|--|
| N plano<br>C-1445 | Firma<br> | Fecha<br>11-2003 | Aparato<br>MUEBLE INTERIOR<br>HORNOS MIX. ELECTROMECANICOS | Lamina<br>3 | Fagor Industrial S.Coop. <b>FAGOR</b><br>Onate |
|-------------------|-----------|------------------|--|-------------|--|

| MOD. |         | HORNOS MIXTOS ELECTROMECHANICOS   |       | ZONA     | MUEBLE INTERIOR |           |             |             |  |
|------|---------|-----------------------------------|-------|----------|-----------------|-----------|-------------|-------------|--|
| ITEM | CODIGO  | DENOMINACION                      | TEXTO | HMM-6/11 | HMM-10/11       | HMM-10/21 | HMM-2-10/11 | HMM-6/11 UL |  |
| 1    | R682632 | Deflector de turbina              |       | -        | -               | 2         | 2           | -           |  |
|      | Q412002 | Remache tubular Ø 4x7,5           |       | -        | -               | 6         | 6           | -           |  |
| 2    | Q412002 | Remache tubular Ø 4x7,5           |       | 4        | 4               | 4         | 4           | 4           |  |
| 3    | R292647 | Escuadra sujecion cubreventilador |       | 2        | 2               | 2         | 2           | 2           |  |
| 4    | R662648 | Aleron derecho                    |       | 1        | -               | -         | -           | 1           |  |
| s/n  | R662647 | Aleron izquierdo                  |       | 1        | -               | -         | -           | 1           |  |
|      | Q412002 | Remache tubular Ø 4x7,5           |       | 6        | -               | -         | -           | 6           |  |
| 5    | R662656 | Cubre ventilador                  |       | 1        | -               | -         | -           | 1           |  |
| 5    | R672651 | Cubre ventilador                  |       | -        | 1               | -         | -           | -           |  |
| 5    | R682669 | Cubre ventilador                  |       | -        | -               | 1         | 1           | -           |  |
| 6    | R732619 | Aleron lateral                    |       | -        | -               | 2         | 2           | -           |  |
| 7    | Q412002 | Remache tubular Ø 4x7,5           |       | -        | -               | 6         | 6           | -           |  |
| 8    | R662661 | Proteccion de turbina             |       | -        | -               | -         | -           | 1           |  |
|      | Q032021 | Tornillo alomado M-4x10           |       | -        | -               | -         | -           | 4           |  |
|      | Q242020 | Arandela abanico A-4              |       | -        | -               | -         | -           | 4           |  |
|      | Q162020 | Tuerca exagonal M-4               |       | -        | -               | -         | -           | 4           |  |
| 9    | Q412002 | Remache tubular Ø 4x7,5           |       | 6        | 6               | 6         | 6           | 6           |  |
| 10   | R662668 | Guia de bandejas derecha          |       | 1        | -               | -         | -           | 1           |  |
| s/n  | R662670 | Guia de bandejas izquierda        |       | 1        | -               | -         | -           | 1           |  |
| 10   | T112615 | Guia de bandejas derecha          |       | -        | 1               | -         | -           | -           |  |
| s/n  | T112617 | Guia de bandejas izquierda        |       | -        | 1               | -         | -           | -           |  |
| 10   | T122614 | Guia de bandejas derecha          |       | -        | -               | 1         | -           | -           |  |
| s/n  | T122616 | Guia de bandejas izquierda        |       | -        | -               | 1         | -           | -           |  |
| 10   | R682640 | Guia de bandejas MARKET-FORGE     |       | -        | -               | -         | -           | -           |  |
| 11   | R252816 | Bandeja 1/1 ( 530x325x20 )        |       | 1        | 1               | -         | 1           | -           |  |
| 11   | R032605 | Bandeja 2/1 ( 530x650x40 )        |       | -        | -               | 1         | -           | -           |  |
| 12   | R672665 | Parrilla 1/1                      |       | 1        | 1               | -         | 1           | 3           |  |
| 12   | R682676 | Parrilla 2/1                      |       | -        | -               | 1         | -           | -           |  |
| 12   | R682641 | Parrilla 2/1 MARKET-FORGE         |       | -        | -               | -         | -           | -           |  |

| MOD. |         | HORNOS MIXTOS ELECTROMECHANICOS |       | ZONA     | MUEBLE INTERIOR |           |             |             |  |
|------|---------|---------------------------------|-------|----------|-----------------|-----------|-------------|-------------|--|
| ITEM | CODIGO  | DENOMINACION                    | TEXTO | HMM-6/11 | HMM-10/11       | HMM-10/21 | HMM-2-10/11 | HMM-6/11 UL |  |
| 13   | R662617 | Anterior de filtro              |       | 1        | -               | -         | -           | 1           |  |
| 13   | R092618 | Anterior de filtro              |       | -        | 1               | 1         | 1           | -           |  |
| 14   | R662622 | Posterior de filtro             |       | 1        | -               | -         | -           | 1           |  |
| 14   | R092621 | Posterior de filtro             |       | -        | 1               | 1         | 1           | -           |  |
| 15   | R672804 | Cubre desagüe                   |       | 1        | 1               | -         | -           | 1           |  |
| 15   | R682805 | Cubre desagüe                   |       | -        | -               | 1         | 1           | -           |  |
| 16   | Q412002 | Remache tubular Ø 4x7,5         |       | 8        | 8               | 8         | 8           | 8           |  |
| 17   | Q152017 | Tornillo amarre M-6x13          |       | 4        | 4               | 4         | 4           | 4           |  |
| 18   | T112813 | Recoge aguas                    |       | 1        | 1               | -         | -           | 1           |  |
| 18   | T122811 | Recoge aguas                    |       | -        | -               | 1         | 1           | -           |  |
| 19   | Q221343 | Remache exagonal M-6            |       | 4        | 4               | 4         | 4           | 4           |  |
| 20   | Q221343 | Remache exagonal M-6            |       | 8        | 8               | 8         | 8           | 8           |  |
| 21   | R342821 | Guia del cuadro electrico       |       | 1        | 1               | 1         | 1           | 1           |  |
| 22   | Q412002 | Remache tubular Ø 4x7,5         |       | 8        | 8               | 8         | 8           | 8           |  |
| 23   | R672813 | Base exterior de horno          |       | 1        | 1               | -         | -           | 1           |  |
| 23   | R682811 | Base exterior de horno          |       | -        | -               | 1         | 1           | -           |  |
| 24   | T072614 | Soporte lateral aislante        |       | 1        | -               | -         | -           | 1           |  |
| 24   | T112624 | Soporte lateral aislante        |       | -        | 1               | -         | -           | -           |  |
| 24   | T122619 | Soporte lateral aislante        |       | -        | -               | 1         | 1           | -           |  |
| 25   | X260151 | Pata regulable                  |       | 4        | 4               | 4         | 4           | 4           |  |
| 26   | Q012042 | Tornillo exagonal M-6x15        |       | 16       | 16              | 16        | 16          | 16          |  |
| 27   | Q242040 | Arandela abanico A-6            |       | 16       | 16              | 16        | 16          | 16          |  |
| 28   | Q221343 | Remache exagonal M-6            |       | 16       | 16              | 16        | 16          | 16          |  |
| 29   | R662682 | Protector portamandos           |       | 1        | -               | -         | -           | 1           |  |
| 29   | R672674 | Protector portamandos           |       | -        | 1               | 1         | 1           | -           |  |
| 30   | Q412002 | Remache tubular Ø 4x7,5         |       | 3        | 3               | 3         | 3           | 3           |  |
| 31   | R662616 | Aislante posterior 560x60x20    |       | 3        | 3               | 4         | 4           | 3           |  |
| 32   | R662615 | Aislante posterior 800x110x20   |       | 2        | -               | -         | -           | 2           |  |
| 32   | R672631 | Aislante posterior 670x230x20   |       | -        | 2               | 2         | 2           | -           |  |

| MOD. |         | HORNOS MIXTOS ELECTROMECHANICOS      |       | ZONA     | MUEBLE INTERIOR |           |             |             |  |
|------|---------|--------------------------------------|-------|----------|-----------------|-----------|-------------|-------------|--|
| ITEM | CODIGO  | DENOMINACION                         | TEXTO | HMM-6/11 | HMM-10/11       | HMM-10/21 | HMM-2-10/11 | HMM-6/11 UL |  |
| 33   | R662655 | Soporte aislante posterior           |       | 1        | -               | -         | -           | 1           |  |
| 33   | R672608 | Soporte aislante posterior           |       | -        | 1               | -         | -           | -           |  |
| 33   | R682606 | Soporte aislante posterior           |       | -        | -               | 1         | 1           | -           |  |
| 34   | Q151301 | Tornillo alomado                     |       | 3        | 3               | 3         | 3           | 3           |  |
| 35   | R142628 | Tejadillo motor turbina              |       | 1        | 1               | 1         | 1           | 1           |  |
| 36   | Q012042 | Tornillo exagonal M-6x15             |       | 1        | 1               | 1         | 1           | 1           |  |
| 37   | Q221343 | Remache exagonal M-6                 |       | 1        | 1               | 1         | 1           | 1           |  |
| 38   | Q012042 | Tornillo exagonal M-6x15             |       | 12       | 12              | 12        | 12          | 12          |  |
| 39   | Q262040 | Arandela muelle A-6                  |       | 12       | 12              | 12        | 12          | 12          |  |
| 40   | Q232040 | Arandela plana A-6                   |       | 12       | 12              | 12        | 12          | 12          |  |
| 41   | R662614 | Aislante base y techo 650x650x20     |       | 5        | 5               | -         | -           | 5           |  |
| 41   | R682623 | Aislante base y techo 860x790x20     |       | -        | -               | 5         | 5           | -           |  |
| 42   | R662613 | Aislante lateral 650x530x20          |       | 3        | -               | -         | -           | 3           |  |
| 42   | R672630 | Aislante lateral 770x650x20          |       | -        | 3               | -         | -           | -           |  |
| 42   | R682623 | Aislante lateral 860x790x20          |       | -        | -               | 3         | 3           | -           |  |
| 43   | R662613 | Aislante lateral 650x530x20          |       | 2        | -               | -         | -           | 2           |  |
| 43   | R672630 | Aislante lateral 770x650x20          |       | -        | 2               | -         | -           | -           |  |
| 43   | R682623 | Aislante lateral 860x790x20          |       | -        | -               | 2         | 2           | -           |  |
| 44   | R662681 | Cuerpo interior horno                |       | 1        | -               | -         | -           | 1           |  |
| 44   | R672673 | Cuerpo interior horno                |       | -        | 1               | -         | -           | -           |  |
| 44   | R682674 | Cuerpo interior horno                |       | -        | -               | 1         | 1           | -           |  |
|      | R662636 | Refuerzo base de cuerpo interior     |       | 1        | 1               | -         | -           | 1           |  |
|      | R682633 | Refuerzo base de cuerpo interior     |       | -        | -               | 1         | 1           | -           |  |
|      | R682663 | Refuerzo vertical de cuerpo interior |       | -        | -               | 2         | 2           | -           |  |
|      | Q232040 | Arandela plana A-6                   |       | 8        | 8               | 21        | 21          | 8           |  |
|      | Q262040 | Arandela muelle A-6                  |       | 8        | 8               | 21        | 21          | 8           |  |
|      | Q162040 | Tuerca exagonal M-6                  |       | 8        | 8               | 21        | 21          | 8           |  |
| 45   | Q222041 | Remache exagonal M-4 inox.           |       | 24       | 28              | 28        | 28          | 24          |  |



Зип ОБЩЕПИТ

vsezip.ru

7(812)987-08-81

4

5

3

1

2

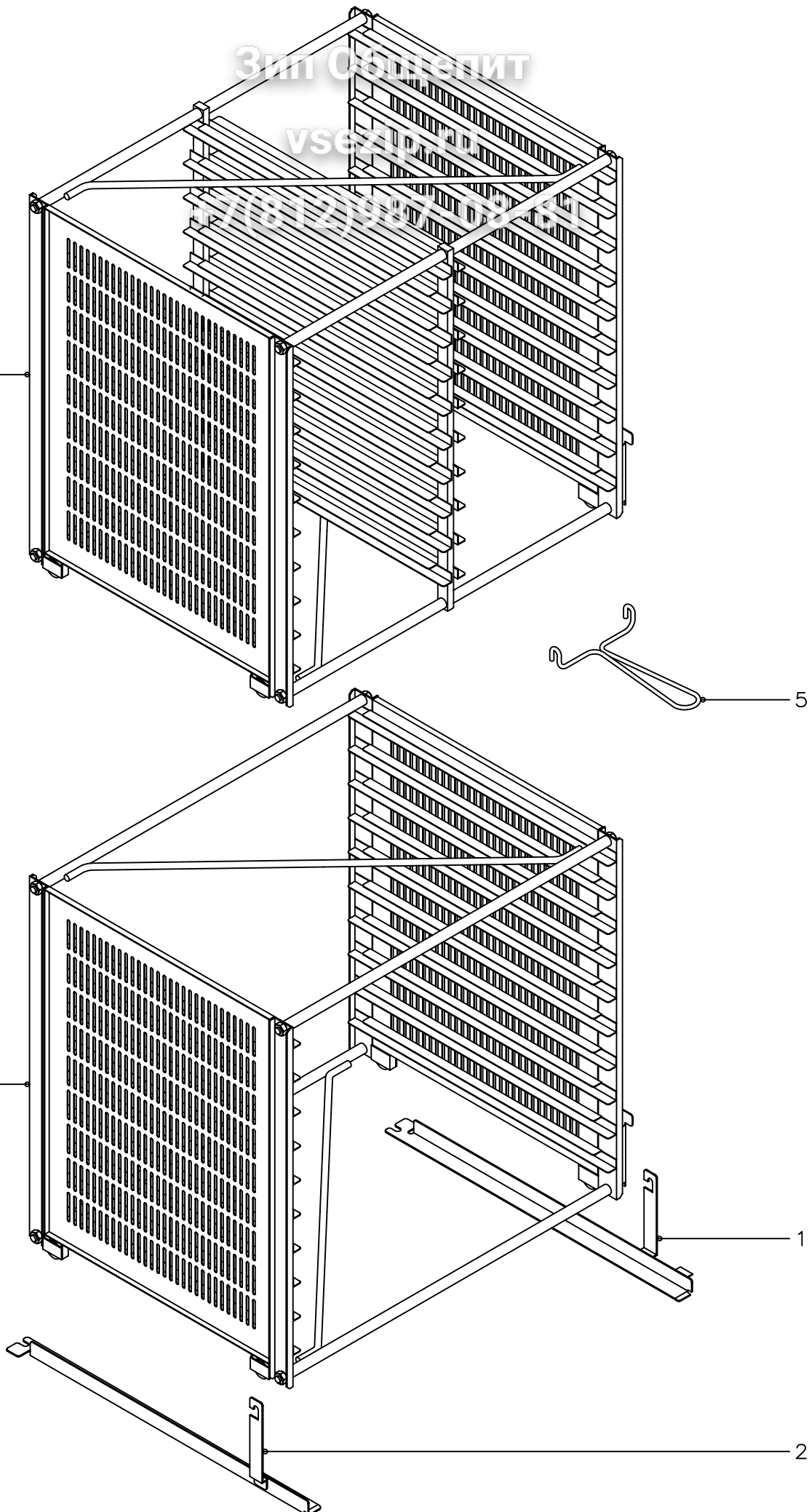

|                   |           |                  |  |                           |             |  |
|-------------------|-----------|------------------|--|---------------------------|-------------|--|
| N plano<br>C-1446 | Firma<br> | Fecha<br>11-2003 | Aparato<br>HORNOS MIX. ELECTROMECHANICOS | EXTRACTURAS PORTABANDEJAS | Lamina<br>4 | Fagor Industrial S.Coop. <b>FAGOR</b><br>Oñate |
|-------------------|-----------|------------------|--|---------------------------|-------------|--|





Зип Общепит

vsezip.ru

+7(812)987-08-81

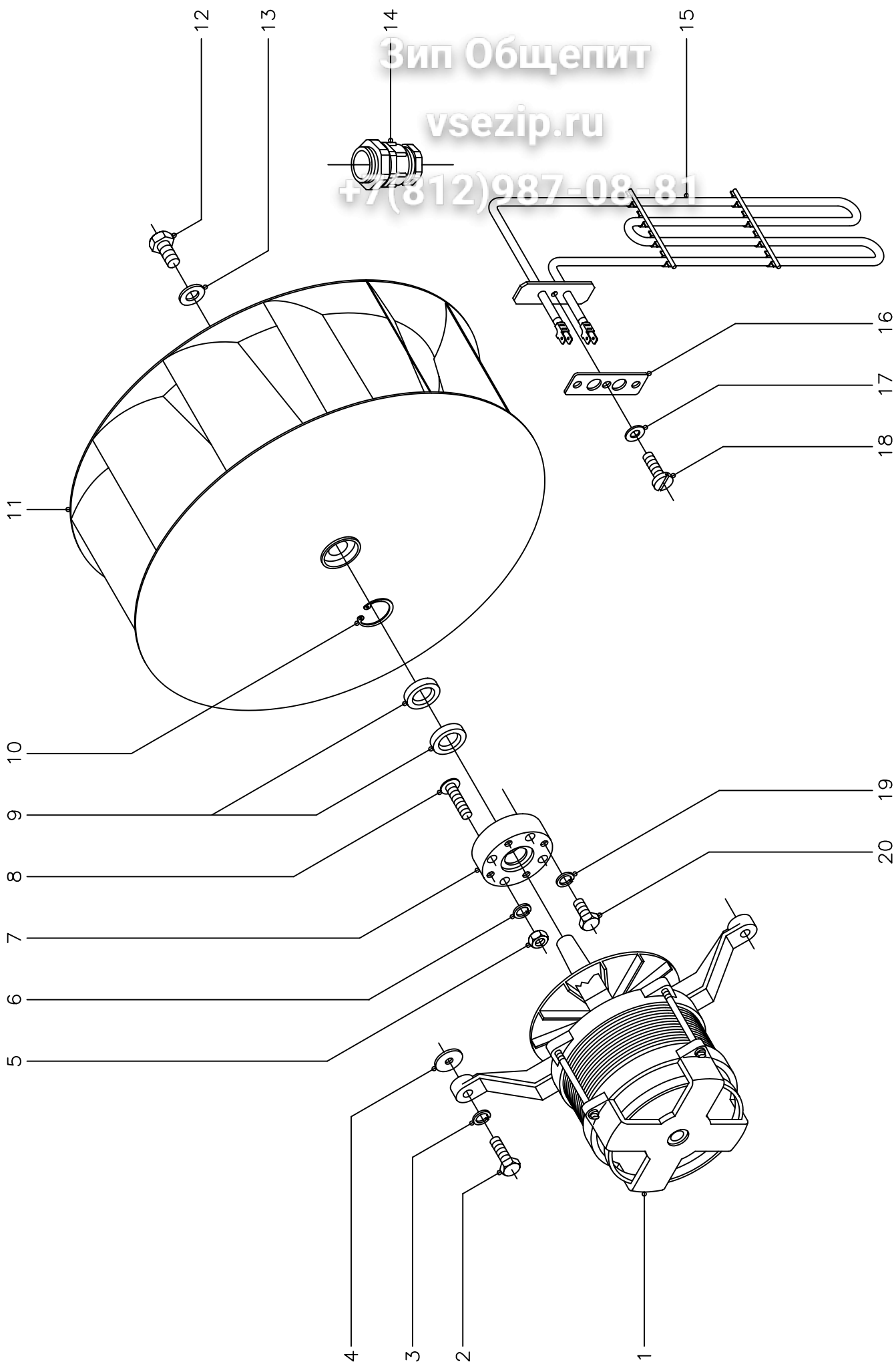

|                   |           |                  |  |         |             |  |
|-------------------|-----------|------------------|--|---------|-------------|--|
| N plano<br>C-1447 | Firma<br> | Fecha<br>11-2003 | Aparato<br>HORNOS MIX. ELECTROMECHANICOS | TURBINA | Lamina<br>5 | Fagor Industrial S.Coop. <b>FAGOR</b><br>Onate |
|-------------------|-----------|------------------|--|---------|-------------|--|



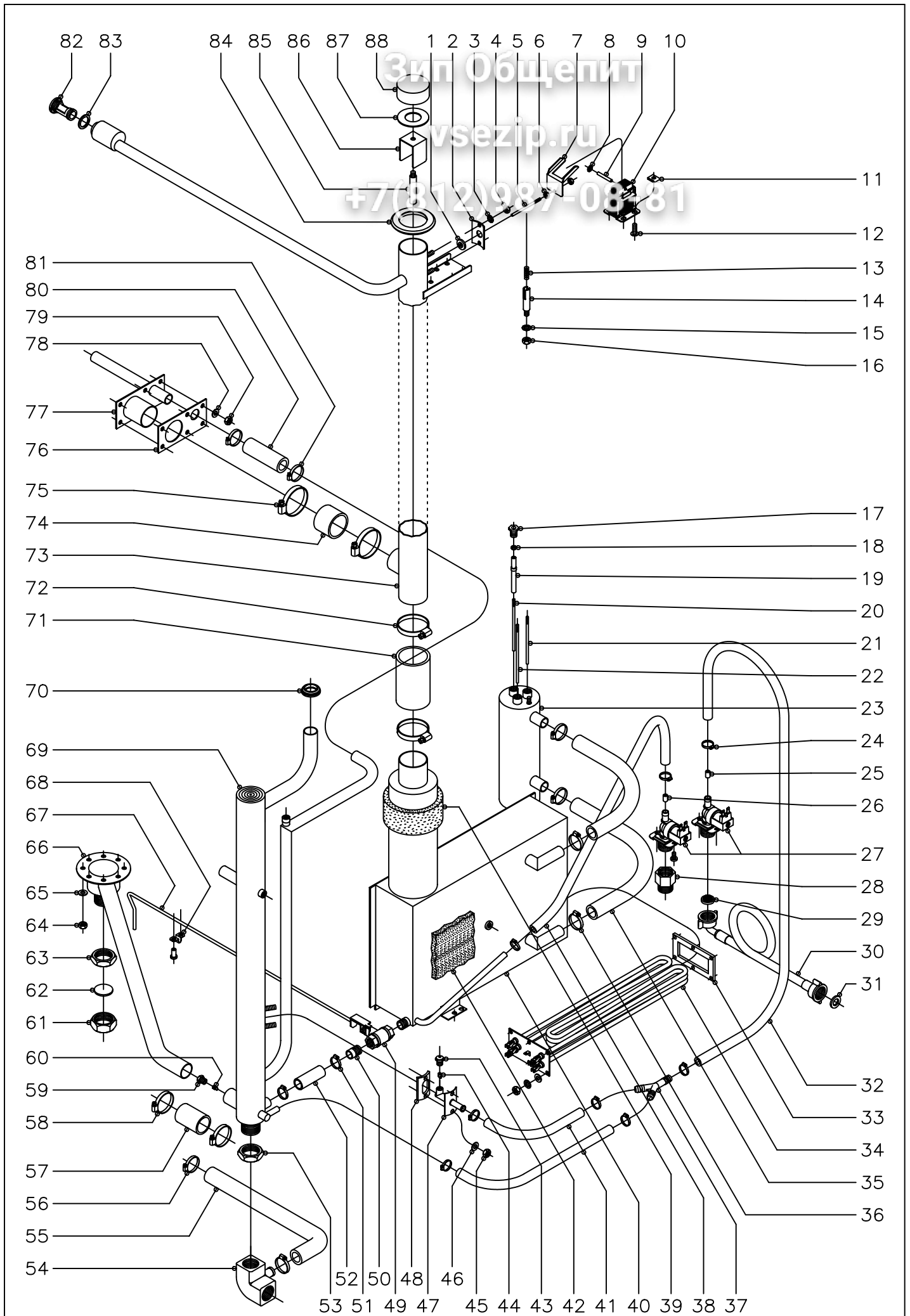

|                   |  |                  |   |             |  |
|-------------------|--|------------------|---|-------------|--|
| N plano<br>C-1448 | Firma<br> | Fecha<br>11-2003 | Aparato<br>CIRCUITO DE AGUA<br>HORNOS MIX. ELECTROMECANICOS | Lamina<br>6 | Fagor Industrial S.Coop. <b>FAGOR</b> <br>Onate |
|-------------------|--|------------------|---|-------------|--|

| MOD. |         | HORNOS MIXTOS ELECTROMECAVICOS   |       | ZONA     | CIRCUITO DE AGUA |           |             |             |  |
|------|---------|----------------------------------|-------|----------|------------------|-----------|-------------|-------------|--|
| ITEM | CODIGO  | DENOMINACION                     | TEXTO | HMM-6/11 | HMM-10/11        | HMM-10/21 | HMM-2-10/11 | HMM-6/11 UL |  |
| 1    | R675033 | Junta palanca accionamiento      |       | 1        | 1                | 1         | 1           | 1           |  |
| 2    | T115105 | Amarre junta a conduccion vahos  |       | 1        | 1                | 1         | 1           | 1           |  |
| 3    | Q242030 | Arandela abanico A-5             |       | 2        | 2                | 2         | 2           | 2           |  |
| 4    | Q162030 | Tuerca exagonal M-5              |       | 2        | 2                | 2         | 2           | 2           |  |
| 5    | R675014 | Palanca accionamiento            |       | 1        | 1                | 1         | 1           | 1           |  |
| 6    | Q162020 | Tuerca exagonal M-4              |       | 2        | 2                | 2         | 2           | 2           |  |
| 7    | R672640 | Escuadra accionamiento           |       | 1        | 1                | 1         | 1           | 1           |  |
| 8    | Q301035 | Sujecion rapida Ø4               |       | 2        | 2                | 2         | 2           | 2           |  |
| 9    | R675016 | Pasador electroiman              |       | 1        | 1                | 1         | 1           | 1           |  |
| 10   | R663030 | Electroiman                      |       | 1        | 1                | 1         | 1           | 1           |  |
| 11   | Q221012 | Tuerca rapida M-5                |       | 2        | 2                | 2         | 2           | 2           |  |
| 12   | Q152004 | Tornillo aplastado M-5x13        |       | 2        | 2                | 2         | 2           | 2           |  |
| 13   | Z883001 | Resorte                          |       | 1        | 1                | 1         | 1           | 1           |  |
| 14   | R665027 | Guia resorte                     |       | 1        | 1                | 1         | 1           | 1           |  |
| 15   | Q242040 | Arandela abanico A-6             |       | 1        | 1                | 1         | 1           | 1           |  |
| 16   | Q162040 | Tuerca exagonal M-6              |       | 1        | 1                | 1         | 1           | 1           |  |
| 17   | R345058 | Racord amarre electrodos         |       | 3        | 3                | 3         | 3           | 3           |  |
| 18   | Q163020 | Tuerca exagonal M-4              |       | 6        | 6                | 6         | 6           | 6           |  |
| 19   | R345059 | Guia aislante de electrodos      |       | 3        | 3                | 3         | 3           | 3           |  |
| 20   | R345063 | Electrodo nivel bajo L=116       |       | 1        | 1                | 1         | 1           | 1           |  |
| 21   | R345060 | Electrodo nivel alto L=106       |       | 1        | 1                | 1         | 1           | 1           |  |
| 22   | R345064 | Electrodo de masa L=131          |       | 1        | 1                | 1         | 1           | 1           |  |
| 23   | R665046 | Cuerpo de niveles                |       | 1        | -                | -         | -           | 1           |  |
| 23   | R025011 | Cuerpo de niveles                |       | -        | 1                | 1         | 1           | -           |  |
| 24   | Q881302 | Abrazadera 12 - 20               |       | 4        | 4                | 4         | 4           | 4           |  |
| 25   | P443042 | Regulador caudal (3 l./m.) negro |       | 1        | 1                | 1         | 1           | 1           |  |
| 26   | Z601156 | Regulador caudal (8 l./m.) rojo  |       | 1        | 1                | 1         | 1           | 1           |  |
| 27   | Z701135 | Electrovalvula entrada agua      |       | 2        | 2                | 2         | 2           | 2           |  |
|      | Q032021 | Tornillo alomado M-4x10          |       | 4        | 4                | 4         | 4           | 4           |  |

# Зип Ощепит

vsezip.ru

+7(812)987-08-81

| MOD. |         | HORNOS MIXTOS ELECTROMECHANICOS  |       | ZONA     | CIRCUITO DE AGUA |           |             |             |  |
|------|---------|----------------------------------|-------|----------|------------------|-----------|-------------|-------------|--|
| ITEM | CODIGO  | DENOMINACION                     | TEXTO | HMM-6/11 | HMM-10/11        | HMM-10/21 | HMM-2-10/11 | HMM-6/11 UL |  |
| 28   | T125033 | Adaptador a rosca UL             |       | -        | -                | -         | -           | 1           |  |
| 29   | Z701132 | Filtro-junta entrada de agua     |       | 1        | 1                | 1         | 1           | 1           |  |
| 30   | Z601114 | Manguera entrada de agua         |       | 2        | 2                | 2         | 2           | -           |  |
| 31   | Q307031 | Arandela junta Ø24xØ14x3         |       | 2        | 2                | 2         | 2           | 2           |  |
| 32   | 3676900 | Tubo de goma Ø17xØ10x900         |       | 1        | 1                | 1         | 1           | 1           |  |
| 33   | R145012 | Junta cierre resistencias        |       | 1        | 2                | 2         | 2           | 1           |  |
| 34   | R143000 | Resistencia (3000W.x3, 230 V.)   |       | 1        | 2                | 2         | 2           | 1           |  |
|      | Q232030 | Arandela plana A-5               |       | 6        | 12               | 12        | 12          | 6           |  |
|      | Q242030 | Arandela abanico A-5             |       | 6        | 12               | 12        | 12          | 6           |  |
|      | Q162030 | Tuerca exagonal M-5              |       | 6        | 12               | 12        | 12          | 6           |  |
| 35   | 3715600 | Tubo silicona forra. Ø26xØ18x400 |       | 2        | 2                | 2         | 2           | 2           |  |
| 36   | Q881305 | Abrazadera 25 - 40               |       | 4        | 4                | 4         | 4           | 4           |  |
| 37   | Z201106 | Racord en " Y "                  |       | 1        | 1                | 1         | 1           | 1           |  |
| 38   | 3676900 | Tubo de goma Ø17xØ10x500         |       | 1        | 1                | 1         | 1           | 1           |  |
| 39   | R665052 | Aislante salida generador        |       | 1        | -                | -         | -           | -           |  |
| 39   | R345013 | Aislante salida generador        |       | -        | 1                | 1         | 1           | -           |  |
| 39   | R672630 | Aislante salida generador        |       | -        | -                | -         | -           | 1/2.        |  |
| 40   | R665042 | Generador de vapor               |       | 1        | -                | -         | -           | 1           |  |
| 40   | R675024 | Generador de vapor               |       | -        | 1                | 1         | 1           | -           |  |
| 41   | 3676900 | Tubo de goma Ø17xØ10x400         |       | 2        | 2                | 2         | 2           | 2           |  |
| 42   | R665051 | Aislante cuerpo generador        |       | 1        | -                | -         | -           | -           |  |
| 42   | R345011 | Aislante cuerpo generador        |       | -        | 1                | 1         | 1           | -           |  |
| 42   | R672630 | Aislante cuerpo generador        |       | -        | -                | -         | -           | 1/2.        |  |
| 43   | Z651931 | Tobera                           |       | 1        | 1                | 1         | 1           | 1           |  |
| 44   | Z651932 | Rodete                           |       | 1        | 1                | 1         | 1           | 1           |  |
| 45   | Q162030 | Tuerca exagonal M-5              |       | 2        | 2                | 2         | 2           | 2           |  |
| 46   | Q232030 | Arandela plana A-5               |       | 2        | 2                | 2         | 2           | 2           |  |
| 47   | R015007 | Conduccion vahos                 |       | 1        | 1                | 1         | 1           | 1           |  |

| MOD. |         | HORNOS MIXTOS ELECTROMECHANICOS |       | ZONA     | CIRCUITO DE AGUA |           |             |             |  |
|------|---------|---------------------------------|-------|----------|------------------|-----------|-------------|-------------|--|
| ITEM | CODIGO  | DENOMINACION                    | TEXTO | HMM-6/11 | HMM-10/11        | HMM-10/21 | HMM-2-10/11 | HMM-6/11 UL |  |
| 48   | R345108 | Junta conduccion vahos          |       | 1        | 1                | 1         | 1           | 1           |  |
| 49   | R015034 | Cuerpo grifo vaciado            |       | 1        | 1                | 1         | 1           | 1           |  |
| 50   | R345014 | Manguito grifo vaciado          |       | 1        | 1                | 1         | 1           | 1           |  |
| 51   | Q881304 | Abrazadera 20 - 32              |       | 2        | 2                | 2         | 2           | 2           |  |
| 52   | 3715600 | Tubo silicona Ø26xØ18x120       |       | 1        | 1                | 1         | 1           | 1           |  |
| 53   | Q223014 | Contratuerca 1"                 |       | 1        | 1                | 1         | 1           | 1           |  |
| 54   | R665067 | Codo desague                    |       | 1        | 1                | 1         | 1           | 1           |  |
| 55   | 3715600 | Tubo silicona Ø26xØ18x1000      |       | 1        | 1                | 1         | 1           | 1           |  |
| 56   | Q881304 | Abrazadera 20 - 32              |       | 2        | 2                | 2         | 2           | 2           |  |
| 57   | 3714100 | Tubo silicona Ø38xØ31x100       |       | 1        | 1                | 1         | 1           | 1           |  |
| 58   | Q881305 | Abrazadera 25 - 40              |       | 2        | 2                | 2         | 2           | 2           |  |
| 59   | Z651931 | Tobera                          |       | 1        | 1                | 1         | 1           | 1           |  |
| 60   | Z651932 | Rodete                          |       | 1        | 1                | 1         | 1           | 1           |  |
| 61   | R665053 | Tuerca tapon 1"                 |       | 1        | 1                | 1         | 1           | 1           |  |
| 62   | R015011 | Arandela junta tapon Ø34x3      |       | 1        | 1                | 1         | 1           | 1           |  |
| 63   | Q223014 | Contratuerca 1"                 |       | 1        | 1                | 1         | 1           | 1           |  |
| 64   | Q162040 | Tuerca exagonal M-6             |       | 8        | 8                | 8         | 8           | 8           |  |
| 65   | Q232040 | Arandela plana A-6              |       | 8        | 8                | 8         | 8           | 8           |  |
| 66   | R675022 | Tubo de desague                 |       | 1        | 1                | -         | -           | 1           |  |
| 66   | R685006 | Tubo de desague                 |       | -        | -                | 1         | 1           | -           |  |
| 67   | R342803 | Palanca de grifo de vaciado     |       | 1        | 1                | -         | -           | 1           |  |
| 67   | R032804 | Palanca de grifo de vaciado     |       | -        | -                | 1         | 1           | -           |  |
| 68   | Q901306 | Grapa amarre palanca grifo      |       | 1        | 1                | 1         | 1           | 1           |  |
|      | Q412002 | Remache tubular Ø 4x7,5         |       | 2        | 2                | 2         | 2           | 2           |  |
| 69   | R665048 | Tubo retorno y chimenea         |       | 1        | -                | -         | -           | 1           |  |
| 69   | R675030 | Tubo retorno y chimenea         |       | -        | 1                | -         | -           | -           |  |
| 69   | R685010 | Tubo retorno y chimenea         |       | -        | -                | 1         | 1           | -           |  |
| 70   | N503017 | Soporte termostato              |       | 1        | 1                | 1         | 1           | 1           |  |
| 71   | R345020 | Tubo empalme generador          |       | 1        | 1                | 1         | 1           | 1           |  |



Зип Общепит

vsezip.ru

+7(812)987-08-81

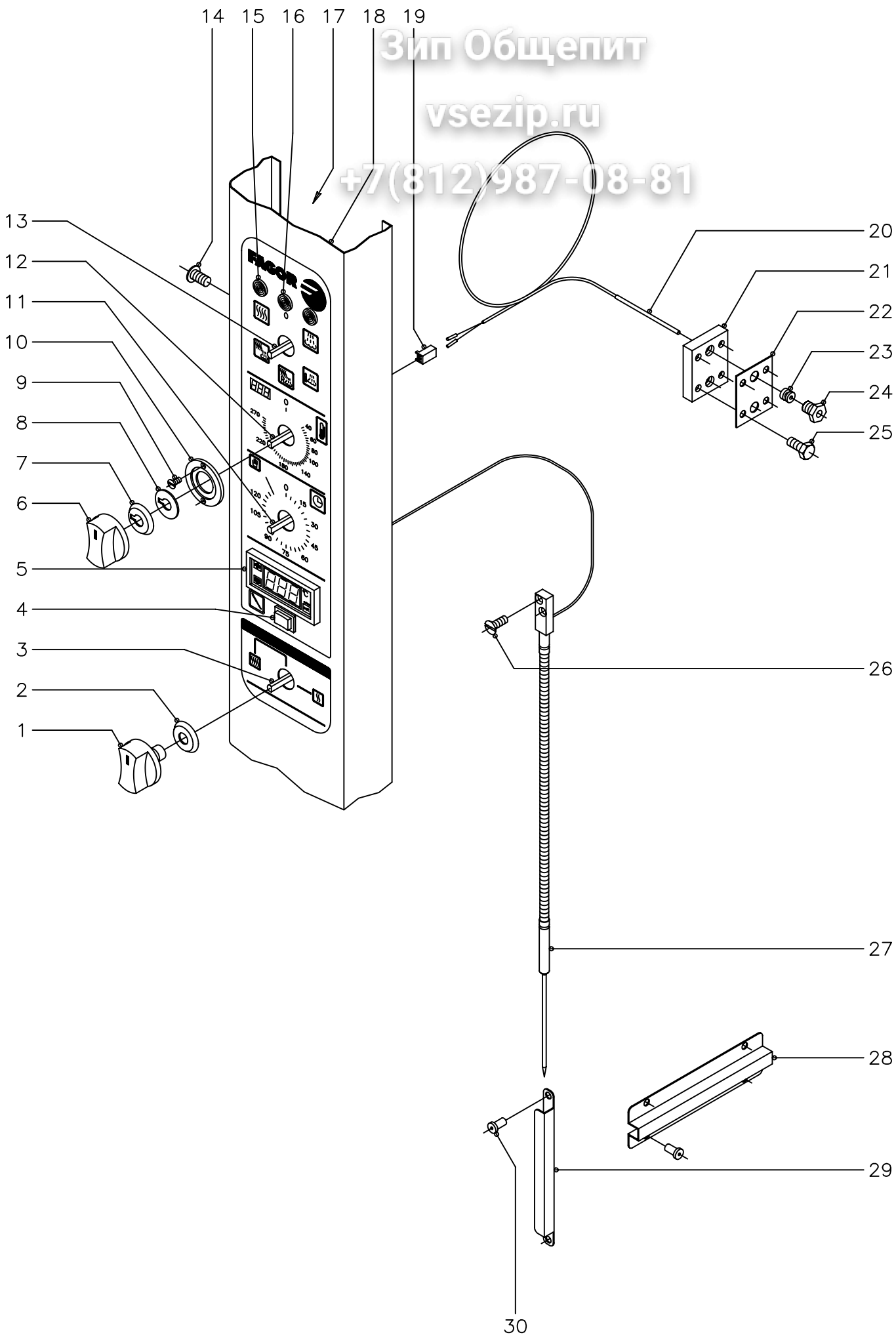

N plano  
C-1449

Firma

Fecha  
11-2003

Aparato SISTEMA ELECTRICO PORTAMANDOS  
HORNOS MIX. ELECTROMECHANICOS

Lamina  
7

Fagor Industrial S.Coop. **FAGOR**  
Onate



| MOD. |         | HORNOS MIXTOS ELECTROMECHANICOS   |       | ZONA     | SISTEMA ELECTRICO PORTAMANDOS |           |             |             |  |
|------|---------|-----------------------------------|-------|----------|-------------------------------|-----------|-------------|-------------|--|
| ITEM | CODIGO  | DENOMINACION                      | TEXTO | HMM-6/11 | HMM-10/11                     | HMM-10/21 | HMM-2-10/11 | HMM-6/11 UL |  |
| 1    | R663062 | Boton de mando (conmutadores)     |       | 2        | 3                             | 3         | 3           | 2           |  |
| 1    | R663070 | Boton de mando (conmutadores)     |       | -        | -                             | -         | -           | 2           |  |
| 2    | R663046 | Junta (conmutadores)              |       | 2        | 3                             | 3         | 3           | 2           |  |
| 3    | R753000 | Conmutador de potencia            |       | -        | 1                             | 1         | 1           | -           |  |
| 4    | R743008 | Interruptor regulacion sonda      |       | 1        | 1                             | 1         | 1           | 1           |  |
| 5    | R743091 | Termostato digital ° C.           |       | 1        | 1                             | 1         | 1           | -           |  |
| 5    | R743035 | Termostato digital ° F.           |       | -        | -                             | -         | -           | 1           |  |
| 6    | R663063 | Boton de mando (circuito impreso) |       | 1        | 1                             | 1         | 1           | 1           |  |
| 6    | R663071 | Boton de mando (circuito impreso) |       | -        | -                             | -         | -           | 1           |  |
| 7    | R663045 | Junta (circuito impreso)          |       | 1        | 1                             | 1         | 1           | 1           |  |
| 8    | R662810 | Arandela guia                     |       | 1        | 1                             | 1         | 1           | 1           |  |
| 9    | Q151346 | Tornillo avellanado M-3x5         |       | 2        | 2                             | 2         | 2           | 2           |  |
| 10   | R662809 | Guia boton de mando               |       | 1        | 1                             | 1         | 1           | 1           |  |
| 11   | R723000 | Temporizador manual               |       | 1        | 1                             | 1         | 1           | 1           |  |
| 12   | R743013 | Termostato electronico 270°C.     |       | 1        | 1                             | 1         | 1           | -           |  |
| 12   | R693058 | Termostato electronico 500°F.     |       | -        | -                             | -         | -           | 1           |  |
| 13   | R743002 | Conmutador de funciones           |       | 1        | 1                             | 1         | 1           | 1           |  |
| 14   | Q152004 | Tornillo aplastado M-5x13         |       | 3        | 3                             | 3         | 3           | 3           |  |
| 15   | R693056 | Piloto ambar                      |       | 2        | 2                             | 2         | 2           | 2           |  |
| 16   | R693055 | Piloto verde                      |       | 1        | 1                             | 1         | 1           | 1           |  |
| 17   | R742803 | Soporte componentes               |       | 1        | 1                             | 1         | 1           | 1           |  |
| 18   | R742807 | Panel portamandos 6/11            |       | 1        | -                             | -         | -           | 1           |  |
| 18   | R752805 | Panel portamandos 10/11 y 10/21   |       | -        | 1                             | 1         | 1           | -           |  |
| 19   | R663092 | Conector 2 vias                   |       | 1        | 1                             | 1         | 1           | 1           |  |
| 20   | R663090 | Conjunto termopar L=1500          |       | 1        | 1                             | 1         | 1           | 1           |  |
| 21   | R662659 | Pasamuros doble para sonda        |       | 1        | 1                             | 1         | 1           | 1           |  |
| 22   | R692811 | Junta pasamuros doble             |       | 1        | 1                             | 1         | 1           | 1           |  |
| 23   | R662652 | Bicono cierre sonda               |       | 1        | 1                             | 1         | 1           | 1           |  |
| 24   | R662629 | Racord cierre sonda               |       | 1        | 1                             | 1         | 1           | 1           |  |



Зип Общепит

vsezip.ru

+7(812)987-08881

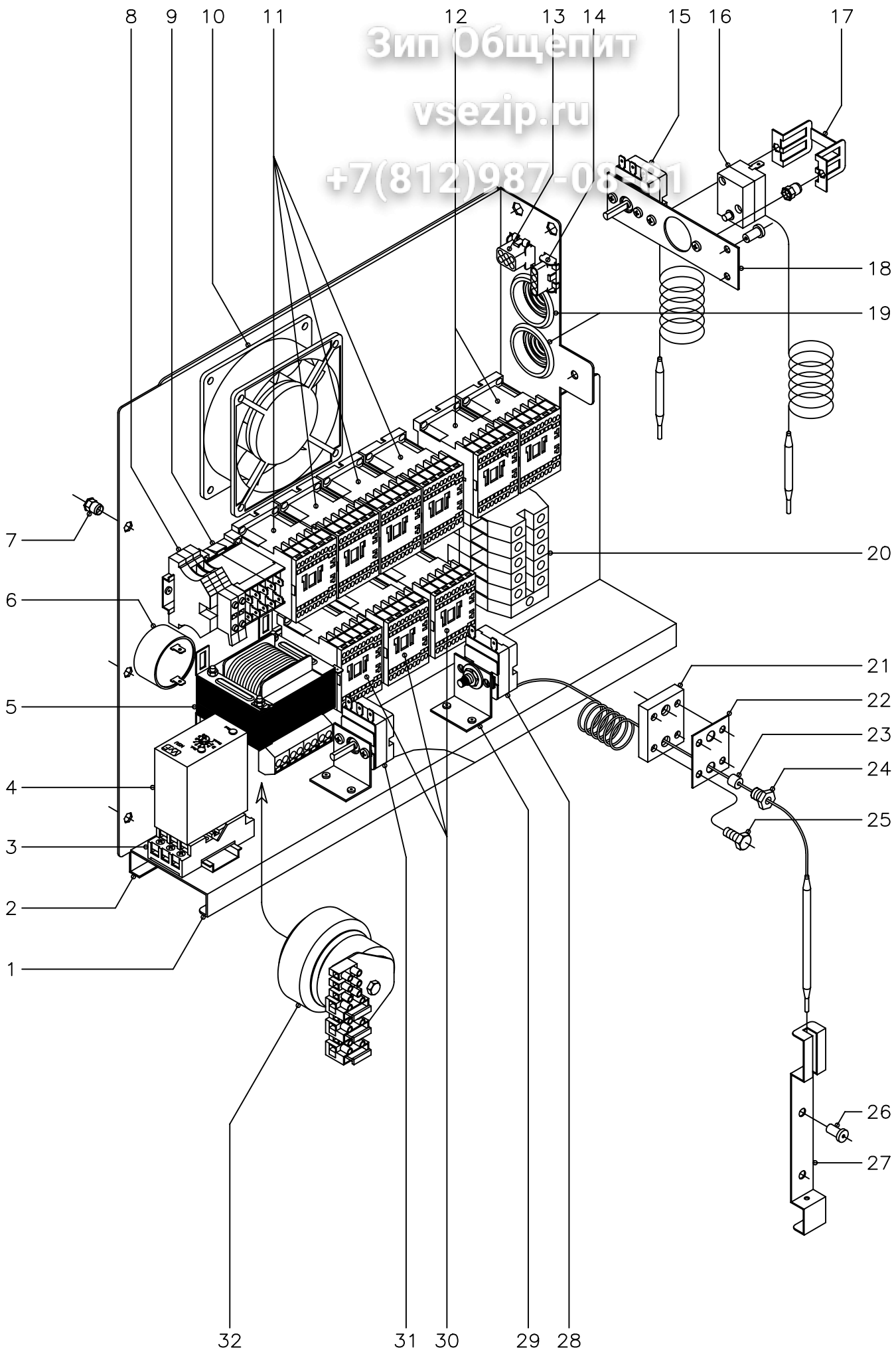

|                   |           |                  |  |             |  |
|-------------------|-----------|------------------|--|-------------|--|
| N plano<br>C-1450 | Firma<br> | Fecha<br>11-2003 | Aparato<br>CUADRO ELECTRICO<br>HORNOS MIX. ELECTROMECHANICOS | Lamina<br>8 | Fagor Industrial S.Coop. <b>FAGOR</b><br>Onate |
|-------------------|-----------|------------------|--|-------------|--|

| MOD. | HORNOS MIXTOS ELECTROMECHANICOS | ZONA                               | CUADRO ELECTRICO |          |           |           |             |             |
|------|---------------------------------|------------------------------------|------------------|----------|-----------|-----------|-------------|-------------|
| ITEM | CODIGO                          | DENOMINACION                       | TEXTO            | HMM-6/11 | HMM-10/11 | HMM-10/21 | HMM-2-10/11 | HMM-6/11 UL |
| 1    | R663081                         | Panel cuadro electrico             |                  | 1        | 1         | 1         | 1           | 1           |
| 2    | R663018                         | Contra guia panel cuadro           |                  | 1        | 1         | 1         | 1           | 1           |
|      | Q412002                         | Remache tubular Ø4x7,5             |                  | 7        | 7         | 7         | 7           | 7           |
| 3    | R743009                         | Base enchufable                    |                  | 1        | 1         | 1         | 1           | 1           |
|      | Z123018                         | Guia contactor L=55                |                  | 1        | 1         | 1         | 1           | 1           |
| 4    | R343072                         | Detector de niveles                |                  | 1        | 1         | 1         | 1           | -           |
| 4    | R743031                         | Detector de niveles                |                  | -        | -         | -         | -           | 1           |
| 5    | R503005                         | Transformador                      |                  | 1        | 1         | 1         | 1           | -           |
| 6    | R693067                         | Zumbador                           |                  | 1        | 1         | 1         | 1           | 1           |
| 7    | Q221342                         | Remache exagonal M-5               |                  | 3        | 3         | 3         | 3           | 3           |
| 8    | R073005                         | Bornas portafusibles               |                  | 2        | 2         | 2         | 2           | 2           |
|      | P184011                         | Cartucho fusible 4 A.              |                  | 2        | 2         | 2         | 2           | 2           |
|      | Z263303                         | Tope final                         |                  | 1        | 1         | 1         | 1           | 1           |
| 9    | Z683087                         | Contactor 3TF20 01 - 3AL2 (230 V.) |                  | 1        | 1         | 1         | 1           | 1           |
|      | Z263303                         | Tope final                         |                  | 1        | 1         | 1         | 1           | 1           |
| 10   | Z103066                         | Ventilador                         |                  | 1        | 1         | 1         | 1           | 1           |
| 11   | Z203050                         | Contactor sirius 3RT-1016-2AP01    |                  | 2        | 4         | 4         | 4           | 2           |
|      | R693009                         | Guia contactor L=250               |                  | 1        | 1         | 1         | 1           | 1           |
| 12   | Z203050                         | Contactor sirius 3RT-1016-2AP01    |                  | 2        | 2         | 2         | 2           | 2           |
|      | Z403016                         | Guia contactor L=100               |                  | 1        | 1         | 1         | 1           | 1           |
| 13   | -                               | Conector hembra 6 vias             |                  | 1        | 1         | 1         | 1           | 1           |
| 14   | -                               | Conector hembra 4 vias             |                  | 1        | 1         | 1         | 1           | 1           |
| 15   | R343100                         | Termostato de condensacion         |                  | 1        | 1         | 1         | 1           | 1           |
|      | Q153111                         | Tornillo alomado M-4x8             |                  | 2        | 2         | 2         | 2           | 2           |
| 16   | Z213014                         | Termostato Tecasa de seguridad     |                  | 1        | 1         | 1         | 1           | 1           |
| 17   | Z203060                         | Amarre limitador Tecasa            |                  | 1        | 1         | 1         | 1           | 1           |
|      | Q221341                         | Remache exagonal M-4               |                  | 2        | 2         | 2         | 2           | 2           |
|      | Q153111                         | Tornillo alomado M-4x8             |                  | 2        | 2         | 2         | 2           | 2           |
| 18   | R673061                         | Soporte amarre termostatos         |                  | 1        | 1         | 1         | 1           | 1           |

# Зип Общепит

vsezip.ru

+7(812)987-08-81

| MOD. | HORNOS MIXTOS ELECTROMECAICOS | ZONA                             | CUADRO ELECTRICO |          |           |           |             |             |
|------|-------------------------------|----------------------------------|------------------|----------|-----------|-----------|-------------|-------------|
| ITEM | CODIGO                        | DENOMINACION                     | TEXTO            | HMM-6/11 | HMM-10/11 | HMM-10/21 | HMM-2-10/11 | HMM-6/11 UL |
|      | Q412002                       | Remache tubular Ø4x7,5           |                  | 2        | 2         | 2         | 2           | 2           |
| 19   | N103013                       | Pasacables                       |                  | 2        | 2         | 2         | 2           | 2           |
| 20   | P453025                       | Borne gris fases 10              |                  | 3        | -         | -         | -           | 3           |
|      | R263003                       | Borne gris fases 35              |                  | -        | 3         | 3         | 3           | -           |
|      | Z263302                       | Borne azul neutro 10             |                  | 1        | -         | -         | -           | 1           |
|      | R673010                       | Borne azul neutro 35             |                  | -        | 1         | 1         | 1           | -           |
|      | P453026                       | Borne verde-amarillo tierra 10   |                  | 1        | -         | -         | -           | 1           |
|      | Z103035                       | Borne verde-amarillo tierra 35   |                  | -        | 1         | 1         | 1           | -           |
|      | Z263303                       | Tope final                       |                  | 1        | -         | -         | -           | 1           |
|      | Z683096                       | Tope final 35                    |                  | -        | 1         | 1         | 1           | -           |
|      | Z683068                       | Señalización bornes              |                  | 1        | 1         | 1         | 1           | 1           |
|      | R663055                       | Guía contactor 120               |                  | 1        | 1         | 1         | 1           | 1           |
| 21   | R662659                       | Pasamuros doble para sonda       |                  | 1        | 1         | 1         | 1           | 1           |
| 22   | R692811                       | Junta pasamuros doble            |                  | 1        | 1         | 1         | 1           | 1           |
| 23   | R662662                       | Junta cierre bulbo limitador     |                  | 1        | 1         | 1         | 1           | 1           |
| 24   | R662629                       | Racord cierre sonda              |                  | 1        | 1         | 1         | 1           | 1           |
| 25   | Q012021                       | Tornillo exagonal M-4x10         |                  | 4        | 4         | 4         | 4           | 4           |
| 26   | Q412002                       | Remache tubular Ø4x7,5           |                  | 2        | 2         | 2         | 2           | 2           |
| 27   | R662630                       | Soporte de bulbo                 |                  | 1        | 1         | 1         | 1           | 1           |
| 28   | R243016                       | Termostato limitador temperatura |                  | 1        | 1         | 1         | 1           | 1           |
| 29   | R343039                       | Soporte de termostatos           |                  | 2        | 2         | 2         | 2           | 2           |
| 30   | Z203050                       | Contacto sirius 3RT-1016-2AP01   |                  | 1        | 3         | 3         | 3           | 1           |
|      | Z103084                       | Guía contactor 138               |                  | 1        | 1         | 1         | 1           | 1           |
| 31   | R343018                       | Termostato a tubo retorno vapor  |                  | 1        | 1         | 1         | 1           | 1           |
| 32   | R723063                       | Transformador UL                 |                  | -        | -         | -         | -           | 1           |
|      |                               |                                  |                  |          |           |           |             |             |
|      |                               |                                  |                  |          |           |           |             |             |
|      |                               |                                  |                  |          |           |           |             |             |
|      |                               |                                  |                  |          |           |           |             |             |

| MOD. |         | HORNOS MIXTOS ELECTROMECHANICOS      |       | ZONA     | VARIOS    |           |             |             |  |
|------|---------|--------------------------------------|-------|----------|-----------|-----------|-------------|-------------|--|
| ITEM | CODIGO  | DENOMINACION                         | TEXTO | HMM-6/11 | HMM-10/11 | HMM-10/21 | HMM-2-10/11 | HMM-6/11 UL |  |
|      | R746501 | Folleto de instrucciones ( FAGOR )   |       | 1        | 1         | 1         | 1           | -           |  |
|      | R696516 | Folleto de instruccio. ( FAGOR UL )  |       | -        | -         | -         | -           | 1           |  |
|      | R746503 | Folleto de instrucciones ( M F )     |       | -        | -         | -         | -           | 1           |  |
|      | R743039 | Esquema electrico adhesivo           |       | 1        | -         | -         | -           | -           |  |
|      | R743040 | Esquema electrico adhesivo (MF)      |       | -        | -         | -         | -           | 1           |  |
|      | R743041 | Esquema electrico adhesivo (UL)      |       | -        | -         | -         | -           | 1           |  |
|      | R753013 | Esquema electrico adhesivo           |       | -        | 1         | 1         | 1           | -           |  |
|      | R753022 | Esquema electrico adhesivo (MF)      |       | -        | -         | -         | -           | -           |  |
|      | R753024 | Esquema electrico adhesivo (UL)      |       | -        | -         | -         | -           | -           |  |
|      | R703040 | Esquema electrico de montaje         |       | 1        | -         | -         | -           | 1           |  |
|      | R503004 | Esquema electrico de montaje         |       | -        | 1         | 1         | 1           | -           |  |
|      | R503009 | Instalacion electrica HMM            |       | 1        | 1         | 1         | 1           | -           |  |
|      | R503008 | Instalacion electrica HMM ( UL )     |       | -        | -         | -         | -           | 1           |  |
|      | R693066 | Cableado fuerza conveccion           |       | 1        | -         | -         | -           | -           |  |
|      | R743062 | Cableado fuerza conveccion ( UL )    |       | -        | -         | -         | -           | 1           |  |
|      | R143005 | Cableado fuerza conveccion           |       | -        | 1         | 1         | 1           | -           |  |
|      | R143015 | Cableado fuerza conveccion ( UL )    |       | -        | -         | -         | -           | -           |  |
|      | R663074 | Instalacion fuerza cuadro electrico  |       | 1        | -         | -         | -           | -           |  |
|      | R743060 | Instalacion fuerza cuadro elec. (UL) |       | -        | -         | -         | -           | 1           |  |
|      | R673013 | Instalacion fuerza cuadro electrico  |       | -        | 1         | 1         | 1           | -           |  |
|      | R753020 | Instalacion fuerza cuadro elec. (UL) |       | -        | -         | -         | -           | -           |  |
|      | R663095 | Cableado luz interior                |       | 1        | 1         | 1         | 1           | 1           |  |
|      | R663094 | Cableado luz puerta                  |       | 1        | 1         | 1         | 1           | -           |  |
|      | R693053 | Cableado luz puerta ( UL )           |       | -        | -         | -         | -           | 1           |  |
|      | 3713900 | Funda roja-negra Ø6,4x500            |       | 1        | 1         | 1         | 1           | 1           |  |
|      | R663075 | Cableado fuerza vapor                |       | 1        | -         | -         | -           | -           |  |







# Зип Общепит

vsezip.ru

+7(812)987-08-81

| MOD. HORNOS MIXTOS ELECTROMECANICOS |         |                                   | ZONA  |          | PIEZAS A INTRODUCIR PARA LA VERSION ( |  |  |  |
|-------------------------------------|---------|-----------------------------------|-------|----------|---------------------------------------|--|--|--|
| ITEM                                | CODIGO  | DENOMINACION                      | TEXTO | HMM-6/11 | HMM-10/11                             |  |  |  |
|                                     | R663048 | Condensador para motor de turbina |       | 1        | 1                                     |  |  |  |
|                                     | R013019 | Cableado para condensador         |       | 1        | 1                                     |  |  |  |
|                                     |         |                                   |       |          |                                       |  |  |  |
|                                     |         |                                   |       |          |                                       |  |  |  |
|                                     |         |                                   |       |          |                                       |  |  |  |
|                                     |         |                                   |       |          |                                       |  |  |  |
|                                     |         |                                   |       |          |                                       |  |  |  |
|                                     |         |                                   |       |          |                                       |  |  |  |
|                                     |         |                                   |       |          |                                       |  |  |  |
|                                     |         |                                   |       |          |                                       |  |  |  |
|                                     |         |                                   |       |          |                                       |  |  |  |
|                                     |         |                                   |       |          |                                       |  |  |  |
|                                     |         |                                   |       |          |                                       |  |  |  |
|                                     |         |                                   |       |          |                                       |  |  |  |
|                                     |         |                                   |       |          |                                       |  |  |  |
|                                     |         |                                   |       |          |                                       |  |  |  |
|                                     |         |                                   |       |          |                                       |  |  |  |
|                                     |         |                                   |       |          |                                       |  |  |  |
|                                     |         |                                   |       |          |                                       |  |  |  |
|                                     |         |                                   |       |          |                                       |  |  |  |
|                                     |         |                                   |       |          |                                       |  |  |  |
|                                     |         |                                   |       |          |                                       |  |  |  |
|                                     |         |                                   |       |          |                                       |  |  |  |
|                                     |         |                                   |       |          |                                       |  |  |  |
|                                     |         |                                   |       |          |                                       |  |  |  |
|                                     |         |                                   |       |          |                                       |  |  |  |
|                                     |         |                                   |       |          |                                       |  |  |  |
|                                     |         |                                   |       |          |                                       |  |  |  |
|                                     |         |                                   |       |          |                                       |  |  |  |
|                                     |         |                                   |       |          |                                       |  |  |  |
|                                     |         |                                   |       |          |                                       |  |  |  |
|                                     |         |                                   |       |          |                                       |  |  |  |
|                                     |         |                                   |       |          |                                       |  |  |  |
|                                     |         |                                   |       |          |                                       |  |  |  |
|                                     |         |                                   |       |          |                                       |  |  |  |
|                                     |         |                                   |       |          |                                       |  |  |  |
|                                     |         |                                   |       |          |                                       |  |  |  |
|                                     |         |                                   |       |          |                                       |  |  |  |
|                                     |         |                                   |       |          |                                       |  |  |  |



3N-50/60Hz 380/415V

Зип Общепит

MODELO HMM-6/1

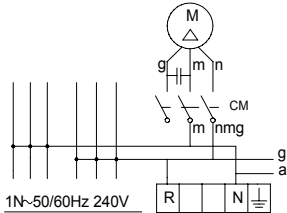
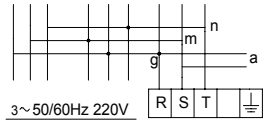
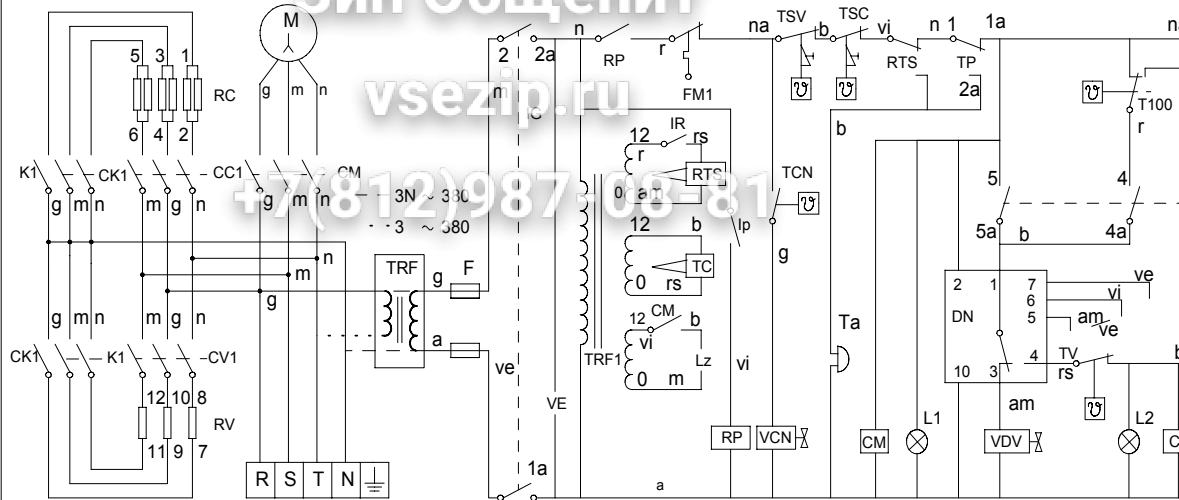

am/ve = amarillo-verde-yellow-green-jaune-vert  
 am = amarillo-yellow-jaune  
 a = azul-blue-bleu  
 b = blanco-white-blanc  
 g = gris-grey-gris  
 ve = verde-green-vert

na = naranja-orange-orange  
 r = rojo-red-rouge  
 m = marron-brown-marron  
 n = negro-black-noir  
 rs = rosa-pink-rose  
 vi = violeta-violet-violette

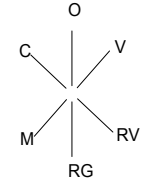

|            |            |
|------------|------------|
| Mode       | OFF        |
| VAPOR      | REG. VAPOR |
| REGENERAC. | MIXTO      |
| CONVECCION |            |

- IP = Interruptor puerta
- IG = Interruptor general
- F = Fusible
- CM = Contactor motor
- VDV = Electroválvula calderin
- DN = Detector de nivel
- FM1 = Térmico motor
- Tsv = Termostato seguridad vapor
- Tsc = Termostato seguridad cámara
- Lz = Luz interior
- IR = Selector regulador sonda nucleo
- RTS = Regulador temperatura sonda nucleo
- RV = Resistencias vapor
- VE = Ventilador cuadro eléctrico
- Ta = Timbre avisador
- Tp = Temporizador
- Rp: Relé puerta

- ET = Electroimán de apertura de tiro
- Ic = Selector de potencia
- VCN = Electroválvula de condensación de vapor
- TC = Termostato cámara
- T100 = Termostato fijo 100°C
- TV = Termostato vapor
- M1 = Motor
- CC1 CC2 = Contactor resistencia cámara
- CV1 CV2 = Contactor resistencia vapor
- CK1, Ck2, K1, K2 = Relé resistencias
- TCN = Termostato de condensacion de vapor
- RC = Resistencias cámara
- TRF = Transformador
- L1 = Lámpara de funcionamiento
- L2 = Lámpara de calentamiento vapor
- L3 = Lámpara de calentamiento cámara

|            |               |          |
|------------|---------------|----------|
| Nº         | Pieza         |          |
| Nº         | Modificacion  |          |
| 1          | Introducir RP |          |
| Firma      |               |          |
| Fecha      |               |          |
| Dibujado   | Iratxe        | 13/11/98 |
| Proyectado |               |          |
| Comprobado |               |          |
| Escala     |               |          |

Plano hau ez daiteke erabil ez berizita

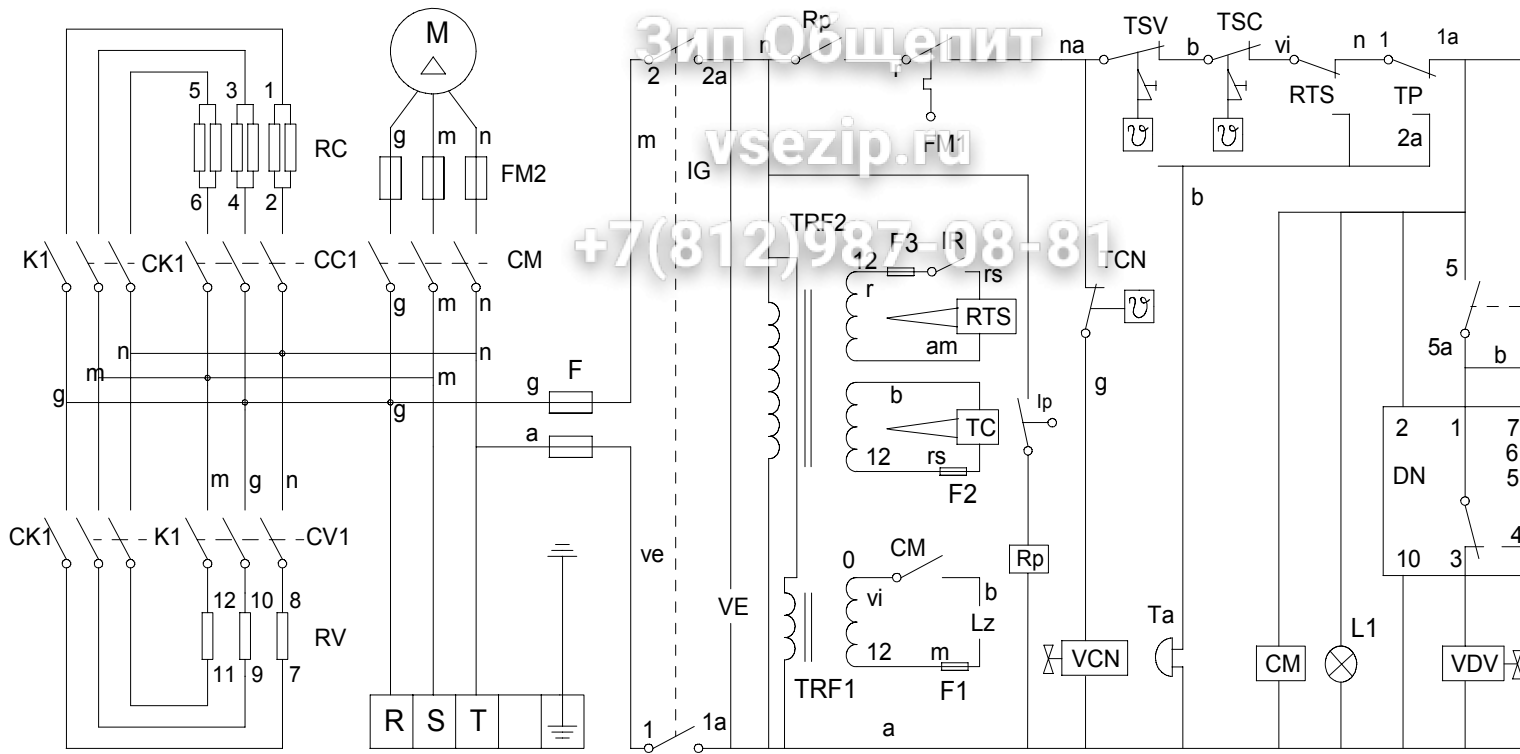

- FM2 = Motor fuse
- IP = Door's switch
- IG = General switch
- F = Fuse
- CM = Motor's relay
- VDV = Steamer's solenoid
- DN = Water level control
- FM1 = Motor's thermal protection
- TSV = Steamer's security thermostat
- TSC = Convection's security thermostat
- LZ = Indoor light
- IR = Probe selector
- RTS = Probe controller
- RV = Steamer elements

- ET = Chimney solenoid
- VCN = Steamer condenser solenoid
- Ta = Alarm
- Tp = Manual Timer
- F1, F2, F3 = Transformer fuse
- TRF1 = Transformer (Indoor light)
- L1 = Pilot lamp (on/off)
- L2 = Pilot lamp (Heating water)
- L3 = Pilot lamp (Heating air)
- Rp = Door's Relay

- VE = Control panel's fan
- Ta = Alarm
- Tp = Manual Timer
- F1, F2, F3 = Transformer fuse
- TRF1 = Transformer (Indoor light)
- L1 = Pilot lamp (on/off)
- L2 = Pilot lamp (Heating water)
- L3 = Pilot lamp (Heating air)
- Rp = Door's Relay

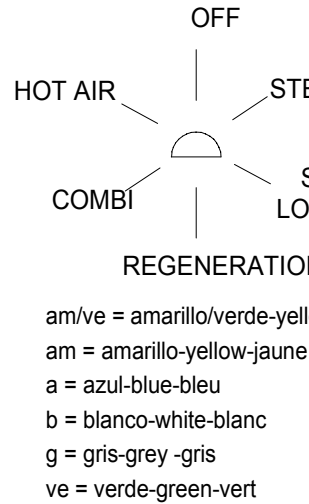

3N 60Hz 208/220/240V

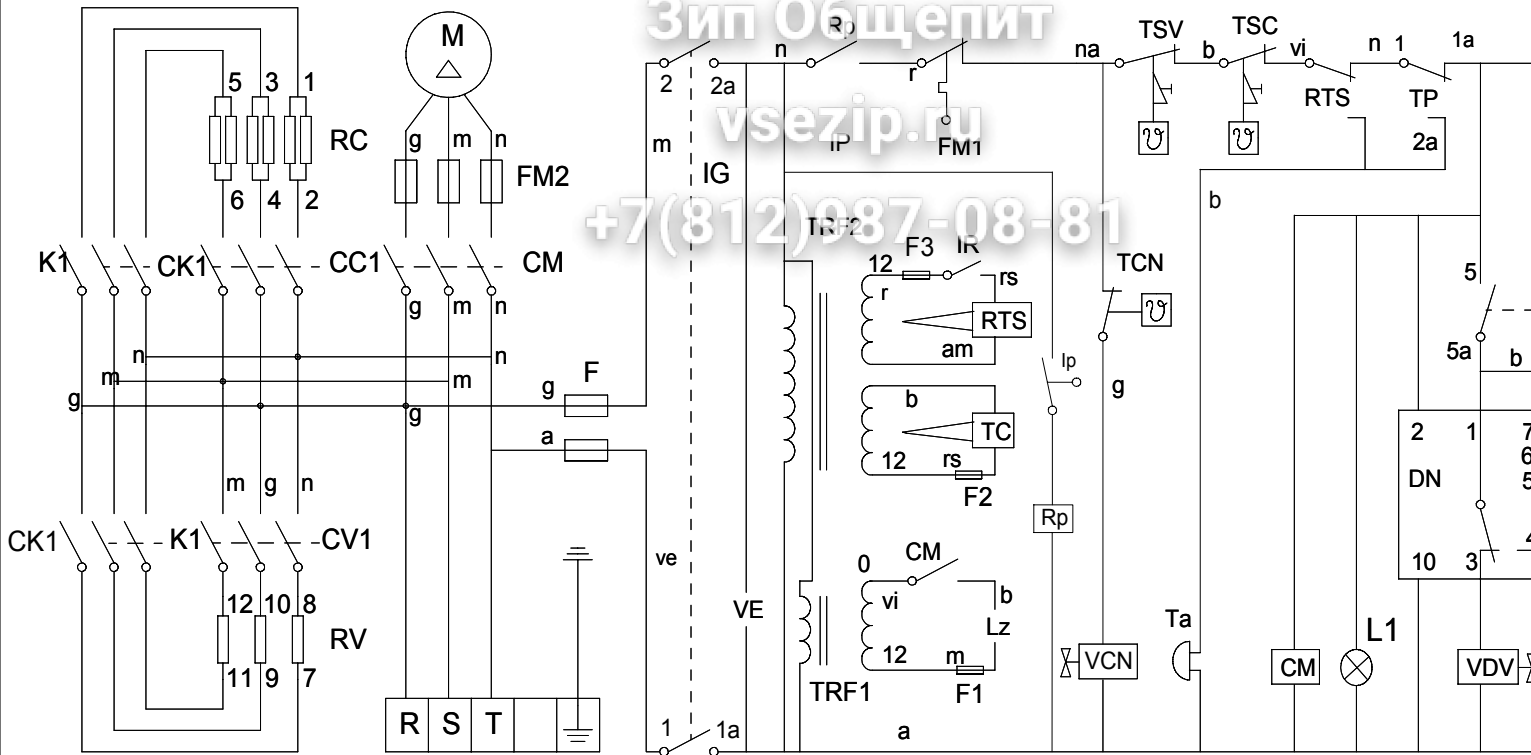

- FM2 = Motor fuse
- IP = Door's switch
- IG = General switch
- F = Fuse
- CM = Motor's relay
- VDV = Steamer's solenoid
- DN = Water level control
- FM1 = Motor's thermal protection
- TSV = Steamer's security thermostat
- TSC = Convection's security thermostat
- LZ = Indoor light
- IR = Probe selector
- RTS = Probe controller

- RV = Steamer elements
- ET = Chimney solenoid
- VCN = Steamer condenser solenoid
- TC = Convection thermostat
- T100 = 100 °C thermostat
- TV = Steamer's thermostat
- M = Motor
- CC1 = Heating air relays
- CV1 = Heating water relays
- CK1, K1 = Elements relays
- TCN = Steam condenser thermostat
- RC = Heating element
- TRF2 = Transformer (Electronic thermostat)

- VE = Control panel's fan
- Ta = Alarm
- Tp = Manual Timer
- F1, F2, F3 = Transformer fuse
- TRF1 = Transformer (Indoor light)
- L1 = Pilot lamp (on/off)
- L2 = Pilot lamp (Heating water)
- L3 = Pilot lamp (Heating air)
- Rp = Door's Relay

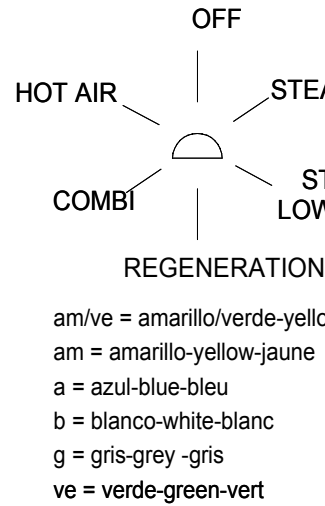

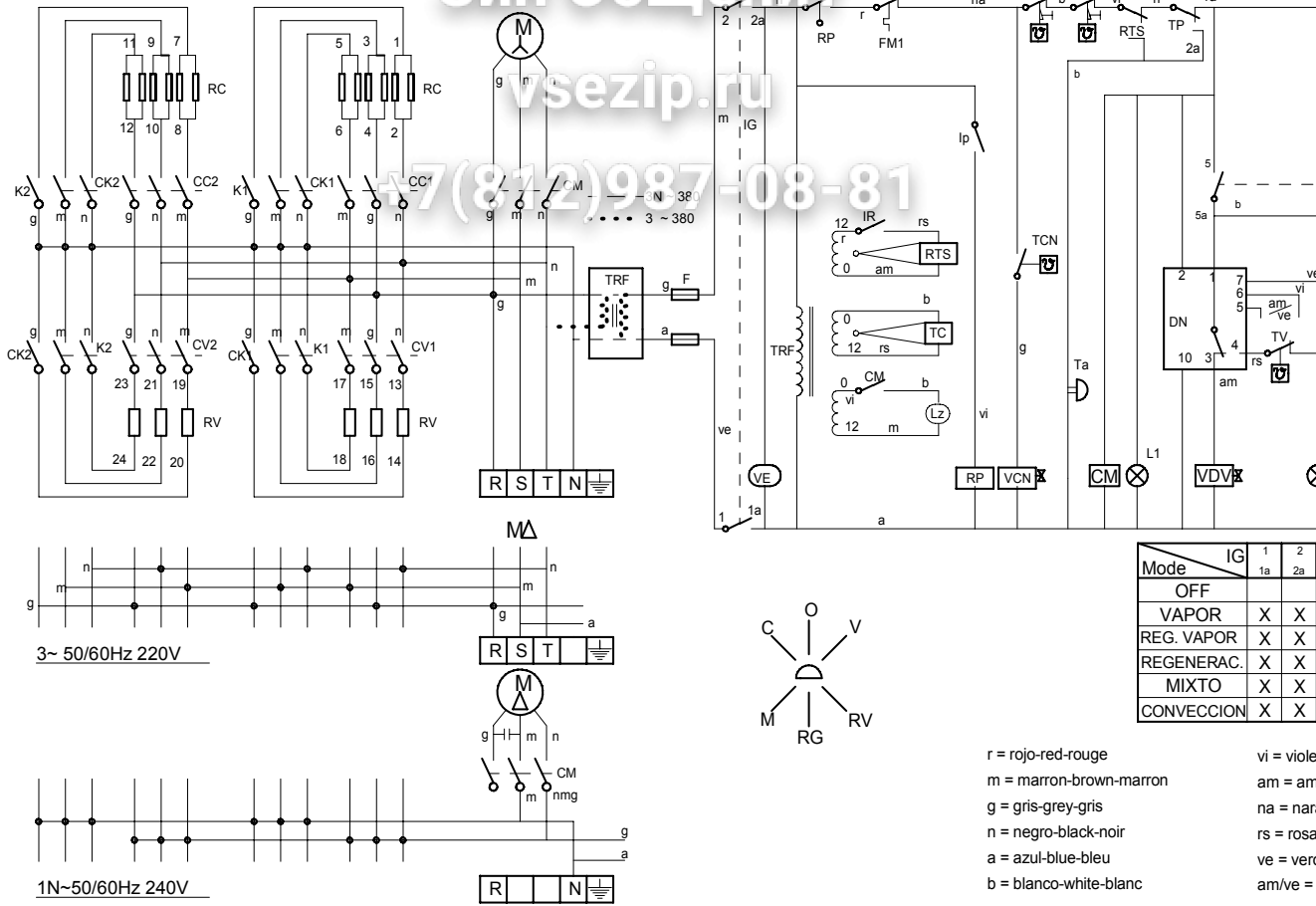

Зип Общелит  
 vsezip.ru  
 7(812)987-08-81

| Mode       | IG | 1  | 2  |
|------------|----|----|----|
|            |    | 1a | 2a |
| OFF        |    |    |    |
| VAPOR      | X  | X  |    |
| REG. VAPOR | X  | X  |    |
| REGENERAC. | X  | X  |    |
| MIXTO      | X  | X  |    |
| CONVECCION | X  | X  |    |

r = rojo-red-rouge  
 m = marron-brown-marron  
 g = gris-grey-gris  
 n = negro-black-noir  
 a = azul-blue-bleu  
 b = blanco-white-blanc

vi = viole  
 am = am  
 na = nar  
 rs = rosa  
 ve = ver  
 am/ve =

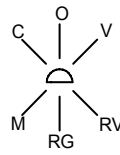

IP = Interruptor puerta  
 IG = Interruptor general  
 F = Fusible  
 CM = Contactor motor  
 VDV = Electroválvula calderin  
 DN = Detector de nivel  
 FM1 = Térmico motor  
 Tsv = Termostato seguridad vapor  
 Tsc = Termostato seguridad cámara  
 Lz = Luz interior  
 VE = Ventilador cuadro eléctrico  
 Ta = Timbre avisador  
 Tp = Temporizador  
 Rp: Relé puerta

ET = Electroimán de apertura de tiro  
 Ic = Selector de potencia  
 VCN = Electroválvula de condensación de vapor  
 TC = Termostato cámara  
 T100 = Termostato fijo 100°C  
 TV = Termostato vapor  
 M1 = Motor  
 CC1 CC2 = Contactor resistencia cámara  
 CV1 CV2 = Contactor resistencia vapor  
 CK1, Ck2, K1, K2 = Relé resistencias  
 TCN = Termostato de condensacion de vapor  
 RC = Resistencias cámara  
 TRF = Transformador  
 L1 = Lámpara de funcionamiento  
 L2 = Lámpara de calentamiento vapor  
 L3 = Lámpara de calentamiento cámara

MEDIDAS 225X127

|   |               |         |
|---|---------------|---------|
| Esquema teórico adhesivo                |               |         |
| Nº                                      | Pieza         |         |
| Nº                                      | Modificacion  |         |
| 1                                       | Introducir RP |         |
| Firma                                   |               | Fecha   |
| Dibujado                                | KONTXI        | 11/9/98 |
| Proyectado                              |               |         |
| Comprobado                              |               |         |
| Escala                                  | H             |         |
| Plano hau ez daiteke erabil ez berizita |               |         |

vsezip.ru  
 (812) 987-08-81

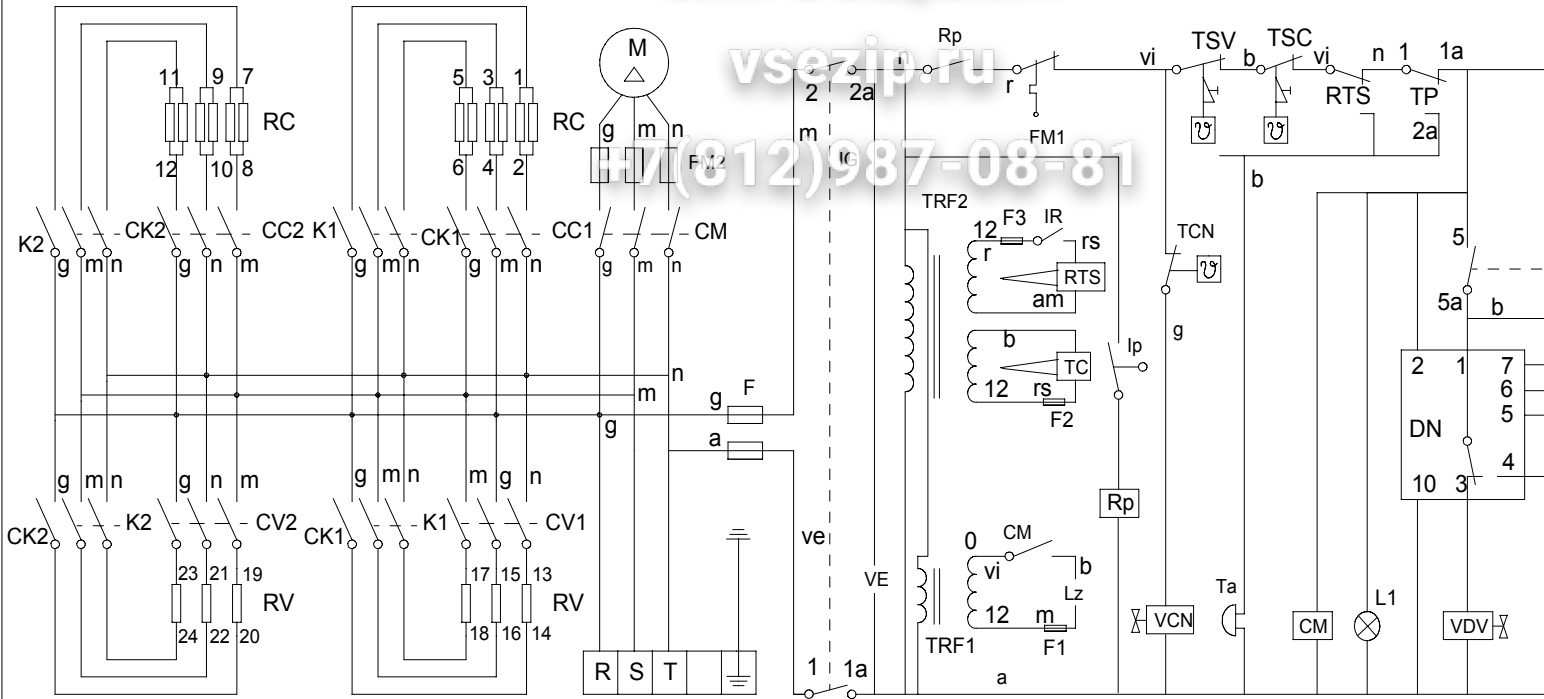

- FM2 = Motor fuse
- IP = Door's switch
- IG = General switch
- F = Fuse
- CM = Motor's relay
- VDV = Steamer's solenoid
- DN = Water level control
- FM1 = Motor's thermal protection
- TSV = Steamer's security thermostat
- TSC = Convection's security thermostat
- LZ = Indoor light
- IR = Probe selector
- RTS = Probe controller
- RV = Steamer elements

- ET = Chimney solenoid
- Ic = Power reduction switch
- VCN = Steamer condenser solenoid
- TC = Convection thermostat
- T100 = 100 °C thermostat
- TV = Steamer's thermostat
- M = Motor
- CC1, CC2 = Heating air relays
- CV1, CV2 = Heating water relays
- CK1, CK2, K1, K2 = Elements relays
- TCN = Steam condenser thermostat
- RC = Heating element
- TRF2= Transformer (Electronic thermostat)

- VE = Control panel's fan
- Ta = Alarm
- TP = Manual Timer
- F1, F2, F3 = Transformer fuse
- TRF1 = Transformer (Indoor light)
- L1 = Pilot lamp (on/off)
- L2 = Pilot lamp (Heating water)
- L3 = Pilot lamp (Heating air)
- Rp = Door's Relay

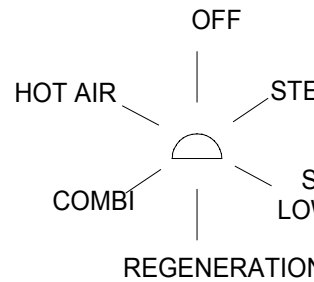

- am/ve = amarillo/verde-yellow-green
- am = amarillo-yellow-jaune
- a = azul-blue-bleu
- b = blanco-white-blanc
- g = gris-grey -gris
- ve = verde-green-vert

Зип Общепит

vsezip.ru  
+7(812)987-08-81

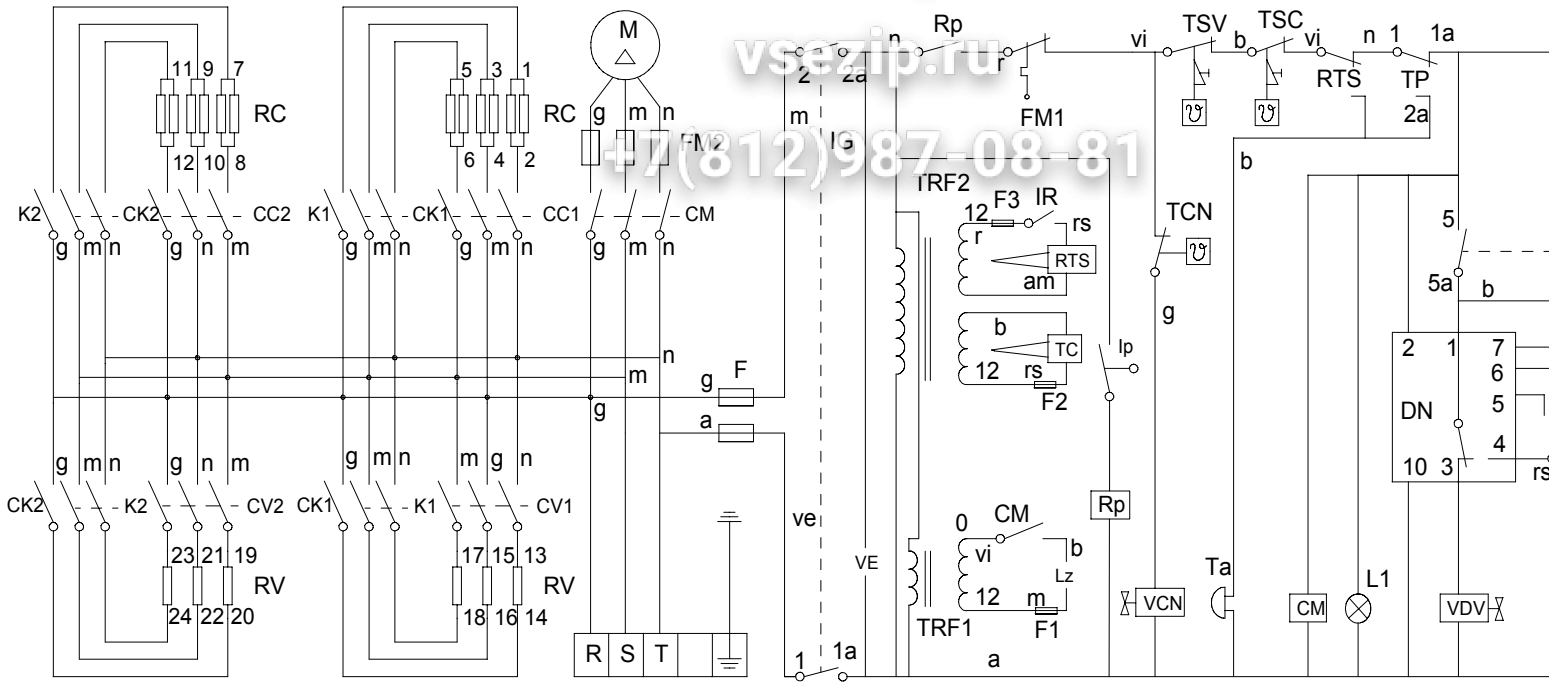

- FM2 = Motor fuse
- IP = Door's switch
- IG = General switch
- F = Fuse
- CM = Motor's relay
- VDV = Steamer's solenoid
- DN = Water level control
- FM1 = Motor's thermal protection
- TSV = Steamer's security thermostat
- TSC = Convection's security thermostat
- LZ = Indoor light
- IR = Probe selector
- RTS = Probe controller
- RV = Steamer elements

- ET = Chimney solenoid
- Ic = Power reduction switch
- VCN = Steamer condenser solenoid
- TC = Convection thermostat
- T100 = 100 °C thermostat
- TV = Steamer's thermostat
- M = Motor
- CC1, CC2 = Heating air relays
- CV1, CV2 = Heating water relays
- CK1, CK2, K1, K2 = Elements relays
- TCN = Steam condenser thermostat
- RC = Heating element
- TRF2 = Transformer (Electronic thermostat)

- VE = Control panel's fan
- Ta = Alarm
- Tp = Manual Timer
- F1, F2, F3 = Transformer fuse
- TRF1 = Transformer (Indoor light)
- L1 = Pilot lamp (on/off)
- L2 = Pilot lamp (Heating water)
- L3 = Pilot lamp (Heating air)
- Rp = Door's Relay

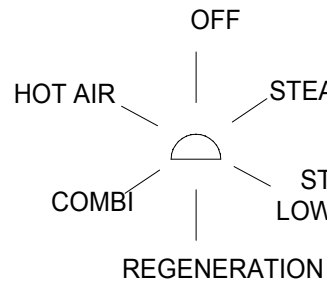

- am/ve = amarillo/verde-yellow/green
- am = amarillo-yellow-jaune
- a = azul-blue-bleu
- b = blanco-white-blanc
- g = gris-grey -gris
- ve = verde-green-vert



vsezip.ru  
7(812)987-08-81

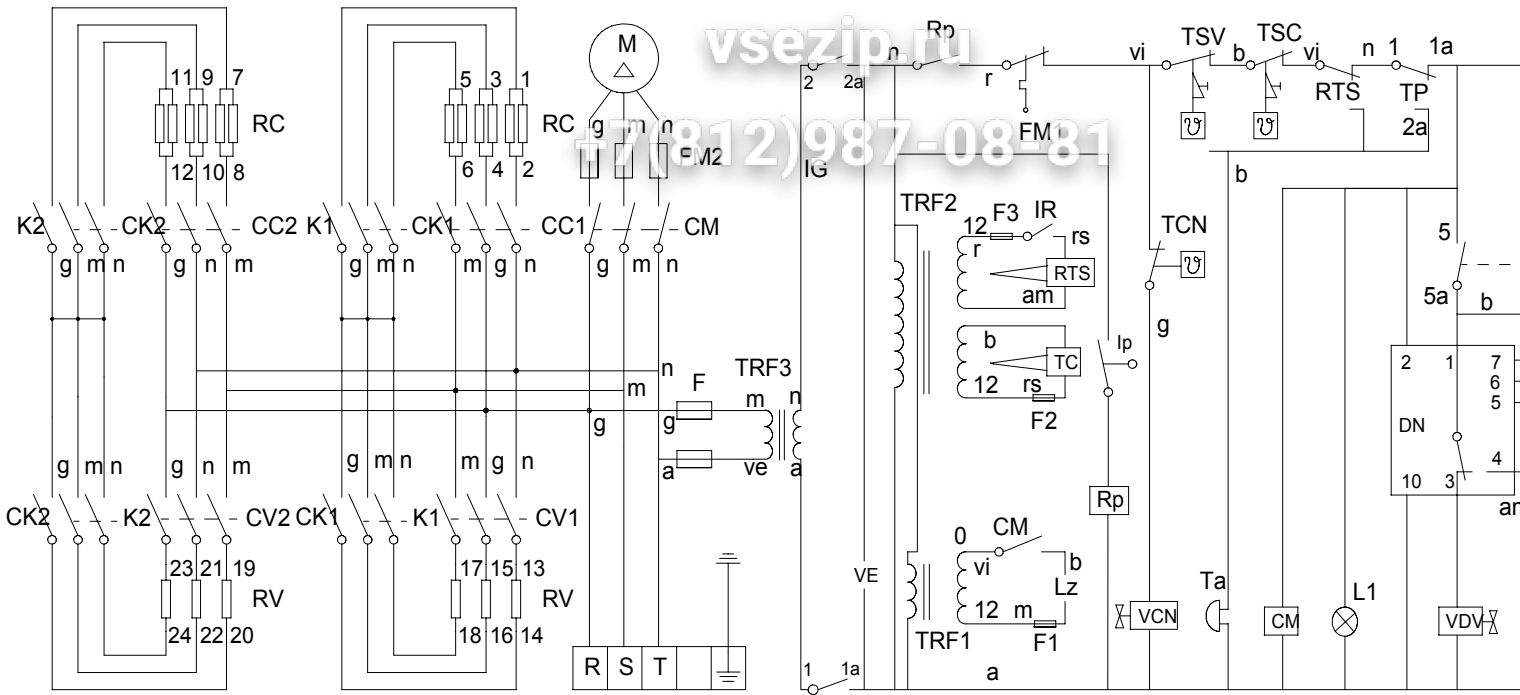

- FM2 = Motor fuse
- IP = Door's switch
- IG = General switch
- F = Fuse
- CM = Motor's relay
- VDV = Steamer's solenoid
- DN = Water level control
- FM1 = Motor's thermal protection
- TSV = Steamer's security thermostat
- TSC = Convection's security thermostat
- LZ = Indoor light
- IR = Probe selector
- RTS = Probe controller
- RV = Steamer elements

- ET = Chimney solenoid
- Ic = Power reduction switch
- VCN = Steamer condenser solenoid
- TC = Convection thermostat
- T100 = 100 °C thermostat
- TV = Steamer's thermostat
- M = Motor
- CC1, CC2 = Heating air relays
- CV1, CV2 = Heating water relays
- CK1, CK2, K1, K2 = Elements relays
- TCN = Steam condenser thermostat
- RC = Heating element
- TRF2= Transformer (Electronic thermostat)

- VE = Control panel's fan
- Ta = Alarm
- TP = Manual Timer
- F1, F2, F3 = Transformer fuse
- TRF1 = Transformer (Indoor light)
- L1 = Pilot lamp (on/off)
- L2 = Pilot lamp (Heating water)
- L3 = Pilot lamp (Heating air)
- TRF3 = Transformer
- Rp = Door's Relay

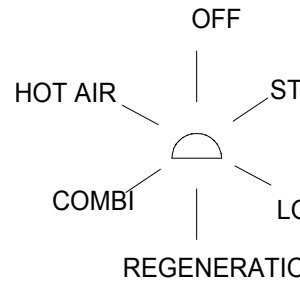

- am/ve = amarillo/verde-yellow/green
- am = amarillo-yellow-jaune
- a = azul-blue-bleu
- b = blanco-white-blanc
- g = gris-grey -gris
- ve = verde-green-vert



Зип Общепит  
 vsezip.ru  
 +7(812)987-08-81

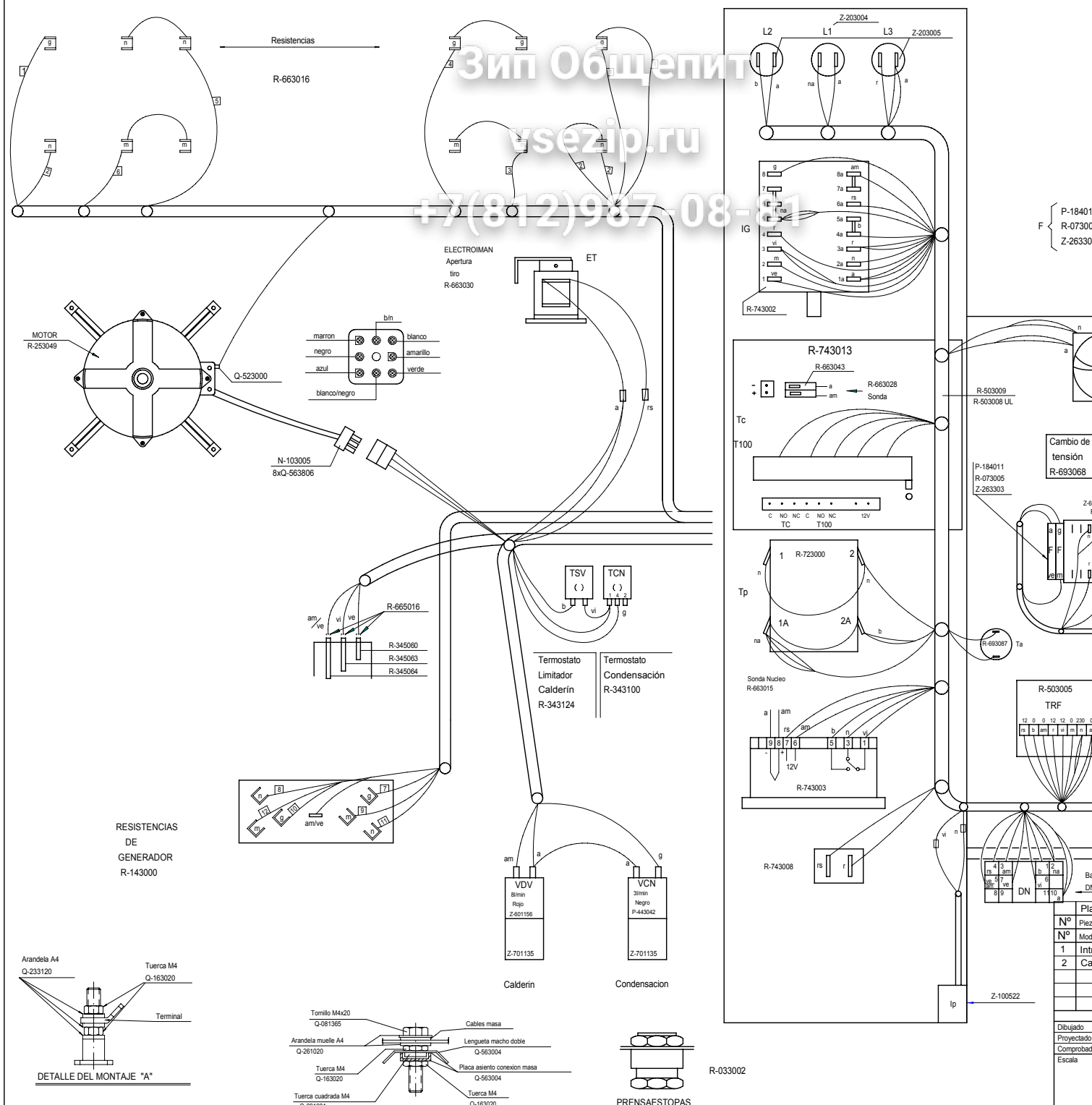

P-184011  
 R-073005  
 Z-263303

Cambio de tensión  
 R-693068

R-503005  
 TRF

| Nº | Pieza | Plan |
|----|-------|------|
| 1  | Intr  |      |
| 2  | Can   |      |

Dibujado  
 Proyectoado  
 Comprobado  
 Escala

Вип Общежит  
 vsevip.ru  
 +7(812)937-08-81

