

Spare parts catalogue

SF. 500 base unit

vsezip.ru

+7(812)987-08-81

| Ref | Description |
|-----|--------------------------------------|
| 1 | Extension for lower table |
| 2 | Lower table |
| 3 | Conveyor belt |
| 4 | Table |
| 5 | Waste drawer |
| 6 | Belt stretching cylinder |
| 7 | Fork for rolling pin |
| 8 | Spacer |
| 9 | Lower table locking handwheel |
| 10 | Table supports |
| 11 | Electric box cover |
| 12 | Electric box |
| 13 | Frame |
| 14 | Foot adjustment |
| 15 | Foot adjustment wheel |
| 16 | Wheel |
| 17 | Wheel spacer |
| 18 | Belt tension rod |
| 19 | Motor support |
| 20 | Electric motor |
| 21 | Motor fulcrum pin |
| 22 | Motor pulley |
| 23 | Side closing panel |
| 24 | Pedal |
| 25 | Pedal lever |
| 26 | Microswitch to invert pedal movement |
| 27 | Table fulcrum rod |
| 28 | Pedal control guard |
| 29 | Side closing panel |

vsezip.ru

+7(812)987-08-81

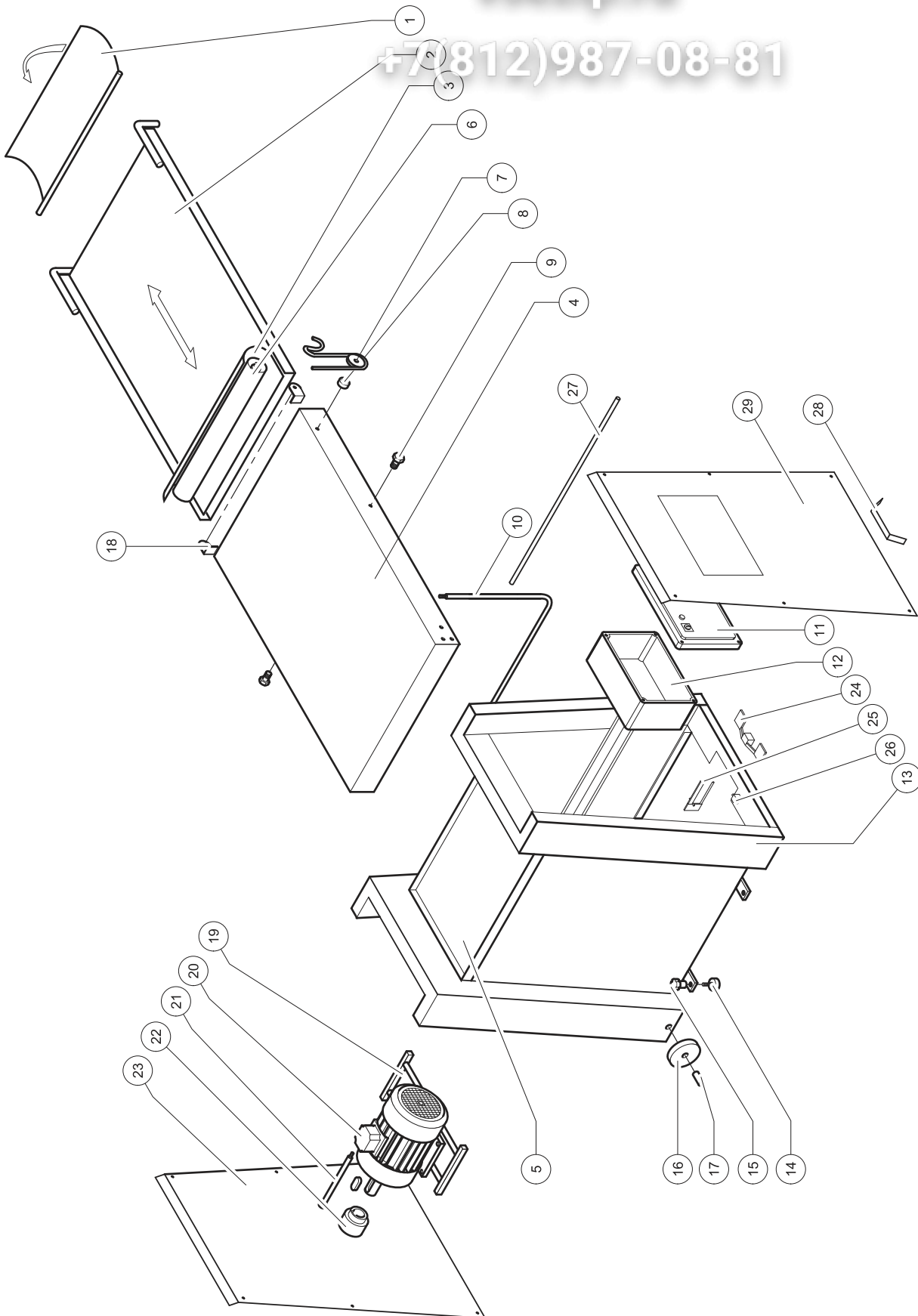

SF. 500 head unit

vsezip.ru

| Ref | Description |
|-----|-------------------------------|
| 1 | Right hand frame |
| 2 | Left hand frame |
| 3 | Right hand panel |
| 4 | Left hand panel |
| 5 | Flange |
| 6 | Bearing 6004 2RS |
| 7 | Seeger ring |
| 8 | Spacer |
| 9 | Freewheel Z=16 1/2" x 1/8" |
| 10 | Threaded pinion |
| 11 | Double screw |
| 12 | Double crown Z=16 1/2" x 1/8" |
| 13 | Washer |
| 14 | Spacer |
| 15 | Rubber gasket |
| 16 | Bushing for connecting rod |
| 17 | Lifting shaft |
| 18 | Cylinder movement lever |
| 19 | Grid rod |
| 20 | Bushing |
| 20b | Eccentric bushing |
| 21 | Right hand connecting rod |
| 22 | Upper scraper shaft holder |
| 23 | Upper scraper |
| 24 | Lifting shaft protection |
| 25 | Spacer |
| 26 | Bowl support |
| 27 | Protection grid |
| 28 | Fixed cylinder |
| 29 | Lower scraper |
| 30 | Lower scraper tension spring |
| 31 | Scraper location sector |
| 32 | Spacer |
| 33 | Pinion Z=16 3/8" |
| 34 | V belt A58 |
| 35 | Pulley |

| Ref | Description |
|-----|-------------------------------------|
| 35 | Left connecting rod |
| 37 | |
| 38 | Lifting shaft |
| 39 | Connecting movement rod |
| 40 | Bushing for connecting rod |
| 41 | Spring |
| 42 | Seeger ring |
| 43 | Bearing 6005 2RS |
| 44 | Double crown Z=35 |
| 45 | Chain tightener |
| 46 | Lifting shaft bushing |
| 47 | Spacer |
| 48 | Grid closing microswitch |
| 49 | Spring |
| 50 | Microswitch plate |
| 51 | Manual movement reverse microswitch |
| 52 | Limit switch lever |
| 53 | Handwheel |
| 54 | Toothed sector |
| 55 | Handle |
| 56 | Lever |
| 57 | Handle spring |
| 58 | Microswitch spacer |
| 59 | Manual movement reverse control rod |
| 60 | Manual control knob |
| 61 | R.H belt drive cylinder |
| 62 | L.H belt drive cylinder |
| 63 | Mobile cylinder |
| 64 | Idle pinion |
| 65 | Limit switch sector lever |

vsezip.ru

+7(812)98708-81

