



MODELO / MODEL

MINEX

Nr. Desde/from 333375 hasta/to

Rev 03

INDICE / INDEX

Vista explosionada/Exploded view.....	Pag 2
Lista de piezas/ Part list.....	Pag 3
Esquema electrónico/Electronic diagram	Pag 8

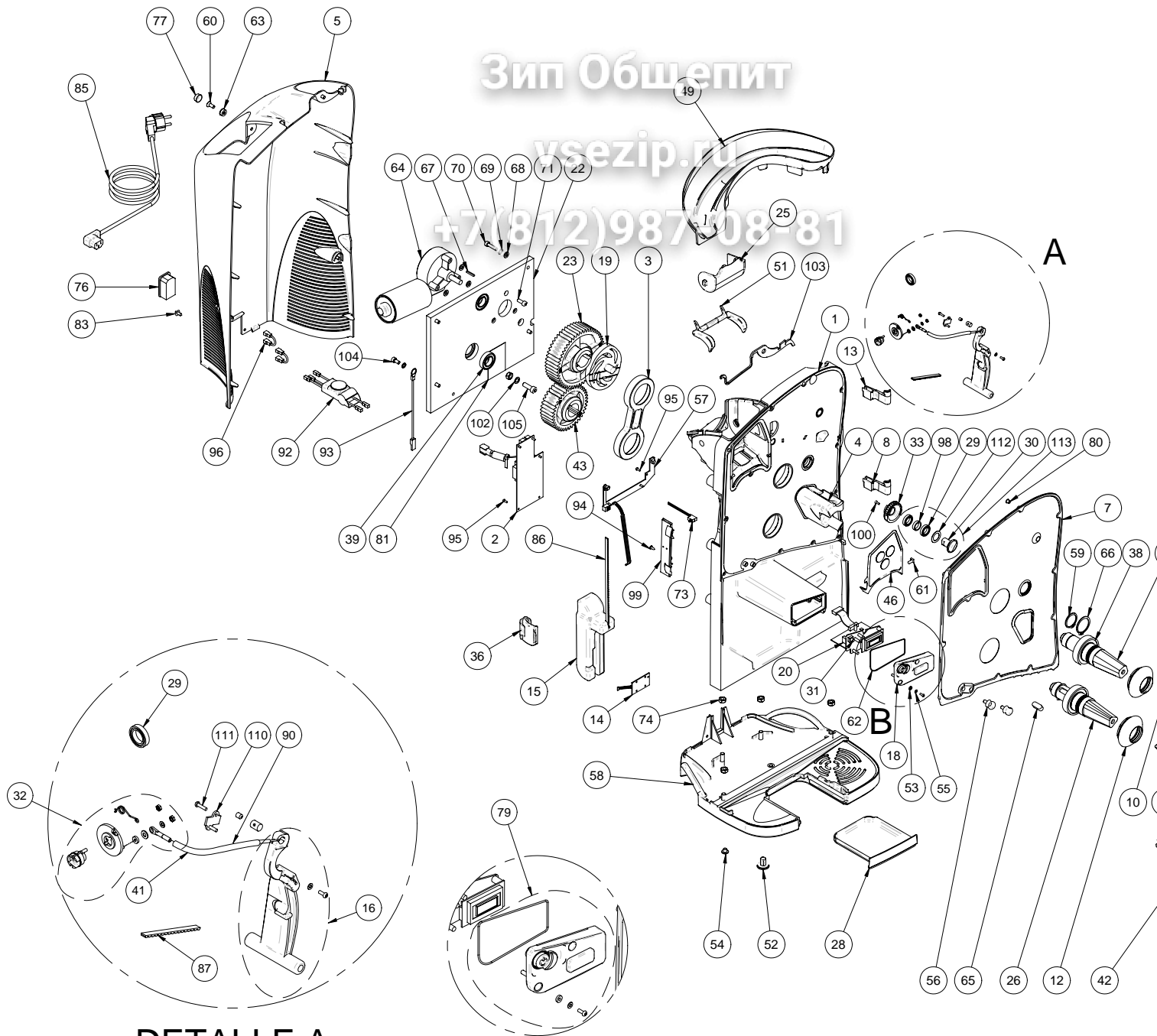

DETALLE A

DETALLE B

NÚMERO DE PIEZA PART NUMBER	REFERENCIA REFERENCE	COMPUESTO POR COMPOSED BY	DESCRIPCION	DESCRIPTION
1	33.1034.000		Modulo Bastidor MX	Plastic frame module MX
		1 Ud / 13.962.001	Bastidor MX	Plastic frame MX
		2 Ud / 225.3320.000	Soporte cuña extractora	Pell ejectors pivot holders
		4 Ud / 180.0038.000	Tareinsert autoroscante	Tareinsert self-screwing M6 brass
		1 Ud / 13.961.001	Frontal inox con juntas MX	S.S. Front plate w/rings MX
		1 Ud / 210.0033.100	Soporte fijo volteador MX	Twirler blade bracket MX
		1 Ud / 210.0029.001	Arrastre exterior	Outer pulling dispenser
		1 Ud / 210.0023.001	Arrastre interior MX	Pulling dispenser MX
		1 Ud / 210.0045.001	Resorte arrastre alimentador MX	Feeder dispenser spring MX
		2 Ud / 100.1901.003	Tuerca DIN 934 M3 I	DIN 934 M3 I nut
		1 Ud / 140.0902.015	Rodamiento 6802 2RS Inox	Bearing 6802 2RS Inox
		2 Ud / 210.0018.000	Eje puerta MX	MX feeder door pivot
		1 Ud / 13.967.000	Tubo guia MX	Steel cable guide tube
		1 Ud / 13.964.100	Kit cable rotula MX	Steel feeder cable set MX
		3 Ud / 100.0919.026	Tornillo DIN 7981 B 3,5 x 13 Inox	DIN 7981 B 3,5 x 13 I screw
		11 Ud / 180.0032.000	Expansionador Heyco 072 5899	Expansible thread heyco
		1 Ud / 210.0074.000	Juego de juntas MX	MX Joint set
1 Ud / 105.0910.003	Arandela DIN 125 D3 I	DIN 125 D3 I washer		
2	33.1025.000		Modulo potencia MX	Main control board MX
		1Ud / 13.612.002	Modulo potencia MX	Main control board MX
		1Ud / 155.0039.000	Brida sujeta cables	Plastic clamp
3	210.0046.000		Refuerzo en ocho	Bearing "8" housing MX
4	33.1032.000		Soporte fijo volteador MX	Twirler blade bracket MX
5	210.0008.000		Tapas trasera verde MX (5)	Plastic rear cover green MX (5)
	13.928.000		Tapas trasera plata MX (6)	Plastic rear cover silver MX (6)
	210.0082.000		Tapas trasera naranja MX (7)	Plastic rear cover orange MX (7)
6	33.1006.000		Cubierta MX	Cover MX
7	13.961.001		Frontal inox con juntas MX	S.S. Front plate w/rings MX
8	210.0011.000		Bisagra B MX	Plastic hinge "B" MX
9	33.1007.000		Cubeta zumo MX	Filter tray MX
10	33.1041.000		Soporte cuchilla volteador inox MX	Twirler blade support inox MX
11	33.1008.000		Jarra verde MX (5)	Jar green MX (5)
	33.1037.000		Jarra plata MX (6)	Jar silver MX (6)
	33.1038.000		Jarra naranja MX (7)	Jar orange MX (7)
12	210.0002.000		Reten eje MX	Shaft Fastener MX

13	210.0054.000		Bisagra A MX	Plastic hinge "A" MX
14	13.614.002		Modulo posicionamiento MX	Stance offset board MX
15	33.1028.000		Peso MX	Internal offset plate MX
16	33.1030.000		Balancin MX	Rocker arm MX
		1 Ud / 210.0030.001	Balancin MX	Rocker arm MX
		1 Ud / 105.0910.003	Arandela DIN 125 D3 I	DIN 125 D3 I washer
		1 Ud / 100.0980.009	Torn para placas RFX 81T 3 x 8	Rfx 81T 3 x 8 screw
17	210.0041.001		Eje tambor hembra MX	Upper pressing shaft MX
18	210.0027.001		Tapa botonera MX	Keyboard cover MX
19	13.960.002		Leva piñon MX	Gear Lever MX
20	33.1033.000		Modulo botonera MX	Keyboard module MX
21	33.1010.000		Cubeta de cortezas verde MX (5)	Pell bucket green MX (5)
	33.1035.000		Cubeta de cortezas plata MX (6)	Pell bucket silver MX (6)
	33.1036.000		Cubeta de cortezas naranja MX (7)	Pell bucket orange MX (7)
22	210.0039.001		Soporte Motor MX	Motor plate bracket MX
23	210.3301.002		Piñon grande plastico	Big plastic gear
24	33.1020.100		Pulsador grifo MX	Faucet pusher MX
25	33.1003.000		Dosificador MX	Dispenser MX
26	210.0040.001		Eje tambor macho	Lower pressing shaft MX
27	33.1018.100		Pistón grifo MX	Faucet MX
28	33.1011.000		Bandeja goteo MX	Brip Tray MX
29	140.0902.015		Rodamiento 6802 2RS Inox	Bearing 6802 2RS Inox
30	13.931.000		Eje rotor MX	Twirler blade Shaft MX
31	210.0076.000		Actuador pulsador ON/OFF MX	ON_OFF Minex button
32	33.1026.000		Kit arrastre dosificador MX	MX dispenser driver
		1 Ud / 210.0023.001	Arrastre interior MX	Pulling dispenser MX
		1 Ud / 210.0029.001	Arrastre exterior	Outer pulling dispenser
		1 Ud / 210.0045.001	Resorte arrastre alimentador MX	Feeder dispenser spring MX
		2 Ud / 100.1901.003	Tuerca DIN 934 M3 I	DIN 934 M3 I nut
		1 Ud / 105.0910.003	Arandela DIN 125 D3 I	DIN 125 D3 I washer
		1 Ud / 105.0910.004	Arandela DIN 125 D4 I	DIN 125 D4 I washer
1 Ud / 210.0088.000	Junta plana silicona 7,5 x 3 x 2	Silicon gasket 7,5 x 3 x 2		
33	210.0025.000		Rotor MX	Twirler blade rotor
34	210.0044.100		Eje retenedor MX	Support pivot shaft
35	33.1040.000		Cuchilla volteador inox MX	Inox twirler blade MX
36	33.1042.000		Kit cierre MX	Kit lock MX
		1 Ud / 210.0086.000	Cierre cubierta plastico MX	Front cover lock MX
		1 Ud / 210.0087.000	Base cierre cubierta MX	Front cover lock holder MX
		2Ud/ 100.0980.010	Tornillo RFX 81T 3 x 12	Screw RFX 81T 3 x 12
37	33.1015.000		Tambor hembra plastico MX	Upper pressing unit MX
38	33.0011.000		Kit rodamientos 6007	6007 2RS bearing kit
		2 Ud / 140.0201.035	Rodamiento 6007 2RS	6007 2RS bearing

39	140.0202.020		Rodamiento 61904 2RS	Bearing 61904 2RS
40	33.0031.000		Tambor macho plástico	Orange lower pressing unit
41	13.967.000		Tubo guía MX	Steel cable guide tube
42	33.0002.000		Cuña extractora izquierda	Left peel ejector
43	210.3302.001		Piñon pequeño plástico	Small plastic gear
44	33.1021.100		Junta grifo MX	Faucet rubber ring MX
46	33.1001.000		Puerta alimentador MX	Feeder door MX
47	33.1005.000		Retenedor MX	Bolcker MX
48	33.0003.001		Kit volantes exprimi TPE	TPE securing knob kit
		2 Ud / 200.3306.004	Volante plastico inyección	Securing knob
49	33.1004.000		Rampa alimentador MX	Feeder ramp MX
50	33.1009.000		Filtro cubeta zumo MX	Filter MX
51	33.1002.000		Contrapeso MX	Counterweight MX
52	32.1025.000		Pies MX	Feet MX
53	210.0088.000		Junta plana silicona 7,5 x 3 x 2	Silicon gasket 7,5 x 3 x 2
54	180.0033.000		Tapón	GPN 300 F3 plastic plug
55	105.0910.003		Arandela DIN 125 D3 I	DIN 125 D3 I washer
56	33.0006.000		Kit soportes pivotes cuñas ext	Pell ejectors pivot holders kit
		2 Ud / 225.3320.000	Soporte cuña extractora	Pell ejectors pivot holders
57	13.613.001		Barrera alimentador MX	Feeder barrier board MX
58	13.968.101		Conjunto Base MX	Base set MX
		1 Ud / 210.0012.100	Base MX	MX Base
		1 Ud / 210.0049.000	Tapa base MX	MX Base cover
		7 Ud / 100.0919.025	Tornillo DIN 7981 B 2,9 x 13 Inox	DIN 7981 B 2,9 x 13 I screw
		4 Ud / 100.0909.130	Tornillo DIN 7991 M8 x 35 I	DIN 7991 M8 x 35 I screw
59	130.0012.030		Anillo de seguridad DIN 471 E-30	Security ring DIN 471 E-30
60	100.0909.106		Tornillo DIN 7991 M-6x15 I	DIN 7991 M6 X 15 I screw
61	210.0018.000		Eje puerta MX	Feeder door pivot MX
62	210.0053.000		Hilo torico	1,5 x 290 Keyboardcover ring
63	180.0035.000		Arandela Snacap M6 VZK Gris	M6 Snacap washer
64	33.1024.000		Motor MX	Motor MX
		1Ud / 160.0132.000	Motoreductor Bosch MX	MX Bosch motor+Gear Box
		2Ud / 155.0000.003	Pin conector aereo macho MX	Male quick connector pin
		1Ud / 155.0000.002	Conector aereo macho motor MX	Male quick connector motor
		1Ud / 115.0000.002	Chaveta 3X3X22	Bolt 3 x 3 x 22
65	115.0000.015		Chaveta 10x8x25	Bolt 10 x 8 x 25
66	130.0012.035		Anillo de seguridad DIN 471 E-35	Security ring DIN 471 E-35
67	115.0000.002		Chaveta 3X3X22	Bolt 3 x 3 x 22
68	105.0910.006		Arandela DIN 125 M6 Forma A	DIN 125 D6 I washer
69	105.0911.006		Arandela DIN 127 D6 I.	DIN 127 D6 I washer
70	100.0903.108		Tornillo DIN 912 M6 x 25 Inox	DIN 912 M6 X 25 I screw
71	100.0903.106		Tornillo DIN 912 M6 x 16 Inox	DIN 912 M6 X 16 I screw

73	155.0026.000		Micro seguridad MX	Cover safety swith
74	100.1901.008		Tuerca DIN 934 M8 inox	DIN 934 M8 I nut
75	100.1901.006		Tuerca DIN 934 M6 Inox	DIN 934 M6 I nut
76	155.1120.000		Base conexión eléctrica	Power supply socket
77	180.0034.000		Tapón Snapcap MC negro	Black snapcap plug
78	33.1019.000		Muelle pulsador grifo MX	Faucet pusher spring MX
79	33.1046.000		Kit Tapa botonera vIX	Kit Keyboard cover MX
		1Ud/ 210.0027.001	Tapa botonera MX	Keyboard cover MX
		1UD/ 210.0076.000	Actuador pulsador ON/OFF MX	ON_OFF Minex button
		1Ud/ 210.0053.000	Hilo torico	1,5 x 290 Keyboardcover ring
		2Ud/ 105.0910.003	Arandela DIN 125 D3 I	DIN 125 D3 I washer
		3Ud/ 210.0088.000	Junta plana silicona 7,5 x 3 x 2	Silicon gasket 7,5 x 3 x 2
	3Ud/ 100.0980.009	Tornillo RFX 81T 3 x 8	Rfx 81T 3 x 8 screw	
80	180.0032.000		Expansionador Heyco 072 5899	Expansible thread heyco
81	210.0048.000		Protector MX	200 micras plastic plate MX
83	180.0039.000		Expansionador DRR011-BLK	Expansible thread DRR011-BLK
85	155.1140.000		Cable Schuko-IEC acodada (1)	MX schuko 90° p.supply cable (1)
	155.1142.000		Cable GB-IEC acodada (2)	MX GB 90° power supply cable (2)
	155.1141.000		Cable UL-IEC acodada (3)	MX UL 90° power supply cable (3)
	155.1160.000		Cable AUS-IEC acodada (4)	MX AUS-IEC power supply cable (4)
86	33.1029.000		Correa dentada peso MX	Counterweight belt MX
87	210.0042.000		Correa dentada balancin MX	Rocker arm belt MX
90	13.964.100		Kit cable rotula MX	Steel feeder cable set MX
		1 Ud / 210.0055.000	Rotula	Articulation KYEH45
		1 Ud / 210.0056.000	Puntera roscada	Threaded terminal CY180031
		1 Ud / 210.0058.000	Cable de acero	Steal cable19H X 0,3 MM
		1 Ud / 210.0059.000	Funda plástico	Plastic cover 3,3 X 2
		1 Ud / 210.0057.000	Puntera prisionero cable	Screw cable terminal
	1 Ud / 100.0927.081	Esparrago DIN 916 M5 x 5 Inox	DIN 916 M-5x5 I allen rod	
92	13.966.003		Cables y filtro mod de potencia	Electrical inlet filter MX
93	13.971.000		Cable toma de tierra	Ground wire MX
94	100.0919.018		Tornillo DIN 7981 B 3,5 x 9,5 Inox	DIN 7981 B 3,5 x 9,5 I screw
95	100.0980.009		Tor para plas RFX 81T 3 x 8	Rfx 81T 3 x 8 screw
96	13.973.001		Cable puente MX	Electrical Jumper MX
97	33.1039.000		Bloqueo cuchilla MX	Twirler blade blocker MX
98	210.0089.000		Espaciador rodamientos MX	Bearings spacer MX
99	210.0019.003		Auxiliar cierre MX	Front cover lock bracket MX
100	100.0935.043		Tornillo DIN 7985 M3 x 8 I	DIN 7985 M3 X 8 I screw
102	105.0911.008		Arandela DIN 127 D8 Inox	DIN 127 D8 I washer
103	210.0074.000		Juego de juntas MX	MX Joint set
104	100.0903.105		Tornillo DIN 912 M6 x 12 I	DIN 912 M6 x 12 I screw
105	100.0903.128		Tornillo DIN 912 M8 x 25 I	DIN 912 M8 x 25 I screw

107	105.0915.006		Arandela DIN 6798A D6 I	DIN 6798A D6 I washer
110	210.0075.000		Reten cable MX	MX Cable fastener
111	100.0980.010		Tor para plas RFX 81T 3 x 12	RFX 81T 3x12 screw
112	210.0090.000		Arandela sellado rotor SLC MX	Rotor sealing washer SLC MX
113	33.1027.000		Kit eje rotor MX	Kit twirler blade shaft MX
		1 Ud / 13.931.000	Eje rotor MX	Twirler blade Shaft MX
		1 Ud / 170.0503.090	Torico CR 3 x 1	MX 3 X 1 Oring
		1 Ud / 100.0935.043	Tornillo DIN 7985 M3 x 5 I	DIN 7985 M3 X 8 I screw
		1 Ud / 105.0910.004	Arandela DIN 125 D4 I	DIN 125 D4 I washer
		1 Ud / 210.0090.000	Arandela sellado rotor SLC MX	Rotor sealing washer SLC MX
		2 Ud / 140.0902.015	Rodamiento 6802 2RS Inox	Bearing 6802 2RS Inox
	1 Ud / 210.0089.000	Espaciador rodamientos MX	Bearings spacer MX	

(1) MINEX

(2) MINEX MODELO GB / GB MODELS

(3) MINEX MODELO UL / UL MODELS

(4) MINEX MODELO AUS / AUS MODELS

(5) MINEX VERDE / MINEX GREEN

(6) MINEX GRIS PLATA / MINEX SILVER GRAY

(7) MINEX NARANJA / MINEX ORANGE

ESQUEMA ELECTRONICO MINEX
MINEX ELECTRONIC DIAGRAM

vsezip.ru

+7(812)987-08-81

