

Зип Общепит

S 30/A • S 40/A • S 40/TA

vsezip.ru

+7(812)987-08-81



PIZZA ROLLING MACHINE



Operation and maintenance manual

Зип Общепит
vsezip.ru
+7(812)987-08-81

Зип Общепит
S 30/A • S 40/A • S 40/TA
vsezip.ru

+7(812)987-08-81



PIZZA ROLLING MACHINE

CONTENTS

1 GENERAL INFORMATION

| | |
|--|---|
| Purpose of the manual..... | 4 |
| Manufacturer and machine identification..... | 4 |
| Machine descriptions..... | 5 |
| Technical specifications..... | 5 |
| Overall dimensions..... | 6 |
| Safety devices..... | 6 |
| Safety information..... | 7 |
| Residual risks..... | 7 |

2 INSTALLATION INFORMATION

| | |
|------------------------------|---|
| Packaging and unpacking..... | 8 |
| Installation area..... | 8 |
| Electrical connections | 8 |

3 USE AND CLEANING INFORMATION

| | |
|----------------------------------|----|
| Control descriptions..... | 9 |
| Machine use..... | 9 |
| Pedal control..... | 9 |
| Recommendations for use..... | 10 |
| End of the day cleaning..... | 10 |
| Roller blade cleaning..... | 10 |
| Extended periods of disuse | 10 |

4 TROUBLESHOOTING. RECYCLING

| | |
|----------------------------------|----|
| Introduction..... | 11 |
| Problems, causes, solutions..... | 11 |
| Disposal and recycling..... | 11 |

ATTACHMENTS

Spare parts catalogue
Wiring diagram

Purpose of the manual

This manual was written by the Manufacturer and is an integral part of machine equipment. During design and construction the Manufacturer has carefully considered possible hazards and personal risks that may result from interaction with the machine. In addition to observing the specific laws in force, the manufacturer has adopted all “exemplary construction technique principles”. The purpose of this information is to advise the users to adopt extreme caution to avoid risks. However, discretion is invaluable. Safety is also in the hands of all the operators who interact with the machine. Keep this manual in a suitable place, always within reach for consultation. The following symbols are included to better stress some passages:

⚠ DANGER – WARNING: indicates hazards that may cause serious damages; attention is required.

ℹ INFORMATION: indicates particularly important technical information.

The following is enclosed with this manual:

- Warranty certificate describing the Manufacturer's warranty conditions.
- Documents that prove conformity with effective health and safety laws.

Contact the Authorised dealer for any service request, information or spare parts order.

Machine and manufacturer identification

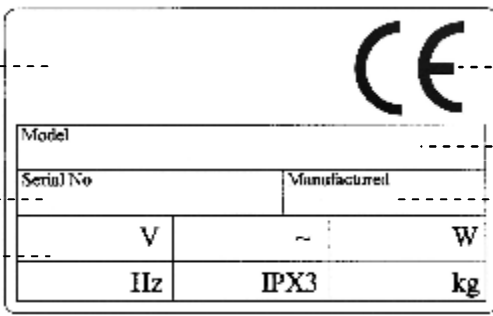
| | | |
|--|--|---|
| <p>Manufacturer Identification -----</p> <p>Serial number -----</p> <p>Technical specifications -----</p> |  | <p>----- Conformity markings</p> <p>----- Machine model</p> <p>----- Year of manufacture</p> |
|--|--|---|

Machine descriptions

+7(812)987-08-81

Mod.S 30/A – S 40/A:

The machine is ideal for rolling pizza dough into a round pie.

The range is made up of 2 different models:

S 30/A (maximum pizza diameter 300mm)

S 40/A (maximum pizza diameter 400mm)

The machine structure is made of easy to clean stainless steel.

It is equipped with safety devices in accordance with European Directives.

Mod. S 40/TA:

The machine is ideal for rolling pizza dough for pan baking.

The range is made up of 1 model:

S 40/TA (maximum pizza width 400mm)

The machine structure is made of easy to clean stainless steel.

It is equipped with safety devices in accordance with European Directives.

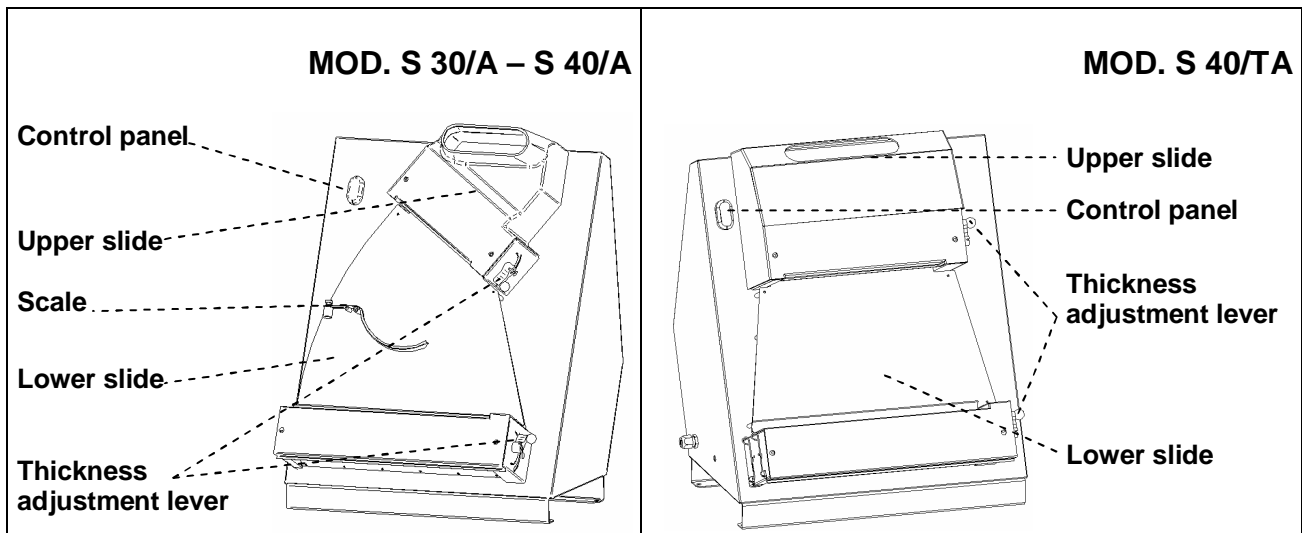

Technical specifications

| Descriptions | Unit of measure | S 30/A | S 40/A | S 40/TA |
|-----------------------------|-----------------|---|------------|------------|
| Power supply | V Hz Ph | 230V 50Hz 1Ph | | |
| Power | kW (HP) | 0.37 (0.5) | 0.37 (0.5) | 0.37 (0.5) |
| Lower roller width | mm | 320 | 420 | 420 |
| Net weight | Kg | 36 | 44 | 43 |
| Packaged weight | Kg | 46 | 54 | 53 |
| Noise level | | Less than 70 dB (A) | | |
| Installation | | Counter | | |
| Protection level | | IPX3 | | |
| Electrical shock protection | | Class I | | |
| Conformity | | 73/23/EEC - 93/68/EEC – 98/37/EEC - 89/336/EEC – 89/109/EEC – 2002/72/EEC | | |

Overall dimensions

+7(812)987-08-81

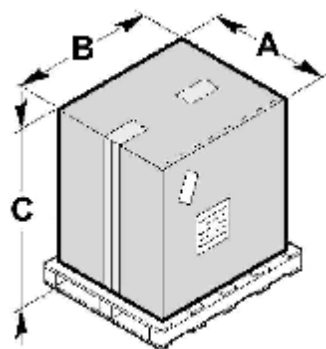
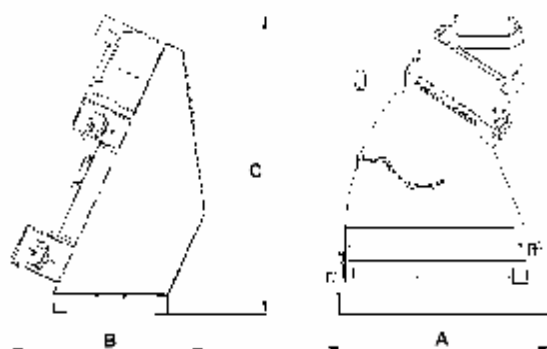
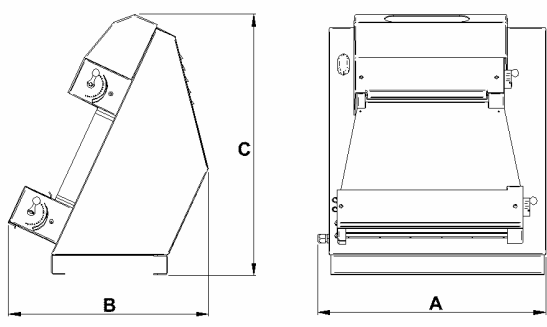
| mm | A | B | C |  |
|---------|-----|-----|-----|--|
| S 30/A | 800 | 650 | 690 | |
| S 40/A | 800 | 650 | 690 | |
| S 40/TA | 800 | 650 | 690 | |
| mm | A | B | C |  |
| S 30/A | 490 | 510 | 640 | |
| S 40/A | 590 | 510 | 760 | |
| mm. | A | B | C |  |
| S 40/TA | 590 | 510 | 700 | |

Safety devices

Roller guards: limit risks of catching upper limbs. Removing them from the appliance is strictly forbidden. The manufacturer is not liable for damages to persons or things due to neglect to observe these instructions.

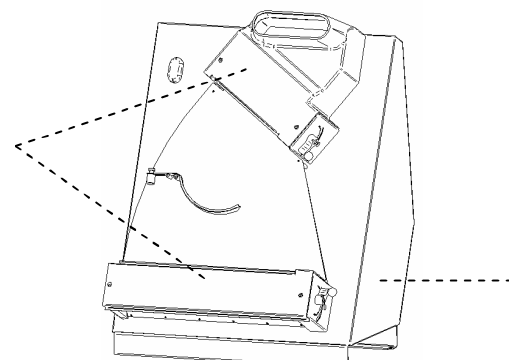

Breaker: in the event of accidental power outage, the machine must be voluntarily restarted.

Safety information

- Careful consultation of this manual before installation and use is essential. Continual observance of the indications found in the manual guarantee personal and machine safety.
- Never tamper with safety devices for any reason.
- Strict observance of the work safety regulations issued by the responsible organisations in each country is strongly recommended.
- The manufacturer is not liable for damages to persons or things due to the neglect of safety regulations.
- Correct machine placement, illumination and cleanliness are important conditions for personal safety.
- Do not expose the machine to the elements.
- Machine connections and start-up must only be performed by specialised technicians.
- Make sure that the system specifications of the room where the machine is installed correspond to the information printed on the plate.
- Make sure the machine is connected to a grounding system.
- The work area around the machine must always be kept clean and dry.
- Use the garments foreseen by work safety regulations.
- This machine must only be used for its specific purpose; any other use is considered improper and therefore hazardous.
- Check the suitability and weight of products to be processed; do not overload the machine.
- Introducing objects, tools, hands or other things within hazardous parts is forbidden.
- Keep the machine away from children.
- Disconnect the power cord from the electrical socket when the machine is not in use.
- In the event of malfunctions and/or problems, do not attempt to repair the machine. Contact the authorised dealer.
- Use original spare parts.
- Before cleaning the machine, disconnect the power supply by unplugging the machine.
- Do not clean with high-pressure jets of water.

Residual risks

In accordance with point 1.7.3 "Residual risk warnings" in Machine Directive 89/392 and further amendments, please note that the safety guards, constructed in accordance with said Directive, do not completely eliminate burning risks to upper limbs.

+7(812)987-08-81

Packing and unpacking

The machine is packaged in cardboard with polyester foam inserts to guarantee full integrity during transport.

- Handle the packaging according to the instructions.
- Open the packaging and check the integrity of all components. Keep packaging for future moves.
- Lift the machine as indicated and place it in the installation area.

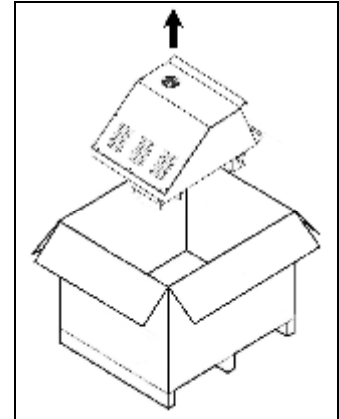
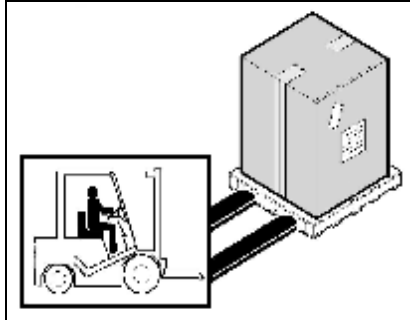

Installation area

The arranged area must be suitably illuminated and an electrical socket must be available. The resting surface must be sufficiently ample, even and dry. The machine must be installed in rooms with non-explosive environments. In any case, installation must also be performed in consideration of the work safety laws in force.

Room conditions table

| Descriptions | Values |
|---------------------|---|
| Working temperature | 0÷35 °C (32÷95 °F) |
| Storage temperature | -15 to +65 °C (from -6.8 to +149 °F) |
| Relative humidity | Maximum 80% with 20 °C room temperature Maximum 50% with room temperature between 20÷60 °C |
| Dustiness | Less than 0.03 g/m ³ |

Electrical connections

⚠ DANGER – WARNING: Electrical connections to the supply mains must be performed by specialised personnel.

Verify the efficiency of the grounding system in the building. Make sure that line voltage (**V**) and frequency (**Hz**) correspond to those of the machine (See the identification plate and wiring diagram). The machine is equipped with an electrical cord that connects to a multi-polar plug. The plug is to be connected to a wall switch equipped with a circuit breaker.

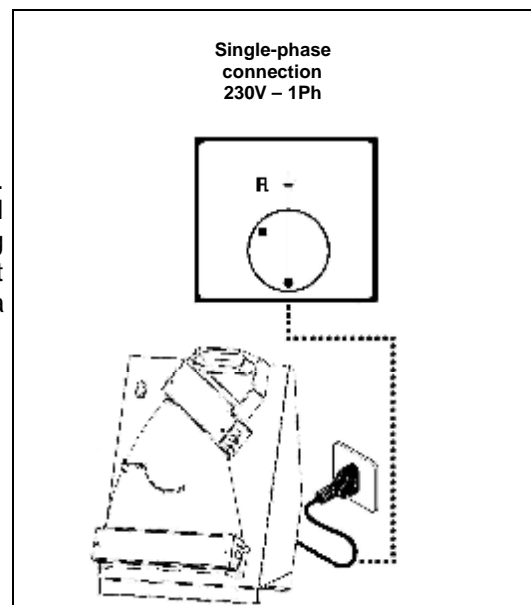

+7(812)987-08-81

Control descriptions

1) Start button "I"

Press the button to start the machine.

2) Stop button "0"

Press the button to stop the machine.

3) Roller adjustment lever

Rotate the lever down to increase thickness. Rotate the lever up to reduce thickness

4) Scale counter-weight knob (mod. S 30/A-S 40/A only)

Unscrew the knob and adjust the counter-weight according to the size and weight of the piece of dough. Screw-in the knob when the counter-weight is in the required position.

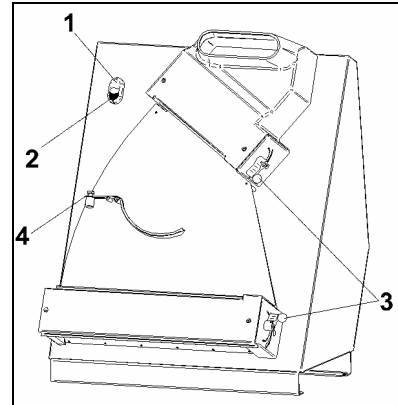

Machine use

- Use the specific levers to adjust thickness on both roller units. The upper rollers must be adjusted to a fairly wide opening while the lower rollers must have an opening as wide as the required thickness (run a few tests to correctly perform this operation).
- Adjust the position of the scale counter-weight according to the size and weight of the dough to be rolled, mod. S 30/A – S 40/A only (run a few tests to correctly perform this operation).
- Make sure the roller blades are in the correct position and that their springs are well-tensioned.
- Start the machine by pressing the start button "I".
- Flatten the piece of dough and liberally cover it with flour to assist the passage through the rollers.
- When finished, stop the machine by pressing the stop button "0".



INFORMATION: For use with very irregular-shaped pieces of dough, remove the scale (mod. S 30/A – S 40/A only) and manually rotate the piece as it passes between the two pairs of rollers.

Pedal control

- With the machine off, insert the pedal control plug in the socket on the side of the appliance.
- Press the start "I" button to power the pedal.
- Start the machine by pressing down on the pedal control. Release the pedal to stop the machine. The machine will restart each time the pedal is pressed down.
- When finished, turn off the pedal control by pressing the stop button "0".

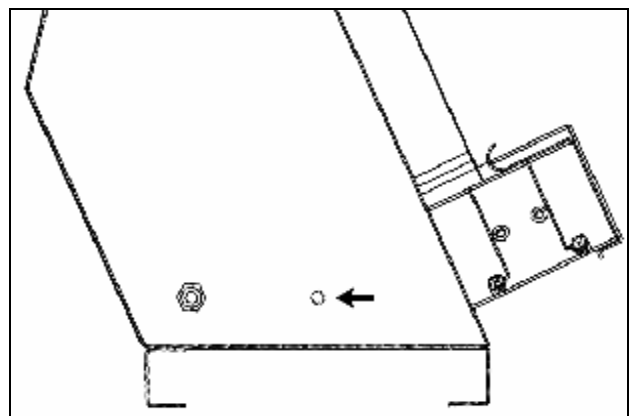

DANGER – WARNING: To prevent the appliance from accidentally restarting, always turn off the pedal after use by pressing the stop button "0". Only remove the pedal plug from the socket after pressing the stop button.

Recommendations for use +7(812)987-08-81

Always use the machine with a wide opening between the upper rollers to prevent excessively straining the transmission components. Furthermore, flatten and liberally cover the piece of dough with flour before placing it in the machine to assist passage through the rollers.

⚠ DANGER – WARNING: The safety guards included in the packaging must be securely fastened to the machine before use. The manufacturer is not liable for damages to things or persons due to neglect to observe these instructions.

End of the day cleaning

- Remove the plug from the electrical socket at the end of the day.
- Accurately clean using neutral products.
- Clean external machine parts with a damp sponge.
- Do not use metallic pads and abrasive detergents.

Roller blade cleaning

- Unhook the springs on the lower rollers by pushing them outwards.

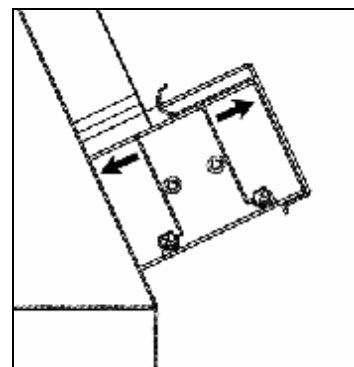

- Rotate the pins inwards and clean the roller blades with a damp cloth.
- To return the roller blades to their initially position, follow the above directions in reverse order.

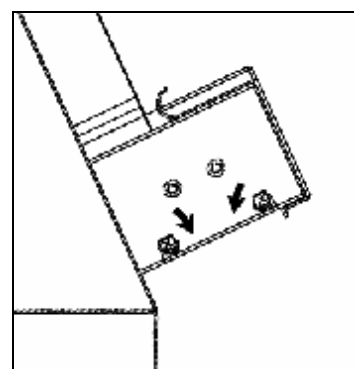

i INFORMATION: Before each work cycle make sure the roller blades are correctly fastened.

Extended periods of disuse

For extended periods of disuse, turn off the main wall switch, clean the machine and cover it with a cloth to protect it from dust.

Introduction

In the event of breakdown or malfunctioning, turn off the wall fuse and contact your Dealer's service centre. Avoid dismantling internal machine parts.

The manufacturer is not liable for any machine tampering!

Problems, causes, solutions

| Problem | Cause | Solution |
|-----------------------------------|--------------------------------|--------------------------------------|
| The machine does not start | Main switch off | Turn on main switch to "I" |
| | No voltage on the power supply | Contact your dealer's service centre |
| | Safety fuse burnt out | Contact your dealer's service centre |

Disposal and recycling

The machine was designed and constructed to work for an average of 10.000 hours. When finished using the machine, follow national laws for disposal and recycling. Please contact the environmental authorities or authorised organisations.

vsezip.ru

+7(812)987-08-81

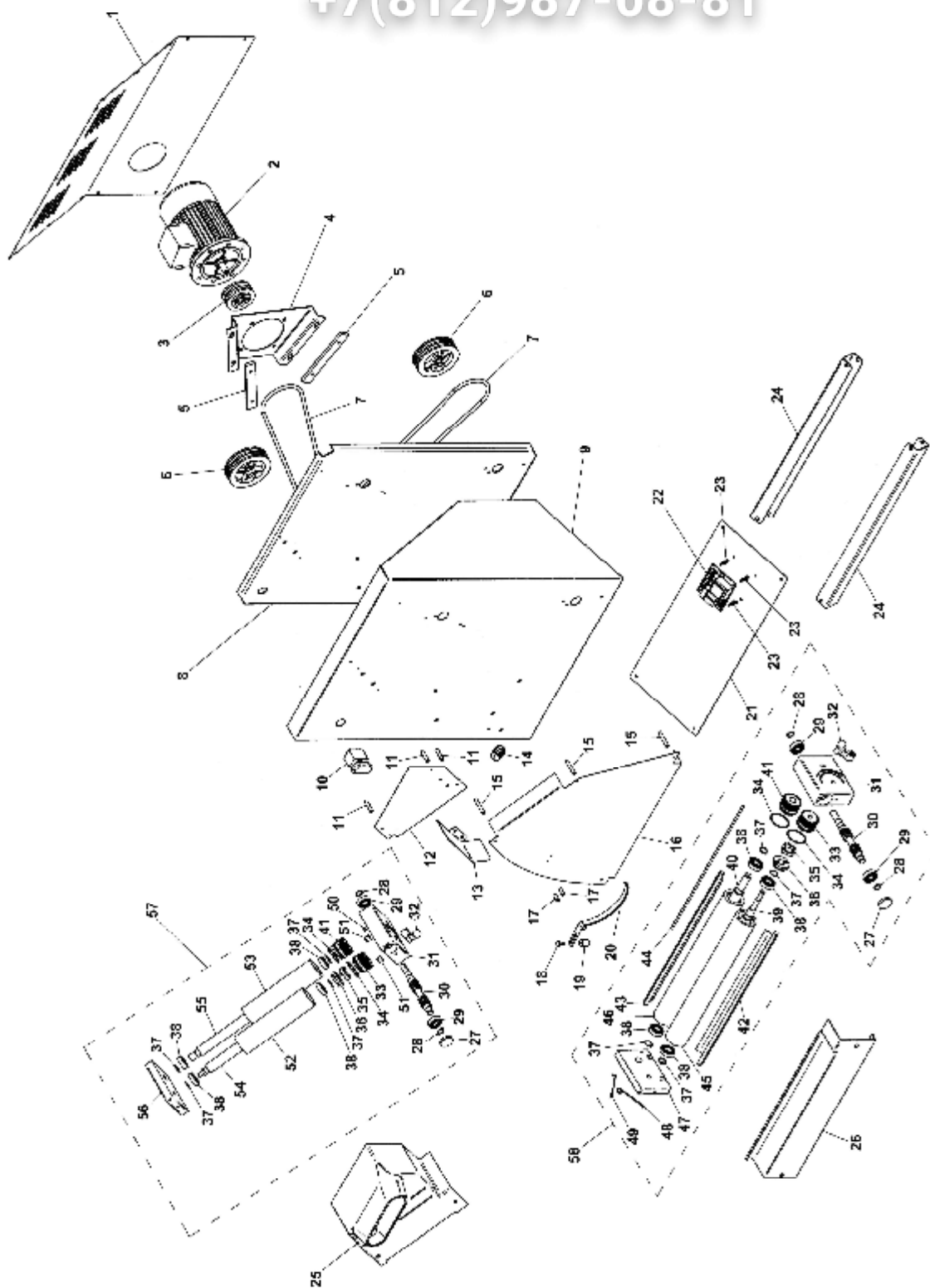

| Rif No | Codice Code | Caratteristiche Characteristics | Descrizione Description |
|--------|-------------|---------------------------------|------------------------------------|
| 1 | SL2457 | S30 | Copertura Covering |
| 1 | SL2458 | S40 | Copertura Covering |
| 2 | SL1470 | 230V/1Ph/50Hz | Motore Motor |
| 3 | SL2432 | | Puleggia Pulley |
| 4 | SL2369 | | Staffa Bracket |
| 5 | SL2884 | | Guida Guide |
| 6 | SL2433 | | Puleggia Pulley |
| 7 | SL2956 | ø8x1000 | Cinghia Belt |
| 8 | SL2462 | S30 | Telaio Frame |
| 8 | SL2463 | S40 | Telaio Frame |
| 9 | SL2459 | S30 | Carcassa Housing |
| 9 | SL2460 | S40 | Carcassa Housing |
| 10 | SL0891 | | Pulsante Push button |
| 11 | SL2476 | ø8x35 M4 | Distanziale Spacer |
| 12 | SL2362 | S30 | Scivolo Chute |
| 12 | SL2363 | S40 | Scivolo Chute |
| 13 | SL2916 | | Staffa Bracket |
| 14 | SL1052 | PG11 | Pressacavo Cable clamp |
| 15 | SL2953 | ø8x50 M4 | Distanziale Spacer |
| 16 | SL2369 | S30 | Scivolo Chute |
| 16 | SL2370 | S40 | Scivolo Chute |
| 17 | SL3019 | ø8x20 M4 | Distanziale Spacer |
| 18 | SL0343 | M5 | Pomello Knob |
| 19 | SL2465 | | Contrappeso Counterweight |
| 20 | SL2360 | S30 | Bilancino Balance |
| 20 | SL2361 | S40 | Bilancino Balance |
| 21 | SL2371 | S30 | Fondo Bottom |
| 21 | SL2372 | S40 | Fondo Bottom |
| 22 | SL2990 | 230V/1Ph/50-60Hz | Scheda elettronica Electronic card |
| 23 | SL3020 | | Distanziale Spacer |
| 24 | SL2358 | S30 | Staffa Bracket |
| 24 | SL2915 | S40 | Staffa Bracket |
| 25 | SL2959 | S30 | Protezione Protection |
| 25 | SL2960 | S40 | Protezione Protection |
| 26 | SL2455 | S30 | Protezione Protection |
| 26 | SL2456 | S40 | Protezione Protection |
| 27 | SL2466 | | Tappo Tap |
| 28 | SL2471 | ø15 | Seeger Seeger |
| 29 | SL2472 | 6202 2RS | Cuscinetto Bearing |
| 30 | SL2425 | | Vite senza fine Endless screw |
| 31 | SL2375 | | Supporto Support |
| 32 | SA1260 | | Leva Lever |
| 33 | SL2427 | Eccentric | Ingranaggio Gear |
| 34 | SL2883 | | Anello Ring |
| 35 | SL2430 | Male | Giunto Joint |
| 36 | SL2429 | Female | Giunto Joint |
| 37 | SL0017 | ø17 | Seeger Seeger |
| 38 | SL2473 | 6003 2RS | Cuscinetto Bearing |
| 39 | SL2436 | Eccentric S30 | Albero Shaft |
| 39 | SL2438 | Eccentric S40 | Albero Shaft |
| 40 | SL2435 | Cylindrical S30 | Albero Shaft |
| 40 | SL2437 | Cylindrical S40 | Albero Shaft |
| 41 | SL2426 | Cylindrical | Ingranaggio Gear |
| 42 | SA1265 | Eccentric S30 | Raschiatore Scraper |
| 42 | SA1270 | Eccentric S40 | Raschiatore Scraper |
| 43 | SA1275 | Cylindrical S30 | Raschiatore Scraper |
| 43 | SA1280 | Cylindrical S40 | Raschiatore Scraper |
| 44 | SL2467 | S30 | Asta Rod |
| 44 | SL2468 | S40 | Asta Rod |
| 45 | SL2444 | Eccentric S30 | Rullo Roller |
| 45 | SL2446 | Eccentric S40 | Rullo Roller |
| 46 | SL2443 | Cylindrical S30 | Rullo Roller |
| 46 | SL2445 | Cylindrical S40 | Rullo Roller |
| 47 | SL2376 | | Supporto Support |
| 48 | SL2384 | Eccentric | Molla Spring |
| 49 | SL2385 | Cylindrical | Molla Spring |
| 50 | SL3035 | | Tappo Tap |
| 51 | SL3096 | | Tappo Tap |
| 52 | SL2448 | Eccentric S30 | Rullo Roller |
| 52 | SL2450 | Eccentric S40 | Rullo Roller |
| 53 | SL2447 | Cylindrical S30 | Rullo Roller |
| 53 | SL2449 | Cylindrical S40 | Rullo Roller |
| 54 | SL2440 | Eccentric S30 | Albero Shaft |
| 54 | SL2442 | Eccentric S40 | Albero Shaft |
| 55 | SL2439 | Cylindrical S30 | Albero Shaft |
| 55 | SL2441 | Cylindrical S40 | Albero Shaft |
| 56 | SL2422 | | Supporto Support |
| 57 | SA1285 | Upper S30 | Gruppo rulli Assembly rollers |
| 57 | SA1290 | Upper S40 | Gruppo rulli Assembly rollers |
| 58 | SA1295 | Lower S30 | Gruppo rulli Assembly rollers |
| 58 | SA1305 | Lower S40 | Gruppo rulli Assembly rollers |

(*) : fuori produzione / out of production

vsezip.ru

+7(812)987-08-81

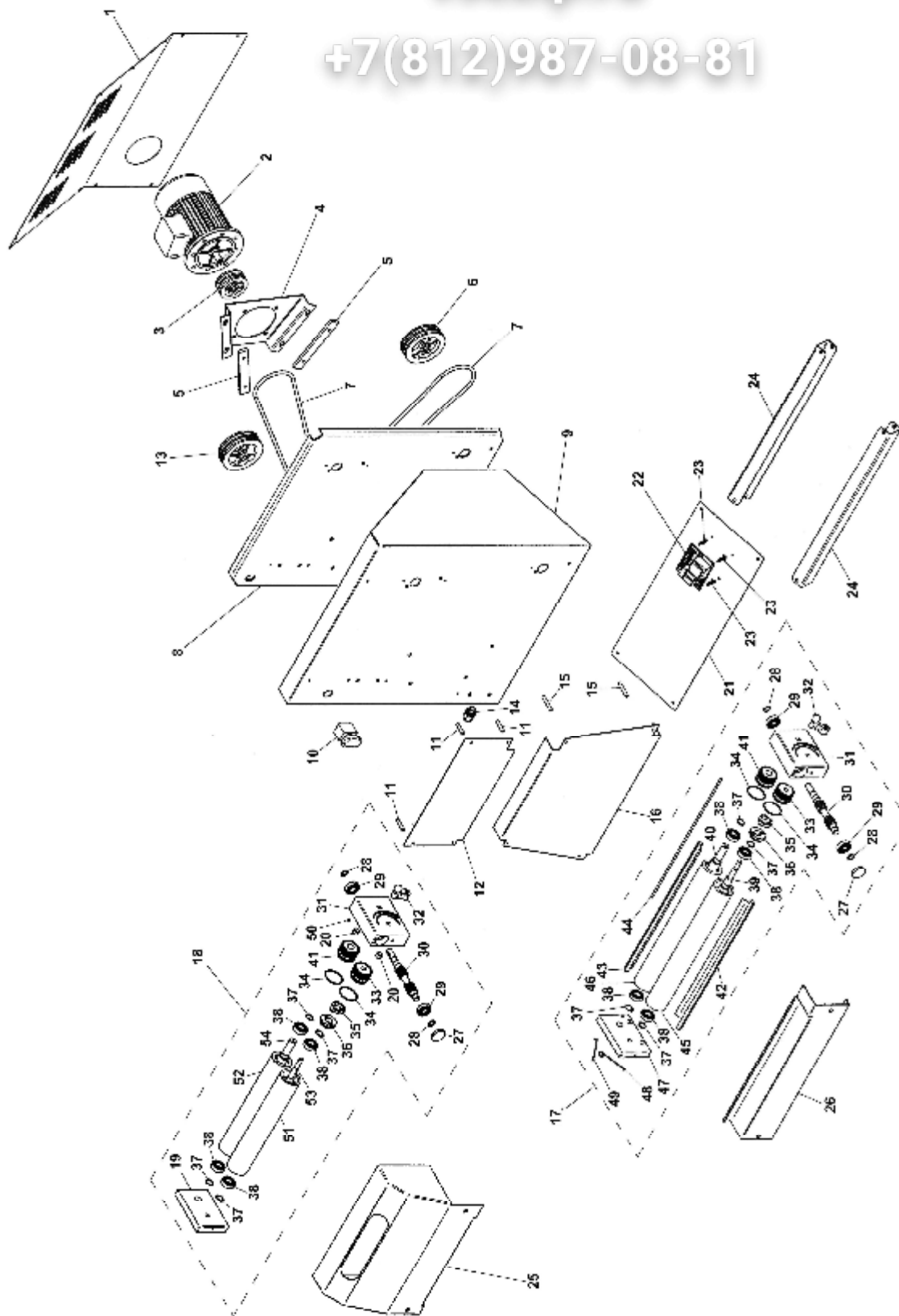

| Rif No | Codice Code | Caratteristiche Characteristics | Descrizione Description |
|--------|-------------|---------------------------------|------------------------------------|
| 1 | SL2925 | | Copertura Covering |
| 2 | SL1470 | 230V/1Ph/50Hz | Motore Motor |
| 3 | SL2432 | | Puleggia Pulley |
| 4 | SL2369 | | Staffa Bracket |
| 5 | SL2884 | | Guida Guide |
| 6 | SL2433 | | Puleggia Pulley |
| 7 | SL2956 | ø8x1000 | Cinghia Belt |
| 8 | SL2464 | | Telaio Frame |
| 9 | SL2461 | | Carcassa Housing |
| 10 | SL0891 | | Pulsante Push button |
| 11 | SL2476 | ø8x35 M4 | Distanziale Spacer |
| 12 | SL2359 | | Scivolo Chute |
| 13 | SL2434 | | Puleggia Pulley |
| 14 | SL1052 | PG11 | Pressacavo Cable clamp |
| 15 | SL2953 | ø8x50 M4 | Distanziale Spacer |
| 16 | SL2369 | (F132) | Scivolo Chute |
| 16 | SL2370 | (F142) | Scivolo Chute |
| 17 | SA1305 | Lower | Gruppo rulli Assembly rollers |
| 18 | SA1310 | Upper | Gruppo rulli Assembly rollers |
| 19 | SL2422 | | Supporto Support |
| 20 | SL3096 | | Tappo Tap |
| 21 | SL2372 | | Fondo Bottom |
| 22 | SL2990 | 230V/1Ph/50-60Hz | Scheda elettronica Electronic card |
| 23 | SL3020 | | Distanziale Spacer |
| 24 | SL2915 | | Staffa Bracket |
| 25 | SL2961 | | Protezione Protection |
| 26 | SL2456 | | Protezione Protection |
| 27 | SL2466 | | Tappo Tap |
| 28 | SL2471 | ø15 | Seeger Seeger |
| 29 | SL2472 | 6202 2RS | Cuscinetto Bearing |
| 30 | SL2425 | | Vite senza fine Endless screw |
| 31 | SL2375 | | Supporto Support |
| 32 | SA1260 | | Leva Lever |
| 33 | SL2427 | Eccentric | Ingranaggio Gear |
| 34 | SL2883 | | Anello Ring |
| 35 | SL2430 | Male | Giunto Joint |
| 36 | SL2429 | Female | Giunto Joint |
| 37 | SL0017 | ø17 | Seeger Seeger |
| 38 | SL2473 | 6003 2RS | Cuscinetto Bearing |
| 39 | SL2438 | Eccentric | Albero Shaft |
| 40 | SL2437 | Cylindrical | Albero Shaft |
| 41 | SL2426 | Cylindrical | Ingranaggio Gear |
| 42 | SA1270 | Eccentric | Raschiatore Scraper |
| 43 | SA1280 | Cylindrical | Raschiatore Scraper |
| 44 | SL2468 | | Asta Rod |
| 45 | SL2446 | Eccentric | Rullo Roller |
| 46 | SL2445 | Cylindrical | Rullo Roller |
| 47 | SL2376 | | Supporto Support |
| 48 | SL2384 | Eccentric | Molla Spring |
| 49 | SL2385 | Cylindrical | Molla Spring |
| 50 | SL3035 | | Tappo Tap |
| 51 | SL2444 | Eccentric | Rullo Roller |
| 52 | SL2443 | Cylindrical | Rullo Roller |
| 53 | SL2436 | Eccentric | Albero Shaft |
| 54 | SL2435 | Cylindrical | Albero Shaft |

(*) : out of production

