



BM7-4G
BM7-7G

SERIE 700

BAGNOMARIA A GAS
BAINMARIE A GAZ
GAS-HEATED BAINMARIE
GASBEHEIZTE WASSERBÄDER
LAGÑO MARIA A GAS

93854-30 BM7-4G
93855-30 BM7-7G

Зип Общепит

vsezip.ru

+7(812)987-08-81

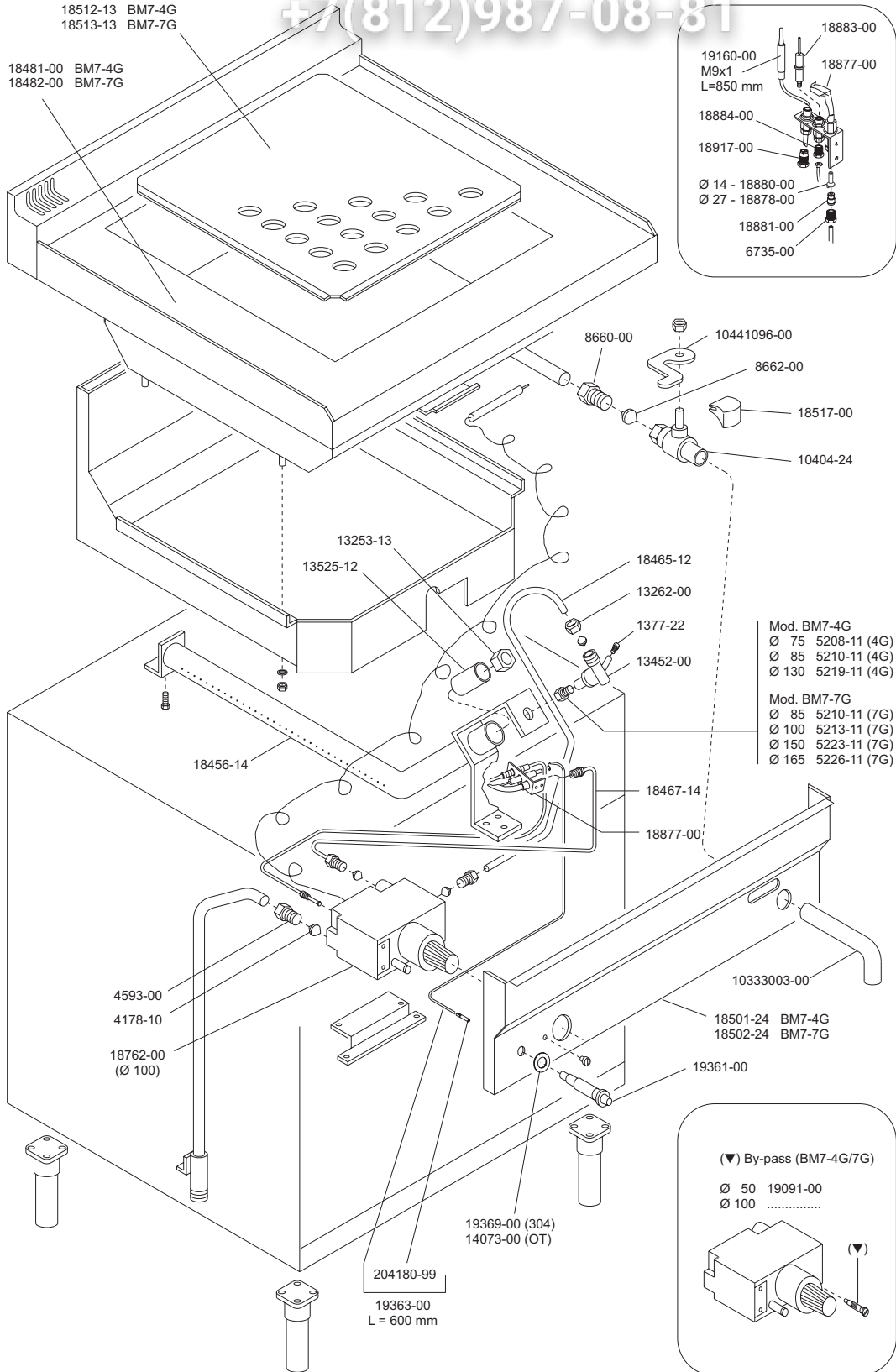



MARENO INDUSTRIE ALI spa
Mareno di Piave (TV)

| | | | |
|-------------|-----------------------|-----------------------------|--|
| ELABORATO: | APPROVATO: | GRUPPO: | DENOMINAZIONE: |
| <i>Plum</i> | | Serie 700 | Impianto a gas e mobile |
| DATA: | DATA: | PARTICOLARE: | REV. N. DEL DISEGNO N. |
| 10 Apr 96 | 10 Apr 96 | Disegno esploso per ricambi | ▼ ▼ ▼ |
| SOST. DIS. | P01 - 9604.3.7.04.BMG | | P 0 1 - 9 6 0 4 . 3 . 7 . 0 4 . B M G |

S700-CE

Зиповелит
vsezip.ru
+7(812)987-08-81

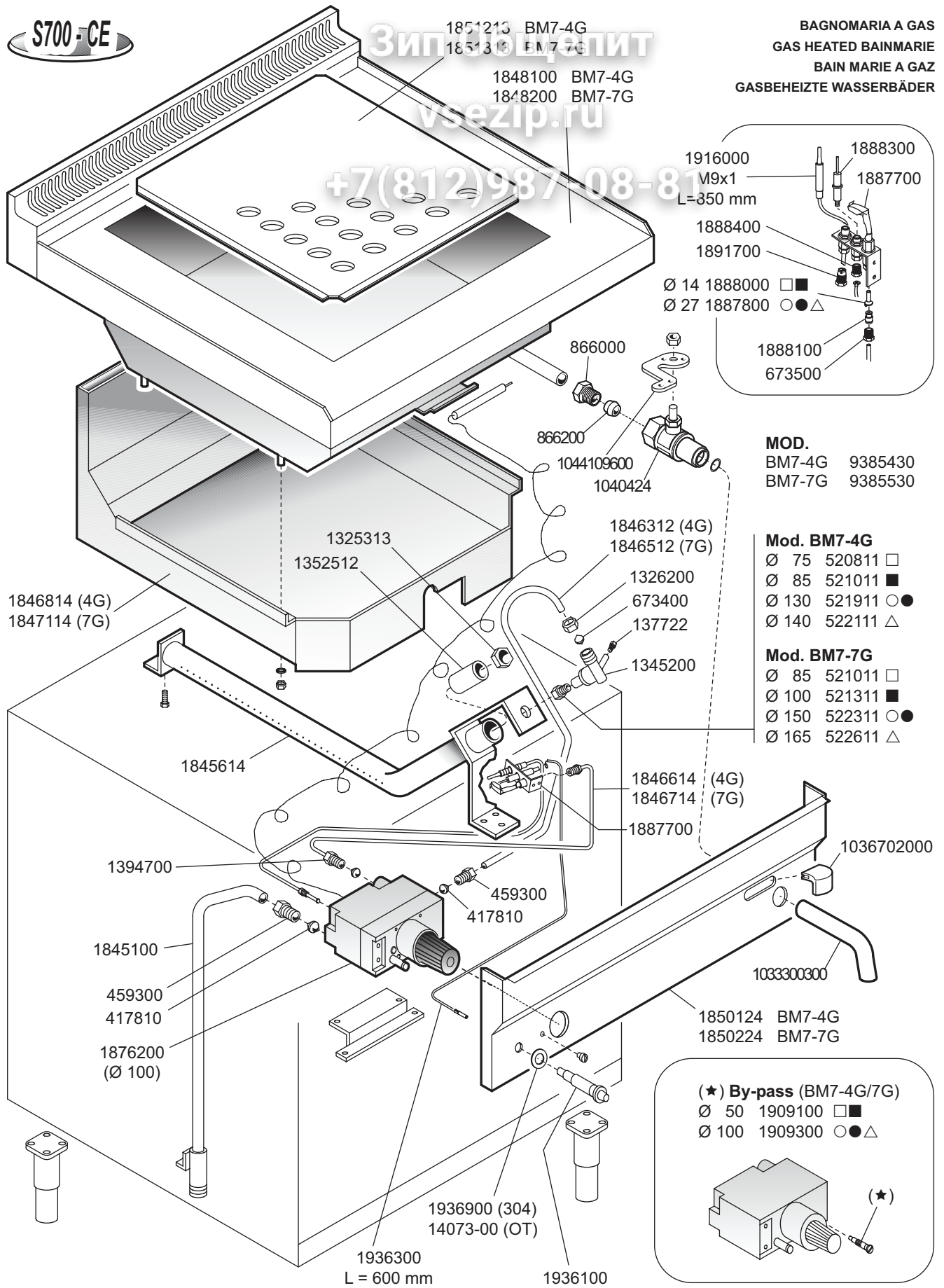
BAGNOMARIA A GAS
GAS HEATED BAINMARIE
BAIN MARIE A GAZ
GASBEHEIZTE WASSERBÄDER



ID GAS: □ G30/50 ■ G30/29 ○ G20/20 ● G25/25 △ G25/20 ▲ G110/8 ⊙ G120/8 ● G140/8

| | | | | | | |
|--|----------------------------|-------------|-----------------------------|-----------------------|-------------|---------------|
|  MARENO INDUSTRIE ALI spa Mareno di Piave (TV) | ELABORATO: | APPROVATO: | GRUPPO: | DENOMINAZIONE: | | |
| | G.Z. | | Serie 700 | Impianto gas e mobile | | |
| | DATA: | DATA: | PARTICOLARE: | REV. N. | DEL | DISEGNO N. |
| | 24 Apr 1996 | 24 Apr 1996 | Disegno esploso per ricambi | ▼ | ▼ | ▼ |
| SOST. DIS. | Z01 9604 3.7.04.BMG | | CE | Z02 | 0303 | 3.7.04 |