

Зип Общепит

ABBATTORI GASTRONOMIA

+7(812)987-0881

**GASTRONOM BLAST CHILLERS
AND FREEZERS**

**GASTRONOMIE
SCHNELLABKÜHLER UND
SCHOCKFROSTER**

**CELLULES DE
REFROIDISSEMENT/SURGELATION
RAPIDE POUR GASTRONOMIE**

DBM141SJ2ITSIBA



ESPLOSTI - EXPLODED DRAWINGS
EXPLOSIONZEICHNUNGEN - VUE ECLATEE

Codice XESH6X61D

Pagina 2

Verifica: Ufficio tecnico +7(812)98708-81 De Cian

Emissione: Ufficio tecnico De Cian

Approvazione: Direzione tecnica Zambon

Copia controllata nr. _____

Copia non controllata

Mod. : 14 teglie GN MISTI FR dep STD

	XESH6X61D	PAG. 3
da matricola - from serial Nr.	a matricola - to serial Nr.	

Зип Общепит

vsezip.ru

+7(812)987-08-81

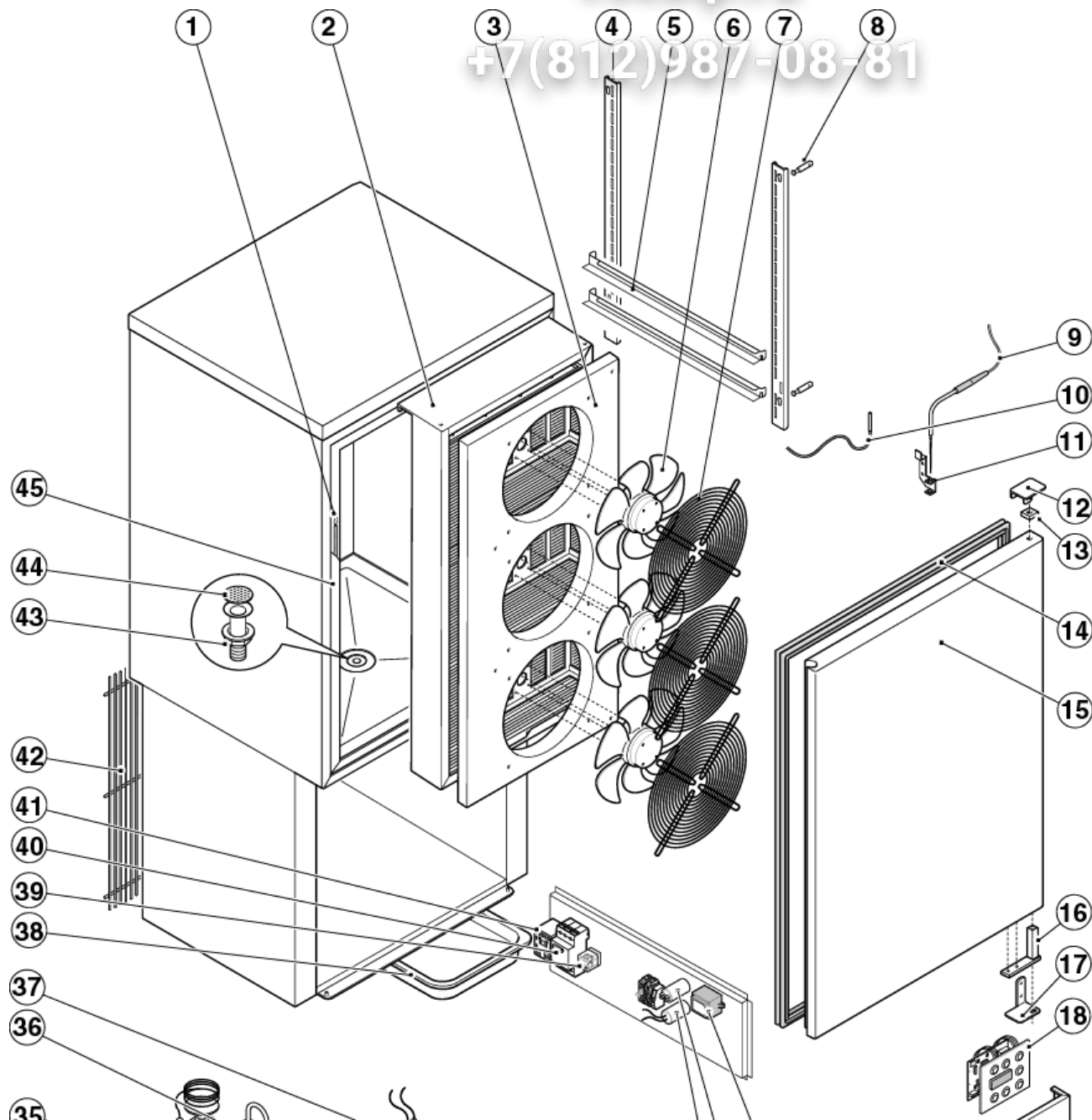

	COD.	REV.	DESCRIZIONE	DESCRIPTION	BESCHREIBUNG	DESCRIPTION
1	RA900046		RESISTENZA ANTICONDENSA	FRAME RESISTANCE	WIDERSTAND RAHMEN	RESISTANCE CADRE
2	RA140024		EVAPORATORE	EVAPORATOR	VERDAMPFER	EVAPORATEUR
3	RF080024		ASSIEME CONVOGLIATORE	FAN COVERING	VENTILATORABDECKUNG	COUVRE VENTILATEUR
4	RG330033		CREMAGLIERA LATERALE SX	LEFT RACK	LINK ZAHNSTANGE	CREMAILLIERE GAUCHE
4a	RG330032		CREMAGLIERA LATERALE DX	RIGHT RACK	RECHT ZAHNSTANGE	CREMAILLIERE DROITE
5	RG490021		GUIDA UNICA CELLA GN	GRID SLIDE	SCHIENE	GLISSIERE GRILLE
6	RA880002	C	MOTOVENTILATORE A2E250-AL06-09	MOTOR FOR FAN A2E250-AL06-09	MOTOR FÜR VENTILATOR A2E250-AL06-09	MOTEUR VENTILATEUR A2E250-AL06-09
7	RA170062		GRIGLIA PROTEZIONE VENTOLA	PROTECTION GRID FOR FAN	SCHUTZGITTER FÜR VENTILATEUR	GRILLE PROTECTION VENTILATEUR
8	RA470020		PERNO CREMAGLIERA GN D.14	HINGE RACK HOLDER GN D.14	ZAPFEN HÄNGER FÜR ZAHNSTANGE GN D.14	PIVOT DE SUPPORT CREMAILLIERE GN D.14
9	RA930013	C	SONDA AISI INFILZO S/RISCALDAMENTO	CORE PROBE	KERNFUEHLER	SONDE AU COEUR
OPT	RA930012	C	SONDA AISI INFILZO CON RISCALDAMENTO	CORE PROBE	KERNFUEHLER	SONDE AU COEUR
10	RA932001	C	SONDA PTC L.2600 SILICONE	PROBE PTC L.2600	FUEHLER PTC L.2600	SONDE PTC L.2600
11	RG830147		SUPPORTO SONDA	PROBE SUPPORT FOR PRICKER PROBE	FUEHLERHALTER FÜR NADELFUEHLER	PORTE-SONDE POUR AGUILLE
12	RG810022		SUPPORTO BOCCOLA CERNIERA	LOWER HINGE	UNTERES SCHARNIER	CHARNIERE INFERIEUR
13	RA050006		BOCCOLA NYLON CERNIERA	BUSH FOR DOOR HINGE	BUCHSE FÜR DER TUER	DOUILLE POUR CHARNIERE PORTE
14	RA190071		GUARNIZIONE MAGNETICA PORTA	SEAL	DICHTUNG	GARNITURE
15	RB100026		ASSIEME PORTA SCHIUMATA	DOOR	TÜR	PORTE
16	RA051007		CERNIERA AUTOCHIUDENTE	HINGE PIVOT	SCHARNIER PIVOT	SCHARNIERE PIVOT
17	RG810021		SUPPORTO CERNIERA	HINGE HOLDER	SCHARNIER HALTER	SUPPORT CHARNIERE
18	RA910071	C	SCHEDA TASTIERA STD	CARD FOR REDUCED KEYBOARD	PLATINE FÜR REDUZIERTE TASTATUR	FICHE CLAVIER POUR PLATINE
19	RF360103		ASSIEME CRUSCOTTO	FRONT PANEL	VORDERPANEEL	PANNEAU FRONTAL
20	RA919000		VOLANTINO ZIGRINATO M5x1	THREAD WHEEL M5x1	RAENDELHANDRAD M5x1	VOLANT MOLETE M5x1
21	RG350065		MASCHERINA ANTERIORE	KEYBOARD PLATE	TASTATURFOLIE	MASQUE PLATINE
22	RA960006		TRASFORMATORE 6VA 230/12V	6VA 230/12V TRANSFORMER	TRANSFORMATOR 6VA 230/12V	TRANSFORMATEUR 6VA 230/12V
OPT	RA960002		TRASFORMATORE 20VA 230/12V	220-12V TRANSFORMER	TRANSFORMATOR 220-12V	TRANSFORMATEUR 220-12V
23	RA860014		CONDENSATORE 9 MF	CONDENSER 9MF	KONDENSER 9MF	CONDENSATEUR 9MF
24	RA860005		CONDENSATORE 5 MF	CONDENSER 5MF	KONDENSER 5MF	CONDENSATEUR 5MF
25	RA090046		CONDENSATORE LUVE STFT 242435 STD	CONDENSER LUVE 242435 STD	KONDENSATOR LUVE 242435 STD	CONDENSATEUR LUVE 242435 STD
26	RA880051	C	GRP.MOTOVENTILATORE ZIEHL D330 4P/S	MOTOR FAN ZIEHL D330 4P/S	MOTOR VENTILATOR ZIEHL D330 4P/S	MOTEUR VENTILATEUR ZIEHL D330 4P/S
27	RA590010		ASSIEME PIEDINO 1"3/4 H=200	FOOT SUPPORT + FOOT 1"3/4 H=200	FUSSHALTER + FUSS 1"3/4 H=200	SUPPORT PIED + PIED 1"3/4 H=200
28	RA073014	C	COMPRESSORE UH TFH2511Z	COMPRESSOR	KOMPRESSOR	COMPRESSEUR
29	RA014103		RICEVITORE LIQUIDO 2,9L	LIQUID RESERVE 2,9L	FLUESSIGKEITRESERVE 2,9L	RECEPTEUR DE LIQUIDE 2,9L
30	RA714014		VALVOLA SOLENOIDE Ø10 CASTEL	CASTEL SOLENOIDE VALVE Ø10	CASTEL SOLENOID-VENTIL Ø10	SOUPAPE SOLENOIDE Ø10 CASTEL
31	RA714012	C	BOBINA TIPO HM2	COIL HM2 FOR SOLENOIDE VALVE	SPUL HM2 FÜR SOLENOID-VENTIL	BOBINE HM2 POUR SOUPAPE SOLENOIDE
32	RA714017		CONNETTORE PG11 PER VALVOLA SOLENOIDE	CONNECTOR PG11 FOR SOLENOIDE VALVE	VERBINDFER PG11 FÜR SOLENOID-VENTIL	CONNECTEUR PG11 POUR SOUPAPE SOLENOIDE
33	RA716502		ADATTATORE A BRASARE	ADAPTER FOR T-TE D.6	ADAPTER FÜR T-TE D.6	ADAPTEUR POUR T-TE D.6
34	RA716019		ORIFICIO N° 03 C/FILTRO	ORIFICE N° 3 WITH FILTER	OEFFNUNG N° 3 MIT FILTER	ORIFICE N° 3 AVEC FILTRE
35	RA715008		CORPO VALVOLA TERMOSTATICA TES2 NL MOP-10 R404A	VALVE BODY TES2 R404A	VENTILKORPER TES2 R404A	CORPS SOUPAPE TES2 R404A
36	RA012005		FILTRO CASTEL 4308/M10S	CASTEL 4308/M10S FILTER	FILTER CASTEL 4308/M10S	FILTRE CASTEL 4308/M10S
37	RA953008		PRESSOSTATO DANFOSS	PRESSURE SWITCH	DRUCKWAECHTER	PRESSOSTAT
38	0102343		BACINELLA PLASTICA GN 1/1	PLASTIC VESSEL GN 1/1	PLASTIC BEHALTER GN 1/1	CUVE EN PLASTIQUE GN 1/1
39	RA890004	C	RELE' FINDER 62.82.82300	RELAIS FINDER 62.82.82300	RELAIS FINDER 62.82.82300	RELAIS FINDER 62.82.82300



40	RA890028		CONTATTORE SIRIUS 3RT102	ELECTROMAGNETIC SWITCH	FERNSCHALTER	TELERUPTEUR
41	RA949009		INTERRUTTORE AUTOMATICO SIRIUS 3R	SIRIUS 3R SWITCH	SCHALTER SIRIUS 3R	INTERRUPTEUR SIRIUS 3R
42	RA170063		PROTEZIONE POSTERIORE	PROTECTION GRILL	HINTERER SCHUTZ	PROTECTION POSTERIEURE
43	RA651002		PILETTA SCARICO 1"	DRAIN STRAINER 1"	BECKENAUSLAUF 1"	CREPINE VIDANGE 1"
44	RG650005		GRIGLIETTA SCARICO	DRAIN GRILL	ABLAUF GITTER	GRILLE DE VIDANGE
45	RG190024		CONTROMAGNETE VERTICALE	VERTICAL COUNTERMAGNET	VERTIKALER GEGENMAGNET	CONTRE-AIMANT VERTICAL
45a	RG190021		CONTROMAGNETE ORIZZONTALE	HORIZONTAL COUNTERMAGNET	WAAGERECHTER GEGENMAGNET	CONTRE-AIMANT HORIZONTAL

+7(812)987-08-81