

Зип Общепит

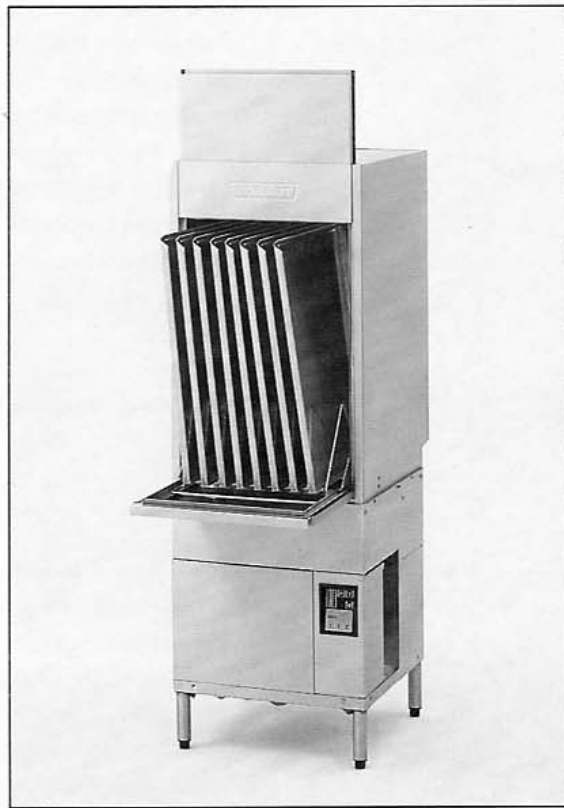

**UW-105**

**Spare Parts**  
**Pièces Détachées**  
**Ersatzteile**  
**Onderdelen**

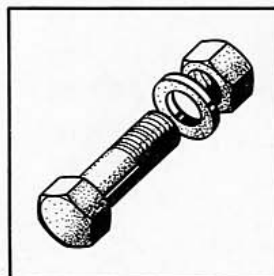

**Contents**

Frame, drain and strainers .....	3
Door and track .....	4
Reed switch – door .....	5
Wash pump .....	6
Wash and rinse system .....	7
Fill pipework .....	8
Spares kit, solenoid valve .....	9 - 11
Rinse booster heater, electric .....	12
Rinse booster heater – steam, hot water .....	13
Solenoid valve .....	14, 16
Rinse booster heater – steam .....	15
Fill pipework .....	17
Float switch .....	18
Tank heating, electric .....	19
Tank heating, steam – hot water .....	20
Rinse pressure pump .....	21, 24
Rinse agent dispenser .....	22
Detergent dispenser .....	23
Control box .....	25
Drain pump .....	26
Vacuum breaker .....	27
Racks .....	28
Piping diagrammes .....	29

**Sommaire**

Chassis, vidange et paniers .....	3
Porte et rails .....	4
Interrupteur – porte .....	5
Pompe de lavage .....	6
Système de lavage et de rinçage .....	7
Arrivée d'eau .....	8
Pièces de rechange, électrovanne .....	9 - 11
Surchauffeur, électrique .....	12
Surchauffeur – vapeur, eau surchauffée .....	13
Electrovanne .....	14, 16
Surchauffeur – vapeur .....	15
Tuyauterie de remplissage .....	17
Interrupteur à flotteur .....	18
Chauffage du bac, électrique .....	19
Chauffage du bac, vapeur – eau surchauffée .....	20
Pompe élévatrice de pression .....	21, 24
Doseur de produit de rinçage .....	22
Doseur de produit détergent .....	23
Coffret de commande .....	25
Pompe de vidange .....	26
Brise-vide .....	27
Casiers .....	28
Schémas de tuyauterie .....	29

**Inhalt**

Gestell, Ablauf und Siebe .....	3
Tür und Laufschiene .....	4
Endschalter – Tür .....	5
Waschpumpe .....	6
Wasch- und Spülsystem .....	7
Eingangsleitung .....	8
Ersatzteile, Magnetventil .....	9 - 11
Durchlauferhitzer, elektrisch .....	12
Durchlauferhitzer – Dampf, Heißwasser .....	13
Magnetventil .....	14, 16
Durchlauferhitzer – Dampf .....	15
Fülleitung .....	17
Schwimmerschalter .....	18
Tankheizung, elektrisch .....	19
Tankheizung, Dampf – Heißwasser .....	20
Drucksteigerungspumpe .....	21, 24
Klarspülmittel-Dosiergerät .....	22
Reiniger-Dosiergerät .....	23
Schaltkasten .....	25
Ablaufpumpe .....	26
Rücksaugeverhinderer .....	27
Körbe .....	28
Rohrleitungsschema .....	29

**Inhoud**

Tank, afvoer en zeven .....	3
Deur en rekkenrails .....	4
Eindschakelaar – deur .....	5
Waspomp .....	6
Was- en spoel-systeem .....	7
Water toevoer .....	8
Onderdelen, vulkraan .....	9 - 11
Booster, elektrisch .....	12
Booster – stoom, heet water .....	13
Vulkraan .....	14, 16
Booster – stoom .....	15
Water toevoer .....	17
Zwem-schakelaar .....	18
Tankverwarming, elektrisch .....	19
Tankverwarming, stoom – heet water .....	20
Spoeldrukpompe .....	21, 24
Spoelmiddel-doseerapparaat .....	22
Wasmiddel-doseerapparaat .....	23
Schakelkast .....	25
Afvoerpomp .....	26
Vacuumbreker .....	27
Rekken .....	28
Leidingenschema .....	29

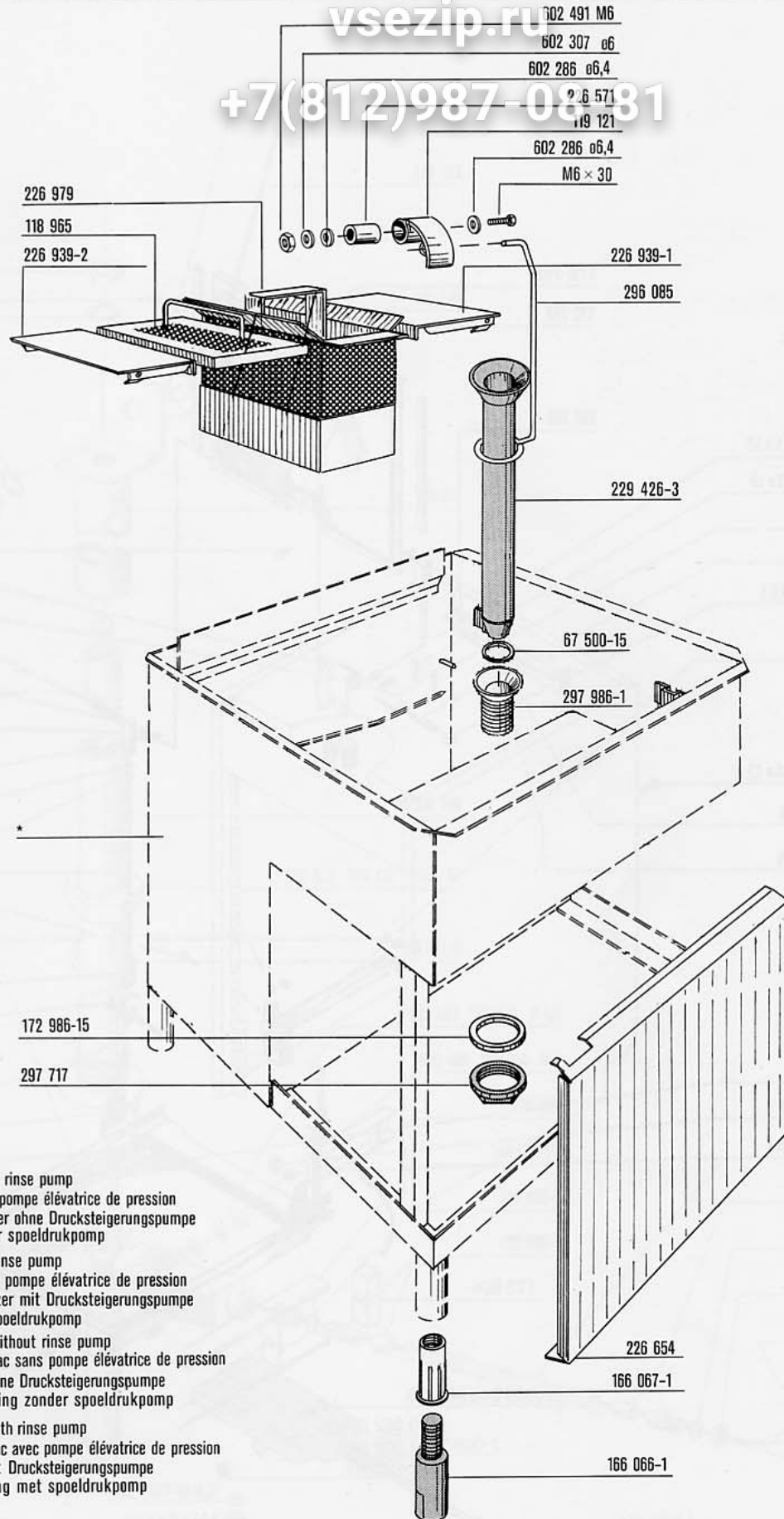

\*Tank for:  
 Bac pour:  
 Tank für:  
 Tank met:

- 170 766-1 booster without rinse pump  
 chaudière sans pompe élévatrice de pression  
 Durchlauferhitzer ohne Drucksteigerungspumpe  
 Booster zonder spoeldrukomp
- 170 766-2 booster with rinse pump  
 chaudière avec pompe élévatrice de pression  
 Durchlauferhitzer mit Drucksteigerungspumpe  
 Booster met spoeldrukomp
- 170 766-3 tank heating without rinse pump  
 chauffage de bac sans pompe élévatrice de pression  
 Tankheizung ohne Drucksteigerungspumpe  
 Tank verwarming zonder spoeldrukomp
- 170 766-4 tank heating with rinse pump  
 chauffage de bac avec pompe élévatrice de pression  
 Tankheizung mit Drucksteigerungspumpe  
 Tankverwarming met spoeldrukomp

Contents

Frame, door and rollers

Door profile

Door rollers

Roller cover

Roller and roller holder

Roller cap

Roller cap, roller holder

Roller cap, roller holder

Roller cap

Roller cap

Roller cap

603 455 M 4 x 12

602 886 M 3 x 15

299 109

602 812

602 288 Ø10,5

172 773-01

172 770

172 770

172 770

172 770

172 770

172 770

172 770

172 770

172 770

172 770

172 770

172 770

172 770

172 770

172 770

172 770

172 770

172 770

172 770

172 770

172 770

172 770

172 770

172 770

172 770

172 770

172 770

172 770

172 770

172 770

172 770

172 770

172 770

172 770

172 788

172 793

228 153

302 207-3

603 649 M 5 x 10-A2

602 288 Ø 10,5

299 110

172 828

165 080

172 792-01

602 521 M 6

602 287 Ø 8,4

602 492 M 8

172 791-01

603 648 M 6 x 12

M 8

172 792-01

602 503 M 8

172 828

602 632 M 6 x 12

228 052

172 828

602 632 M 6 x 12

228 052

172 828

602 632 M 6 x 12

228 052

172 828

602 632 M 6 x 12

228 052

172 828

602 632 M 6 x 12

228 052

172 828

602 632 M 6 x 12

228 052

172 828

602 632 M 6 x 12

228 052

172 828

602 632 M 6 x 12

228 052

172 828

vsezip.ru

(812)987-08-81

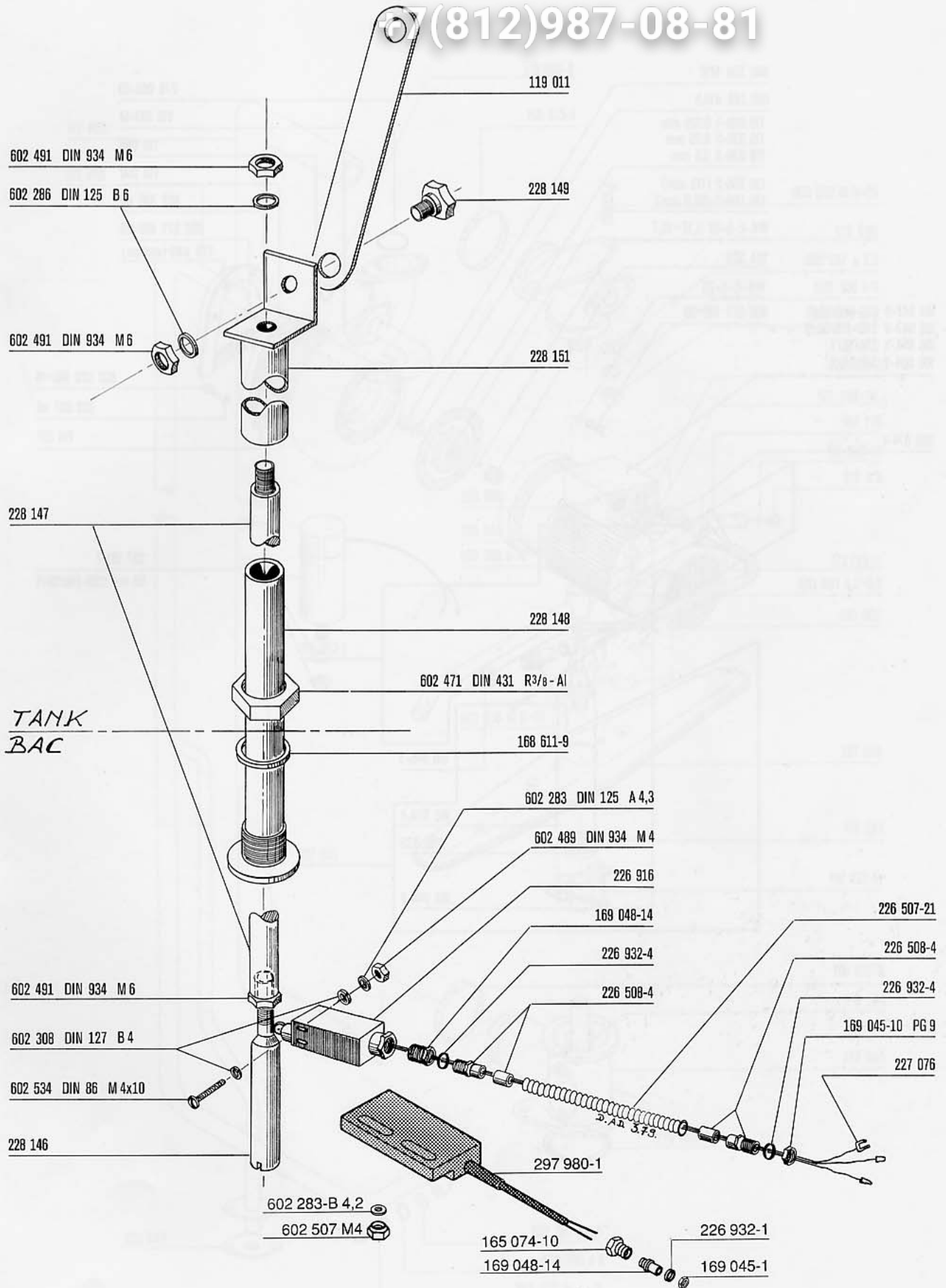

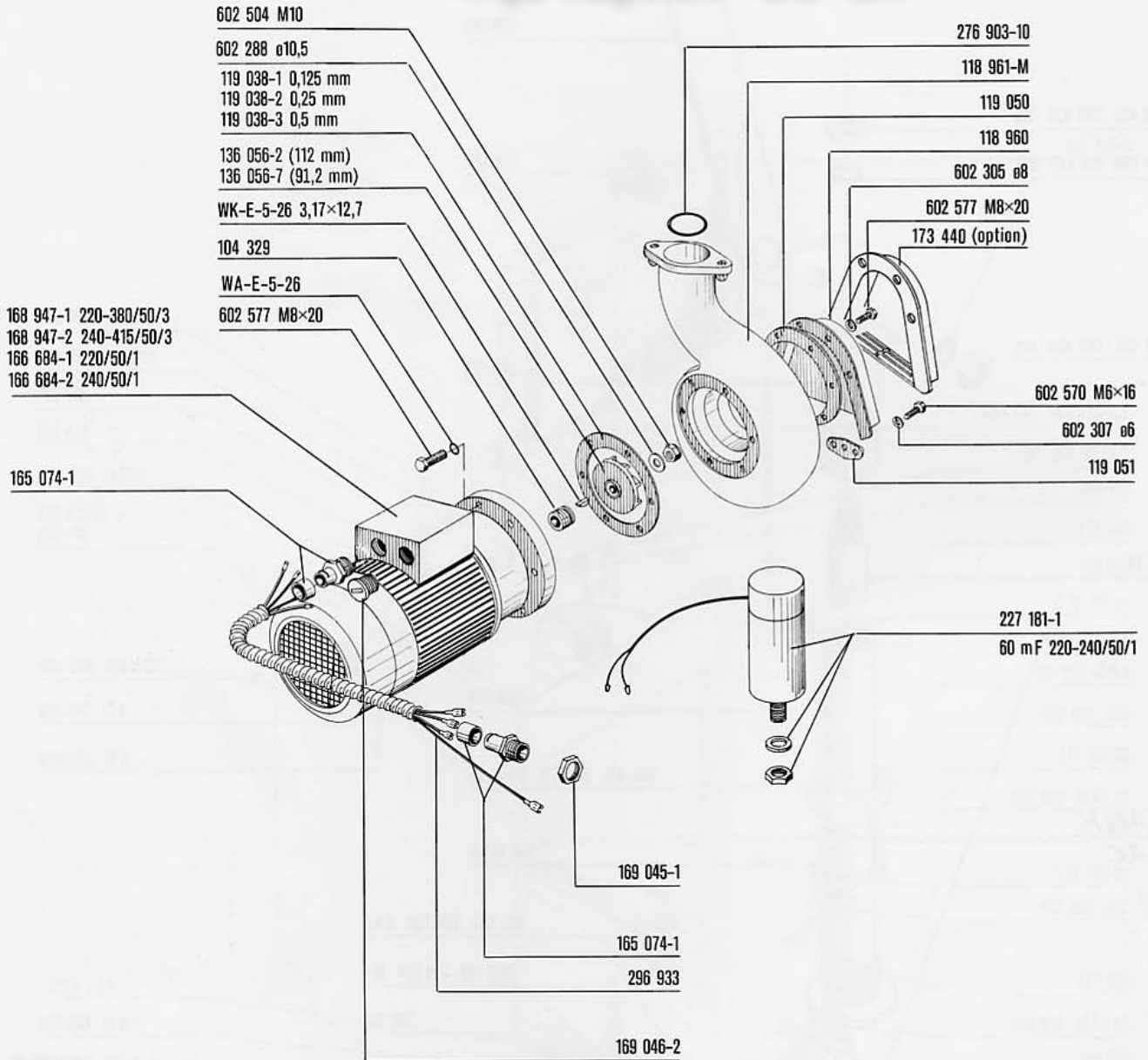



vsezip.ru

+7(812)987-08-81

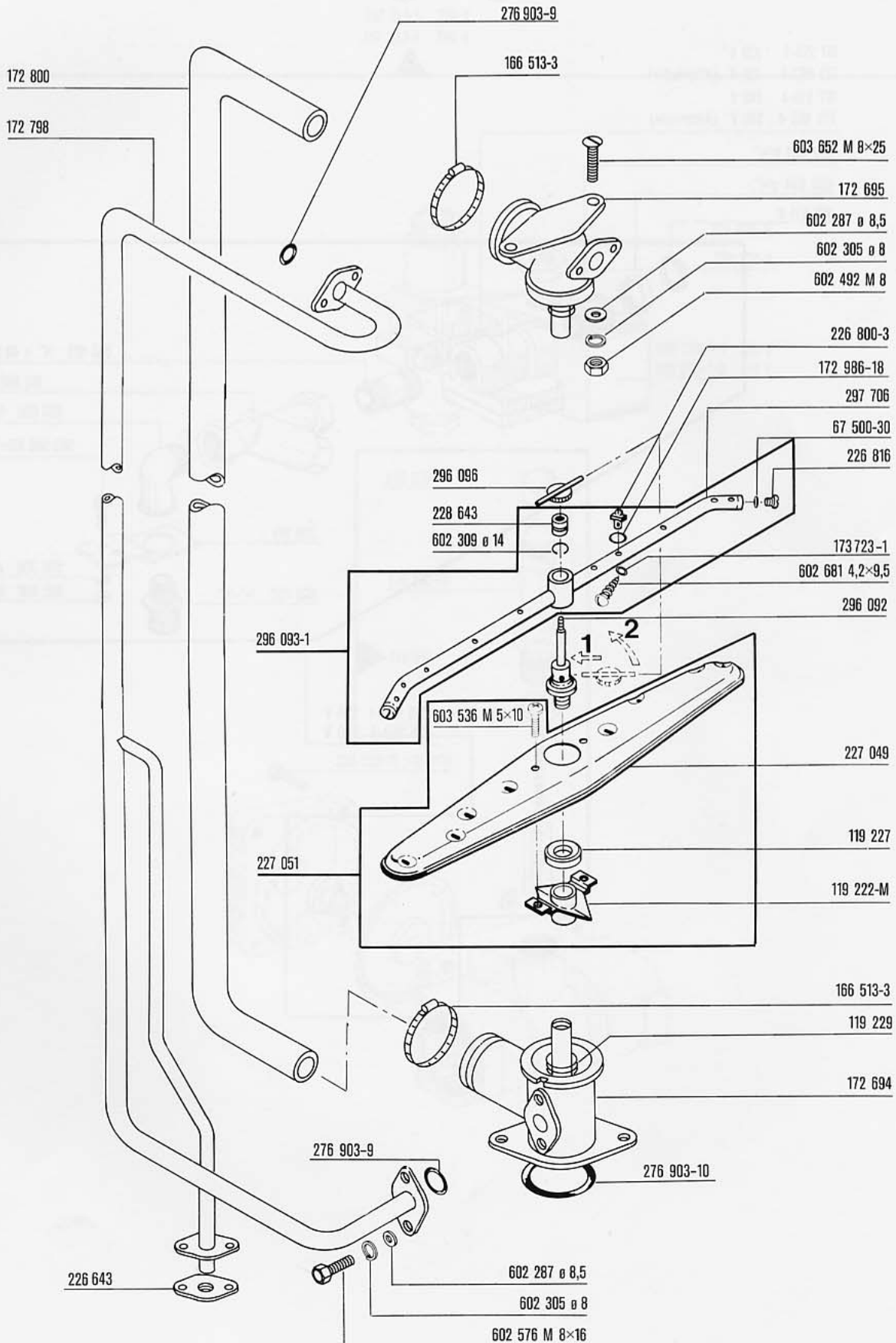

vsezip.ru

+7(812)987-08-81

- 167 213-1 220 V
- 173 863-1 220 V (Alternativ)
- 167 213-4 240 V
- 173 863-4 240 V (Alternativ)

602 407 R $\frac{3}{4}$ "

602 834 g $\frac{3}{4}$ "

168 611-9

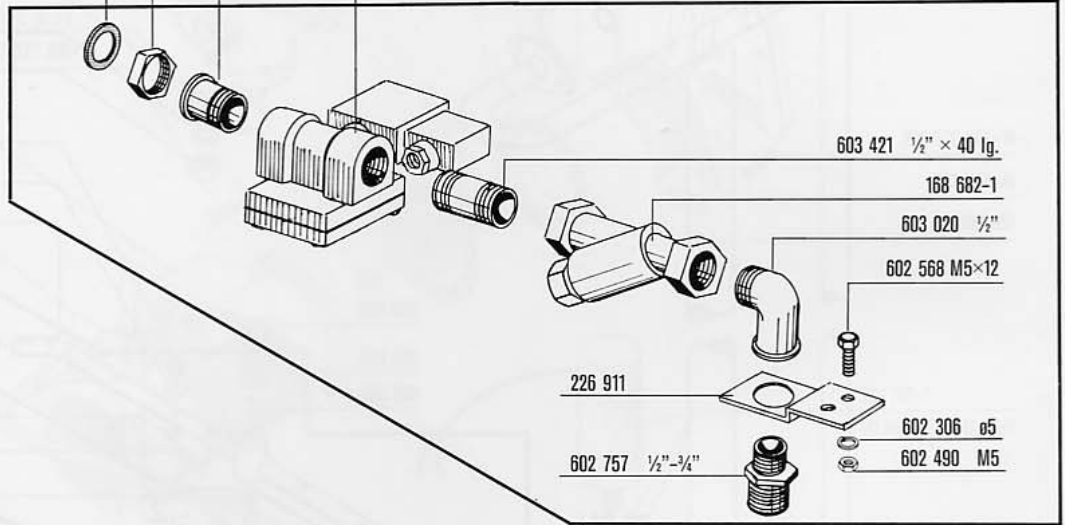

- 226 653-1 220 V
- 226 653-2 240 V



vsezip.ru

+7(812)987-08-81

167 213-1 220 V  
167 213-2 240 V

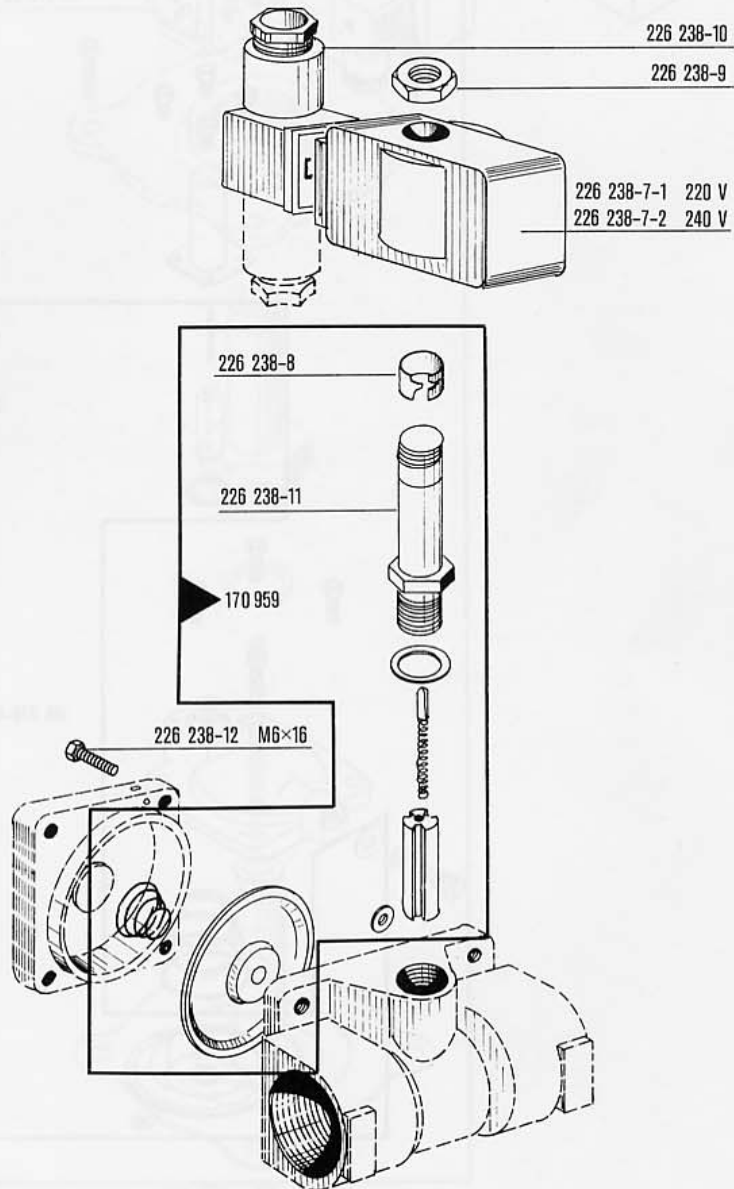

vsezip.ru

146 076-1 220 V

146 076-4 240 V

+7(812)987-08-81

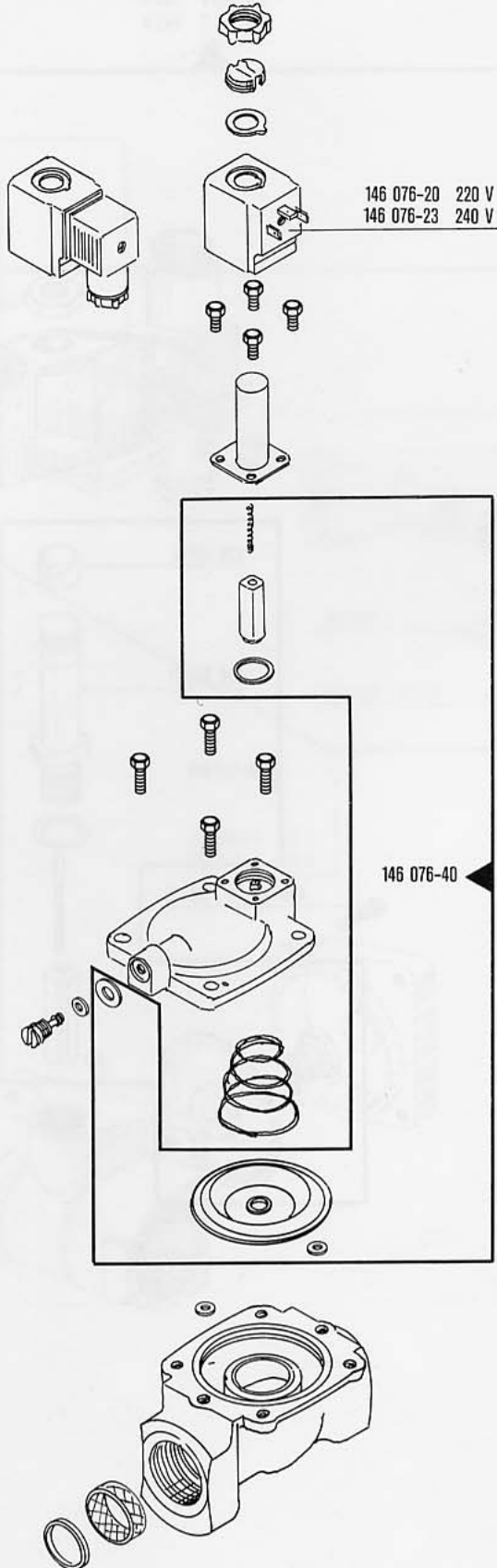

vsezip.ru

59 468

+7(812)987-08-81

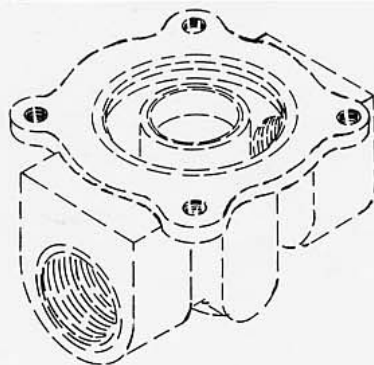
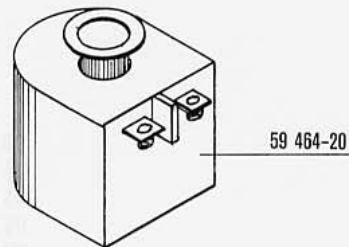
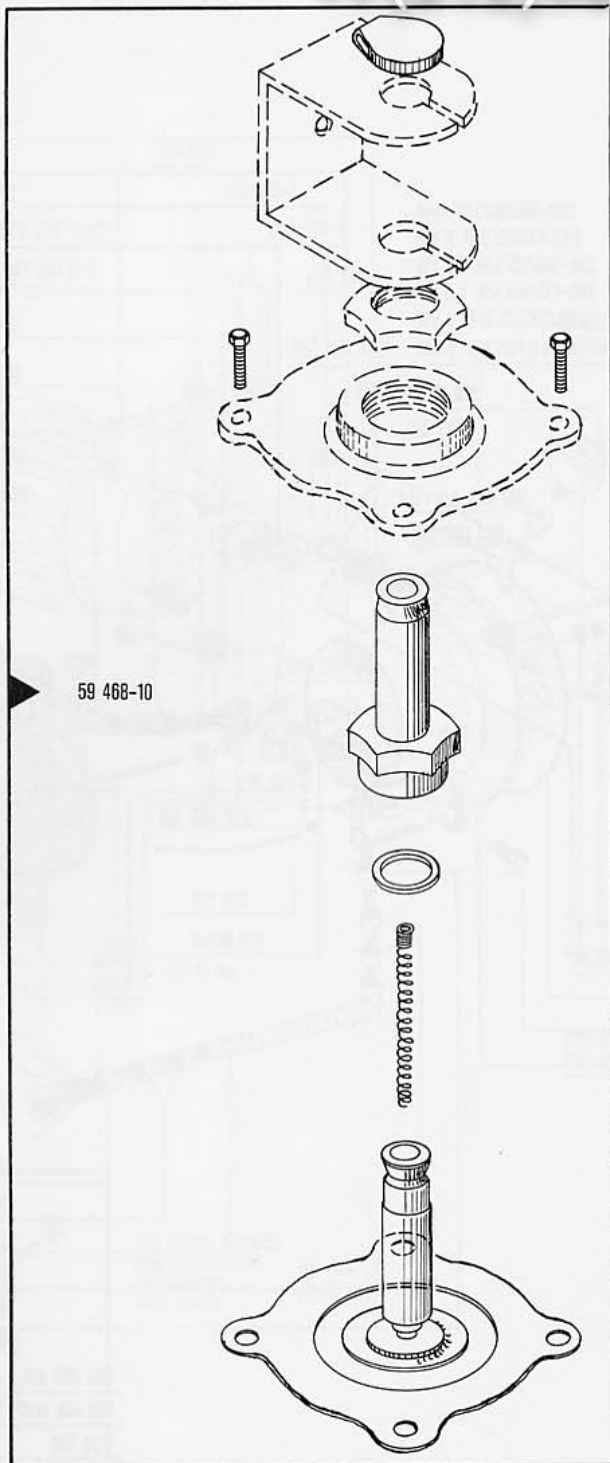

vsezip.ru

+7(812)987-08-81

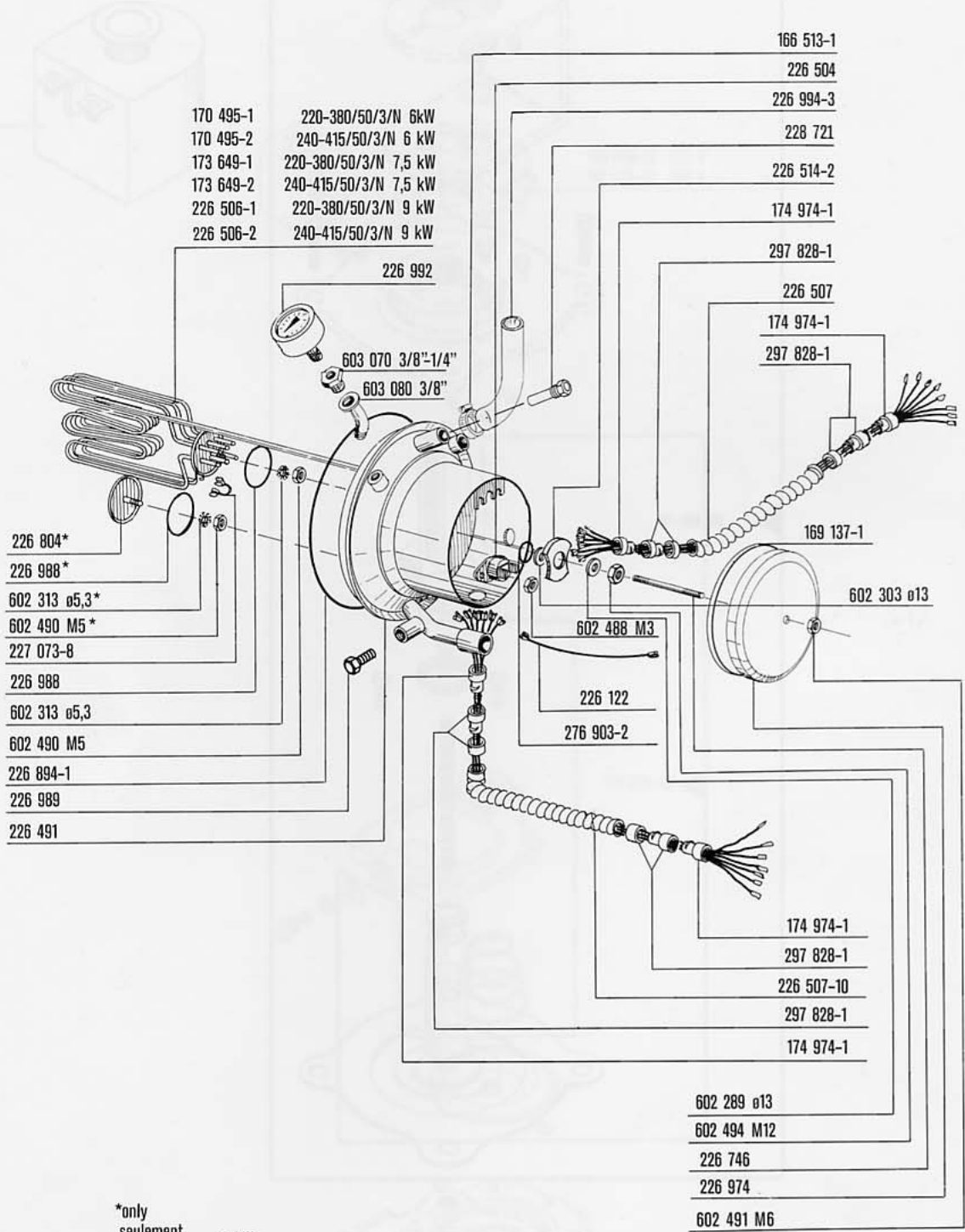

\*only  
 seulement  
 nur  
 alleen

9 kW

vsezip.ru

+7(812)987-08-81

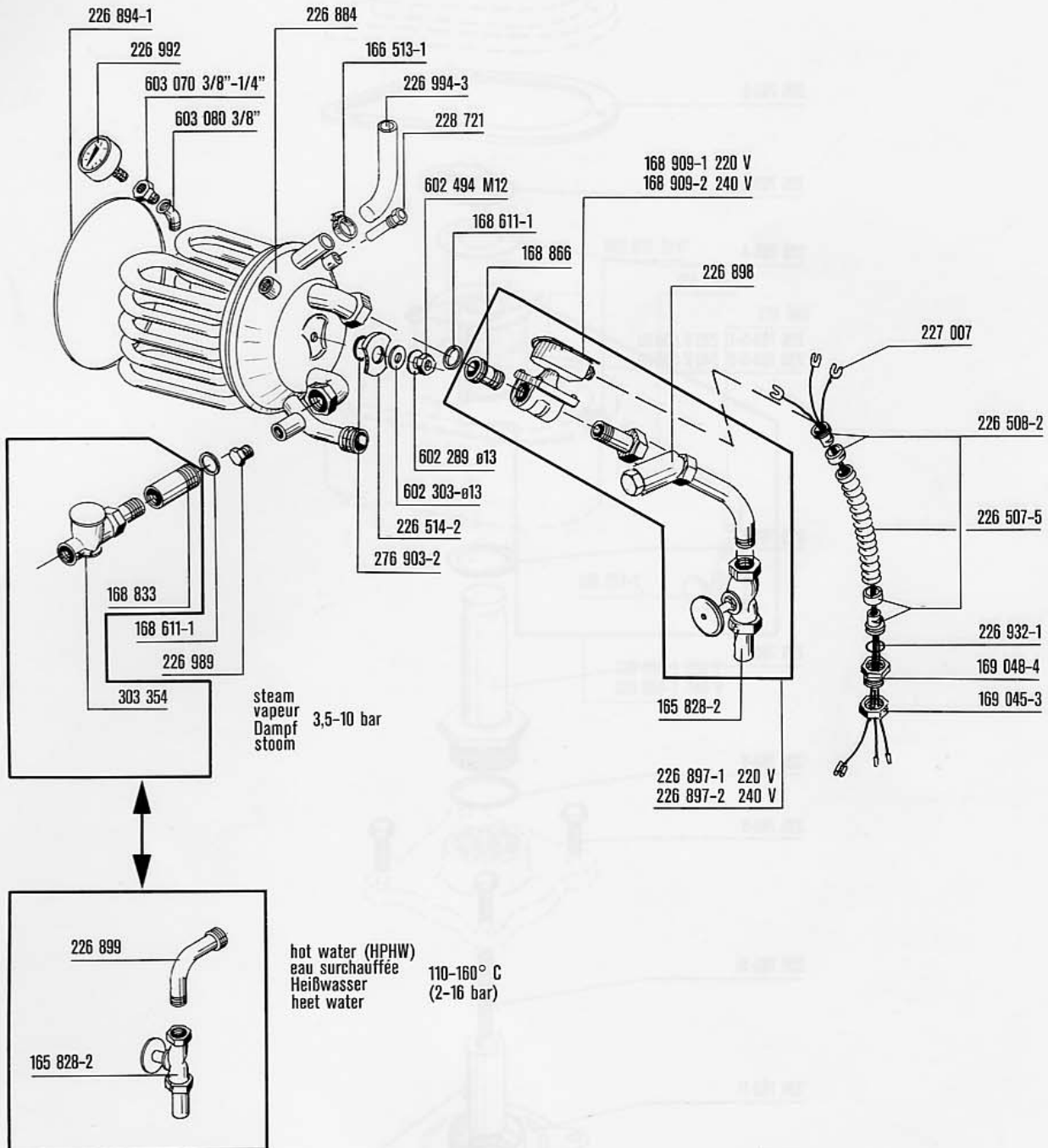

vsezip.ru

168 785-1 220 V

168 785-2 240 V

+7(812)987-08-81

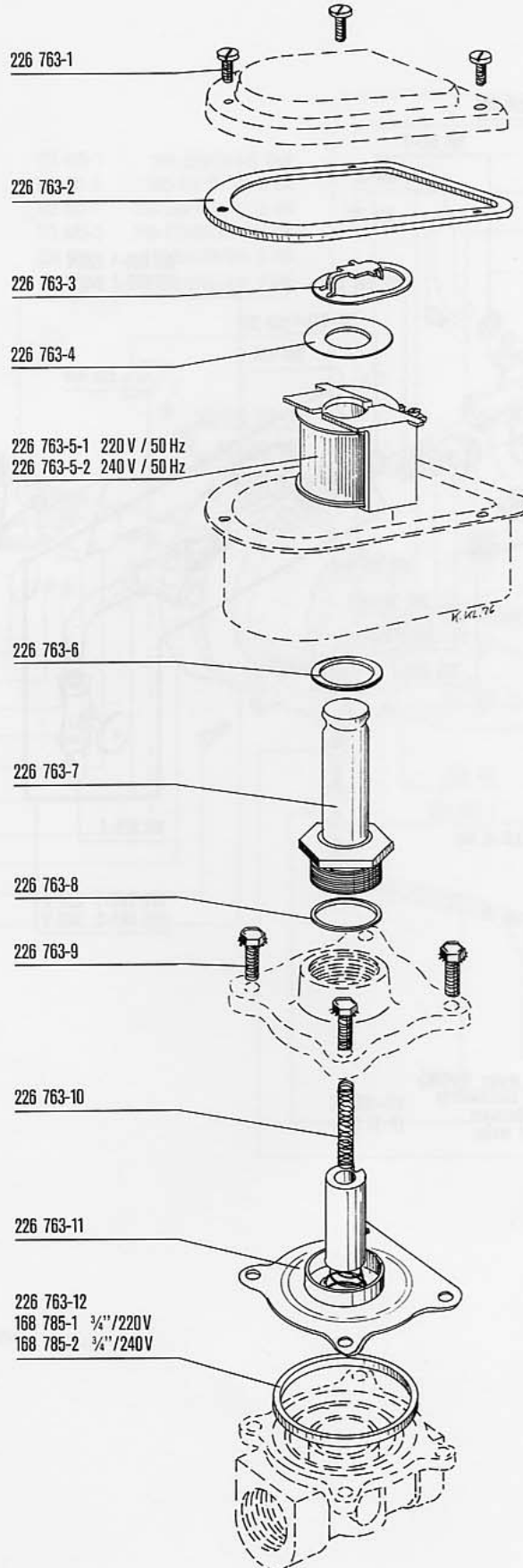

vsezip.ru

+7(812)987-08-81

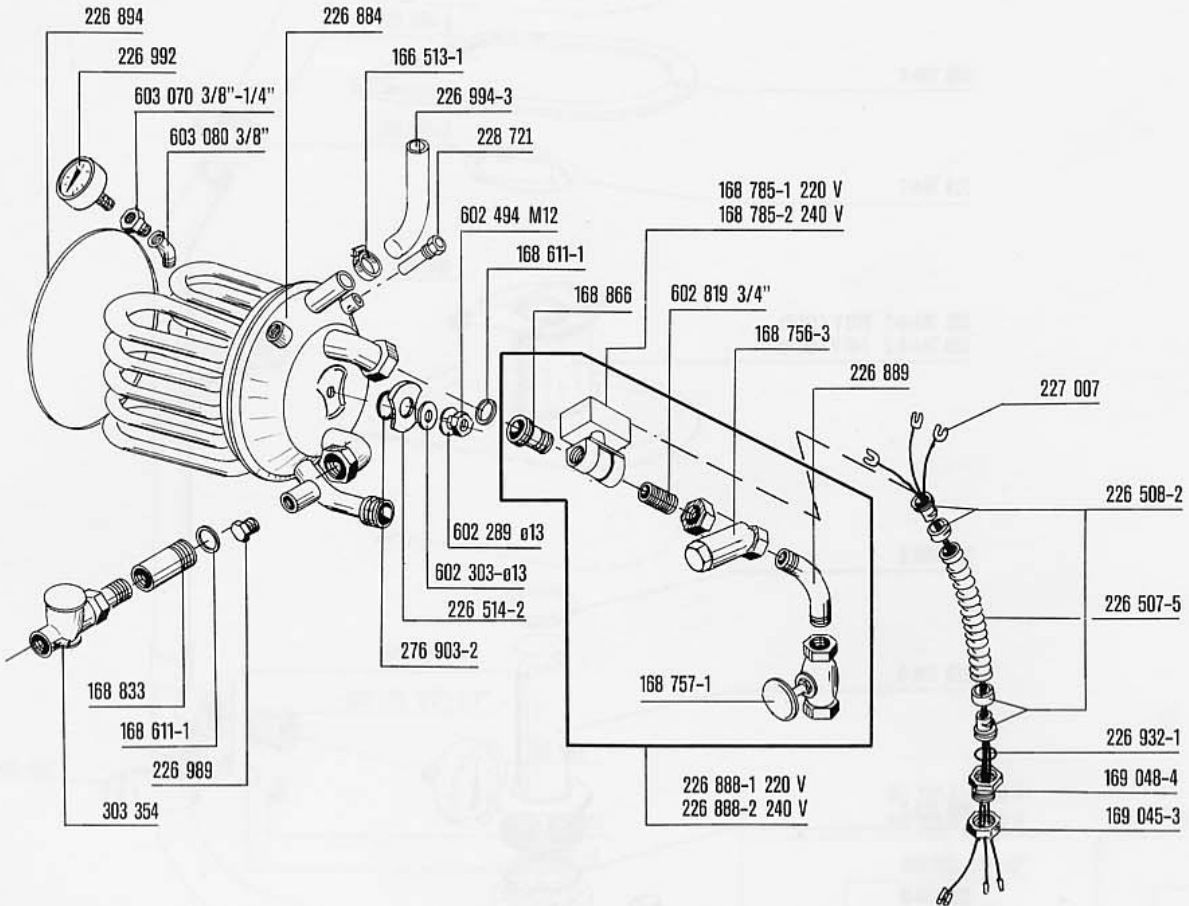



vsezip.ru

168 909-1 220 V

168 909-2 240 V

+7(812)987-08-81

226 764-1



226 764-2



226 764-3



226 764-4-1 220 V / 50 Hz

226 764-4-2 240 V / 50 Hz

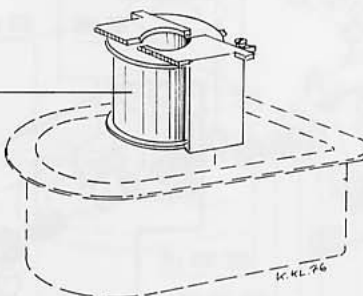

226 764-5



226 764-6



226 764-7



226 764-8

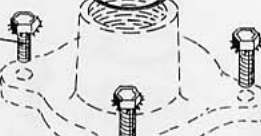

226 764-9



226 764-10



226 764-11



226 764-12



226 764-13

168 909-1 3/4" / 220 V

168 909-2 3/4" / 240 V



vsezip.ru

+7(812)987-08-81

for machines without rinse booster heater  
 pour les machines sans surchauffeur  
 für Maschinen ohne Durchlauferhitzer  
 voor machien zonder booster

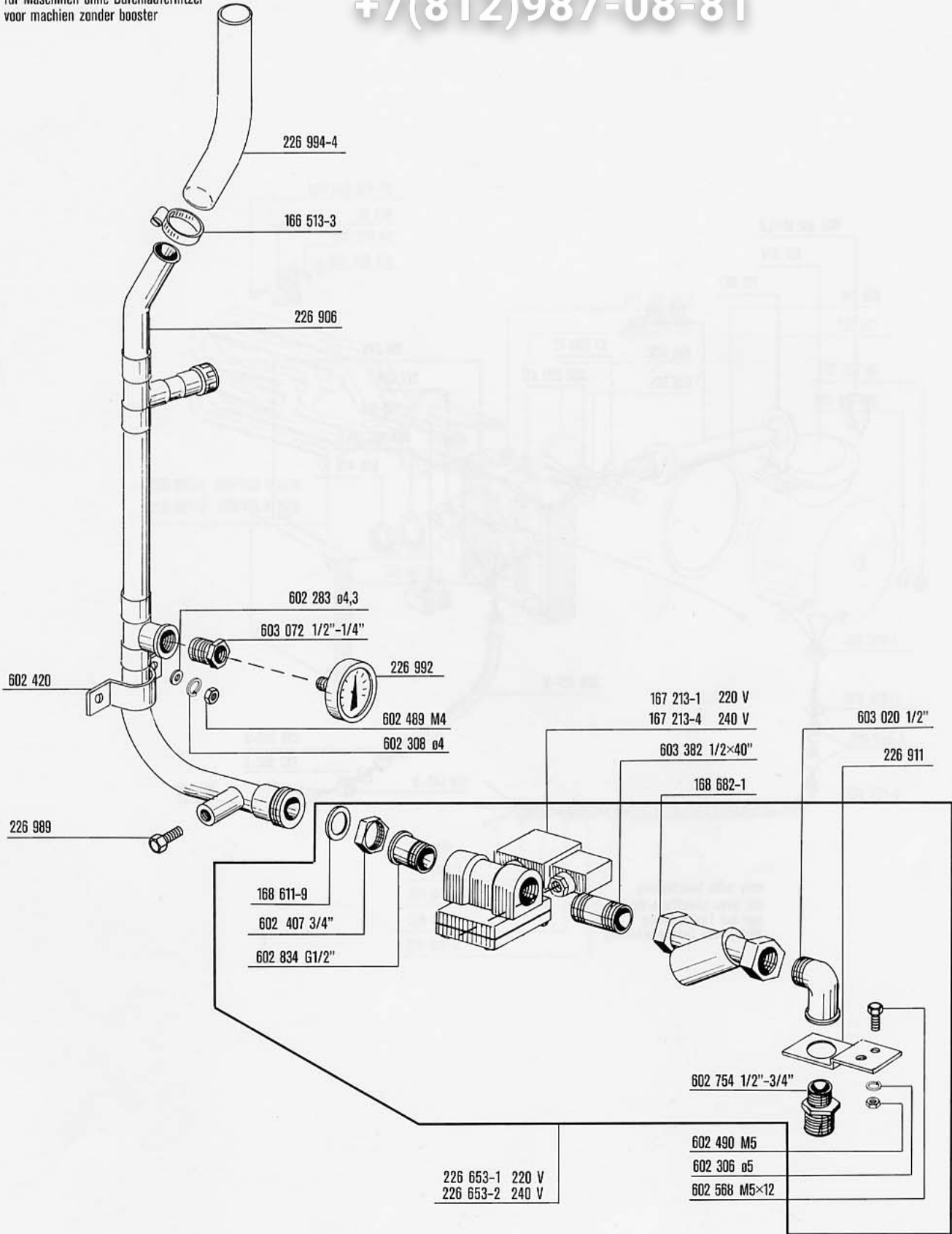

vsezip.ru

+7(812)987-08-81

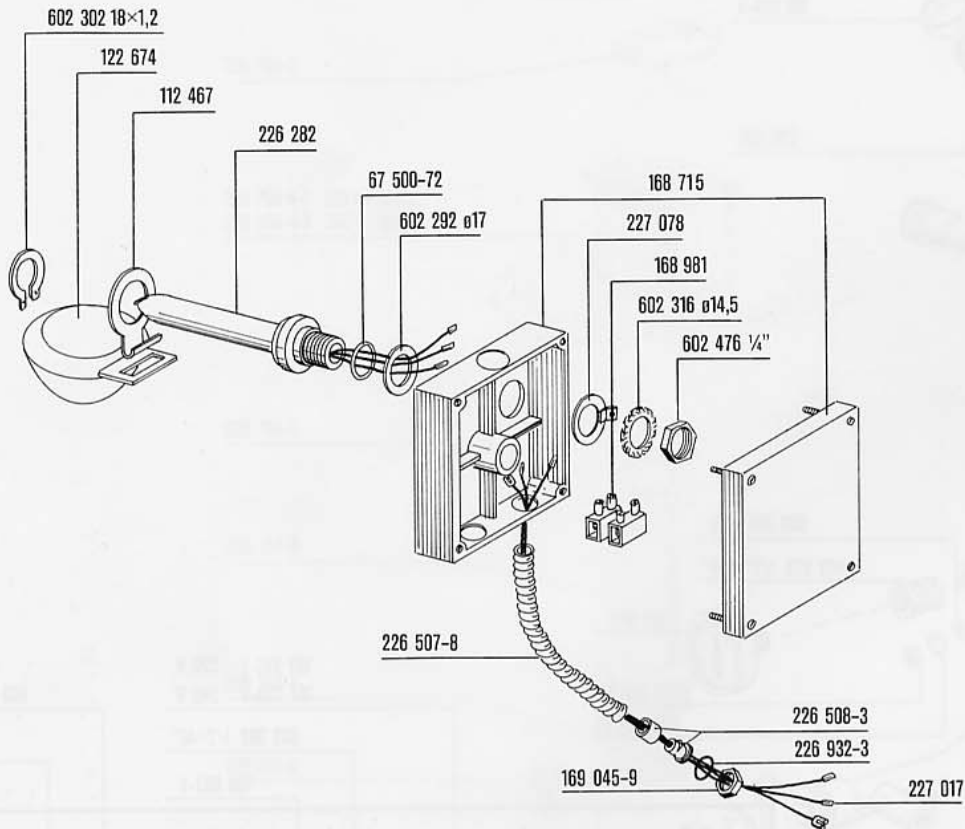

only with tankheating  
slt. avec chauffage du bac  
nur bei Tankheizung  
alleen met tankverwarming

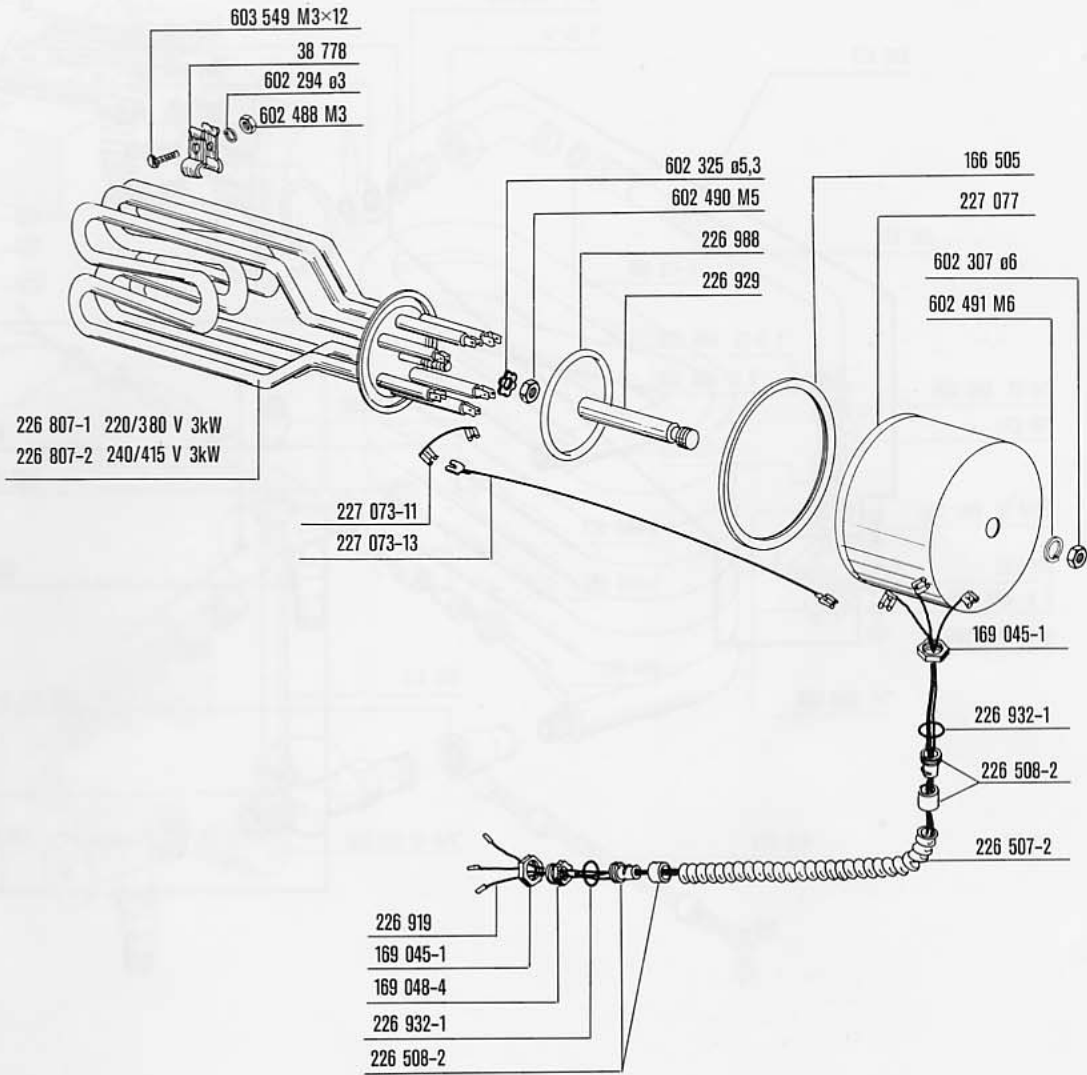

vsezip.ru

+7(812)987-08-81

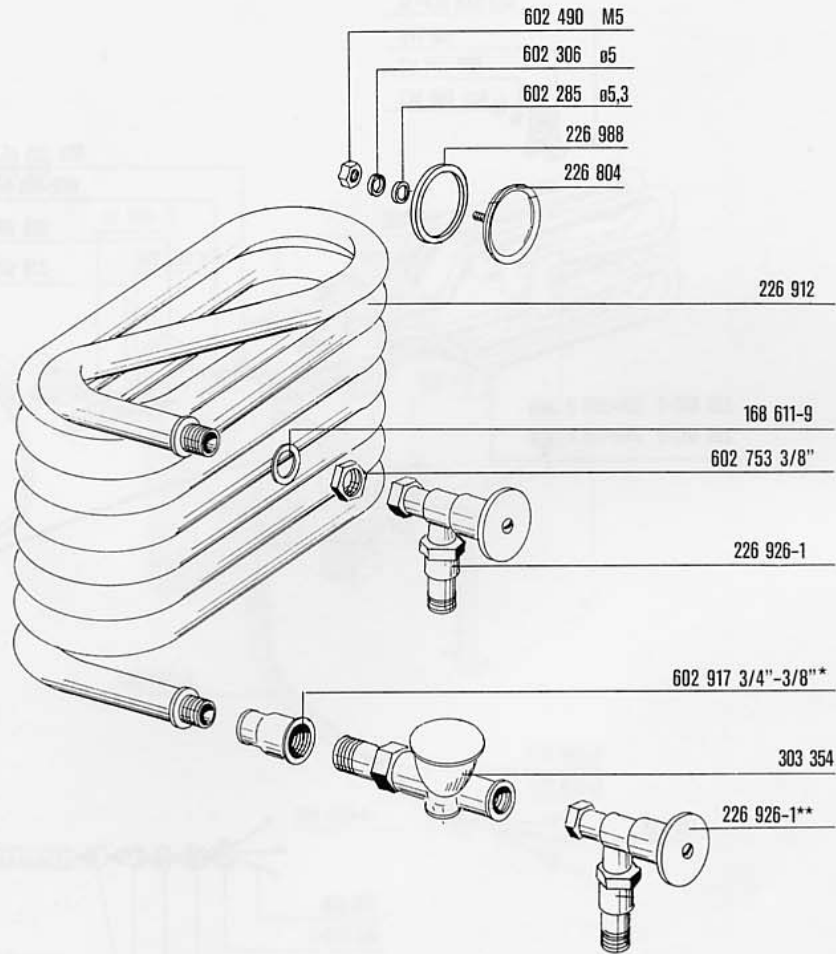

\* steam  
vapeur  
Dampf  
stoom

\*\* hot water  
eau surchauffée  
Heißwasser  
heet water

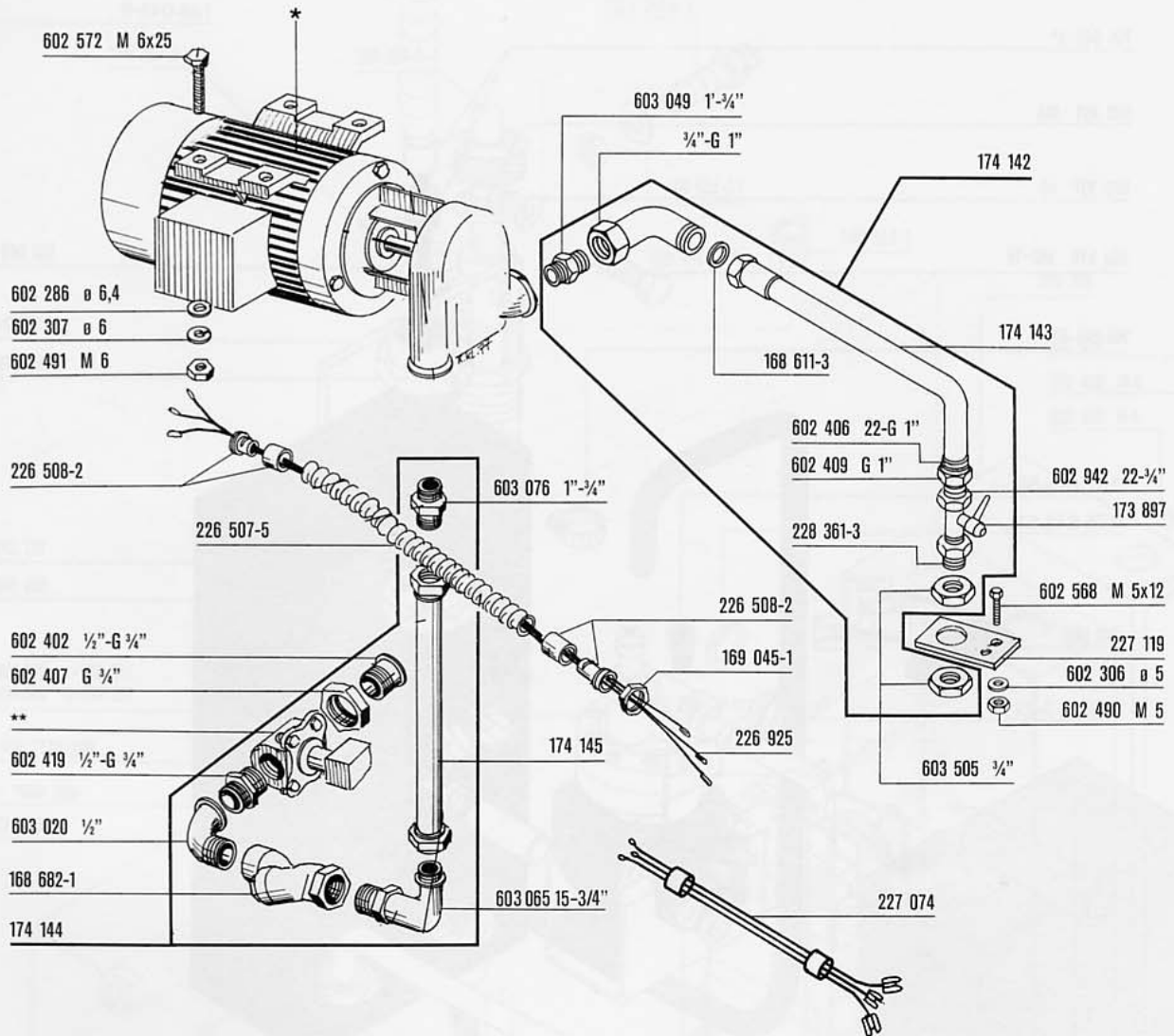

- \* 137 118-1 220/50/3  
380/50/3  
380/50/3/N
- 137 118-2 240/50/3  
415/50/3  
415/50/3/N
- 137 118-3 240/50/1
- 137 118-4 220/50/1

- \*\* 167 213-1 220/50/1  
220/50/3  
380/50/3  
380/50/3/N
- 59 486-1 240/50/1  
240/50/3  
415/50/3  
415/50/3/N

vsezip.ru

+7(812)987-08-81

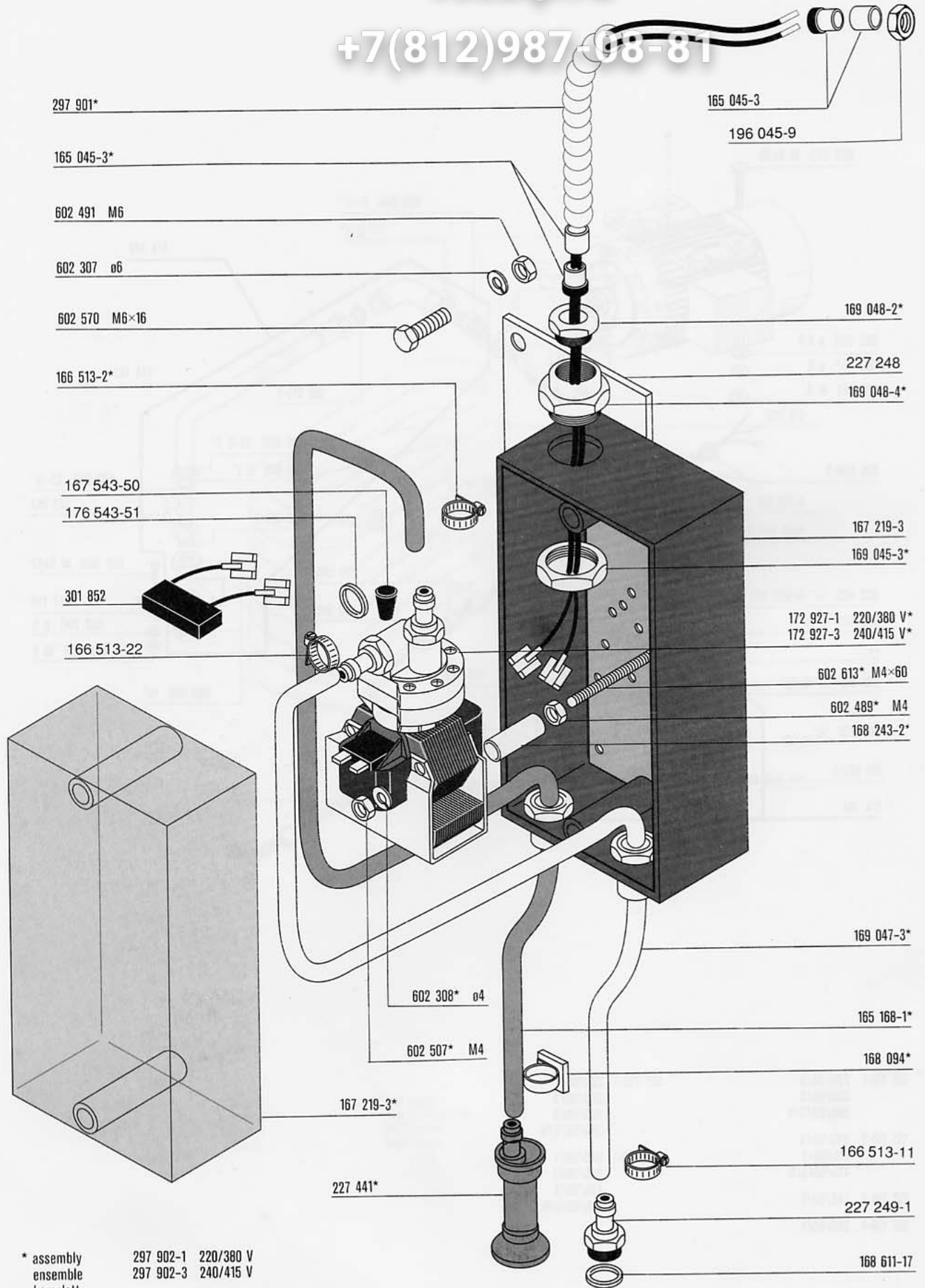

\* assembly 297 902-1 220/380 V  
 ensemble 297 902-3 240/415 V  
 komplett  
 zusammen



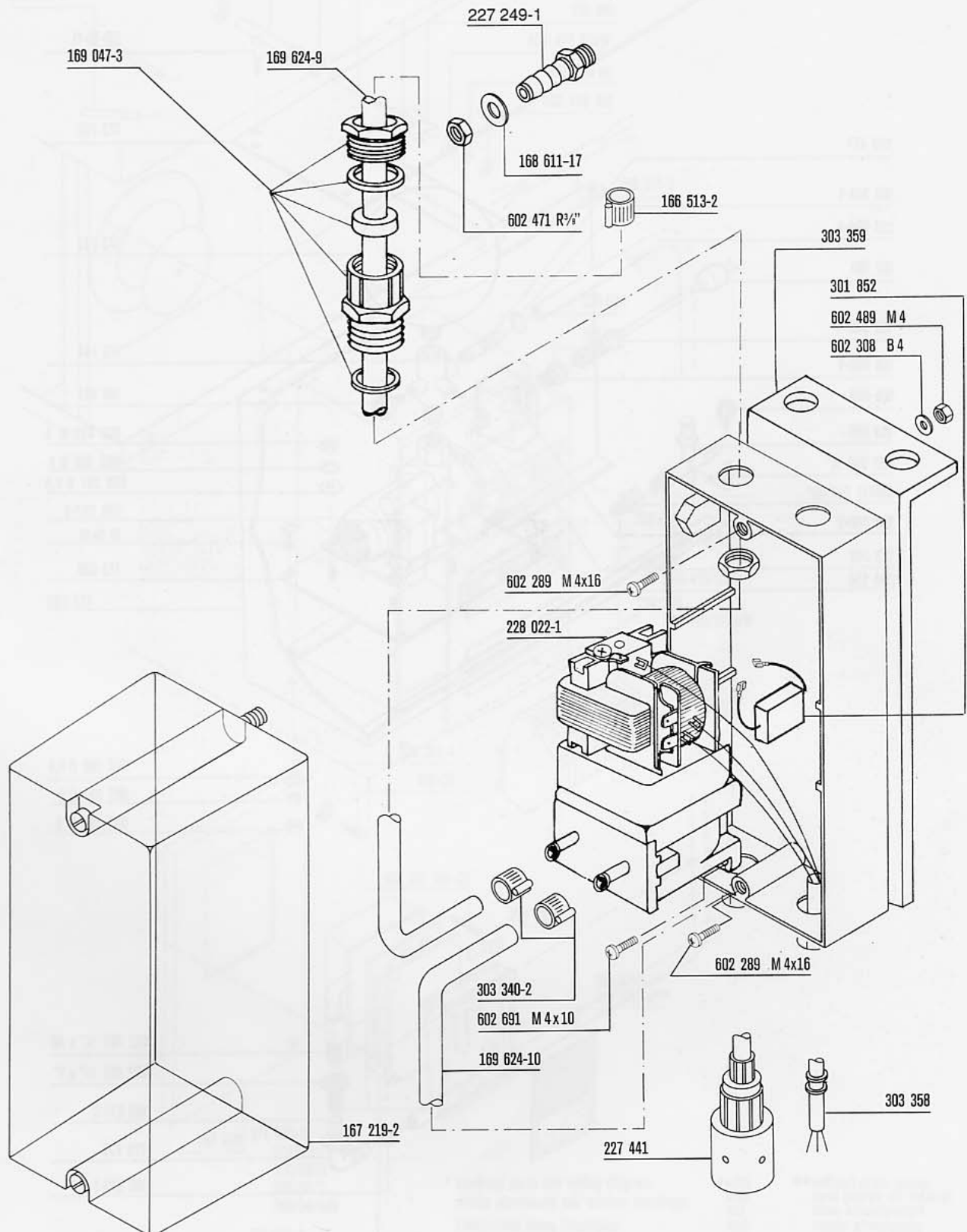

vsezip.ru

+7(812)987-08-81

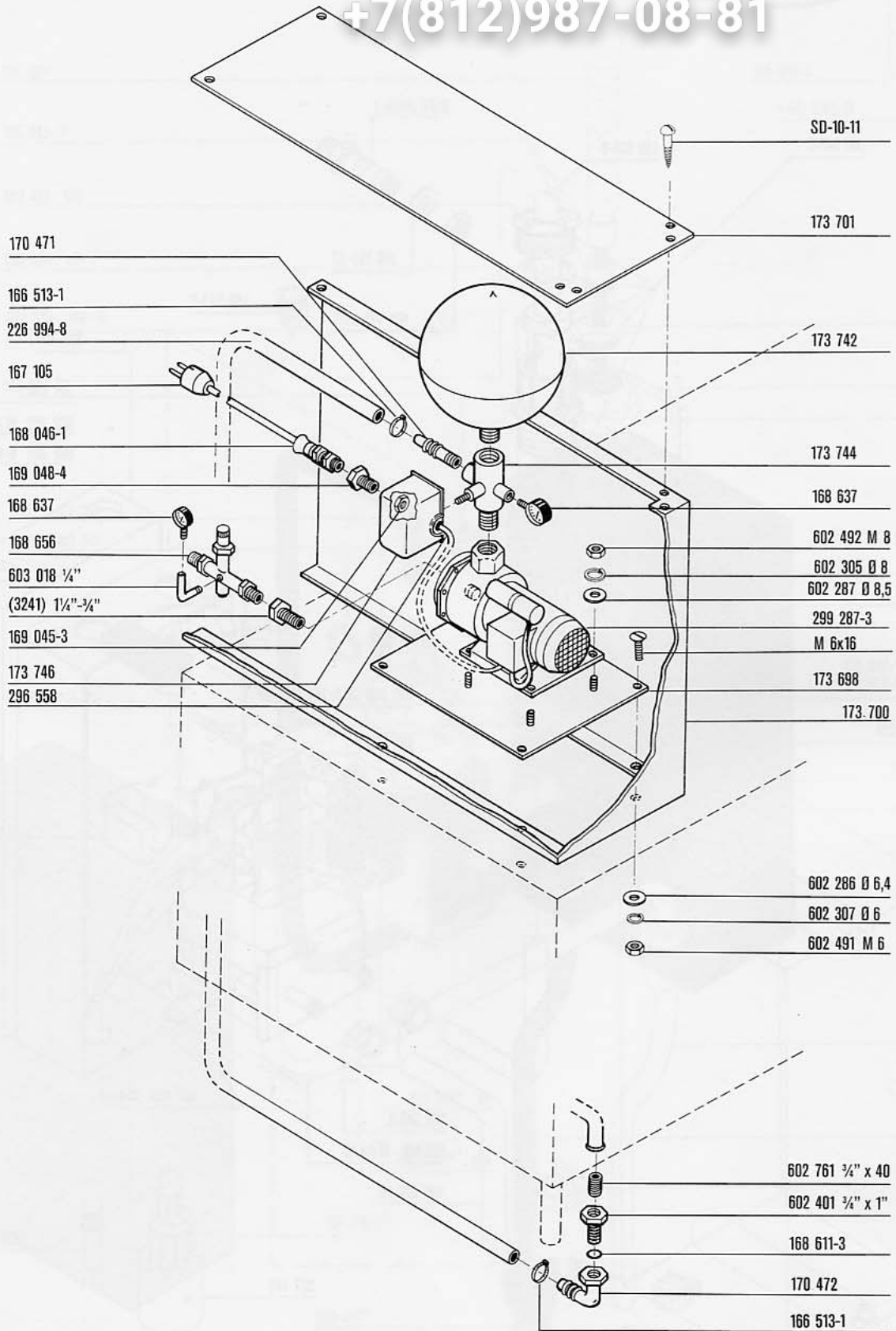

vsezip.ru

7(812)987-08-81

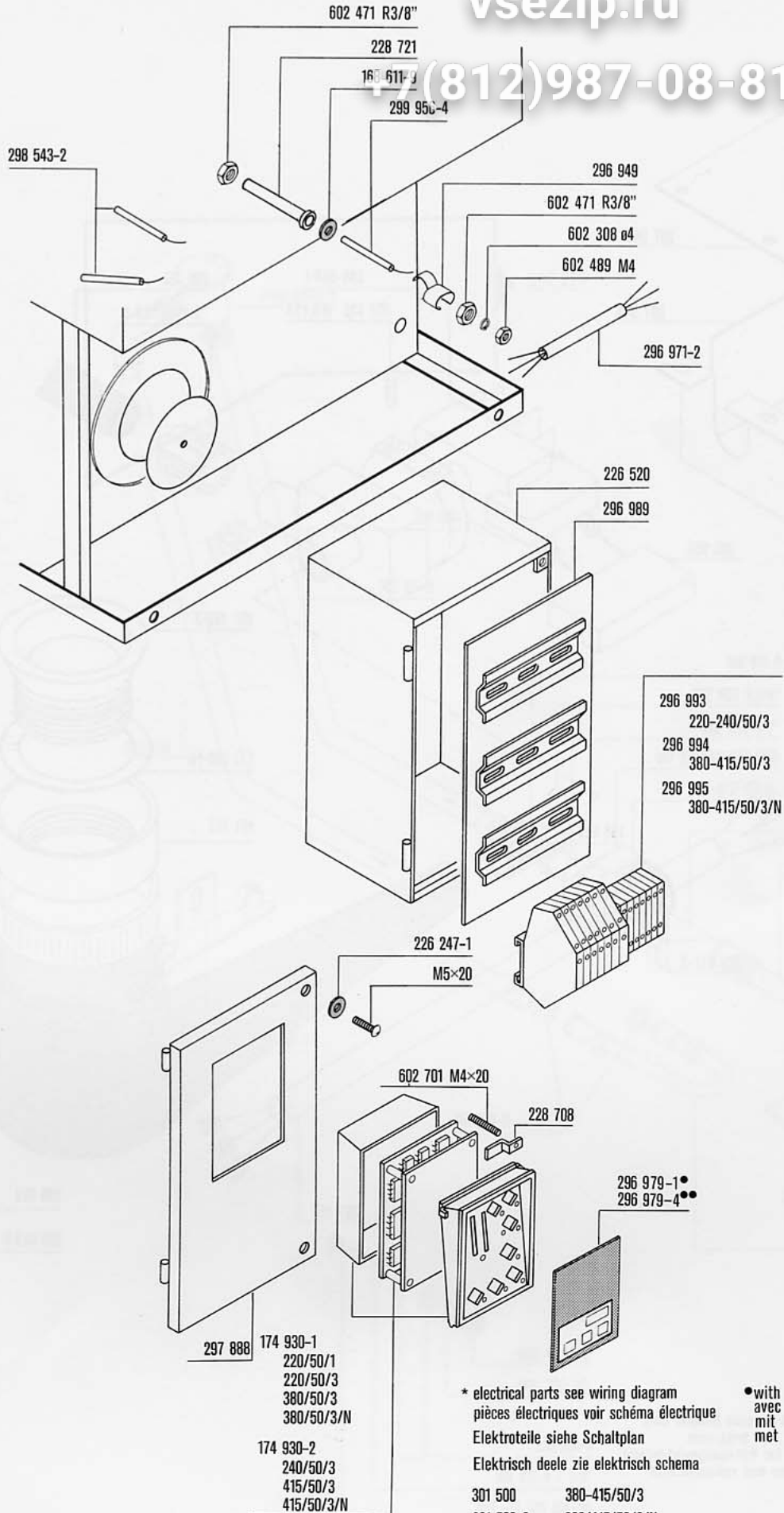

\* electrical parts see wiring diagram  
pièces électriques voir schéma électrique  
Elektroteile siehe Schaltplan  
Elektrisch deele zie elektrisch schema

• with  
avec  
mit  
met

•• without drain pump  
sans pompe de vidange  
ohne Ablaufpumpe  
zonder afvoerpomp

- |           |                |
|-----------|----------------|
| 301 500   | 380-415/50/3   |
| 301 500-2 | 380/415/50/3/N |
| 301 500-3 | 220-240/50/3   |

vsezip.ru

+7(812)987-08-81

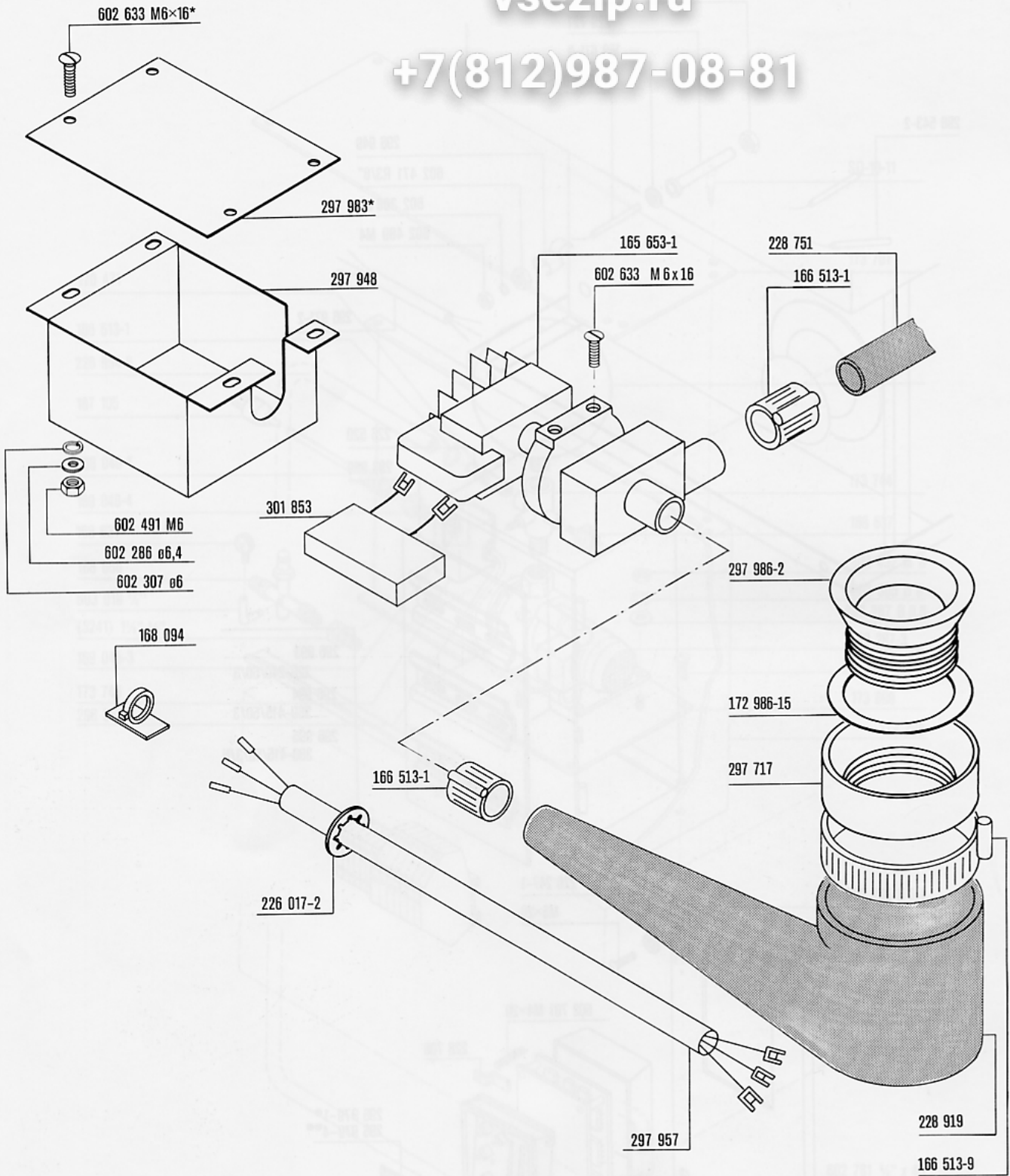

\*with vacuum breaker only  
 slt. avec brise-vide  
 nur bei Rücksaugeverhinderer  
 alleen met vakuumbreker

vsezip.ru

+7(812)987-08-81

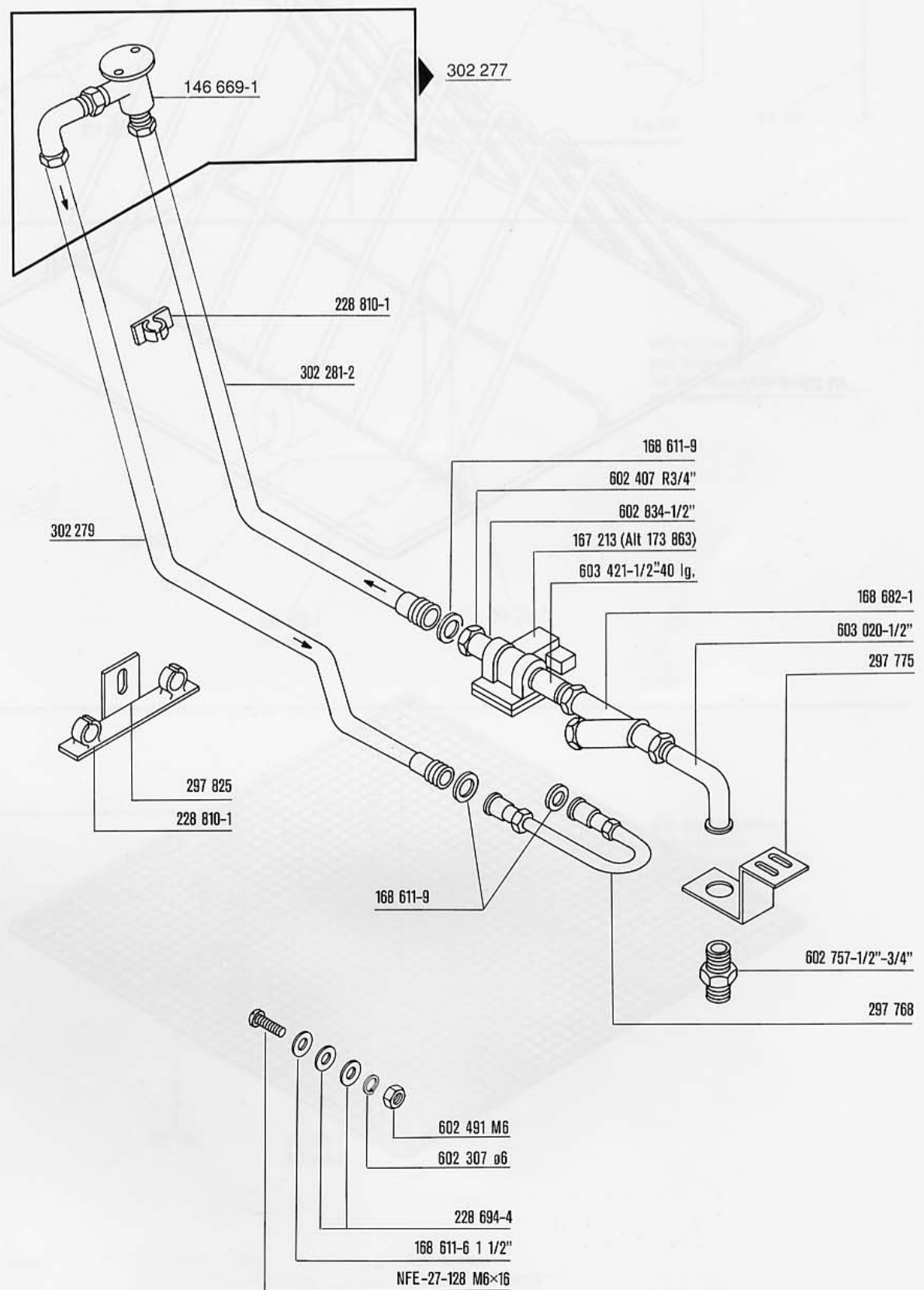

vsezip.ru

+7(812)987-08-81

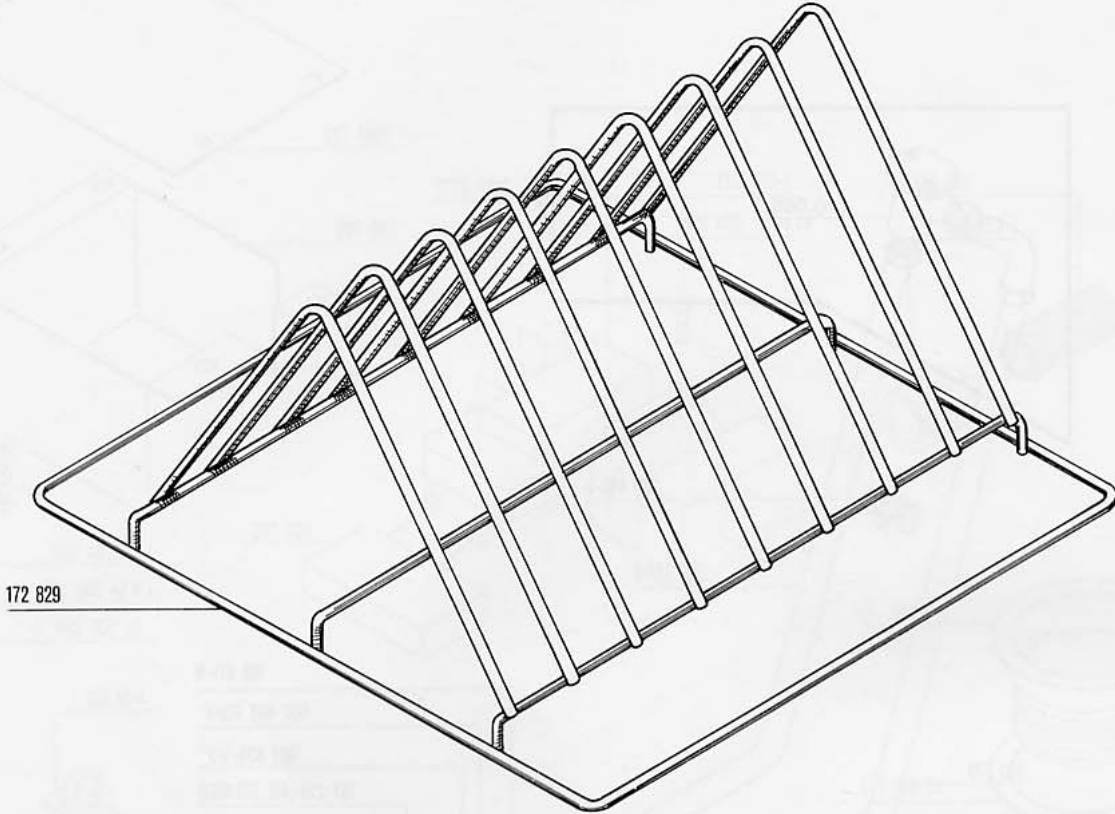

172 829

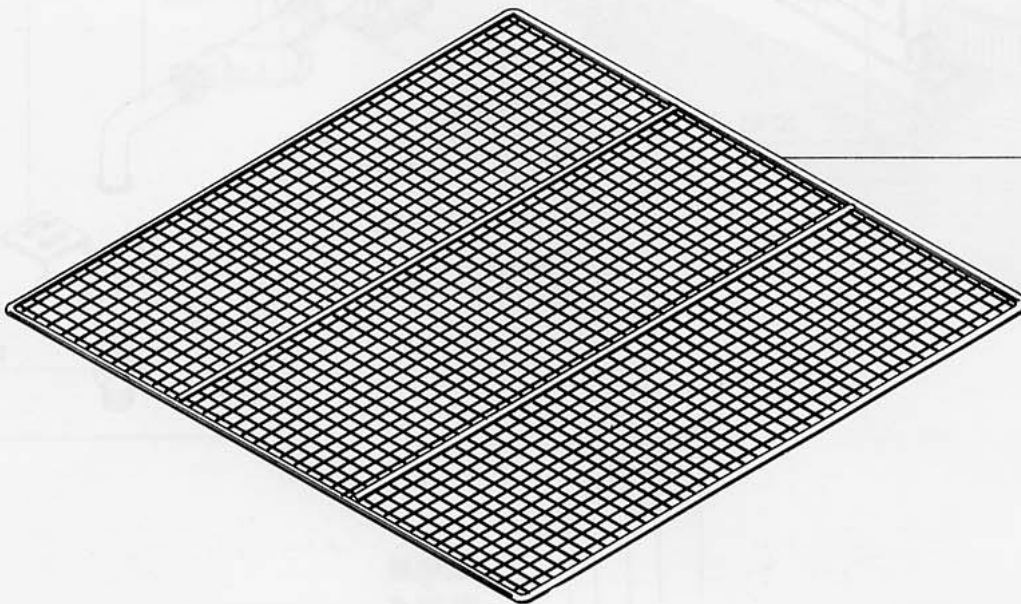

172 831



vsezip.ru

+7(812)987-08-81

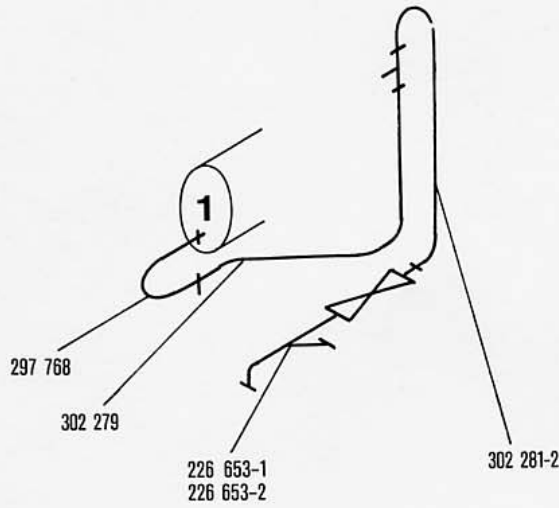
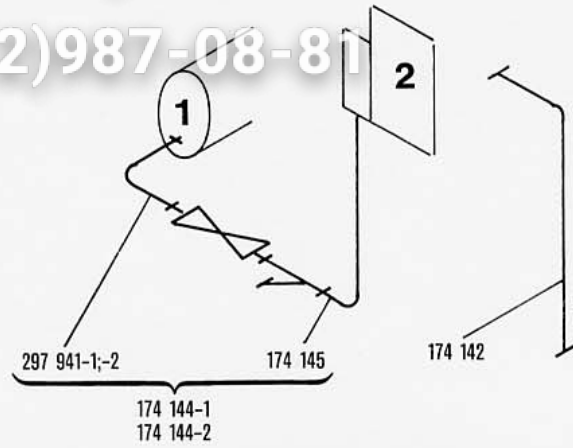
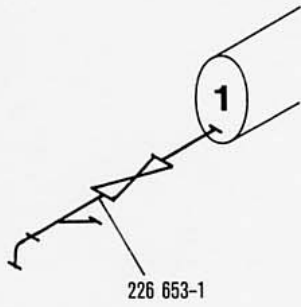

with vacuum breaker  
avec brise-vide  
mit Rücksaugeverhinderer  
met vakuumbreker

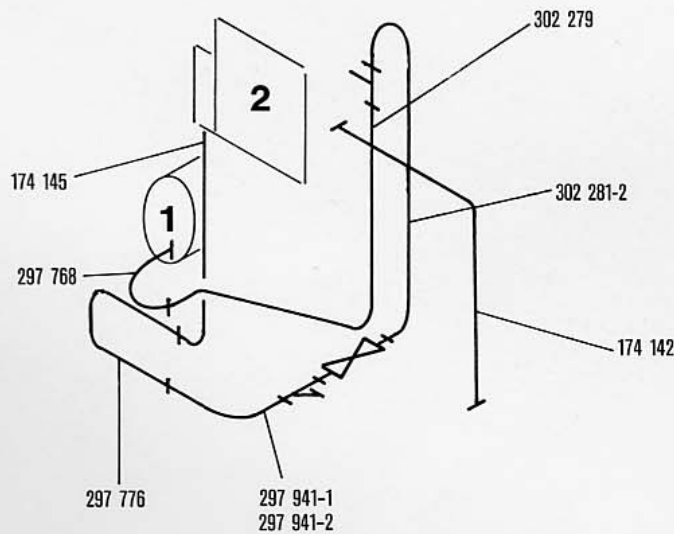

with vacuum breaker  
avec brise-vide  
mit Rücksaugeverhinderer  
met vakuumbreker

1 = Rinse booster heater  
Surchauffeur  
Durchlauferhitzer  
Booster

2 = Rinse pressure pump  
Pompe élévatrice de pression  
Drucksteigerungspumpe  
Spoeldrukomp

3 = Heat recovery  
Récupération d'énergie  
Wärmerückgewinnung  
Energierugwinning