

Зип Общепит

vsezip.ru

---

DESPIECE TECNICO

---

+7(812)987-08-81

**Freidoras a gas de calentamiento indirecto**  
**Gas deep fat fryers indirect heating**  
**Friteuses a gaz cuve en "V"**  
**Gas-fritteusen indirekt beheizt**  
**Friggitrici a gas riscaldamento indiretto**  
**Fritadeiras a gás aquecimento indireto**

**GAMA 900**

**Modelos:**

**FGCL9-05 1C**

**FGCL9-05 2C**

***Junio 2010 June***

*Revisado Marzo 2014 March Revised*



---

F A G O R I N D U S T R I A L

Зип Общепит

vsezip.ru

+7(812)987-08-81

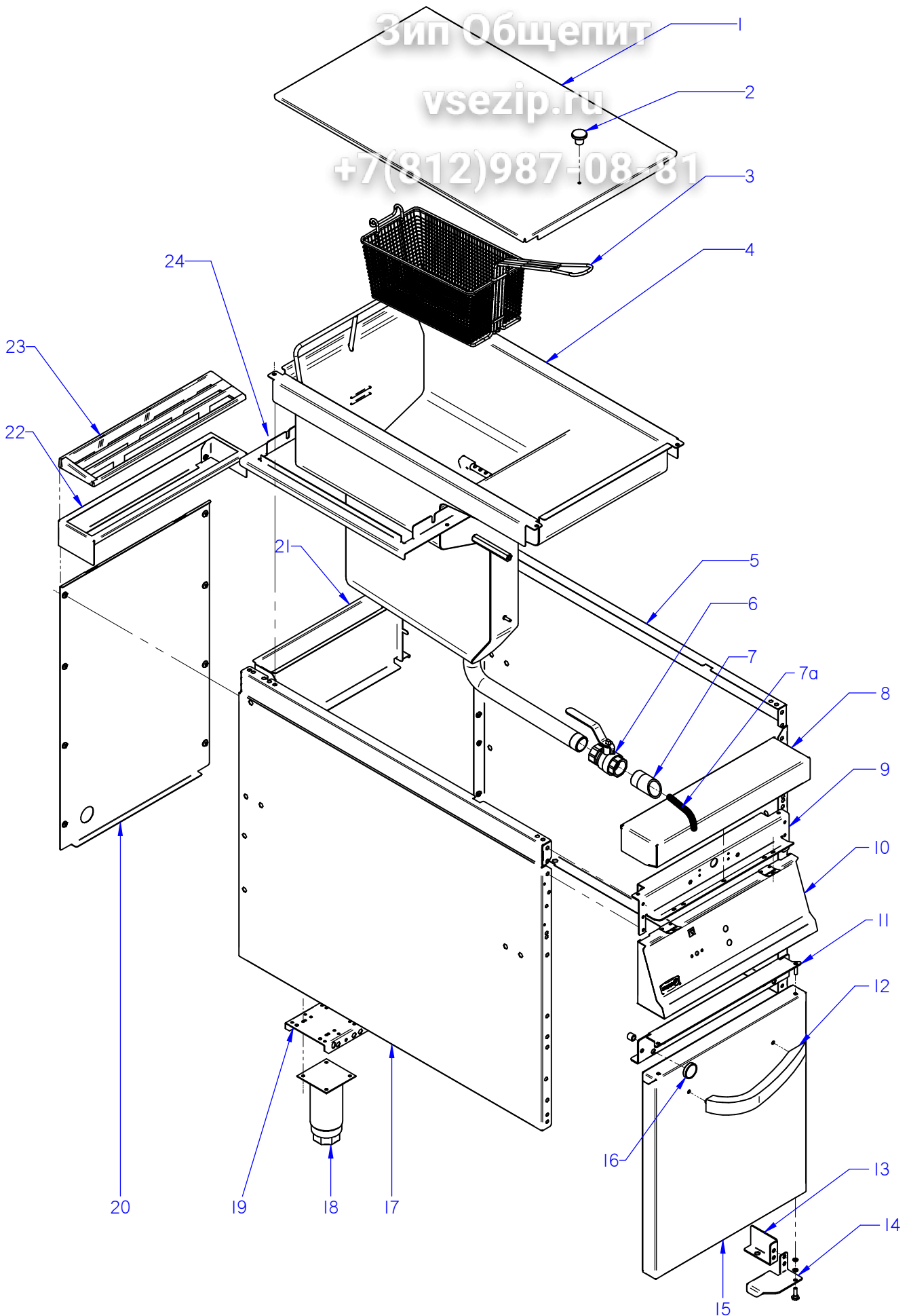

ITEM MARCADO EN COLOR = REPUESTO RECOMENDADO  
COLOURED ITEM = RECOMMENDED SPARE PART

|         |               |         |                    |                  |        |                                       |
|---------|---------------|---------|--------------------|------------------|--------|---------------------------------------|
| N plano | Firma         | Fecha   | Aparato            | MUEBLE / FITTING | Lamina | Fagor Industrial S.Coop. <b>FAGOR</b> |
| C-2665  | name (benjor) | 2010-06 | FREIDORAS FGCL9-05 |                  | 1      | Oñate                                 |

| MOD. | FREIDORAS / FRYERS | ZONA / ZONE                   | MUEBLE / FITTING              |             |             |              |              |
|------|--------------------|-------------------------------|-------------------------------|-------------|-------------|--------------|--------------|
| ITEM | CODIGO CODE        | DENOMINACION                  | NAME                          | FGCL9-05 2C | FGCL9-05 1C | FGCL9-05S 2C | FGCL9-05S 1C |
| 1    | X506127000         | TAPA DE CUBA FGCL9-05         | COVER FG9-00 FGCL9-05         | 1           | 1           | 1            | 1            |
| 2    | X166154000         | POMO PARA TAPA                | COVER KNOB                    | 1           | 1           | 1            | 1            |
|      | Q012032000         | TORNILLO EXAGONAL M5X15       | HEXAGONAL BOLT M5X15          | 6           | 6           | 6            | 6            |
| 3    | X166525000         | CESTILLO PEQUEÑO G900         | SMALL BASKET G900             | 2           |             | 2            |              |
| 3    | X166526000         | CESTILLO GRANDE G900          | LARGE BASKET G900             |             | 1           |              | 1            |
| S/Nº | X166522000         | REJILLA COMPLETA              | COMPLETE GRILLE               | 1           | 1           | 1            | 1            |
| 4    | X506101000         | CUBA LIMPIA COMPLETA          | CUBA COMPLETE CLEAN           | 1           | 1           | 1            | 1            |
|      | Q012043000         | TORNILLO EXAGONAL M6X20       | HEXAGONAL BOLT M6X20          | 1           | 1           | 1            | 1            |
|      | Q302022000         | ARANDELA 16X6X1.2 A.304       | WASHER 16X6X1.2 A.304         | 1           | 1           | 1            | 1            |
|      | Q012032000         | TORNILLO EXAGONAL M5X15       | HEXAGONAL BOLT M5X15          | 6           | 6           | 6            | 6            |
| 5    | X162814000         | PANEL LATERAL DERECHO G900    | RIGHT SIDE PANEL G900         | 1           | 1           |              |              |
| 5    | S142806000         | PANEL LATERAL DERECHO G900S   | RIGHT SIDE PANEL G900S        |             |             | 1            | 1            |
|      | Q221342000         | REMACHE EXAGONAL M5           | HEXAGONAL RIVET M5            | 3           | 3           | 3            | 3            |
|      | Q221343000         | REMACHE EXAGONAL M6           | HEXAGONAL RIVET M6            | 4           | 4           | 4            | 4            |
|      | Q221342000         | REMACHE EXAGONAL M5           | HEXAGONAL RIVET M5            | 3           | 3           | 3            | 3            |
| 6    | X036107000         | VALVULA ESFERA PASO TOTAL 1   | SPHERICAL VALVE TOTAL PASS    | 1           | 1           | 1            | 1            |
| 7    | X506129000         | PUNTA DESAGÜE (CUBA LIMPIA)   | DRAINAGE POINT (CLEAN TUB)    | 1           | 1           | 1            | 1            |
| 7a   | 11000006           | TUBO SILICONA BAJA Tª D 38*31 | SILICONE PIPE Tª D 38 * 31    | 1           | 1           | 1            | 1            |
| 8    | R045416000         | ANTERIOR MESA 1/2 M           | FRONT BENCH 1/2 M G-900       | 1           | 1           | 1            | 1            |
|      | Q152004000         | TORNIL. APLASTADO M5X13 A 304 | FLAT HEADED SCREW M5x13 A 304 | 2           | 2           | 2            | 2            |
|      | Q302022000         | ARANDELA 16X6X1.2 A.304       | WASHER 16X6X1.2 A.304         | 1           | 1           | 1            | 1            |
| 9    | X162690000         | ESCUAD INTER ANTER MESA 1/2M  | BENCH FRONT INT. BRACKET 1/2  | 1           | 1           | 1            | 1            |
|      | Q221342000         | REMACHE EXAGONAL M5           | HEXAGONAL RIVET M5            | 3           | 3           | 3            | 3            |
|      | Q012032000         | TORNILLO EXAGONAL M5X15       | HEXAGONAL BOLT M5X15          | 6           | 6           | 6            | 6            |
|      | Q302022000         | ARANDELA 16X6X1.2 A.304       | WASHER 16X6X1.2 A.304         | 1           | 1           | 1            | 1            |
| 10   | X502811000         | PORTAMANDOS COMP. FG-905      | CONTROL HOLDER FG-905         | 1           | 1           | 1            | 1            |
|      | Q152004000         | TORNIL. APLASTADO M5X13 A 304 | FLAT HEADED SCREW M5x13 A 304 | 2           | 2           | 2            | 2            |
|      | U022836000         | ESCUDO FAGOR                  | FAGOR EMBLEM                  | 1           | 1           | 1            | 1            |
|      | Q221023000         | CLIP SUJECIÓN RÁPIDA Ø5       | RAPID CONNECT CLIP Ø5         | 2           | 2           | 2            | 2            |
| 11   | X162669000         | LISTON BISAGRA SUPERIOR DCH.  | UPPER RIGHT HINGE STRIP       | 1           | 1           | 1            | 1            |
|      | Q152004000         | TORNIL. APLASTADO M5X13 A 304 | FLAT HEADED SCREW M5x13 A 304 | 2           | 2           | 2            | 2            |

| MOD. |             | FREIDORAS / FRYERS            | ZONA / ZONE                   | MUEBLE / FITTING |             |              |              |
|------|-------------|-------------------------------|-------------------------------|------------------|-------------|--------------|--------------|
| ITEM | CODIGO CODE | DENOMINACION                  | NAME                          | FGCL9-05 2C      | FGCL9-05 1C | FGCL9-05S 2C | FGCL9-05S 1C |
| 12   | U020507000  | ASA ARMARIO COMPLETO G900     | FULL CUPBOARD HANDLE G700     | 1                | 1           | 1            | 1            |
|      | Q162040000  | TUERCA EXAGONAL M6            | HEXAGONAL NUT M6              | 2                | 2           | 2            | 2            |
|      | Q302022000  | ARANDELA 16X6X1.2 A.304       | WASHER 16X6X1.2 A.304         | 2                | 2           | 2            | 2            |
| 13   | U020526000  | ESCUADRA REFUERZO BISAG DE.   | R. HINGE REINFORCE. BRACKET   | 1                | 1           | -            | -            |
|      | Q221343000  | REMACHE EXAGONAL M6           | HEXAGONAL RIVET M6            | 1                | 1           | -            | -            |
|      | Q221342000  | REMACHE EXAGONAL M5           | HEXAGONAL RIVET M5            | 2                | 2           | -            | -            |
|      | Q152004000  | TORNIL. APLASTADO M5X13 A 304 | FLAT HEADED SCREW M5x13 A 304 | 2                | 2           | -            | -            |
| 14   | U020511000  | BISAGRA DERECHA INFERIOR      | LOWER RIGHT HINGE             | 1                | 1           | -            | -            |
| 14   | X190504000  | BISAGRA DERECHA INFERIOR SUS  | LOWER RIGHT HINGE S           | -                | -           | 1            | 1            |
|      | X960504000  | TORNILLO DE GIRO M8           | ROTATION BOLT M8              | 1                | 1           | 1            | 1            |
|      | Q232040000  | ARANDELA A6                   | WASHER A6                     | 2                | 2           | 2            | 2            |
|      | Q232050000  | ARANDELA A8                   | WASHER A8                     | 2                | 2           | 2            | 2            |
|      | Q221342000  | REMACHE EXAGONAL M5           | HEXAGONAL RIVET M5            | 2                | 2           | -            | -            |
|      | Q012042000  | TORNILLO EXAGONAL M6X15       | HEXAGONAL BOLT M6X15          | 2                | 2           | -            | -            |
|      | Q302022000  | ARANDELA 16X6X1.2 A.304       | WASHER 16X6X1.2 A.304         | 2                | 2           | -            | -            |
| 15   | U020536000  | PUERTA LATERAL G900           | SIDE DOOR G900                | 1                | 1           | -            | -            |
| 15   | U020513000  | PUERTA LATERAL SUS G900       | SIDE DOOR SUS G900            | -                | -           | 1            | 1            |
| S/Nº | U020537000  | CONTRAPUERTA LATERAL G900     | SIDE DOOR REVERSE G900        | 1                | 1           | -            | -            |
| S/Nº | U020514000  | CONTRAPUERTA LATE. SUS G900   | SIDE DOOR REVERSE US G900     | -                | -           | 1            | 1            |
|      | Q412000000  | REMACHE TUBULAR 4X8           | RIVET 4X8                     | 4                | 4           | 4            | 4            |
| 16   | X960501000  | IMAN                          | MAGNET                        | 2                | 2           | 2            | 2            |
| S/Nº | X960502000  | FIJACION IMAN                 | MAGNET ATTACHMENT             | 2                | 2           | 2            | 2            |
|      | Q012021000  | TORNILLO EXAGONAL M4X10       | HEXAGONAL BOLT M4x10          | 2                | 2           | 2            | 2            |
|      | Q232020000  | ARANDELA A4                   | WASHER A4                     | 2                | 2           | 2            | 2            |
| 17   | X162813000  | PANEL LATERAL IZQUIERDO G900  | LEFT SIDE PANEL G900          | 1                | 1           | -            | -            |
| 17   | S142805000  | PANEL LATERAL IZQUIERD. G900S | LEFT SIDE PANEL G900S         | -                | -           | 1            | 1            |
|      | Q221342000  | REMACHE EXAGONAL M5           | HEXAGONAL RIVET M5            | 3                | 3           | 3            | 3            |
|      | Q221343000  | REMACHE EXAGONAL M6           | HEXAGONAL RIVET M6            | 4                | 4           | 4            | 4            |
|      | Q221342000  | REMACHE EXAGONAL M5           | HEXAGONAL RIVET M5            | 3                | 3           | 3            | 3            |
| 18   | X260151000  | PATA REGULABLE                | ADJUSTABLE LEG                | 4                | 4           | -            | -            |
|      | Q411304000  | REMACHE AVIBULB Ø 4,8         | AVIBULB RIVET Ø 4.8           | 16               | 16          | -            | -            |



Зип Общепит

vsezip.ru

+7(812)987-08-81

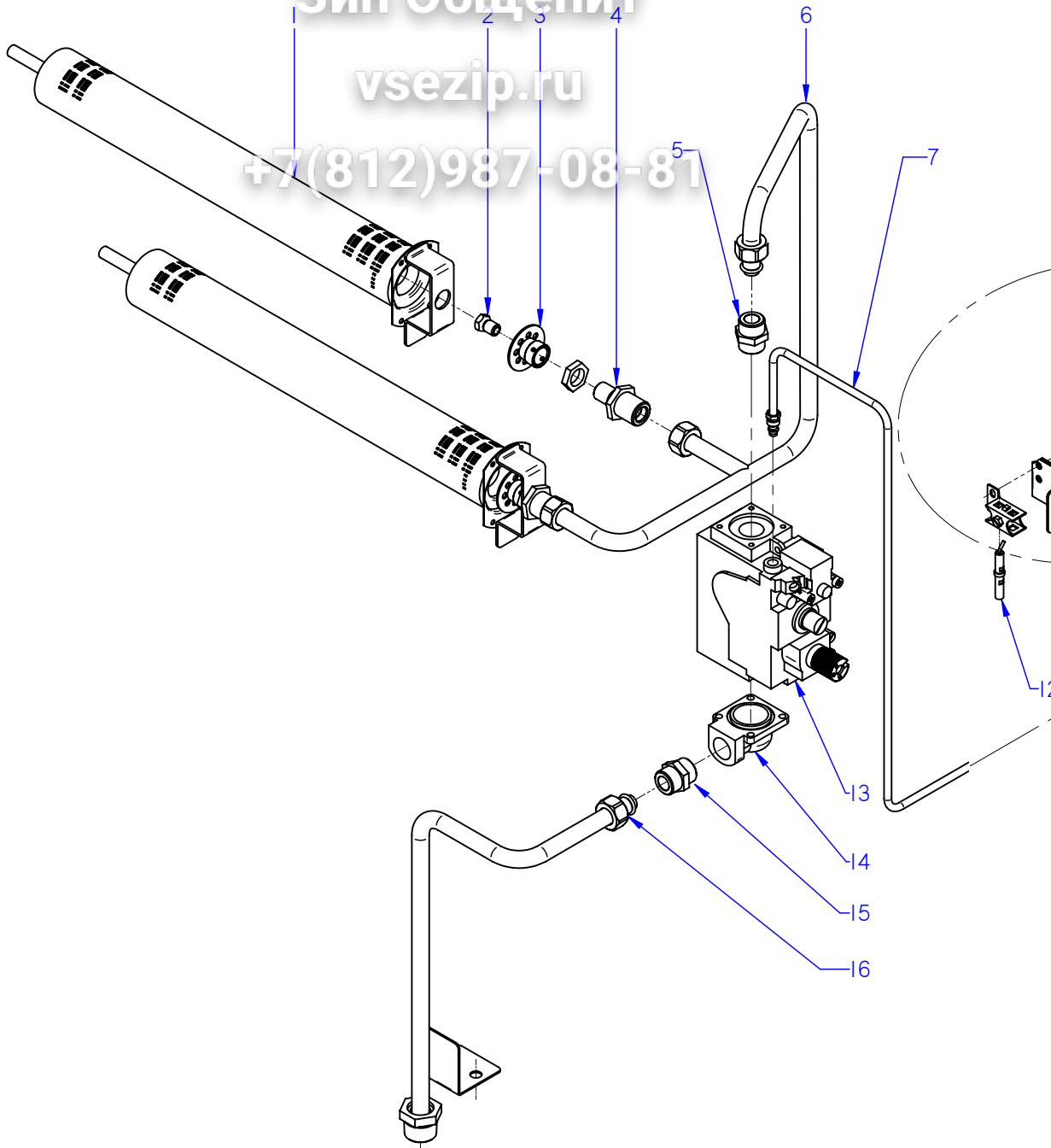

ITEM MARCADO EN COLOR = REPUUESTO RECOMENDADO  
COLOURED ITEM = RECOMMENDED SPARE PART

|         |                    |         |   |        |                           |
|---------|--------------------|---------|---|--------|---------------------------|
| N plano | Firma              | Fecha   | Aparato   | Lamina | Fogor Industrial S. Coop. |
| C-2666  | <i>[Signature]</i> | 2010-06 | PARTE FUNCIONAL DE GAS / GAS FUNCTIONAL PART<br>FREIDORA FGCL9-05 | 2      | Onite <b>FAGOR</b>        |

| MOD. |                | FREIDORAS / FRYERS            |                              | ZONA / ZONE |  | PARTE FUNCIONAL DE GAS<br>GAS FUNCTIONAL PART |  |  |  |
|------|----------------|-------------------------------|------------------------------|-------------|--|---|--|--|--|
| ITEM | CODIGO<br>CODE | DENOMINACION                  | NAME                         | FGCL9-05    |  |   |  |  |  |
| 1    | X505725000     | QUEMADOR                      | BURNER                       | 2           |  |   |  |  |  |
| 2    | 12008793       | TOBERA Ø 1,65 (BUTANO-PROP.)  | NOZZLE Ø 1.65 (BUT-PROP.)    | 2           |  |   |  |  |  |
| 2    | 12008801       | TOBERA Ø 2,90 (GAS NATURAL)   | NOZZLE Ø 2,90 (GAS NATURAL)  | 2           |  |   |  |  |  |
| 2    | 12008764       | TOBERA Ø 4,23 (GAS VILLA)     | NOZZLE Ø 4,23 (GAS VILLA)    | 2           |  |   |  |  |  |
| 3    | X505013000     | REGULADOR DE AIRE POLIDORO    | AIR REGULATOR                | 2           |  |   |  |  |  |
|      | Q012021000     | TORNILLO EXAGONAL M4x10 A.304 | HEXAGONAL BOLT M4x10 A.304   | 2           |  |   |  |  |  |
| 4    | X505724000     | MANGUITO PORTATOBERAS         | NOZZLE HOLDER SLEEVE         | 2           |  |   |  |  |  |
|      | Q223019000     | TUERCA 3/8 GAS LATÓN          | NUT 3 / 8 BRASS GAS          | 2           |  |   |  |  |  |
| 5    | S502106000     | MANGUITO DOBLE 3/4"- 1/2"     | DOUBLE SLEEVE 3/4"- 1/2"     | 1           |  |   |  |  |  |
| 5    | 12046984       | MANGUITO DOBLE 1/2"-3/4"      | DOUBLE SLEEVE 1/2"-3/4"      | 1           |  |   |  |  |  |
|      | Q306052000     | ARANDELA Ø23,5x15,5x3         | WASHER Ø23.5X15.5X3          | 1           |  |   |  |  |  |
| 6    | X505016000     | ENTRADA COMPL. A QUEMADOR     | BURNER FULL ENTRY            | 1           |  |   |  |  |  |
|      | Q306052000     | ARANDELA Ø23,5x15,5x3         | WASHER Ø23,5x15,5x3          | 3           |  |   |  |  |  |
| 7    | X505020000     | TUBO PILOTO COMPLE            | COMPL PILOT PIPE             | 1           |  |   |  |  |  |
| 8    |                | PILOTO COMPLETO               | PILOT COMPLETE               | 1           |  |   |  |  |  |
| S/Nº | X502103000     | CABEZA PILOTO                 | PILOT HEAD                   | 1           |  |   |  |  |  |
| S/Nº | X012122000     | REGULADOR DE AIRE 912.001     | AIR CONTROL 912.001          | 1           |  |   |  |  |  |
| S/Nº | X012126000     | CUERPO SIN RAC. 901.210       | BODY WITHOUT CONNEC. 901.2   | 1           |  |   |  |  |  |
| S/Nº | U442130000     | AMARRE TRAS. PILOTO 978.009   | REAR FASTENING PILOT 978.009 | 2           |  |   |  |  |  |
| S/Nº | U442131000     | AMARRE DELANT. PILOTO 978.021 | FRONT FASTENING PILOT 978.02 | 2           |  |   |  |  |  |
| S/Nº | R275016000     | INYECTOR Ø 0.3 (B-P 29 mbar)  | NOZZLE Ø 0.3 (B-P 29 mbar)   | 1           |  |   |  |  |  |
| S/Nº | U442137000     | INYECTOR Ø 0.4 (GAS NATURAL)  | NOZZLE Ø 0.4 (GAS NATURAL)   | 1           |  |   |  |  |  |
|      | X012116000     | TORNILLO AMARRE PILOTO        | PILOT FASTENING BOLT         | 2           |  |   |  |  |  |
| 9    | U562130000     | TERMOPAR L=850                | THERMOCOUPLE L=850           | 1           |  |   |  |  |  |
| 10   | X502673000     | SOPORTE AMARRE PILOTO         | TIE PILOT SUPPORT            | 1           |  |   |  |  |  |
|      | Q152004000     | TORNIL. APLASTADO M5X13 A 304 | FLAT HEADED SCREW M5x13 A 3  | 4           |  |   |  |  |  |
| 11   | X502681000     | ESCUAD. AMARRE PILOTO IZQDO   | LEFT SQUARE TIE PILOT        | 1           |  |   |  |  |  |
| S/Nº | X502680000     | ESCUAD. AMARRE PILOTO DCHO    | RIGHT SQUARE TIE PILOT       | 1           |  |   |  |  |  |
| 12   | X012101000     | BUJIA 915.037                 | SPARK PLUG 915.037           | 1           |  |   |  |  |  |
| 13   | 12097292       | VALVULA NOVA 820 REGULADA     | VALVE REGULATED NOVA 820     | 1           |  |   |  |  |  |
| 13   | 12024777       | ELECTROVALV. 820 NOVA 60 Hz.  | SOLENOID VALVE. 820 NOVA 60  | 1           |  |   |  |  |  |





Зип Общепит

vsezip.ru

+7(812)987-08-81

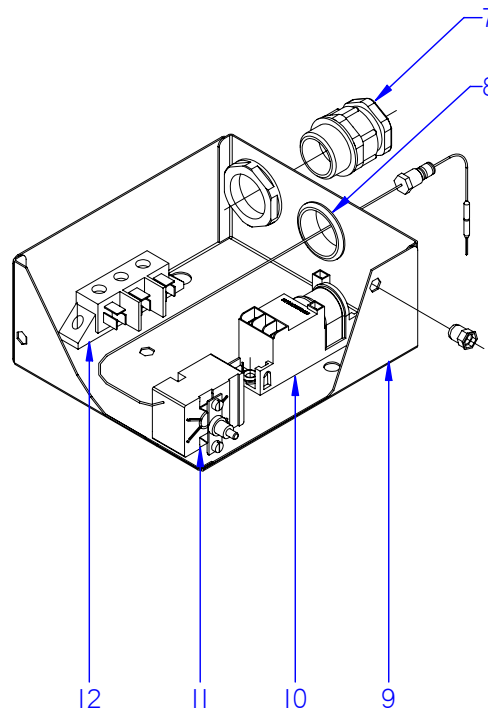
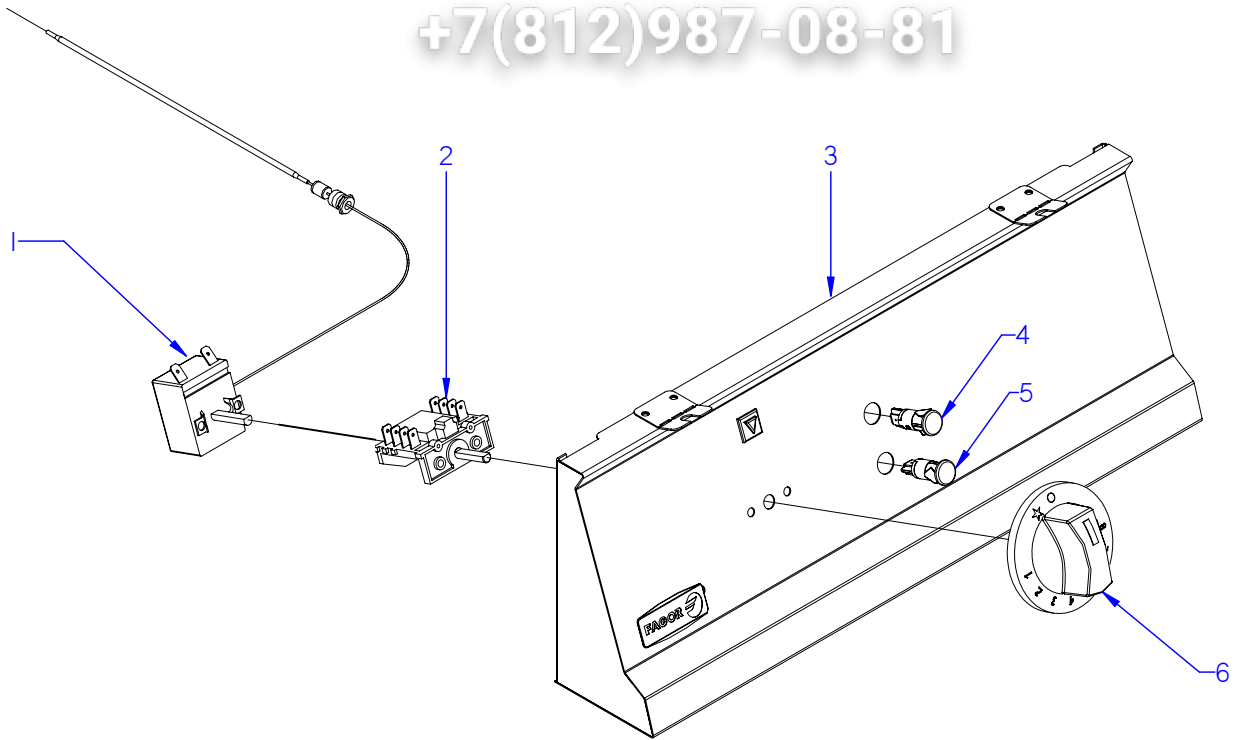

ITEM MARCADO EN COLOR = REPUESTO RECOMENDADO  
COLOURED ITEM = RECOMMENDED SPARE PART

|         |                    |         |                   |   |        |                                       |
|---------|--------------------|---------|-------------------|---|--------|---------------------------------------|
| N plano | Firma              | Fecha   | Aparato           | PARTE FUNCIONAL ELECTRICA / ELECTRICS FUNCTIONAL PART | Lamina | Fagor Industrial S.Coop. <b>FAGOR</b> |
| C-2667  | <i>[Signature]</i> | 2010-06 | FREIDORA FGCL9-05 |   | 3      | Oñate                                 |

| MOD. |                | FREIDORAS / FRYERS            |                             | ZONA / ZONE |            | PARTE FUNCIONAL ELECTRICA<br>ELECTRICS FUNCTIONAL PART |  |  |  |
|------|----------------|-------------------------------|-----------------------------|-------------|------------|--|--|--|--|
| ITEM | CODIGO<br>CODE | DENOMINACION                  | NAME                        | FGCL9-05    | FGCL9-05 S |  |  |  |  |
| 1    | X163001000     | TERMOSTATO LIMITADOR          | THERMOSTAT LIMITER          | 1           | 1          |  |  |  |  |
| 1    | 12048400       | TERMOSTATO SEGURIDAD 245°C U  | SECURITY THERMOSTAT 245°C   | 1           | 1          |  |  |  |  |
| 2    | X163007000     | CONMUTADOR ACOPLE TERMOS.     | THERMOSTAT CONNECT SWITC    | 1           | 1          |  |  |  |  |
| 3    | X502811000     | PORTAMANDOS COMP. FG-905      | CONTROL HOLDER FG-905       | 1           | 1          |  |  |  |  |
| 4    | R693055000     | PILOTO VERDE 41227000C7       | GREEN PILOT 41227000C7      | 1           | 1          |  |  |  |  |
| 4    | 12047390       | PILOTO VERDE 230V AC 8KW 16MM | GREEN PILOT 230V AC 8KW 16M | 1           | 1          |  |  |  |  |
| 5    | R693056000     | PILOTO AMBAR 41227000A4       | AMBER PILOT 41227000A4      | 1           | 1          |  |  |  |  |
| 5    | 12024669       | PILOTO AMBAR Ø18              | AMBER PILOT Ø18             | 1           | 1          |  |  |  |  |
| 6    | X503005000     | MANDO MONTADO FG9 Ø6          | CONTROL BUTTON Ø6 FG-900    | 1           | 1          |  |  |  |  |
| 7    | R023013000     | PRENSA ESTOPAS                | STUFFING BOX                | 1           | 1          |  |  |  |  |
|      | R023025000     | CONTRATUERCA GAES             | COUNTERNUT GAES             | 1           | 1          |  |  |  |  |
|      | R023026000     | JUNTA DE GOMA GAES            | RUBBER SEAL GAES            | 1           | 1          |  |  |  |  |
| 8    | X723014000     | PASAMUROS Ø 30                | WALL BUSHING Ø 30           | 1           | 1          |  |  |  |  |
| 9    | X163022000     | CUADRO ELECTRICO FG9-00       | ELECTRIC PANEL FG9-00       | 1           |            |  |  |  |  |
| 9    | X193000000     | CUADRO ELECTRICO FG-905 S     | ELECTRIC PANEL FG9-00 S     |             | 1          |  |  |  |  |
| S/Nº | X163023000     | TAPA CUADRO ELECTRICO         | ELECTRIC PANEL COVER        | 1           |            |  |  |  |  |
| S/Nº | X193001000     | TAPA CUADRO ELECTRICO SUSP.   | ELECTRIC PANEL COVER SUSP.  |             | 1          |  |  |  |  |
|      | Q152004000     | TORNILLO APLASTADO M5x13 A304 | FLAT HEADED BOLT M5x13 A304 | 9           | 9          |  |  |  |  |
|      | Q221342000     | REMACHE EXAGONAL M5           | HEXAGONAL RIVET M5          | 3           | 3          |  |  |  |  |
| 10   | X163014000     | ENCENDEDOR PARA 2 BUJIAS      | LIGHTER FOR 2 PLUGS         | 1           | 1          |  |  |  |  |
|      | Q082005000     | TORNILLO CHAP. 4.2X13 4.2X13  | PLATE BOLT 4.2X13 4.2X13    | 2           | 2          |  |  |  |  |
| 11   | X163001000     | TERMOSTATO LIMITADOR          | THERMOSTAT LIMITER          | 1           | 1          |  |  |  |  |
| 11   | 12048400       | TERMOSTATO SEGURIDAD 245°C U  | SECURITY THERMOSTAT 245°C   | 1           | 1          |  |  |  |  |
|      | Q151320000     | TORNILLO ALOM. M4X6 H.ZINCAD. | CURVED SCREW M4x6 H,ZINC.   | 2           | 2          |  |  |  |  |
| 12   | U183046000     | REGLETA AUXILIAR              | AUXILIARY STRIP             | 1           | 1          |  |  |  |  |
|      | Q152004000     | TORNILLO APLASTADO M5x13 A304 | FLAT HEADED BOLT M5x13 A304 | 2           | 2          |  |  |  |  |
|      |                |                               |                             |             |            |  |  |  |  |
|      |                |                               |                             |             |            |  |  |  |  |
|      |                |                               |                             |             |            |  |  |  |  |
|      |                |                               |                             |             |            |  |  |  |  |

| MOD. |             | FREIDORAS / FRYERS             |                             | ZONA / ZONE |  | VARIOS / MISCELLANEOUS |  |
|------|-------------|--------------------------------|-----------------------------|-------------|--|------------------------|--|
| ITEM | CODIGO CODE | DENOMINACION                   | NAME                        | FGCL9-05    |  |                        |  |
|      | X506500000  | FOLLETO DE INSTRUCCIONES       | INSTRUCTION LEAFLET         | 1           |  |                        |  |
|      | X163005000  | ESQUEMA TEORICO ADHESIVO       | THEOR. DIAGRAM LABEL        | 1           |  |                        |  |
|      | X163017000  | PLANO DE MONTAJE               | ASSEMBLY PLAN               | 1           |  |                        |  |
|      | X163018000  | CABLEADO PORTAMANDOS           | CONTROL HOLDER WIRING       | 1           |  |                        |  |
|      | U323007000  | CABLE ENCENDEDOR A BUJIA       | LIGHTER TO SPARK PLUG CAB.  | 1           |  |                        |  |
|      | X163002000  | CABLE BUJIA                    | SPARK PLUG CABLE            | 1           |  |                        |  |
|      | X163008000  | CABLE CON. 820 960.103         | CON. 820 960.103 CABLE      | 1           |  |                        |  |
|      | R275027000  | CABLEADO ELECTROS. 927.012     | ELECTRICAL 927.012 WIRING   | 1           |  |                        |  |
|      | 12046785    | CABL. VALVULA GAS NOVA 960.015 | WIRING NOVA GAS VALVE 960.0 | 1           |  |                        |  |
|      | 12046142    | CABLE. TENSOR PORTAMANDOS      | WIRING TENSOR PORTAMAND.    | 1           |  |                        |  |
|      |             |                                |                             |             |  |                        |  |
|      |             |                                |                             |             |  |                        |  |
|      |             |                                |                             |             |  |                        |  |
|      |             |                                |                             |             |  |                        |  |
|      |             |                                |                             |             |  |                        |  |
|      |             |                                |                             |             |  |                        |  |
|      |             |                                |                             |             |  |                        |  |
|      |             |                                |                             |             |  |                        |  |
|      |             |                                |                             |             |  |                        |  |
|      |             |                                |                             |             |  |                        |  |
|      |             |                                |                             |             |  |                        |  |
|      |             |                                |                             |             |  |                        |  |
|      |             |                                |                             |             |  |                        |  |
|      |             |                                |                             |             |  |                        |  |
|      |             |                                |                             |             |  |                        |  |
|      |             |                                |                             |             |  |                        |  |
|      |             |                                |                             |             |  |                        |  |
|      |             |                                |                             |             |  |                        |  |
|      |             |                                |                             |             |  |                        |  |
|      |             |                                |                             |             |  |                        |  |
|      |             |                                |                             |             |  |                        |  |
|      |             |                                |                             |             |  |                        |  |
|      |             |                                |                             |             |  |                        |  |
|      |             |                                |                             |             |  |                        |  |
|      |             |                                |                             |             |  |                        |  |
|      |             |                                |                             |             |  |                        |  |
|      |             |                                |                             |             |  |                        |  |
|      |             |                                |                             |             |  |                        |  |

# Зип Общепит

|      |                  |      |  |
|------|------------------|------|--|
| MOD. | <b>FREIDORAS</b> | ЗЧНА | REPUESTOS RECOMENDADOS<br>RECOMMENDED SPARE PART |
|------|------------------|------|--|

| ITEM | CODIGO     | DENOMINACION                  | TEXTO                           | FGCL9-05 | FGCL9-05 S |  |  |  |  |
|------|------------|-------------------------------|---------------------------------|----------|------------|--|--|--|--|
| 6    | X036107000 | VALVULA ESFERA PASO TOTAL 1   | SPHERICAL VALVE TOTAL PASS      | 1        | 1          |  |  |  |  |
| 8    |            | PILOTO COMPLETO               | PILOT COMPLETE                  | 1        | 1          |  |  |  |  |
| S/Nº | X502103000 | CABEZA PILOTO                 | PILOT HEAD                      | 1        | 1          |  |  |  |  |
| S/Nº | X012122000 | REGULADOR DE AIRE 912.001     | AIR CONTROL 912.001             | 1        | 1          |  |  |  |  |
| S/Nº | X012126000 | CUERPO SIN RAC. 901.210       | BODY WITHOUT CONNEC. 901.210    | 1        | 1          |  |  |  |  |
| S/Nº | U442130000 | AMARRE TRAS. PILOTO 978.009   | REAR FASTENING PILOT 978.009    | 2        | 2          |  |  |  |  |
| S/Nº | U442131000 | AMARRE DELANT. PILOTO 978.021 | FRONT FASTENING PILOT 978.021   | 2        | 2          |  |  |  |  |
| S/Nº | R275016000 | INYECTOR Ø 0.3 (B-P 29 mbar)  | NOZZLE Ø 0.3 (B-P 29 mbar)      | 1        | 1          |  |  |  |  |
| S/Nº | U442137000 | INYECTOR Ø 0.4 (GAS NATURAL)  | NOZZLE Ø 0.4 (GAS NATURAL)      | 1        | 1          |  |  |  |  |
| 9    | U562130000 | TERMOPAR L=850                | THERMOCOUPLE L=850              | 1        | 1          |  |  |  |  |
| 12   | X012101000 | BUJIA 915.037                 | SPARK PLUG 915.037              | 1        | 1          |  |  |  |  |
| 13   | 12097292   | VALVULA NOVA 820 REGULADA     | VALVE REGULATED NOVA 820        | 1        | 1          |  |  |  |  |
| 13   | 12024777   | ELECTROVALV. 820 NOVA 60 Hz.  | SOLENOID VALVE. 820 NOVA 60 Hz. | 1        | 1          |  |  |  |  |
| 1    | 12048400   | TERMOSTATO SEGURIDAD 245°C UL | SECURITY THERMOSTAT 245°C UL    | 1        | 1          |  |  |  |  |
| 2    | X163007000 | CONMUTADOR ACOUPLE TERMOS.    | THERMOSTAT CONNECT SWITCH       | 1        | 1          |  |  |  |  |
| 4    | 12047390   | PILOTO VERDE 230V AC 8KW 16MM | GREEN PILOT 230V AC 8KW 16MM    | 1        | 1          |  |  |  |  |
| 5    | 12024669   | PILOTO AMBAR Ø18              | AMBER PILOT Ø18                 | 1        | 1          |  |  |  |  |
| 10   | X163014000 | ENCENDEDOR PARA 2 BUJIAS      | LIGHTER FOR 2 PLUGS             | 1        | 1          |  |  |  |  |
| 11   | 12048400   | TERMOSTATO SEGURIDAD 245°C UL | SECURITY THERMOSTAT 245°C UL    | 1        | 1          |  |  |  |  |
|      |            |                               |                                 |          |            |  |  |  |  |
|      |            |                               |                                 |          |            |  |  |  |  |
|      |            |                               |                                 |          |            |  |  |  |  |
|      |            |                               |                                 |          |            |  |  |  |  |
|      |            |                               |                                 |          |            |  |  |  |  |
|      |            |                               |                                 |          |            |  |  |  |  |
|      |            |                               |                                 |          |            |  |  |  |  |
|      |            |                               |                                 |          |            |  |  |  |  |
|      |            |                               |                                 |          |            |  |  |  |  |
|      |            |                               |                                 |          |            |  |  |  |  |
|      |            |                               |                                 |          |            |  |  |  |  |
|      |            |                               |                                 |          |            |  |  |  |  |
|      |            |                               |                                 |          |            |  |  |  |  |
|      |            |                               |                                 |          |            |  |  |  |  |

# Зип Общепит

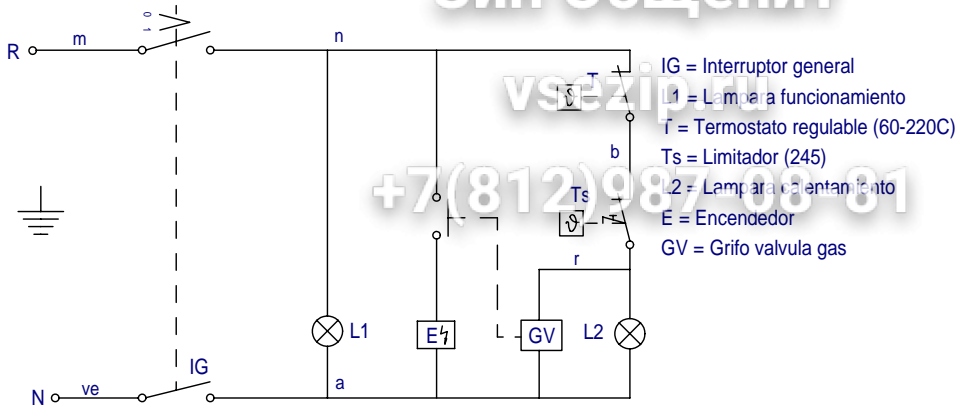

m=marron-brown-marron      ve=verde-green-vert  
 n=negro-black-noir          g=gris-grey-gris  
 r=rojo-red-rouge              a=azul-blue-bleu  
 b=blanco-white-blanc

X163005

**NOTAS:**

- GRABACIONES: COLOR NEGRO
- FONDO: COLOR NATURAL
- LA PLACA SERA AUTOADHESIVA POR LA CARA POSTERIOR Y RECUBIERTO POR UN PAPEL PROTECTOR.
- LAS INSCRIPCIONES RESISTIRAN SIN MODIFICACION APRECIABLE, EL FROTAMIENTO DURANTE 15 SEG. DE UN ALGODON EMPAPADO EN GASOLINA.

ALUMINIO BRILLO (SOLID-FOIL)

e=ALUMINIO+PROTECTOR=0,2      +0.05  
 -0.05

|                                   |   |              |  |   |
|-----------------------------------|---|--------------|--|---|
| Esquema teorico adhesivo FG-91/20 |   | X163005      |  |   |
| Nº                                | Pieza   | Material     | Nº Clasificacion   | Acabado                                       |
| Nº                                | Modificacion  | Propuesta de | Fecha  | Tolerancias generales                         |
| 1                                 | Modificacion general(pasar a fabri.interi.)                                     | Plazaola     | 23-5-97  | <math>\leq 5\pm</math><br>5-25± :<br>25-50± : |
|                                   |   |              |  | 50-100± :<br>> 100±<br>$\infty$ ±             |
|                                   | Firma   | Fecha        | Mecanizado superficial<br><br>Plano numero<br><b>HB-14457-1</b><br>Sustituye al Nº<br>Sustituido por |   |
| Dibujado                          | JON   | 93-9-14      |  |   |
| Proyectado                        |   |              |  |   |
| Comprobado                        |   |              |  |   |
| Escala                            | <b>FREIDORAS</b><br>Plano hau ez daiteke erabil ez berrizta gure baimenitz gabe |              |  |   |



Fagor Industrial, Koop. Elk, Mugatua

# Зип Общепит

www.zezip.ru

+7(812)987-08-81

Esquema adhesivo  
X-163005 FG-920  
X-163050 FG9-20A

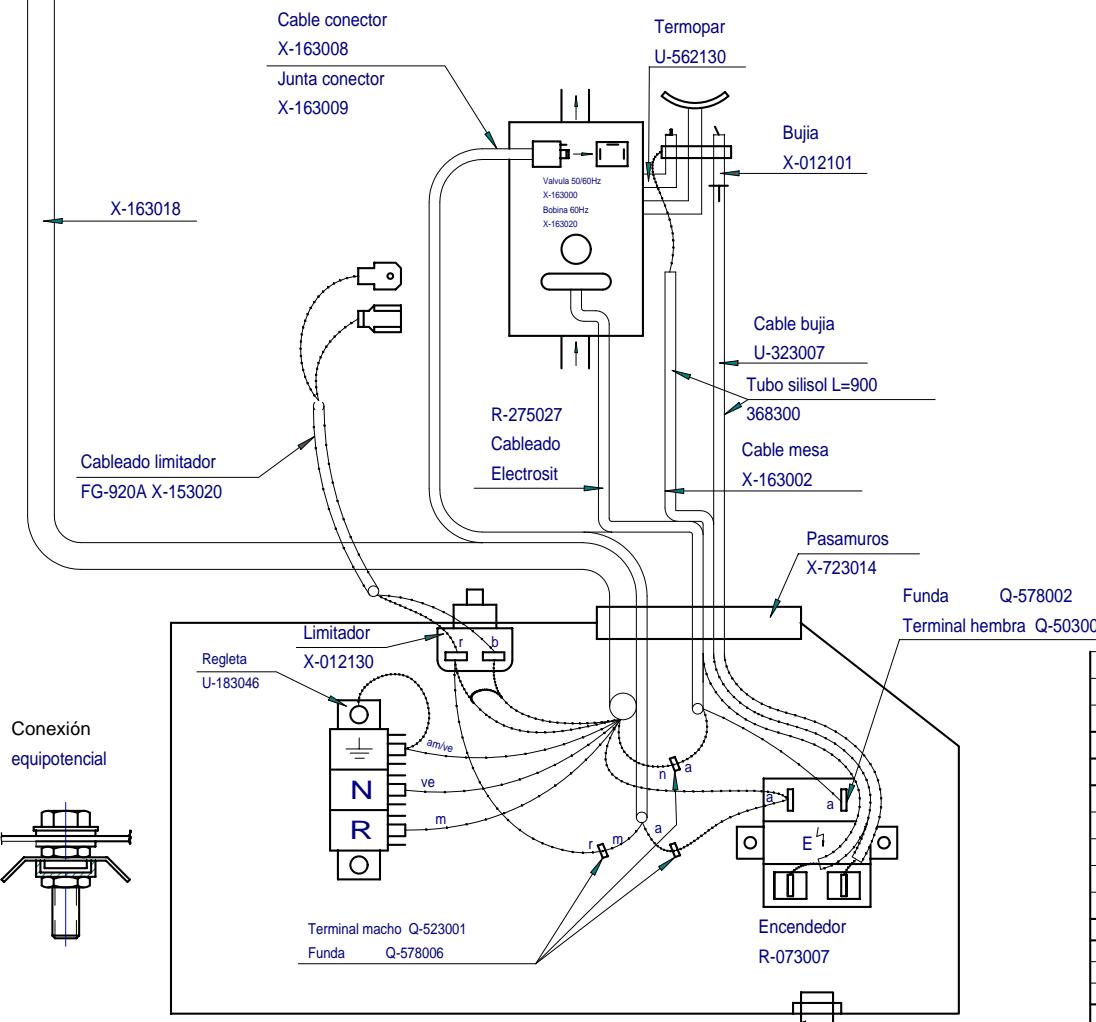
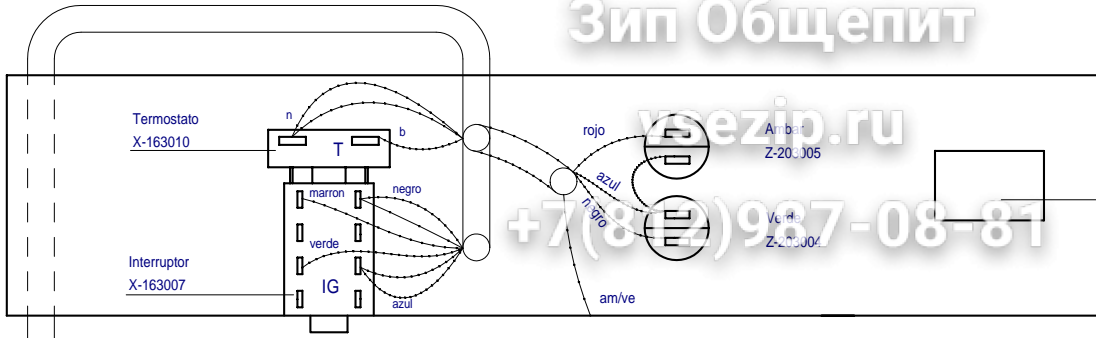

|   |              |         |
|---|--------------|---------|
| Plano de montaje                              |              |         |
| Nº  | Pieza        |         |
| Nº  | Modificacion |         |
|   |              |         |
|   |              |         |
|   |              |         |
| Firma   |              | Fecha   |
| Dibujado                                      | KONTXI       | 22/7/98 |
| Proyectado                                    |              |         |
| Comprobado                                    |              |         |
| Escala  |              |         |
| <b>FREIDORA F</b>                             |              |         |
| Plano hau ez daitelke erabil ez berritza gure |              |         |