

Зип Общепит

vsezip.ru

DESPIECE TECNICO / SPARE PARTS BOM

+7(812)987-08-81

**Hornos eléctricos
Fours électriques
Electric ovens
Elektro heissluftdämpfer
Forni elettrici
Fornos eletricos**

Modelos / Models:

**AE-201
ACE-201
APE-201**

Septiembre 2012 September

Revisado Abril 2016 April Revised



FAGOR INDUSTRIAL

Зип Ощепит

vsezip.ru

+7(812)987-08-81

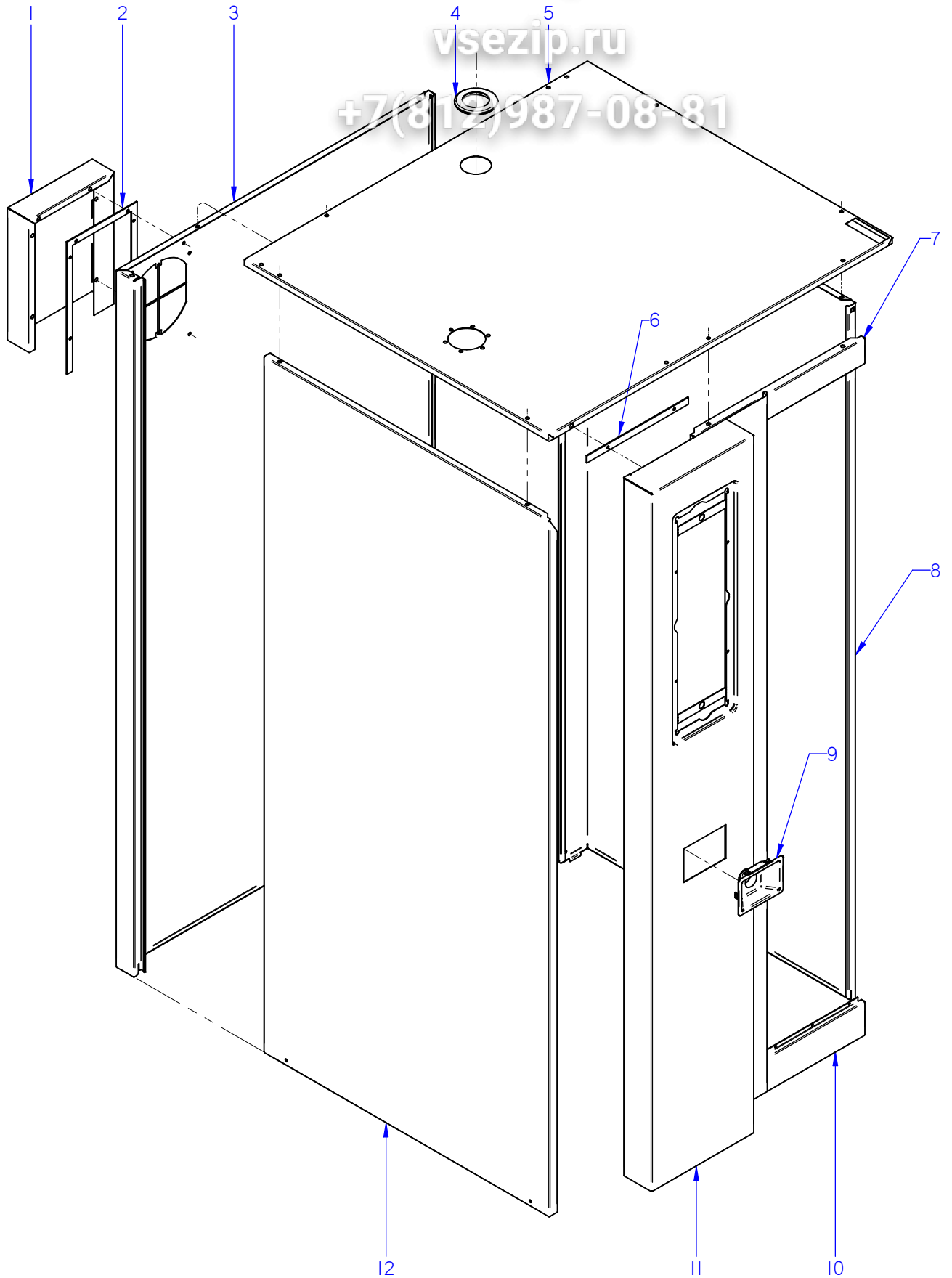

ITEM MARCADO EN COLOR = REPUESTO RECOMENDADO
COLOURED ITEM = RECOMMENDED SPARE PART

| | | | | | | |
|---------------------|--------------------|--------------|------------------------------|---------------|----------------|---------------------------------------|
| Nº plano / N° plane | Firma | Fecha / Date | Denominación / Denomination: | MUEBLE / UNIT | Lamina / Sheet | Fagor Industrial S.Coop. FAGOR |
| C-3022 | <i>(Signature)</i> | 2012-09 | HORNOS AE; ACE; APE-201 | | 1 | Oñate |

| MOD. | | HORNOS / OVEN | | ZONA / ZONE | | | MUEBLE / UNIT | | | | |
|------|---------------------|-------------------------------|----------------------------------|-------------|--------|---------|---------------|--|--|--|--|
| ITEM | CODIGO REFERENCE | DENOMINACION | DENOMINATION | ACE-201 | AE-201 | APE-201 | | | | | |
| 1 | 12022556 | CHAPA SEPARACION IPX5 20-21 | SEPARATION PLATE IPX5 20-21 | 1 | 1 | 1 | | | | | |
| 1 | 12022557 | CHAPA SEPARACI. IPX5 20 SOLD. | SEPARAT. PLATE IPX5 20 WEL. | 1 | 1 | 1 | | | | | |
| 2 | 12024081 | JUNTA IPX5 20-21 | SEAL IPX5 20-21 | 1 | 1 | 1 | | | | | |
| 3 | 12041103 | PANEL POSTERIOR 201 ADV | REAR PANEL 201 ADV | 1 | 1 | 1 | | | | | |
| 4 | 12024231 | PASAMUROS CHIMENEA 101003361 | FEED THROUGH FLUE PIPE 101003361 | 2 | 2 | 2 | | | | | |
| 5 | 12043253 | PANEL SUPERIOR SOLD. AE 201 | TOP PANEL AE 201 SOLDIER | 1 | 1 | 1 | | | | | |
| 6 | 12041319 | JUNTA PORTAMANDOS 201 ADV | CONTROL PANEL SEAL 201 ADV | 1 | 1 | 1 | | | | | |
| 7 | 12041125 | PANEL FRONTAL SUPE. 201 ADV | UPPER FRONT PANEL 201 ADV | 1 | 1 | 1 | | | | | |
| 8 | 12041123 | PANEL EXTERIOR DCHO 201 ADV | RIGHT PANEL 201 ADV | 1 | 1 | 1 | | | | | |
| 9 | 12041736 | EMBELLECEDOR DUCHA AD | SHOWER TRIM AD | — | 1 | 1 | | | | | |
| 10 | 12041126 | PANEL FRONTAL INFER. 201 ADV | LOWER FRONT PANEL 201 ADV | — | 1 | 1 | | | | | |
| 11 | 12095164 | PANEL PORTAMANDOS AC 201 | CONTROL PANEL AC 201 | 1 | — | — | | | | | |
| 11 | 12135173 | KIT PORTAMANDO 201 ACE | CONTROL PANEL 201 ACE | 1 | — | — | | | | | |
| 11 | 12043844 | PANEL PORTAMANDOS APE 201 | CONTROL PANEL APE 201 | — | 1 | 1 | | | | | |
| 11 | 12135172 | KIT PORTAMANDO 201 ADV-PL. | CONTROL PANEL 201 ADV-PL. | — | 1 | 1 | | | | | |
| 12 | 12041157 | PANEL EXT. IZQUIERDO 201 ADV | REAR LEFT PANEL 201 ADV | 1 | 1 | 1 | | | | | |
| | | | | | | | | | | | |
| | | | | | | | | | | | |
| | | | | | | | | | | | |
| | | | | | | | | | | | |
| | | | | | | | | | | | |
| | | | | | | | | | | | |
| | | | | | | | | | | | |
| | | | | | | | | | | | |
| | | | | | | | | | | | |
| | | | | | | | | | | | |
| | | | | | | | | | | | |
| | | | | | | | | | | | |
| | | | | | | | | | | | |
| | | | | | | | | | | | |
| | | | | | | | | | | | |
| | | | | | | | | | | | |
| | | | | | | | | | | | |
| | | | | | | | | | | | |
| | | | | | | | | | | | |

Зип Общепит

vsezip.ru

+7(812)987-08-81

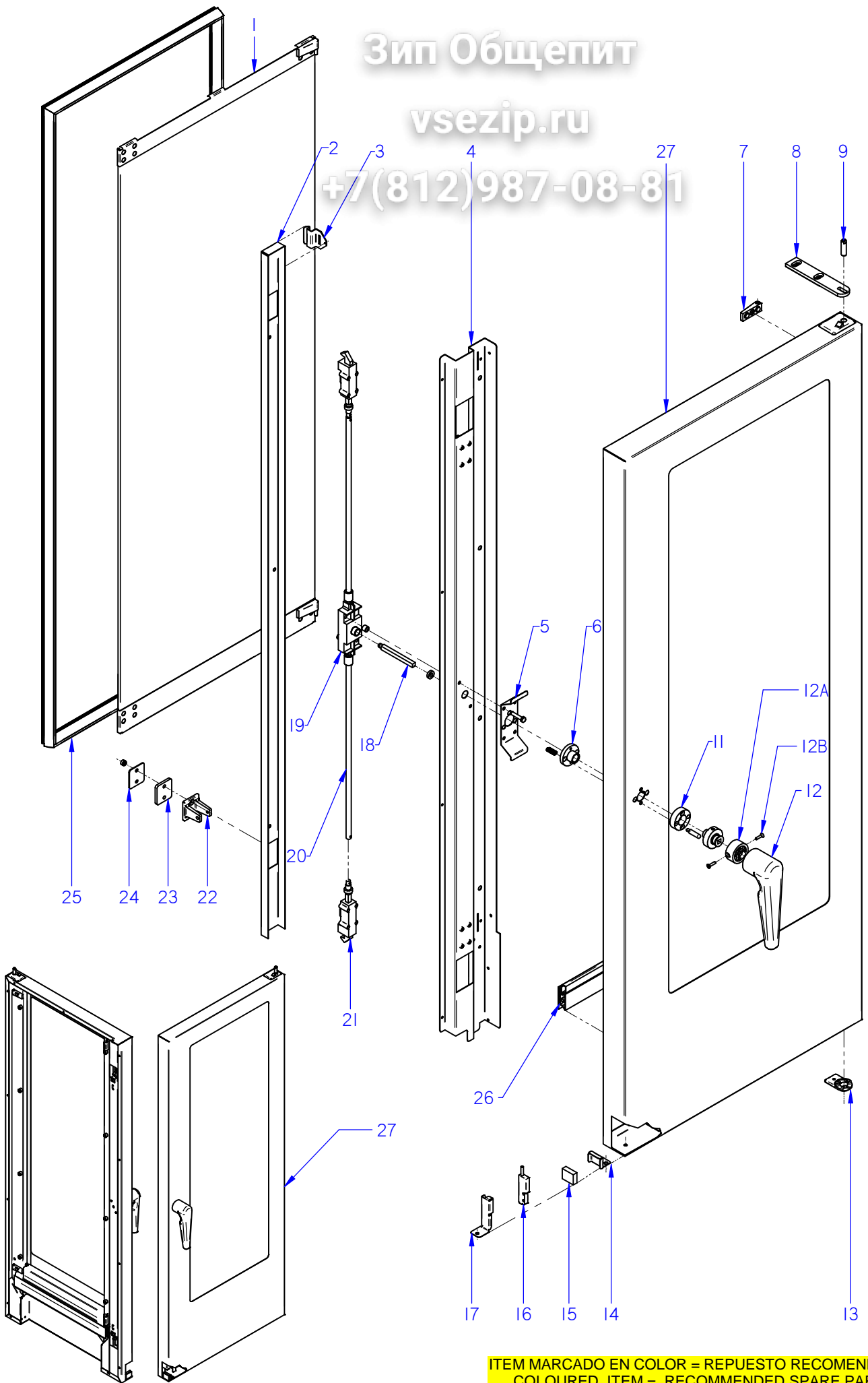

ITEM MARCADO EN COLOR = REPUESTO RECOMENDADO
COLOURED ITEM = RECOMMENDED SPARE PART

| | | | | | | |
|---------------------|-------------------|--------------|------------------------------|---------------|----------------|---------------------------------------|
| Nº plano / N° plane | Firma / Signature | Fecha / Date | Denominación / Denomination: | PUERTA / DOOR | Lamina / Sheet | Fagor Industrial S.Coop. FAGOR |
| C-3023 | Iban R. | 06-2015 | HORNOS AE; ACE; APE-201 | | 2 | Oñate |

| MOD. | | HORNOS / OVEN | | ZONA / ZONE | | PUERTA (HASTA 06-2014) / DOOR (UNTIL 06-2014) | | | | | |
|------|------------------|------------------------------|--------------------------|-------------|--------|---|--|--|--|--|--|
| ITEM | CODIGO REFERENCE | DENOMINACION | DENOMINATION | ACE-201 | AE-201 | APE-201 | | | | | |
| 1 | 12041083 | KIT CRISTAL INTER. 201 | 201 INNER GLASS KIT | 1 | 1 | 1 | | | | | |
| 2 | 12039324 | TAPA CIERRE PUERTA 202 | DOOR CLOSING COVER 202 | 1 | 1 | 1 | | | | | |
| 3 | 12024319 | PESTILLO | INNER GLASS HINGE | 2 | 2 | 2 | | | | | |
| 4 | 12039302 | CONTRAPUERTA MANILLA 202 | COMPLETE HANDLE DOOR 202 | 1 | 1 | 1 | | | | | |
| 5 | 12039326 | SUPLEMENTO SUJ. CERRADURA | LOCK FIXING SUPPLEMENT | 1 | 1 | 1 | | | | | |
| 6 | 12024389 | GUIA MANILLA | HANDLE GUIDE | 1 | 1 | 1 | | | | | |
| 7 | 12024402 | BASE DE BISAGRA | HINGE BASE | 2 | 2 | 2 | | | | | |
| 8 | 12039312 | BISAGRA SUPERIOR | UPPER HINGE | 1 | 1 | 1 | | | | | |
| 9 | 12023636 | EJE SUPERIOR | UPPER SHAFT | 1 | 1 | 1 | | | | | |
| 11 | 12024505 | SOPORTE RESORTE | SPRING HOLDER | 1 | 1 | 1 | | | | | |
| 12 | 12044776 | ASA COMPLETA 2/1 ADVANCE | HANDLE 2/1 ADVANCE | 1 | 1 | 1 | | | | | |
| 12A | 12102288 | INSERTO AMARRE | FASTENING INSERT | 1 | 1 | 1 | | | | | |
| 12B | 12010262 | TORNILLO AVELLANADO M4X15 | COUNTERSUNK SCREW M4x15 | 2 | 2 | 2 | | | | | |
| 13 | 12039311 | BASE BISAGRA INFERIOR PUERTA | LOWER DOOR HINGE BASE | 1 | 1 | 1 | | | | | |
| 13 | 12047967 | BASE BISAGRA INFERIOR 6 DIEN | LOWER HINGE BASE | 1 | 1 | 1 | | | | | |
| 14 | 12022049 | SOPORTE IMAN | MAGNET HOLDER | 1 | 1 | 1 | | | | | |
| 15 | 12024384 | IMAN | MAGNET | 1 | 1 | 1 | | | | | |
| 16 | 12024560 | INTERRUPTOR MAGNETICO AC | MAGNETIC SWITCH AC | 1 | 1 | 1 | | | | | |
| 17 | 12022166 | SOPORTE MICRO PUERTA | DOOR MICRO SWITCH | 1 | 1 | 1 | | | | | |
| 18 | 12024799 | EJE DE MANILLA PUERTA | LEVER SHAFT | 1 | 1 | 1 | | | | | |
| 19 | 12024673 | MECANISMO CIERRE | CLOSING MECHANISM | 1 | 1 | 1 | | | | | |
| 20 | 12039308 | TUBO ALARGADERA 201/202 ADV | ROD 201/202 ADV | 2 | 2 | 2 | | | | | |
| 21 | 12024657 | ELEMENTO CIERRE | CLOSING COMPONENT | 2 | 2 | 2 | | | | | |
| 22 | 12024495 | ENGANCHE PUERTA | FASTENER | 2 | 2 | 2 | | | | | |
| 23 | 12024380 | SUPLEMENTO ENGANCHE | FASTENER SUPPLEMENT | 2 | 2 | 2 | | | | | |
| 24 | 12022138 | CALZO DE ENGANCHE | COUPLING CHOCK | 4 | 4 | 4 | | | | | |
| 25 | 12041134 | JUNTA PUERTA COMPL.201 ADV | DOOR JOINT 201 ADV | 1 | 1 | 1 | | | | | |
| 26 | 12041088 | JUNTA CIERRE INFERIOR 201 | LOWER LOCK JOINT 201 | 1 | 1 | 1 | | | | | |
| 27 | 12046022 | KIT PUERTA 201 | DOOR 201 KIT | 1 | 1 | 1 | | | | | |
| | | | | | | | | | | | |
| | | | | | | | | | | | |

Зип Общепит

vsezip.ru

+7(812)987-08-81

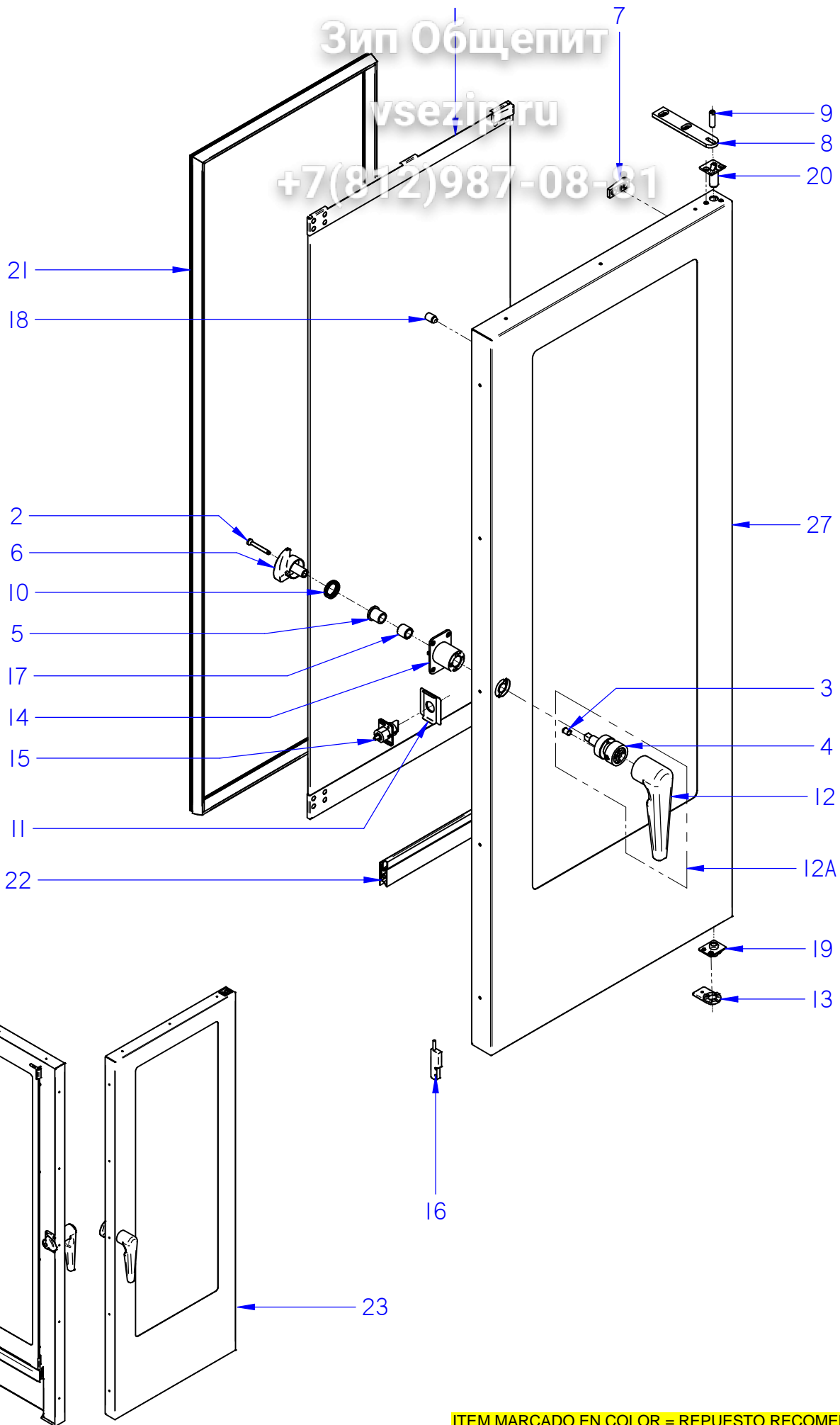

ITEM MARCADO EN COLOR = REPUESTO RECOMENDADO
COLOURED ITEM = RECOMMENDED SPARE PART

| | | | | | |
|-----------------------|-------------------|--------------|--|----------------|---------------------------------------|
| Nº plano / Drawing N. | Firma / Signature | Fecha / Date | Denominación / Denomination: | Lamina / Sheet | Fagor Industrial S.Coop. FAGOR |
| C-3023-14 | Iban R. | 03-2016 | PUERTA / DOOR HORNOS AE; ACE; APE-201 | 2-14 | Oñate |

| MOD. | | HORNOS / OVEN | | ZONA / ZONE | | PUERTA (DESDE 06-2014) / DOOR (FROM 06- | | | | | |
|------|------------------|----------------------------------|------------------------------|-------------|--------|---|--|--|--|--|--|
| ITEM | CODIGO REFERENCE | DENOMINACION | DENOMINATION | ACE-201 | AE-201 | APE-201 | | | | | |
| 1 | 12041083 | KIT CRISTAL INTER. 201 | 201 INNER GLASS KIT | 1 | 1 | 1 | | | | | |
| 2 | 12097552 | TORNILLO AVELLANADO M6x50 | COUNTERSAUNK SCREW M6x50 | 1 | 1 | 1 | | | | | |
| 3 | 12049719 | POSICIONADOR DE BOLA MUELLE | BALL-SPRING FIXER | 1 | 1 | 1 | | | | | |
| 4 | 12131277 | KIT INSERTOS ASA 20X | KIT HANDLE INSERTS 20X | 1 | 1 | 1 | | | | | |
| 5 | 12025100 | CASQUILLO SELFOIL 16-22-25 | SELFOIL BUSHING 16-22-25 | 1 | 1 | 1 | | | | | |
| 6 | 12049692 | LEVA CIERRE UNICO 20X ADV | SINGLE LOCK CAM 20X ADV | 1 | 1 | 1 | | | | | |
| 7 | 12024402 | BASE DE BISAGRA | HINGE BASE | 2 | 2 | 2 | | | | | |
| 8 | 12039312 | BISAGRA SUPERIOR | UPPER HINGE | 1 | 1 | 1 | | | | | |
| 9 | 12023636 | EJE SUPERIOR | UPPER SHAFT | 1 | 1 | 1 | | | | | |
| 10 | 12093685 | MUELLE LEVA PUERTA ADVANCE | CAM SPRING ADVANCE DOOR | 1 | 1 | 1 | | | | | |
| 11 | 12094299 | TAPA PESTILLO PUERTA COMPLETA | COMPL. DOOR BOLT COVER | 1 | 1 | 1 | | | | | |
| 12 | 12044773 | ASA ADVANCE | ADVANCE HANDLE | 1 | 1 | 1 | | | | | |
| 12A | 12135274 | REP. ASA COMP. 20X CIERRE UNICO | SPARE SINGLE LOCK 20X HANDLE | 1 | 1 | 1 | | | | | |
| 13 | 12047967 | BASE BISAGRA INFERIOR 6 DIEN | LOWER HINGE BASE | 1 | 1 | 1 | | | | | |
| 14 | 12049691 | SOPORTE MANILLA 20X | 20X HANDLE SUPPORT | 1 | 1 | 1 | | | | | |
| 15 | 12113376 | MOD PITON PUERTA | DOOR BOLT MODULE | 1 | 1 | 1 | | | | | |
| 16 | 12024560 | INTERRUPTOR MAGNETICO AC | MAGNETIC SWITCH AC | 1 | 1 | 1 | | | | | |
| 17 | 12097533 | CASQUILLO SELFOIL TIPOA 16-22-20 | SELFOIL BUSHING 16-22-20 | 1 | 1 | 1 | | | | | |
| 18 | 12024794 | TOPE CRISTAL INTERIOR | INNER GLASS BLOCK | 9 | 9 | 9 | | | | | |
| 19 | 12049660 | BISAGRA INF. 202 ADV 6 DIENTES | LOWER HINGE 202 ADV. 6 TEETH | 1 | 1 | 1 | | | | | |
| 20 | 12049282 | BISAGRA SUP. 202 TOPE ALTO | TOP HINGE 202 | 1 | 1 | 1 | | | | | |
| 21 | 12041134 | JUNTA PUERTA COMPL.201 ADV | DOOR JOINT 201 ADV | 1 | 1 | 1 | | | | | |
| 22 | 12041088 | JUNTA CIERRE INFERIOR 201 | LOWER LOCK JOINT 201 | 1 | 1 | 1 | | | | | |
| 23 | 12097686 | KIT PUERTA 201 CIERRE UNICO | SINGLE LOCK DOOR 201 KIT | 1 | 1 | 1 | | | | | |
| | | | | | | | | | | | |
| | | | | | | | | | | | |
| | | | | | | | | | | | |
| | | | | | | | | | | | |
| | | | | | | | | | | | |
| | | | | | | | | | | | |
| | | | | | | | | | | | |

Зип Общепит

vsezip.ru

+7(812)987-08-81

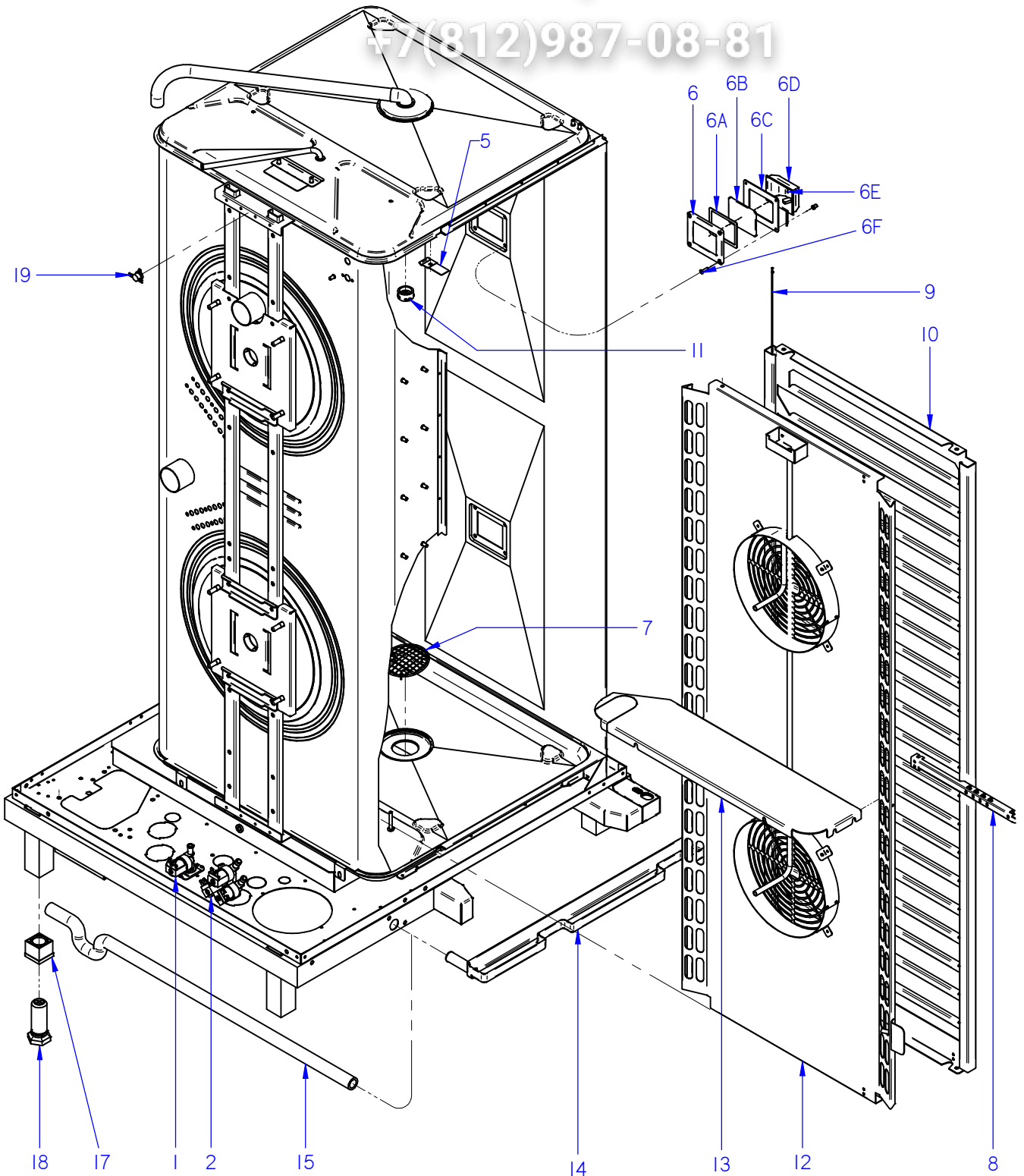

ITEM MARCADO EN COLOR = REPUESTO RECOMENDADO
COLOURED ITEM = RECOMMENDED SPARE PART

| | | | | | |
|-------------------------------|------------------------------|-------------------------|--|---------------------|--|
| Nº plano / N° plane C-3024 | Firma / Signature Iban R. | Fecha / Date 03-2016 | Denominación / Denomination: MUEBLE INTERIOR / INTERIOR OVEN HORNOS AE; ACE; APE-201 | Lamina / Sheet 3 | Fagor Industrial S.Coop. FAGOR Onate |
|-------------------------------|------------------------------|-------------------------|--|---------------------|--|

| MOD. | | HORNOS / OVEN | | ZONA / ZONE | | MUEBLE INTERIOR / INTERIOR OVEN | | | | | |
|------|------------------|-----------------------------|----------------------------|-------------|--------|---------------------------------|--|--|--|--|--|
| ITEM | CODIGO REFERENCE | DENOMINACION | DENOMINATION | ACE-201 | AE-201 | APE-201 | | | | | |
| 1 | 12025161 | E.V. 230VAC 50/60Hz 1V | SOLENOID VALVE 230VAC 1 W | 1 | | 1 | | | | | |
| 2 | 12023794 | E.V. 230VAC 50/60Hz 2V | SOLENOID VALVE 230VAC 2 W | 1 | 1 | | | | | | |
| 2 | 12115418 | E.V. 230VAC 50/60Hz 3V | SOLENOID VALVE 230VAC 3 W | | 1 | 1 | | | | | |
| 5 | 12041767 | SOPORTE SONDA PINCHO CAMARA | CAMERA PROBE SUPP. PINCHO | 1 | 1 | 1 | | | | | |
| 6 | 12024464 | MARCO LAMPARA | LAMP ANCHORING PLATEN | 2 | 2 | 2 | | | | | |
| 6A | 12023532 | JUNTA INTERIOR LAMPARA | LAMP INNER JOINT | 2 | 2 | 2 | | | | | |
| 6B | 12023668 | CRISTAL LAMPARA | LAMP GLASS | 2 | 2 | 2 | | | | | |
| 6C | 12023578 | JUNTA EXTERIOR LAMPARA | LAMP OUTER JOINT | 2 | 2 | 2 | | | | | |
| 6D | 12024545 | PORTALAMPARAS | LAMP HOLDER | 2 | 2 | 2 | | | | | |
| 6E | 12025123 | LAMPARA 10W-12V | LIGHT 10W 12V | 2 | 2 | 2 | | | | | |
| 6F | 12010262 | TORNILLO AVELLANADO M4X15 | COUNTERSUNK SCREW M.4x15 | 8 | 8 | 8 | | | | | |
| 7 | 12095042 | FILTRO DESAGÜE Ø53 | DRAINAGE FILTER Ø53 | 1 | 1 | 1 | | | | | |
| 8 | 12126827 | SOPORTE CORE HOLDER | CORE HOLDER SUPPORT | 1 | 1 | 1 | | | | | |
| 9 | 12039490 | TOPE BANDEJAS 101-102 | TRAY TOP 101-102 | 4 | | | | | | | |
| 10 | 12126823 | PORTABANDEJAS IZDA 201 ACE | ACE 201 LEFT HOLDER | 1 | | | | | | | |
| 10 | 12126822 | PORTABANDEJAS DCHA 201 ACE | ACE 201 RIGHT HOLDER | 1 | | | | | | | |
| 11 | 12023935 | PUNTA DIFUSORA LAVADO | WASHING DISPENSER POINT | | | 1 | | | | | |
| 11 | 12129275 | PUNTA DIFUSORA ACLARADO | RINSING DISPENSER POINT | 1 | 1 | | | | | | |
| 12 | 12126836 | CUBREVENTILADOR 201 ADV | FAN COVER 201 ADV | 1 | | | | | | | |
| 12 | 12126837 | CUBREVENTILADOR 201 ADV | FAN COVER 201 ADV | | 1 | 1 | | | | | |
| 13 | 12041119 | CHAPA REFUERZO CUBA AE 201 | CUBA REINFOR. PLATE AE 201 | 1 | 1 | 1 | | | | | |
| | 12009868 | ARANDELA PLANA INOX 6MM | WASHER FLAT 6 MM INOX. | 7 | 7 | 7 | | | | | |
| | 12010255 | TORNILLO EXAGONAL M6 INOX. | HEXAGONAL SCREW M6 INOX. | 7 | 7 | 7 | | | | | |
| 14 | 12039467 | RECOGEAGUAS HORNO 201 | SPRING WATER COLLE. 201 | 1 | | | | | | | |
| 15 | 12039498 | TUBO RECOGEAGUAS 101 | COLLECT WATER PIPE 101 | 1 | | | | | | | |
| | 12009628 | ABRAZADERA ELAST. 26.7-28.1 | SPRING CLAMP 26.7-28.1 | 2 | | | | | | | |
| 17 | 12043392 | TUERCA PATA 202 ADVANCE | NUT LEG 202 ADVANCE | 4 | 4 | 4 | | | | | |
| 18 | 12043393 | TORNILLO PATA 202 ADVANCE | SCREW LEG 202 ADVANCE | 4 | 4 | 4 | | | | | |
| 19 | 12095019 | TERMOSTATO_261_NA_51°C | THERMOSTAT_261_NA_51°C | 1 | 1 | | | | | | |
| | | | | | | | | | | | |
| | | | | | | | | | | | |

Зип Общепит

ysezip.ru

+7(812)987-08-81

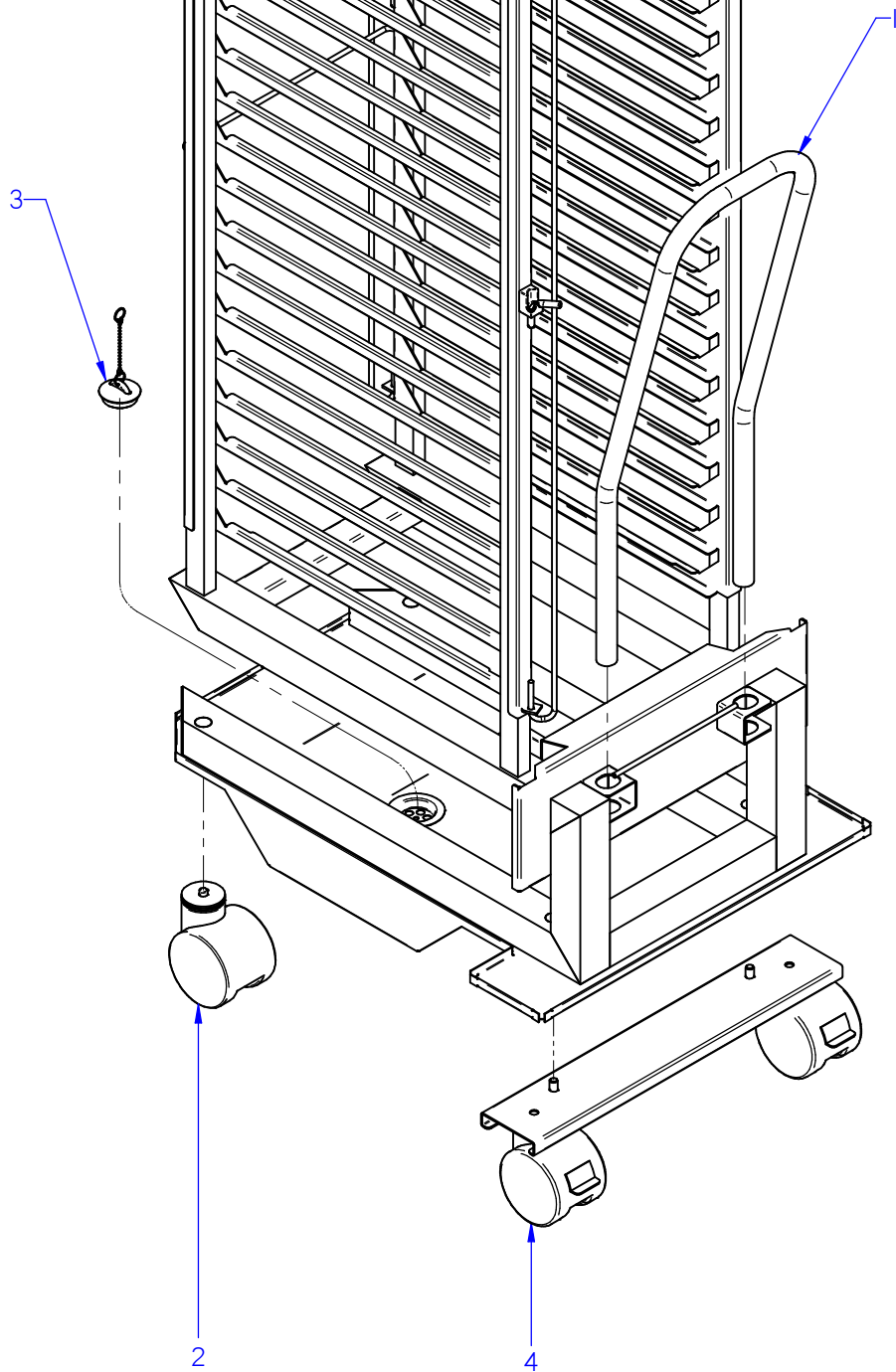

ITEM MARCADO EN COLOR = REPUESTO RECOMENDADO
COLOURED ITEM = RECOMMENDED SPARE PART

| | | | | | | |
|---------------------|--------|--------------|------------------------------|-----------------|----------------|---|
| Nº plano / N° plane | Firma | Fecha / Date | Denominación / Denomination: | CARRO / TROLLEY | Lamina / Sheet | Fagor Industrial S.Coop. FAGOR |
| C-3025 | Iban R | 2015-05 | HORNOS AE; ACE; APE-201 | 4 | Oñate |  |

| MOD. | | HORNOS / OVEN | ZONA / ZONE | CARRO / TROLLEY | | | | | |
|------|------------------|-------------------------------|-----------------------------|-----------------|---------|--|--|--|--|
| ITEM | CODIGO REFERENCE | DENOMINACION | DENOMINATION | AE-201 | APE-201 | | | | |
| | 12041135 | CARRO 201 ADVANCE | TROLLEY 201 ADVANCE | 1 | 1 | | | | |
| 1 | 12041148 | ASA COMPLETA CARRO 201 ADV | HANDLE FULL 201 ADV | 1 | 1 | | | | |
| 2 | 12045315 | RUEDA GIRATORIA SIN FRENO | SWIVEL WHEEL WITHOUT BR. | 2 | 2 | | | | |
| 3 | 12024275 | TAPON Ø44 | CAP Ø44 | 1 | 1 | | | | |
| 4 | 12045312 | KIT RUEDA GIRATORIA CON FRENO | SWIVEL WHEEL WITH BRAKE KIT | 1 | 1 | | | | |
| | | | | | | | | | |
| | | | | | | | | | |
| | | | | | | | | | |
| | | | | | | | | | |
| | | | | | | | | | |
| | | | | | | | | | |
| | | | | | | | | | |
| | | | | | | | | | |
| | | | | | | | | | |
| | | | | | | | | | |
| | | | | | | | | | |
| | | | | | | | | | |
| | | | | | | | | | |
| | | | | | | | | | |
| | | | | | | | | | |
| | | | | | | | | | |
| | | | | | | | | | |
| | | | | | | | | | |
| | | | | | | | | | |
| | | | | | | | | | |
| | | | | | | | | | |
| | | | | | | | | | |
| | | | | | | | | | |
| | | | | | | | | | |
| | | | | | | | | | |
| | | | | | | | | | |

Зип Общепит

vsezip.ru

+7(812)987-08-81

Nº plano / N° plane
C-3026

Firma
(Signature)

Fecha / Date
2012-09

Denominación / Denomination:
HORNOs AE; ACE; APE-201

TURBINA / TURBINE

Lamina / Sheet
5

Fagor Industrial S. Coop. **FAGOR**
Oñate

ITEM MARCADO EN COLOR = REPUESTO RECOMENDADO
COLOURED ITEM = RECOMMENDED SPARE PART

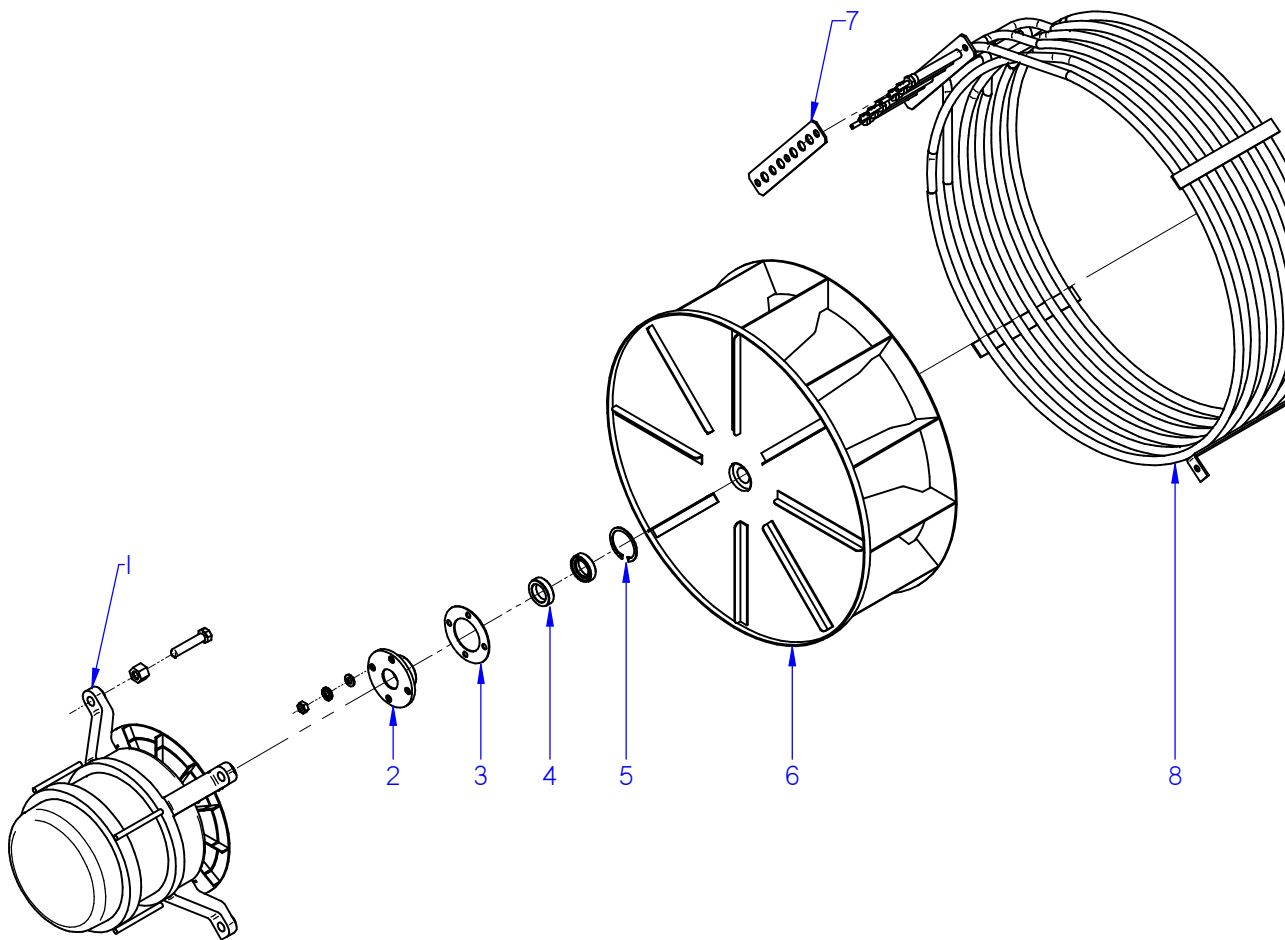

| MOD. | | HORNOS / OVEN | | ZONA / ZONE | TURBINA / TURBINE | | | | |
|------|---------------------|--------------------------------|-------------------------------|-------------|-------------------|---------|--|--|--|
| ITEM | CODIGO REFERENCE | DENOMINACION | DENOMINATION | ACE-201 | AE-201 | APE-201 | | | |
| 1 | 12024325 | MOTOR 230V AC 3N650KW 1450RPM | MOTOR 230V AC 3N650KW 1450 | 2 | 2 | 2 | | | |
| S/Nº | 12023560 | DISTANCIADOR MOTOR 10/21 | SPACER MOTOR 10/21 | 8 | 8 | 8 | | | |
| 2 | 12024742 | CASQUILLO RETEN 10/21 | SEAL BUSHING 10/21 | 2 | 2 | 2 | | | |
| 3 | 12024221 | JUNTA CASQUILLO RETEN | SEAL BUSHING GASKET | 2 | 2 | 2 | | | |
| 4 | 12024510 | RETEN 17X28X7V | RETAINER 28x17x7 | 4 | 4 | 4 | | | |
| 5 | 12010122 | ANILLO DE SEGURIDAD Ø 28X1.2 | SAFETY RING 28x1,2 | 2 | 2 | 2 | | | |
| 6 | 12024306 | TURBINA RECTA Ø350X127 HANN. | TURBINE RECTA Ø350X127 HAN | 2 | 2 | 2 | | | |
| 7 | 12041165 | JUNTA RESIST. CIRCULAR 1/1 ADV | RESIST. CIRCULAR 1/1 ADV SEAL | 4 | 4 | 4 | | | |
| 8 | 12039496 | RESIST.CONVECCION INT. 9Kw ADV | CONVECTION RESIST. INT. ADV | 2 | 2 | 2 | | | |
| 9 | 12039497 | RESIST.CONVECCION EXT. 9Kw ADV | RESIST.CONVECCION EXT. ADV | 2 | 2 | 2 | | | |
| | | | | | | | | | |
| | | | | | | | | | |
| | | | | | | | | | |
| | | | | | | | | | |
| | | | | | | | | | |
| | | | | | | | | | |
| | | | | | | | | | |
| | | | | | | | | | |
| | | | | | | | | | |
| | | | | | | | | | |
| | | | | | | | | | |
| | | | | | | | | | |
| | | | | | | | | | |
| | | | | | | | | | |
| | | | | | | | | | |
| | | | | | | | | | |
| | | | | | | | | | |
| | | | | | | | | | |

Зип Общепит

vsezip.ru

+7(812)987-08-81

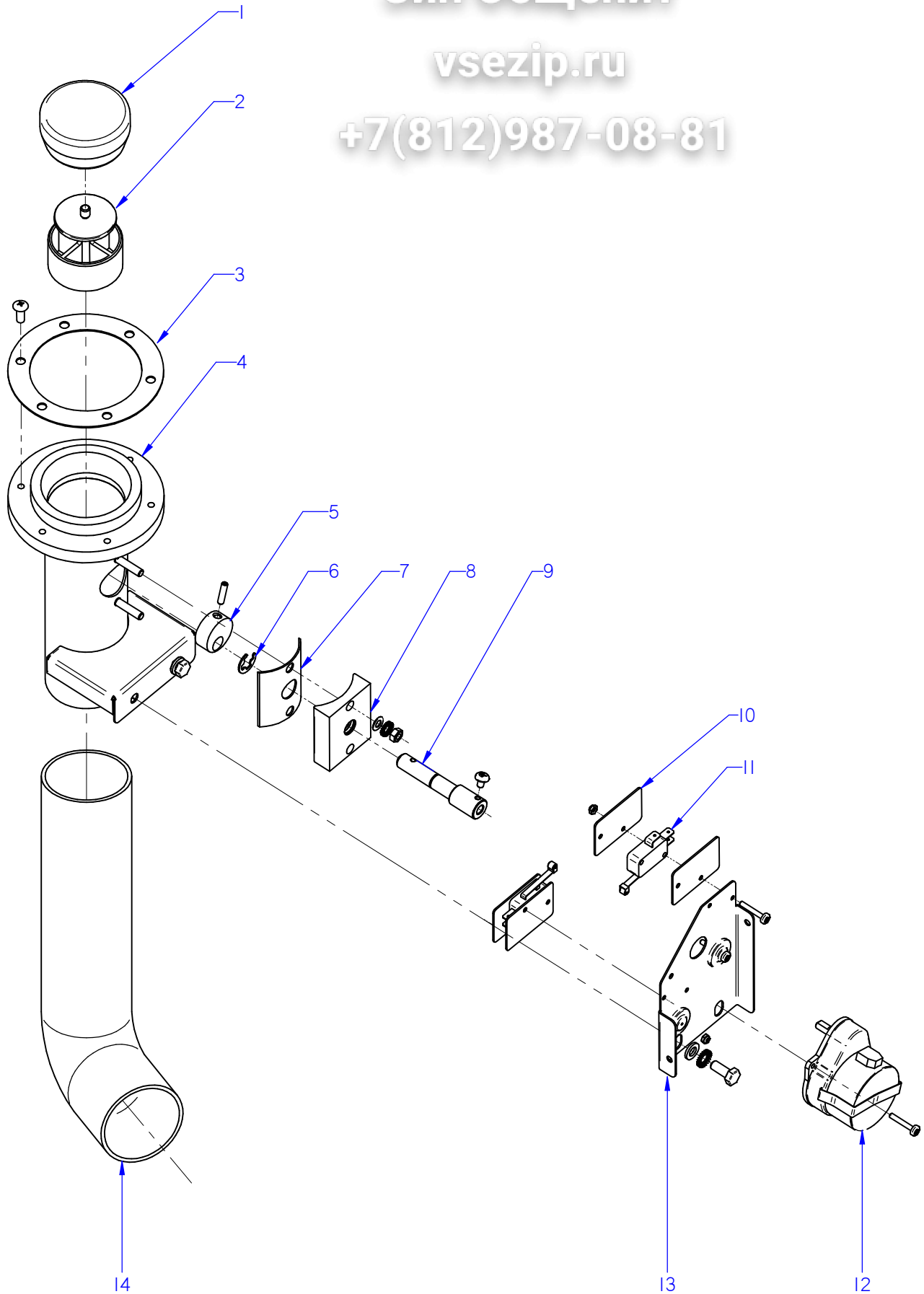

ITEM MARCADO EN COLOR = REPUESTO RECOMENDADO
COLOURED ITEM = RECOMMENDED SPARE PART

| | | | | | |
|-------------------------------|-----------------------------|-------------------------|--|---------------------|--|
| Nº plano / N° plane C-3027 | Firma <i>(Signature)</i> | Fecha / Date 2012-09 | Denominación / Denomination: CHIMENEA / FLUEPIPE HORNOS AE; ACE; APE 201 | Lamina / Sheet 6 | Fagor Industrial S.Coop. FAGOR Oñate |
|-------------------------------|-----------------------------|-------------------------|--|---------------------|--|

| MOD. | | HORNOS / OVEN | | ZONA / ZONE | | CHIMENEA / FLUEPIPE | | | | |
|------|------------------|-----------------------------|-------------------------------|-------------|--------|---------------------|--|--|--|--|
| ITEM | CODIGO REFERENCE | DENOMINACION | DENOMINATION | ACE-201 | AE-201 | APE-201 | | | | |
| 1 | 12024520 | RETENCION DE VAPORES | CLOSE CHIMNEY | 1 | 1 | 1 | | | | |
| 2 | 12024500 | GUIA RETENCION VAPORES | STEAM RETAINER GUIDE | 1 | 1 | 1 | | | | |
| 3 | 12023576 | JUNTA BASE CHIMENEA | FLUEPIPE BASE SEAL | 1 | 1 | 1 | | | | |
| S/Nº | 12095516 | JUNTA TORICA 5x1 | O-RING 5x1 | 6 | 6 | 6 | | | | |
| 4 | 12022868 | CONJUNTO CHIMENEA | COMPLETE CHIMNEY | 1 | 1 | 1 | | | | |
| 4 | 12104226 | CONJUNTO CHIMENEA | COMPLETE CHIMNEY | 1 | 1 | 1 | | | | |
| 5 | 12024328 | LEVA EJE CHIMENEA | FLUEPIPE SHAFT CAM | 1 | 1 | 1 | | | | |
| 6 | 12010014 | ARANDELA DE SEGURIDAD Ø8 | SAFETY WASHER Ø8 | 1 | 1 | 1 | | | | |
| 7 | 12023497 | JUNTA EJE CHIMENEA | FLUEPIPE SHAFT SEAL | 1 | 1 | 1 | | | | |
| 8 | 12024436 | GUIA EJE CHIMENEA | FLUEPIPE SHAFT GUIDE | 1 | 1 | 1 | | | | |
| 8 | 12098396 | GUIA EJE CHIMENEA | FLUEPIPE SHAFT GUIDE | 1 | 1 | 1 | | | | |
| S/Nº | 12010274 | JUNTA TORICA 9.19x2.62 | O-RING 9.19x2.62 | 1 | 1 | 1 | | | | |
| 9 | 12024435 | EJE CHIMENEA ELECTRICA | ELECTRIC FLUEPIPE SHAFT | 1 | 1 | 1 | | | | |
| 9 | 12104228 | EJE CHIMENEA ELECTRICA | ELECTRIC FLUEPIPE SHAFT | 1 | 1 | 1 | | | | |
| 10 | 12009985 | PLACA SEPARADORA | SPACER PLATE | 4 | 4 | 4 | | | | |
| 11 | 12025193 | INTERRUPTOR PUERTA | DOOR SWITCH | 2 | 2 | 2 | | | | |
| 12 | 12024638 | MOTOR CHIMENEA | FLUEPIPE MOTOR | 1 | 1 | 1 | | | | |
| 13 | 12022146 | ESCUA. AMARRE MOTOR CHIMEN. | FLUEPIPE MOTOR FASTENING BRAC | 1 | 1 | 1 | | | | |
| 14 | 12024122 | TUBO FLEXIBLE Ø53X360 | FLEXIBLE TUBE Ø53X360 | 1 | 1 | 1 | | | | |
| | 12009962 | ABRAZADERA 40*60 | CLAMP 40*60 | 2 | 2 | 2 | | | | |
| | | | | | | | | | | |
| | | | | | | | | | | |
| | | | | | | | | | | |
| | | | | | | | | | | |
| | | | | | | | | | | |
| | | | | | | | | | | |
| | | | | | | | | | | |
| | | | | | | | | | | |
| | | | | | | | | | | |
| | | | | | | | | | | |
| | | | | | | | | | | |
| | | | | | | | | | | |
| | | | | | | | | | | |
| | | | | | | | | | | |
| | | | | | | | | | | |
| | | | | | | | | | | |
| | | | | | | | | | | |

Зип Общепит

vsezip.ru

+7(812)987-08 81

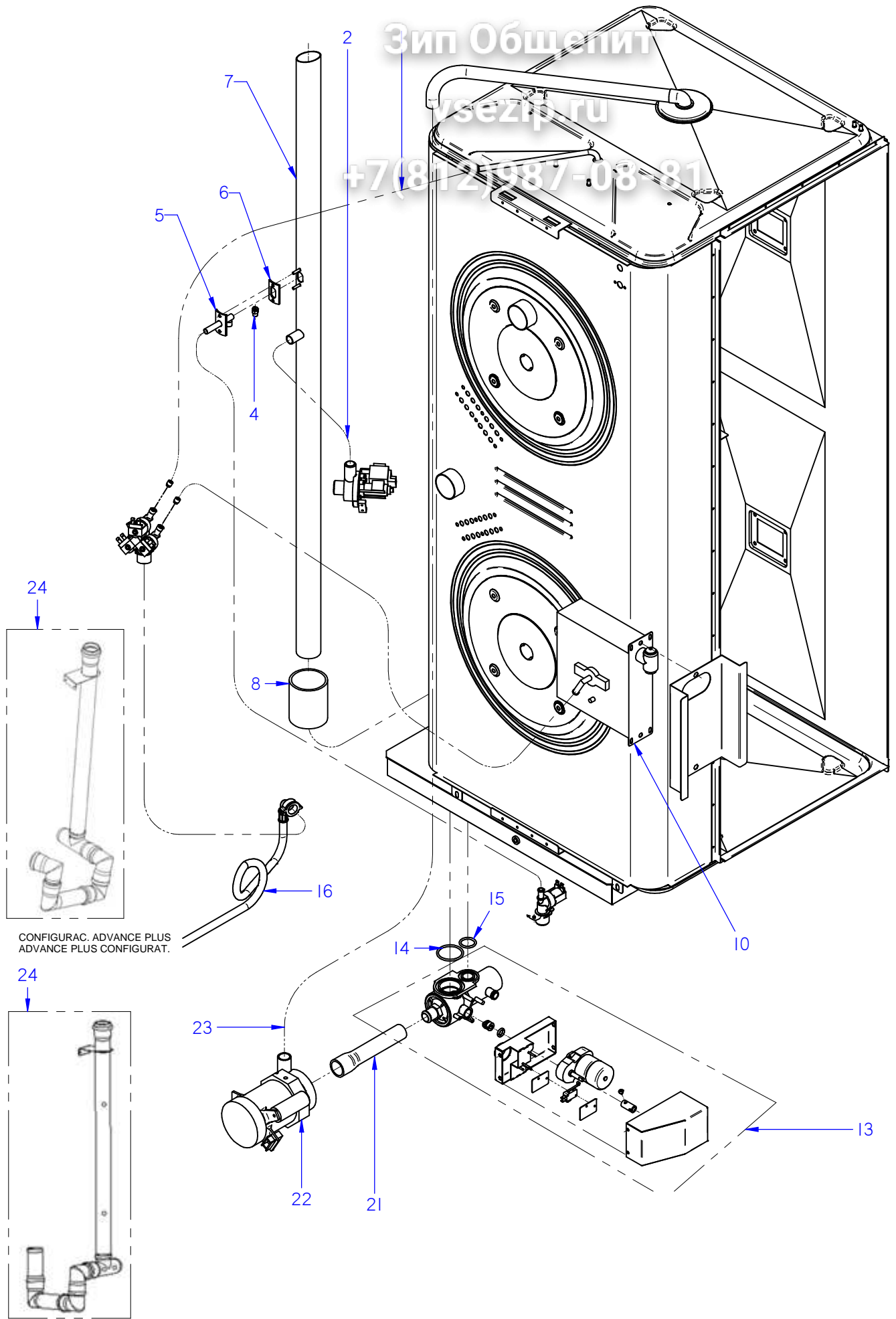

CONFIGURAC. ADVANCE PLUS
ADVANCE PLUS CONFIGURAT.

CONFIGURAC. ADVANCE / CONCEPT
ADVANCE / CONCEPT CONFIGURAT.

ITEM MARCADO EN COLOR = REPUESTO RECOMENDADO
COLOURED ITEM = RECOMMENDED SPARE PART

| | | | | | | |
|---------------------|---------|--------------|------------------------------|------------------------------------|----------------|---------------------------------------|
| Nº plano / N° plane | Firma | Fecha / Date | Denominación / Denomination: | CONDUCCIONES DE AGUA / WATER PIPES | Lamina / Sheet | Fagor Industrial S.Coop. FAGOR |
| C-3028 | Iban R. | 03-2016 | HORNOS AE; ACE; APE-201 | | 7 | Oñate |

| MOD. | | HORNOS / OVEN | | ZONA / ZONE | | CONDUCCIONES DE AGUA / WATER PIPE | | | | | |
|------|------------------|-----------------------------------|--------------------------------|-------------|--------|-----------------------------------|--|--|--|--|--|
| ITEM | CODIGO REFERENCE | DENOMINACION | DENOMINATION | ACE-201 | AE-201 | APE-201 | | | | | |
| 1 | 11000083 | T. GOMA NEGRA Ø17*10 | BLACK RUBBER PIPE Ø17*10 | 3 | 3 | 3 | | | | | |
| | 12010036 | ABRAZADERA 12*20 | CLAMP 12-20 | 6 | 10 | 8 | | | | | |
| 2 | 11000157 | TUBO SILIC. ALTA Tª D26*18 | HIGH TEMP. SILIC. HOSE D26*18 | - | 2 | 2 | | | | | |
| | 12009628 | ABRAZAD. ELASTICA 26,7*28,1 | ELAST. CLAMP 26,7*28,1 | - | 1 | 1 | | | | | |
| 4 | 12024000 | TOBERA 1/8 | NOZZLE 1/8 | 1 | 1 | 1 | | | | | |
| 4 | 12049131 | BOQUILLA 1/8M-B-1-3 | INJECTOR 1/8M-B-1-3 | 1 | 1 | 1 | | | | | |
| 5 | 12039468 | CONDUCC. VAHOS COMPLETO | COMPLETE VAPOUR DUCT | 1 | 1 | 1 | | | | | |
| 6 | 12023605 | JUNTA TUBO INYECTOR | INJECTOR PIPE SEAL | 1 | 1 | 1 | | | | | |
| 7 | 12043995 | CHIMENEA COMPLETA 201 ACE | COMPL. FLUEPIPE 201 ACE | 1 | - | - | | | | | |
| 7 | 12041127 | CHIMENEA COMPLETA 201 ADV | COMPLET FLUEPIPE 201 ADV | - | 1 | 1 | | | | | |
| 8 | 12047901 | EMPALME SILICONA Ø53 | SILICONE JOINT Ø53 | 1 | 1 | 1 | | | | | |
| | 12007943 | ABRAZADERA ELASTICA 62*66 | ELAST. CLAMP 62*66 | 2 | 2 | 2 | | | | | |
| 10 | 12040977 | DUCHA | SHOWER | - | 1 | 1 | | | | | |
| 13 | 12126816 | KIT VALVULA DESAGUE ADVAN. | VALVE DRAIN ADVANCE KIT | - | - | 1 | | | | | |
| 14 | 12010081 | JUNTA TORICA Ø52X3,5 | O-RING Ø52X3.5 | - | - | 1 | | | | | |
| 15 | 12010131 | JUNTA TORICA Ø33x3,5 | O-RING Ø33x3.5 | - | - | 1 | | | | | |
| 16 | 12025198 | MANGUERA ENTRADA AGUA | WATER INLET HOSE | 1 | 1 | 1 | | | | | |
| 21 | 12024407 | GOMA VALVULA BOMBA GAS | PUMP VALVE RUBBER | - | - | 1 | | | | | |
| | 12010023 | ABRAZADERA 20-32 | CLAMP 20-32 | - | - | 1 | | | | | |
| | 12009997 | ABRAZADERA 25-40 | CLAMP 25-40 | - | - | 1 | | | | | |
| 22 | 12024782 | MOTOBOMBA 230V AC 1N 50Hz | MOTOR 230V AC 1N 50Hz 74,6 | - | - | 1 | | | | | |
| S/Nº | 12024463 | CONDENSADOR ELEC. 250V VDE | CONDENSER ELEC. 250V VDE | 1 | 1 | 1 | | | | | |
| 23 | 11000005 | TUBO SILIC. ALTA Tª D31*23 | HIGH TEMP. SILIC. HOSE D31*23 | - | - | 2 | | | | | |
| 24 | 12047404 | MOD CONJUNTO DESAGUE ADV | ADV DRAIN SET MODEL | 1 | 1 | 1 | | | | | |
| | | | | | | | | | | | |
| | | | | | | | | | | | |
| | | | | | | | | | | | |
| | | | | | | | | | | | |
| | | | | | | | | | | | |
| | | | | | | | | | | | |
| | | | | | | | | | | | |

3ип Общепит

vsezip.ru

+7(812)987-08-81

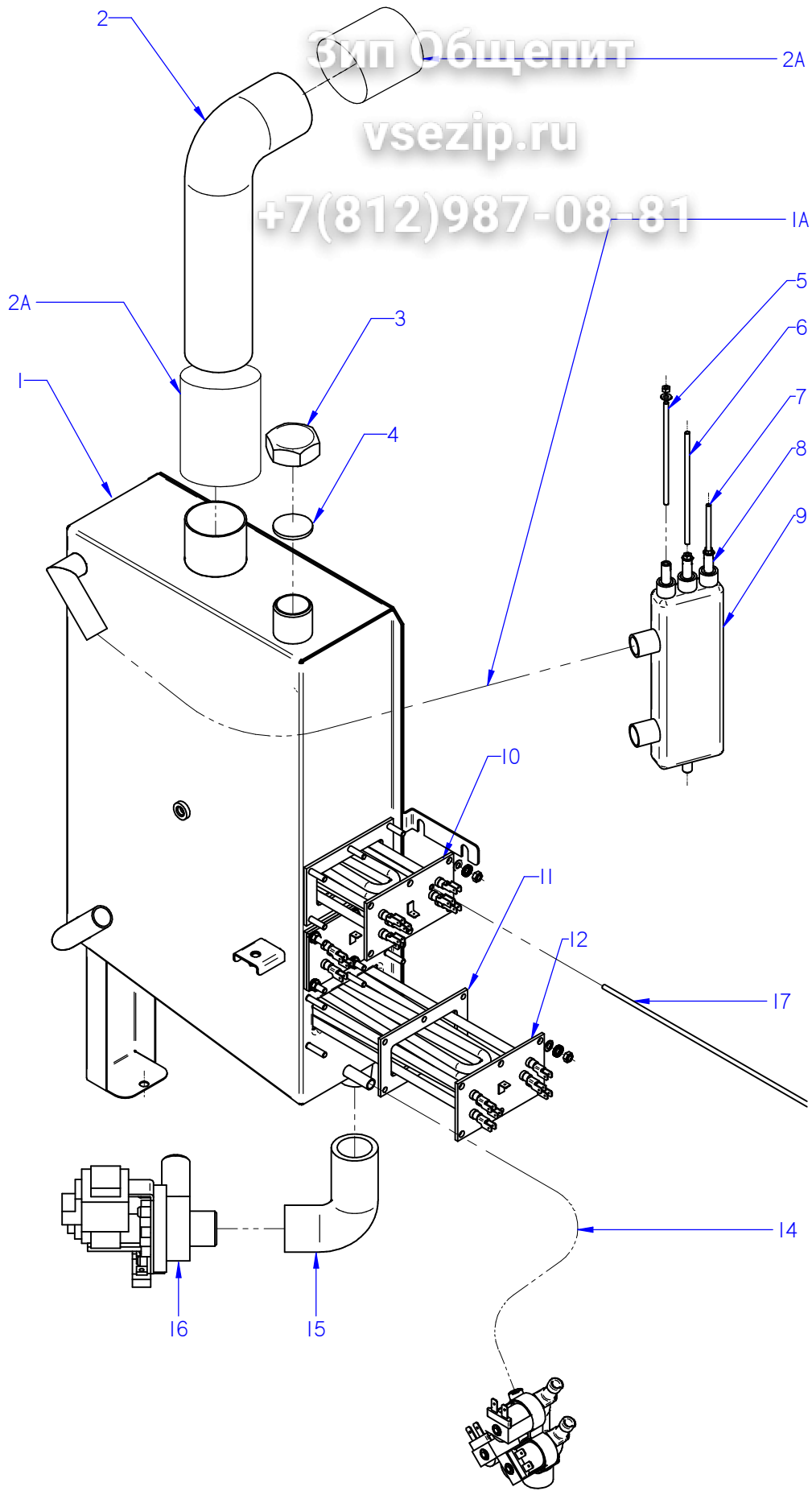

ITEM MARCADO EN COLOR = REPUESTO RECOMENDADO
COLOURED ITEM = RECOMMENDED SPARE PART

| | | | | | |
|-------------------------------|-----------------------------|-------------------------|---|---------------------|--|
| Nº plano / N° plane C-3029 | Firma <i>(Signature)</i> | Fecha / Date 03-2016 | Denominación / Denomination: CIRCUITO DE VAPOR / STEAM CIRCUIT HORNOS AE-201; APE-201 | Lamina / Sheet 8 | Fagor Industrial S.Coop. FAGOR Oñate |
|-------------------------------|-----------------------------|-------------------------|---|---------------------|--|

| MOD. | | HORNOS / OVEN | | ZONA / ZONE | | CIRCUITO DE VAPOR / STEAM CIRCUIT | | | | | |
|------|------------------|-------------------------------|------------------------------|-------------|---------|-----------------------------------|--|--|--|--|--|
| ITEM | CODIGO REFERENCE | DENOMINACION | DENOMINATION | AE-201 | APE-201 | | | | | | |
| 1 | 12046053 | KIT GENERADOR VAPOR 102-201 | STEAM GENERATOR 102-201 KIT | 1 | 1 | | | | | | |
| 1A | 11000157 | TUBO SILICONA Tº Ø 26*18 | HIGH SILICON PIPE Tº Ø 26*18 | 3 | 3 | | | | | | |
| | 12009628 | ABRAZADERA ELASTICA 26,7*28,1 | ELAST. CLAMP 26,7*28,1 | 6 | 6 | | | | | | |
| 2 | 12041855 | TUBO FLEXIBLE Ø53X360 VARILLA | FLEXIBLE TUBE Ø53X360 | 1 | 1 | | | | | | |
| 2 | 12047930 | EMPALME GENERADOR 061 | GENERATOR JOINT 601 | 1 | 1 | | | | | | |
| 2A | 12047901 | EMPALME SILICONA Ø53 | SILICONE JOINT Ø53 | 2 | 2 | | | | | | |
| 3 | 12009699 | TUERCA TAPON 1" | PLUG NUT 1" | 1 | 1 | | | | | | |
| 4 | 12009884 | ARANDELA Ø32 | WASHER Ø32 | 1 | 1 | | | | | | |
| 5 | 12023573 | ELECTRODO ALTO | HIGH LEVEL ELECTRODE | 1 | 1 | | | | | | |
| 6 | 12023574 | ELECTRODO BAJO | LOW LEVEL ELECTRODE | 1 | 1 | | | | | | |
| 7 | 12023575 | ELECTRODO DE MASA | EARTH ELECTRODE | 1 | 1 | | | | | | |
| 8 | 12024460 | GUIA AISLANTE | INSULATION GUIDE | 3 | 3 | | | | | | |
| 9 | 12024419 | BOTE DE NIVELES | LEVELS VESSEL | 1 | 1 | | | | | | |
| 9 | 12113061 | BOTE DE NIVELES INOX | LEVELS VESSEL S.STEEL | 1 | 1 | | | | | | |
| 10 | 12024752 | RESISTENCIA 3x3000W 230V | RESISTOR 3x3000W 230V | 1 | 1 | | | | | | |
| 11 | 12023680 | JUNTA CIERRE RESISTENCIAS | RESISTOR SEAL | 3 | 3 | | | | | | |
| 12 | 12024747 | RESISTENCIA 3x3000W | RESISTOR 3x3000W | 2 | 2 | | | | | | |
| 14 | 11000083 | T. GOMA NEGRA Ø17*10 | BLACK RUBBER PIPE Ø17*10 | 1 | 1 | | | | | | |
| 15 | 12039649 | TUBO DESAGÜE GENERADOR | DRAIN TUBE GENERATOR | 1 | 1 | | | | | | |
| 16 | 12039546 | MOTOBOMBA 230V AC 1N 50/60Hz | PUMP 230V AC 50/60Hz 30W 1N | 1 | 1 | | | | | | |
| 17 | 12023901 | CONJUNTO TERMOPAR VAPOR (Tg) | STEAM THERMOCOUPLE UNIT (Tg) | 1 | 1 | | | | | | |
| | | | | | | | | | | | |
| | | | | | | | | | | | |
| | | | | | | | | | | | |
| | | | | | | | | | | | |
| | | | | | | | | | | | |
| | | | | | | | | | | | |
| | | | | | | | | | | | |
| | | | | | | | | | | | |
| | | | | | | | | | | | |

Зип Общепит

vsezip.ru

+7(812)987-0881

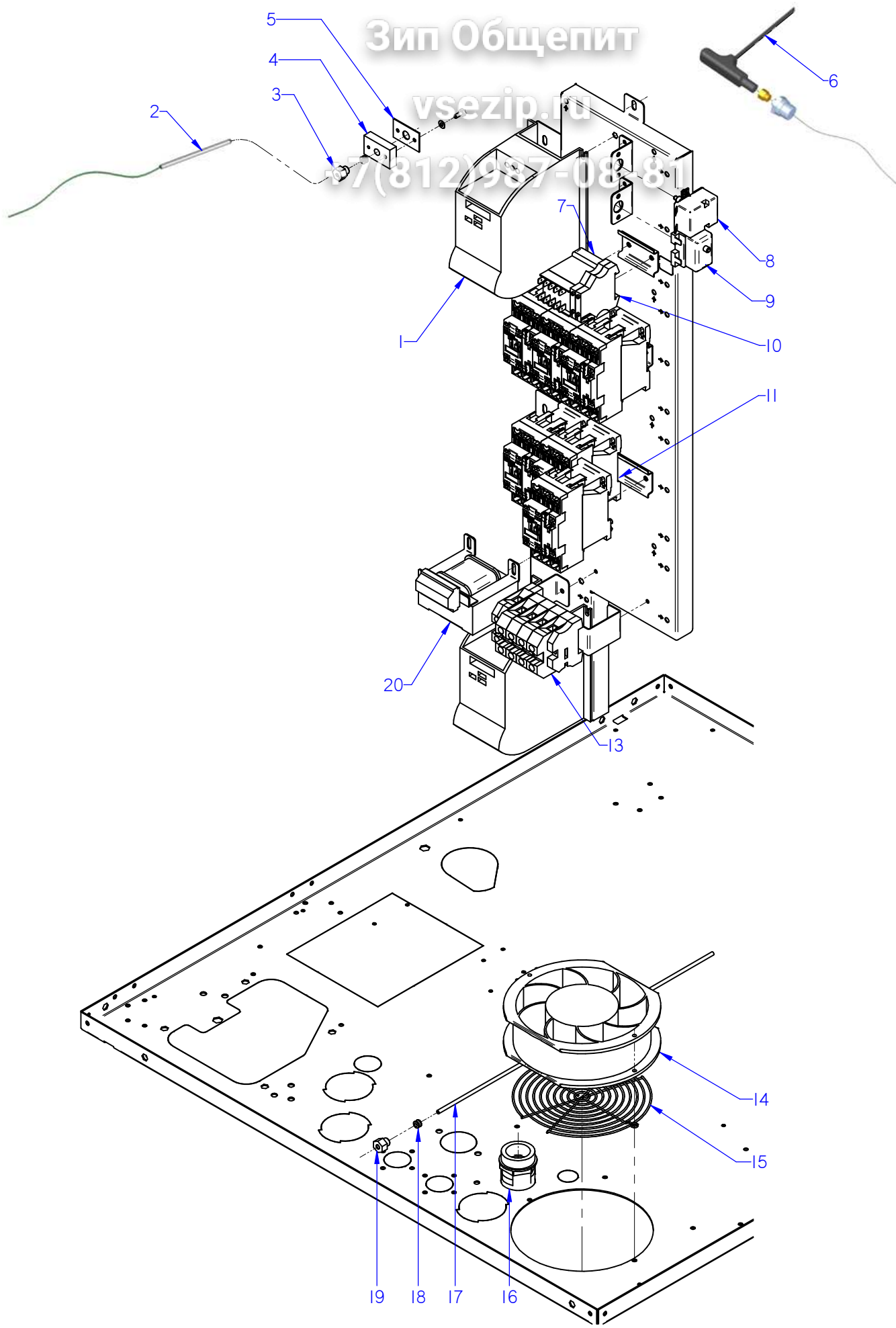

ITEM MARCADO EN COLOR = REPUESTO RECOMENDADO
COLOURED ITEM = RECOMMENDED SPARE PART

| | | | | | | |
|---------------------|--------------------|--------------|------------------------------|-----------------------------------|----------------|---------------------------------------|
| Nº plano / Nº plane | Firma | Fecha / Date | Denominación / Denomination: | CUADRO ELECTRICO / ELECTRIC PANEL | Lamina / Sheet | Fagor Industrial S.Coop. FAGOR |
| C-3030 | <i>(Signature)</i> | 2012-09 | HORNOS AE; ACE; APE-201 | 9 | Oñate | |

| MOD. | | HORNOS / OVEN | | ZONA / ZONE | | CUADRO ELECTRICO / ELECTRIC PANEL | | | | | |
|------|------------------|------------------------------------|------------------------------|-------------|--------|-----------------------------------|--|--|--|--|--|
| ITEM | CODIGO REFERENCE | DENOMINACION | DENOMINATION | ACE-201 | AE-201 | APE-201 | | | | | |
| 1 | 12048798 | REP VARIADOR REGULADO ADV | REGULATED VARIATOR ADV | 2 | 2 | 2 | | | | | |
| 2 | 12024642 | CONJUN. TERMOPAR CAMARA (Tn) | CHAM. THERMOCOUPLE UNIT (Tn) | 1 | 1 | 1 | | | | | |
| 3 | 12023581 | RACORD CIERRE SONDA | PROBE CLOSING ADAPTOR | 1 | 1 | 1 | | | | | |
| S/Nº | 12024247 | BICONO CIERRE SONDA | PROBE CLOSING BICONE | 1 | 1 | 1 | | | | | |
| 4 | 12023737 | BASE CIERRE SONDA | FIXING CORE PROBE | 1 | 1 | 1 | | | | | |
| 5 | 12023504 | JUNTA PASAMUROS SIMPLE | SIMPLE | 1 | 1 | 1 | | | | | |
| 6 | 12039548 | SONDA PINCHO ADVANCE | ADVANCE PROBE PINCHO | 1 | 1 | 1 | | | | | |
| | 12010110 | ARANDELA Ø 8.4X20X1.5 | FLAT WASHER Ø 8.4X20X1.5 | 1 | 1 | 1 | | | | | |
| | 12040566 | CONTRATUERCA H 1/4" | COUNTERNUT H 1/4" | 1 | 1 | 1 | | | | | |
| 7 | 12024011 | CONTACTOR 230 V. 50-60 HZ | 230 V. 50-60 HZ CONTACTOR | 1 | 1 | 1 | | | | | |
| 8 | 12024591 | TERMOSTATO LIMITADOR 10/21 | LIMITER THERMOSTAT10/21 | 1 | 1 | 1 | | | | | |
| 9 | 12024884 | TERMOSTATO LIMITADOR CORTE | THERMOSTAT LIMITER | - | 1 | 1 | | | | | |
| 10 | 12025158 | BORNAS PORTA FUSIBLES | FUSE HOLDER TERMINAL | 2 | 2 | 2 | | | | | |
| S/Nº | 12024152 | FUSIBLE 10A Ø5MM 20X5 | 10A Ø5MM 20X5 FUSE | 2 | 2 | 2 | | | | | |
| 11 | 12041014 | CONTAC. 230V AC 50/60Hz 40A3V | CONTAC. 230V AC 50/60Hz 40A3 | 6 | 6 | 6 | | | | | |
| 13 | 12024420 | BORNA PASO 35MM | GREY PHASE 35 TERMINAL | 3 | 3 | 3 | | | | | |
| | 12024515 | BORNA TIERRA 35MM | EARTH TERMINAL 35mm | 1 | 1 | 1 | | | | | |
| | 12025143 | BORNA PASO AZUL 35MM | NEUTRAL TERMINAL 35 BLUE | 1 | 1 | 1 | | | | | |
| | 12025158 | BORNA PORTAFUSIBLES | FUSE HOLDER TERMINAL | 2 | 2 | 2 | | | | | |
| | 12025171 | TOPE FINAL BORNA 35mm2 UL | TOP END TERMINAL 35mm2 UL | 1 | 1 | 1 | | | | | |
| 14 | 12024106 | VENTILADOR 230V AC 1N 50/60Hz 36KW | FAN 230V AC 1N 50/60Hz 36KW | 2 | 2 | 2 | | | | | |
| 15 | 12024790 | PROTECCI. VENTILADOR RM-155 | FAN PROTECTION RM-155 | 1 | 1 | 1 | | | | | |
| 16 | 12009851 | PRENSA ESTOPAS PG 29 D38 | STUFFING BOX PG 29 D38 | 1 | 1 | 1 | | | | | |
| | 12009973 | CONTRATUERCA GAES | COUNTERNUT GAES | 1 | 1 | 1 | | | | | |
| 17 | 12041634 | CON.TERMOPAR VAPOR (Tv) | STEAM THERMOCOUPLE UNIT (Tv) | 1 | 1 | - | | | | | |
| 17 | 12044609 | CONJ. TERMOPAR L425 (Tv) | L425 THERMOCOUPLE UNIT (Tv) | - | - | 1 | | | | | |
| 18 | 12043409 | BICONO CIERRE SONDA Ø4 | PROBE CLOSING BICONE Ø4 | 1 | 1 | 1 | | | | | |
| 19 | 12041049 | RACORD CIERRE SONDA Ø 4 | PROBE CLOSING ADAPTOR Ø 4 | 1 | 1 | 1 | | | | | |
| 20 | 12024173 | TRANSFORMADOR 12-0-12-0,24-0 | TRANSFORMER 12-0-12-0,24-0 | 1 | 1 | 1 | | | | | |
| | | | | | | | | | | | |
| | | | | | | | | | | | |

Зип Общепит

vsezip.ru

+7(812)987-08-81

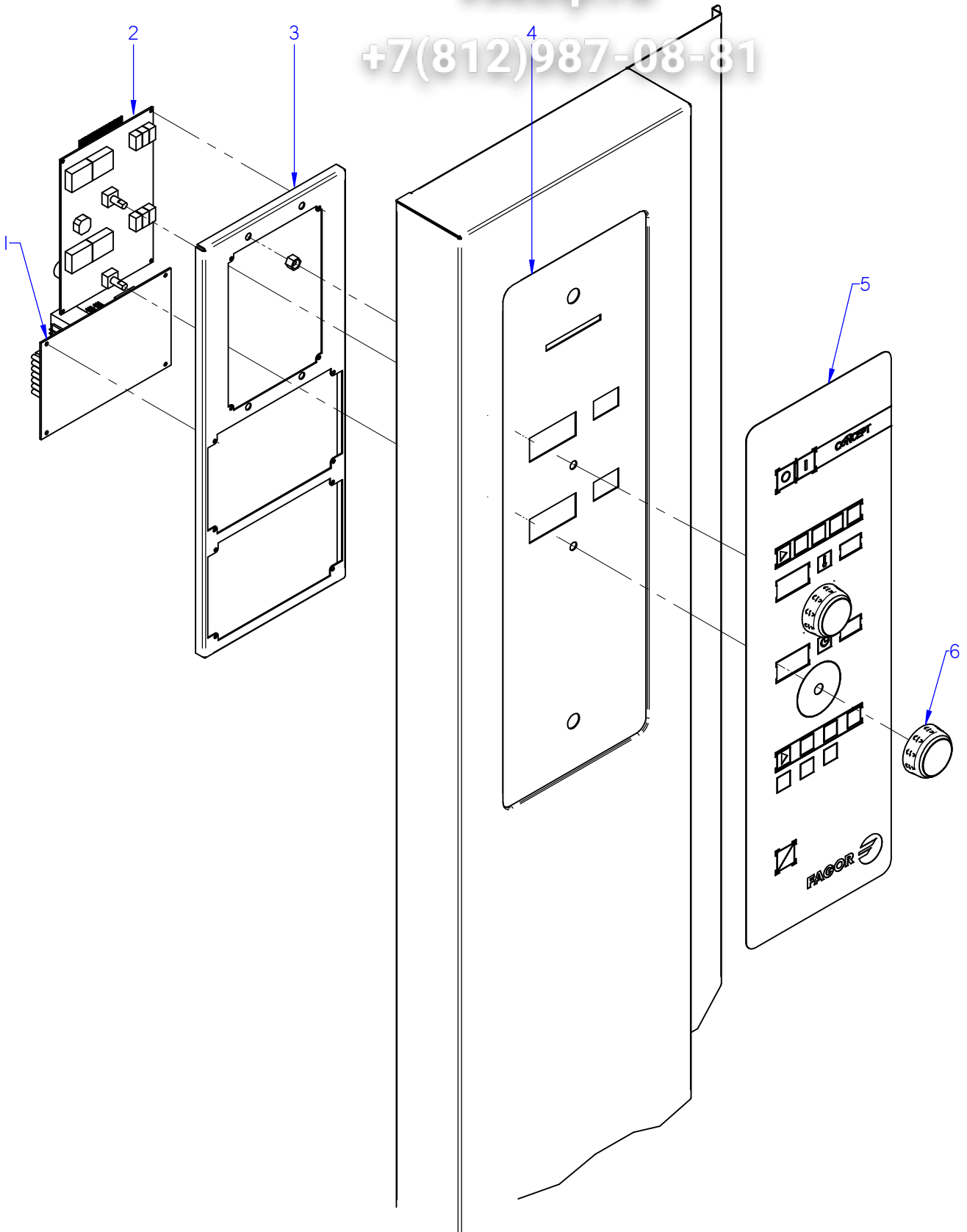

ITEM MARCADO EN COLOR = REPUESTO RECOMENDADO
COLOURED ITEM = RECOMMENDED SPARE PART

| | | | | | |
|---------------------|--------------------|--------------|---|----------------|---------------------------------------|
| Nº plano / N° plane | Firma | Fecha / Date | Denominación / Denomination: PORTAMANDOS / CONTROL HOLDER | Lamina / Sheet | Fagor Industrial S.Coop. FAGOR |
| C-3031 | <i>(Signature)</i> | 2012-09 | HORNOS ACE-201 | 10 | Odate |

| MOD. | | HORNOS / OVEN | ZONA / ZONE | CONJUNTO ELECTRICO PORTAMANDOS / CO | | | | | | | | | |
|------|---------------------|---------------------------------|-----------------------------|-------------------------------------|--|--|--|--|--|--|--|--|--|
| | | | | HOLDER ELECTRIC UNIT | | | | | | | | | |
| ITEM | CODIGO REFERENCE | DENOMINACION | DENOMINATION | ACE-200 | | | | | | | | | |
| | | | | | | | | | | | | | |
| 1 | 12046659 | CONTROL TARJETA CAM.12V AC . | CARD CONTROL 12V AC 50/60Hz | 1 | | | | | | | | | |
| 1 | 12130672 | TARJETA CAMARA GRAB. LAVADO | RECORD. CHAMBER CARD WASH | 1 | | | | | | | | | |
| 2 | 12046671 | VISUALIZADOR 12V AC 50/60Hz 12D | 12V AC 50/60Hz 12D DISPLAY | 1 | | | | | | | | | |
| 2 | 12130674 | TARJ. PORTAM. GRABADA LAVADO | REC. COTRL PANEL CARD WASH | 1 | | | | | | | | | |
| 3 | 12043668 | SOPORTE PROG. CONCEPT ADV | CIRCUIT SUPPO. CONCEPT AD | 1 | | | | | | | | | |
| 4 | 12093219 | FRENTE PORTAM. CONCEPT | CONTROL PANEL FRONT CONC. | 1 | | | | | | | | | |
| S/Nº | 12041815 | JUNTA PORTAMANDOS ADV PLUS | CONTROL PANEL SEAL ADV PLUS | 1 | | | | | | | | | |
| 5 | 12044109 | SERIGRAFIA CONCEPT ADVANCE E. | SERIGRAPHY CONCEPT ADVAN | 1 | | | | | | | | | |
| 5 | 12129318 | SERIGRAFIA ACE-ACG | ACE-ACG SERIGRAPHY | 1 | | | | | | | | | |
| 6 | 12046201 | BOTON CONCEPT ADV | CONTROL BUTTON CONC. ADV | 2 | | | | | | | | | |
| | | | | | | | | | | | | | |
| | | | | | | | | | | | | | |
| | | | | | | | | | | | | | |
| | | | | | | | | | | | | | |
| | | | | | | | | | | | | | |
| | | | | | | | | | | | | | |
| | | | | | | | | | | | | | |
| | | | | | | | | | | | | | |
| | | | | | | | | | | | | | |
| | | | | | | | | | | | | | |
| | | | | | | | | | | | | | |
| | | | | | | | | | | | | | |
| | | | | | | | | | | | | | |
| | | | | | | | | | | | | | |

Зип Общежит

vsezip.ru

+7(812)987 08-81

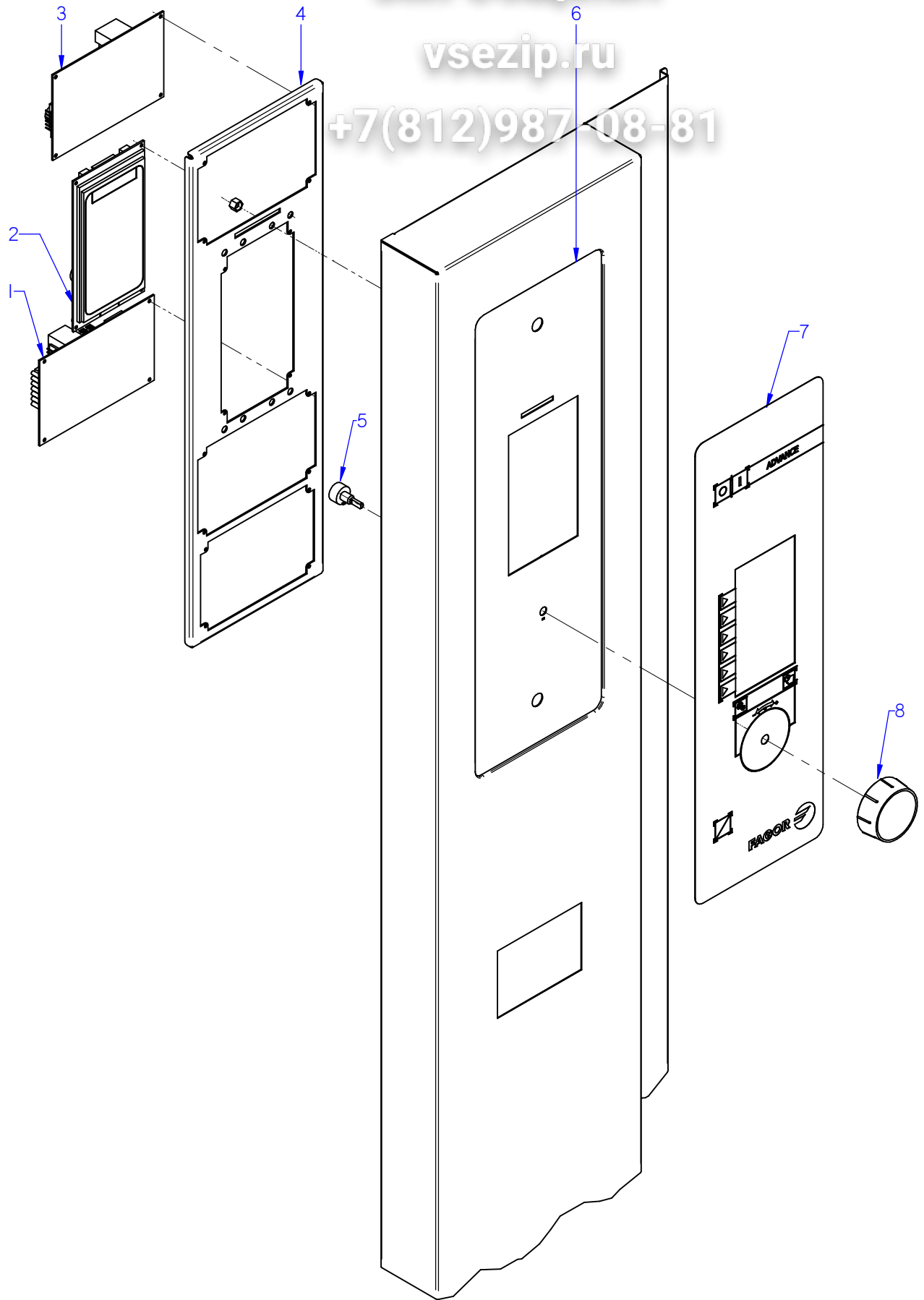

ITEM MARCADO EN COLOR = REPUESTO RECOMENDADO
COLOURED ITEM = RECOMMENDED SPARE PART

| | | | | | |
|---------------------|--------------------|--------------|---|----------------|---------------------------------------|
| Nº plano / N° plane | Firma | Fecha / Date | Denominación / Denomination: PORTAMANDOS / CONTROL HOLDER | Lamina / Sheet | Fagor Industrial S.Coop. FAGOR |
| C-3032 | <i>(Signature)</i> | 2012-09 | HORNOS AE-201 | 11 | Odate |

| | MOD. | HORNOS / OVEN | ZONA / ZONE | CONJUNTO ELECTRICO PORTAMANDOS / CO HOLDER ELECTRIC UNIT | | | | | |
|------|---------------------|------------------------------------|-----------------------------|---|--|--|--|--|--|
| ITEM | CODIGO REFERENCE | DENOMINACION | DENOMINATION | AE-201 | | | | | |
| 1 | 12046659 | CONTROL TARJETA CAM.12V AC . | CARD CONTROL 12V AC 50/60Hz | 1 | | | | | |
| 1 | 12130672 | TARJETA CAMARA GRAB. LAVADO | RECORD. CHAMBER CARD WASH | 1 | | | | | |
| 2 | 12046672 | VISUALIZADOR 12V AC 50/60Hz 32 D | 12V AC 50/60Hz 32 D DISPLAY | 1 | | | | | |
| 2 | 12130675 | REP PORTAM. ADVANCE LAVADO | RECORD. C. PANEL CARD WASH | 1 | | | | | |
| 3 | 12046670 | CONTROL TARJETA CALD. 12V AC 50/60 | CARD CONTROL 12V AC 50/60Hz | 1 | | | | | |
| 4 | 12039536 | SOPORTE CIRCUITOS ADVANCE | CIRCUIT SUPPORT ADVANCE | 1 | | | | | |
| 5 | 12043405 | ENCODER GAMA ADVANCE | ADVANCE RANGE ENCODER | 1 | | | | | |
| 6 | 12093236 | FRENTE PORTAM. AE-AG COMP. | CONTROL PANEL FRONT AE-AG | 1 | | | | | |
| S/Nº | 12041815 | JUNTA PORTAMANDOS ADV PLUS | CONTROL PANEL SEAL ADV PLUS | 1 | | | | | |
| 7 | 12044139 | SERIGRAFIA ADVANCE | ADVANCE SERIGRAPHY | 1 | | | | | |
| 7 | 12129465 | SERIGRAFIA ADVANCE LAVADO | ADVANCE SERIGRAPHY WASHING | 1 | | | | | |
| 8 | 12044074 | BOTON DE MANDO ADV | ADV CONTROL BUTTON | 1 | | | | | |
| | | | | | | | | | |
| | | | | | | | | | |
| | | | | | | | | | |
| | | | | | | | | | |
| | | | | | | | | | |
| | | | | | | | | | |
| | | | | | | | | | |
| | | | | | | | | | |
| | | | | | | | | | |
| | | | | | | | | | |
| | | | | | | | | | |
| | | | | | | | | | |
| | | | | | | | | | |
| | | | | | | | | | |
| | | | | | | | | | |
| | | | | | | | | | |
| | | | | | | | | | |
| | | | | | | | | | |

Зип Общепит

vsezip.ru

+7(812)987-08-81

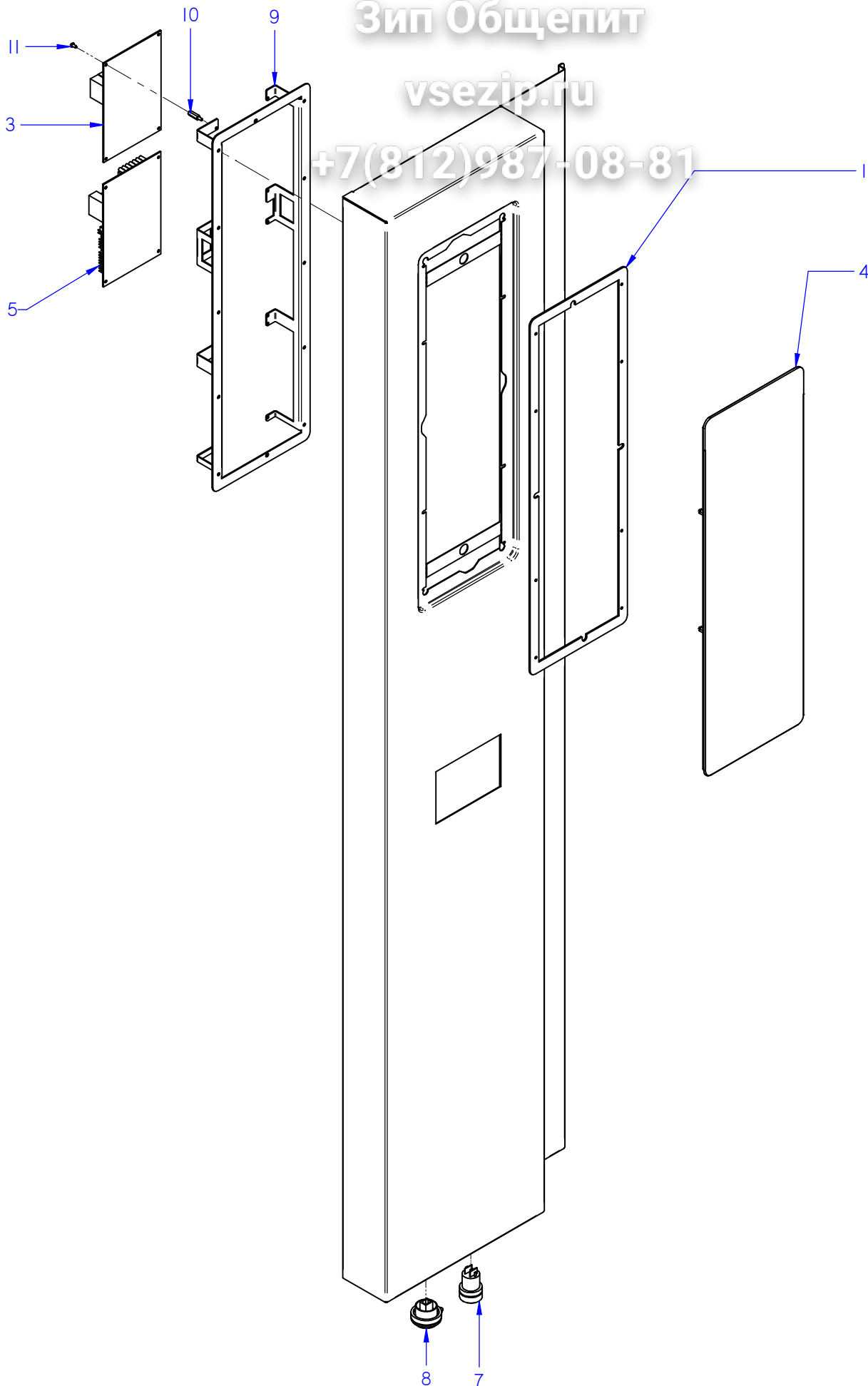

ITEM MARCADO EN COLOR = REPUESTO RECOMENDADO
COLOURED ITEM = RECOMMENDED SPARE PART

| | | | | | |
|---------------------|--------------------|--------------|---|----------------|---------------------------------------|
| Nº plano / N° plane | Firma | Fecha / Date | Denominación / Denomination: PORTAMANDOS / CONTROL HOLDER | Lamina / Sheet | Fagor Industrial S.Coop. FAGOR |
| C-3033 | <i>name Benfor</i> | 05-2015 | HORNOS APE-201 | 12 | Oñate |

| | | | |
|-------------|----------------------|--------------------|---|
| MOD. | HORNOS / OVEN | ZONA / ZONE | CONJUNTO ELECTRICO PORTAMANDOS / CO HOLDER ELECTRIC UNIT |
|-------------|----------------------|--------------------|---|

| ITEM | CODIGO REFERENCE | DENOMINACION | DENOMINATION | APE-2019 | | | | | | |
|-------------|-----------------------------|------------------------------------|-----------------------------|-----------------|--|--|--|--|--|--|
| 1 | 12041815 | JUNTA PORTAMANDOS ADV PLUS | CONTROL PANEL SEAL ADV PLUS | 1 | | | | | | |
| | 12010289 | TUERCA AUTOB. M3 DIN985 | SELF-LOCK NUT M3 DIN985 | 6 | | | | | | |
| | 12010288 | CLIP SUJECIÓN RÁPIDA Ø 4 | RAPID CONNECT CLIP Ø 4 | 12 | | | | | | |
| 3 | 12046670 | CONTROL TARJETA CALD. 12V AC 50/60 | CARD CONTROL 12V AC 50/60Hz | 1 | | | | | | |
| 4 | 12046579 | PLAT ADV PLUS CON SOFTWARE | ADV PLUS SOFTWARE PLATF. | 1 | | | | | | |
| 4 | 12121349 | PLAT ADV PLUS CON SOFTWARE | ADV PLUS SOFTWARE PLATF. | 1 | | | | | | |
| 5 | 12046659 | CONTROL TARJETA CAM.12V AC . | CARD CONTROL 12V AC 50/60Hz | 1 | | | | | | |
| 5 | 12130672 | TARJETA CAMARA GRAB. LAVADO | RECORD. CHAMBER CARD WASH | 1 | | | | | | |
| 7 | 12023927 | PULSADOR SERIE MICRO | MICRO SWITCH SERIES | 1 | | | | | | |
| 8 | 12024064 | CONECTOR USB VISUAL PLUS | VISUAL PLUS USB CONNECTOR | 1 | | | | | | |
| S/N° | 12023647 | TAPA USB VISUAL PLUS | VISUAL PLUS USB COVER | 1 | | | | | | |
| 9 | 12127553 | SOPORTE TARJETAS PLUS | PLUS CARDS SUPPORT | 1 | | | | | | |
| 10 | 12025260 | DISTANCIADOR 3M | 3M SPACER | 8 | | | | | | |
| 11 | 12024612 | FIJACION CIRCUITO | CARD CONTROL FIXER | 4 | | | | | | |
| | | | | | | | | | | |
| | | | | | | | | | | |
| | | | | | | | | | | |
| | | | | | | | | | | |
| | | | | | | | | | | |
| | | | | | | | | | | |
| | | | | | | | | | | |
| | | | | | | | | | | |
| | | | | | | | | | | |
| | | | | | | | | | | |
| | | | | | | | | | | |
| | | | | | | | | | | |
| | | | | | | | | | | |
| | | | | | | | | | | |
| | | | | | | | | | | |

Зип Цецелт

vsezip.ru

+7(812)987-08-01

| MOD. | | HORNOS / OVEN | ZONA / ZONE | VARIOS / MISCELLANEOUS | | | | | | |
|------|------------------|---------------------------------|--------------------------------|------------------------|--------|---------|--|--|--|--|
| ITEM | CODIGO REFERENCE | DENOMINACION | DENOMINATION | ACE-201 | AE-201 | APE-201 | | | | |
| | 12043770 | INSTAL. ELECTRICA ACE 201, 202 | ELEC. INSTALL. ACE 201, 202 | 1 | - | - | | | | |
| | 12041729 | INST. ELECTR. APE, AE, 202, 201 | ELEC. INSTA. APE, AE, 202, 201 | - | 1 | 1 | | | | |
| | 12043797 | CABLEADO ACE 20 2 | WIRING ACE 20 2 | 1 | - | - | | | | |
| | 12043793 | CABLEADO FUERZA ACE 20 2 | POWER WIRE ACE 20 2 | 1 | - | - | | | | |
| | 12008538 | CABLEADO FUERZA VE102 | POWER WIRE VE102 | - | 1 | 1 | | | | |
| | 12041781 | CABLEA. RESISTENCIAS APE 201 | RESISTOR WIRING APE 201 | - | 1 | 1 | | | | |
| | 12024575 | CABLEADO LUZ INTERIOR 20-21 | INTERIOR LIGHT WIRING 20-21 | 1 | 1 | 1 | | | | |
| | 12023696 | CABLEADO BMF | WIRING BMF | 1 | 1 | 1 | | | | |
| | 12040567 | CABLEADO LAVADO 201-102-202 | WIRING CABLE 201-102-202 | - | - | 1 | | | | |
| | 12008976 | CABLEADO PULSADOR RESET | RESET BUTTON WIRING | - | - | 1 | | | | |
| | 12023775 | CABLE USB VISUAL PLUS 1,5M | VISUAL PLUS USB CABLE 1,5M | - | - | 1 | | | | |
| | 12009277 | CD HACCP VISUAL COMPLETO | HACCP CD COMPLETE VISUAL | - | - | 1 | | | | |
| | 12130541 | CABLEADO VENTILADOR 201-202 | 201-202 OVEN FAN WIRING | 1 | 1 | 1 | | | | |
| | 12009257 | CABL. TRANSFORMADOR-TFT UL | TFT UL TRANSFORMER WIRING | - | - | 1 | | | | |
| | 12025235 | CONECTOR PASO 3,96MM 8 VIAS | CONNECTOR ROUTES 3,96MM 8 | 1 | 1 | 1 | | | | |
| | | | | | | | | | | |
| | | | | | | | | | | |
| | | | | | | | | | | |
| | | | | | | | | | | |
| | | | | | | | | | | |
| | | | | | | | | | | |
| | | | | | | | | | | |
| | | | | | | | | | | |
| | | | | | | | | | | |
| | | | | | | | | | | |
| | | | | | | | | | | |
| | | | | | | | | | | |
| | | | | | | | | | | |
| | | | | | | | | | | |
| | | | | | | | | | | |
| | | | | | | | | | | |
| | | | | | | | | | | |
| | | | | | | | | | | |
| | | | | | | | | | | |
| | | | | | | | | | | |
| | | | | | | | | | | |
| | | | | | | | | | | |
| | | | | | | | | | | |
| | | | | | | | | | | |
| | | | | | | | | | | |
| | | | | | | | | | | |
| | | | | | | | | | | |
| | | | | | | | | | | |
| | | | | | | | | | | |
| | | | | | | | | | | |
| | | | | | | | | | | |
| | | | | | | | | | | |
| | | | | | | | | | | |
| | | | | | | | | | | |
| | | | | | | | | | | |
| | | | | | | | | | | |
| | | | | | | | | | | |
| | | | | | | | | | | |
| | | | | | | | | | | |
| | | | | | | | | | | |
| | | | | | | | | | | |
| | | | | | | | | | | |
| | | | | | | | | | | |
| | | | | | | | | | | |

| MOD. | | HORNOS / OVEN | | ZONA / ZONE | | REPUESTOS RECOMENDADOS RECOMMENDED SPARE PART | | | | | |
|------|---------------------|---------------------------------|------------------------------|-------------|--------|--|--|--|--|--|--|
| ITEM | CODIGO REFERENCE | DENOMINACION | DENOMINATION | ACE-201 | AE-201 | APE-201 | | | | | |
| 23 | 12097686 | KIT PUERTA 201 CIERRE UNICO | SINGLE LOCK DOOR 201 KIT | 1 | 1 | 1 | | | | | |
| 1 | 12041083 | KIT CRISTAL INTER. 201 | 201 INNER GLASS KIT | 1 | 1 | 1 | | | | | |
| 8 | 12039312 | BISAGRA SUPERIOR | UPPER HINGE | 1 | 1 | 1 | | | | | |
| 12A | 12135274 | REP. ASA COMP. 20X CIERRE UNICO | SPARE SINGLE LOCK 20X HANDLE | 1 | 1 | 1 | | | | | |
| 13 | 12047967 | BASE BISAGRA INFERIOR 6 DIEN | LOWER HINGE BASE | 1 | 1 | 1 | | | | | |
| 16 | 12024560 | INTERRUPTOR MAGNETICO AC | MAGNETIC SWITCH AC | 1 | 1 | 1 | | | | | |
| 21 | 12041134 | JUNTA PUERTA COMPL.201 ADV | DOOR JOINT 201 ADV | 1 | 1 | 1 | | | | | |
| 22 | 12041088 | JUNTA CIERRE INFERIOR 201 | LOWER LOCK JOINT 201 | 1 | 1 | 1 | | | | | |
| 1 | 12025161 | E.V. 230VAC 50/60Hz 1V | SOLENOID VALVE 230VAC 1 W | 1 | | 1 | | | | | |
| 2 | 12023794 | E.V. 230VAC 50/60Hz 2V | SOLENOID VALVE 230VAC 2 W | 1 | 1 | | | | | | |
| 2 | 12115418 | E.V. 230VAC 50/60Hz 3V | SOLENOID VALVE 230VAC 3 W | | 1 | 1 | | | | | |
| 19 | 12095019 | TERMOSTATO _261_NA_51°C | THERMOSTAT _261_NA_51°C | 1 | 1 | | | | | | |
| 1 | 12024325 | MOTOR 230V AC 3N650KW 1450RPM | MOTOR 230V AC 3N650KW 1450 | 2 | 2 | 2 | | | | | |
| 4 | 12024510 | RETEN 17X28X7V | RETAINER 28x17x7 | 4 | 4 | 4 | | | | | |
| 5 | 12010122 | ANILLO DE SEGURIDAD Ø 28X1.2 | SAFETY RING 28x1,2 | 2 | 2 | 2 | | | | | |
| 6 | 12024306 | TURBINA RECTA Ø350X127 HANN. | TURBINE RECTA Ø350X127 HAN | 2 | 2 | 2 | | | | | |
| 8 | 12039496 | RESIST.CONVECCION INT. 9Kw ADV | CONVECTION RESIST. INT. ADV | 2 | 2 | 2 | | | | | |
| 9 | 12039497 | RESIST.CONVECCION EXT. 9Kw ADV | RESIST.CONVECCION EXT. ADV | 2 | 2 | 2 | | | | | |
| 11 | 12025193 | INTERRUPTOR PUERTA | DOOR SWITCH | 2 | 2 | 2 | | | | | |
| 12 | 12024638 | MOTOR CHIMENEA | FLUEPIPE MOTOR | 1 | 1 | 1 | | | | | |
| 14 | 12024122 | TUBO FLEXIBLE Ø53X360 | FLEXIBLE TUBE Ø53X360 | 1 | 1 | 1 | | | | | |
| 13 | 12126816 | KIT VALVULA DESAGUE ADVAN. | VALVE DRAIN ADVANCE KIT | | | 1 | | | | | |
| 22 | 12024782 | MOTOBOMBA 230V AC 1N 50Hz | MOTOR 230V AC 1N 50Hz 74,6 | | | 1 | | | | | |
| 5 | 12023573 | ELECTRODO ALTO | HIGH LEVEL ELECTRODE | | 1 | 1 | | | | | |
| 6 | 12023574 | ELECTRODO BAJO | LOW LEVEL ELECTRODE | | 1 | 1 | | | | | |
| 7 | 12023575 | ELECTRODO DE MASA | EARTH ELECTRODE | | 1 | 1 | | | | | |
| 10 | 12024752 | RESISTENCIA 3x3000W 230V | RESISTOR 3x3000W 230V | | 1 | 1 | | | | | |
| 12 | 12024747 | RESISTENCIA 3x3000W | RESISTOR 3x3000W | | 2 | 2 | | | | | |
| 16 | 12039546 | MOTOBOMBA 230V AC 1N 50/60Hz | PUMP 230V AC 50/60Hz 30W 1N | | 1 | 1 | | | | | |
| 17 | 12023901 | CONJUNTO TERMOPAR VAPOR (Tg) | STEAM THERMOCOUPLE UNIT (Tg) | | 1 | 1 | | | | | |
| 1 | 12048798 | REP VARIADOR REGULADO ADV | REGULATED VARIATOR ADV | 2 | 2 | 2 | | | | | |

| MOD. | | HORNO / OVEN | ZONA / ZONE | REPUESTOS RECOMENDADOS RECOMMENDED SPARE PART | | | | | |
|------|---------------------|------------------------------------|------------------------------|--|--------|---------|--|--|--|
| ITEM | CODIGO REFERENCE | DENOMINACION | DENOMINATION | ACE-201 | AE-201 | APE-201 | | | |
| 2 | 12024642 | CONJUN. TERMOPAR CAMARA (Tn) | CHAM. THERMOCOUPLE UNIT (Tn) | 1 | 1 | 1 | | | |
| 6 | 12039548 | SONDA PINCHO ADVANCE | ADVANCE PROBE PINCHO | 1 | 1 | 1 | | | |
| 7 | 12024011 | CONTACTOR 230 V. 50-60 HZ | 230 V. 50-60 HZ CONTACTOR | 1 | 1 | 1 | | | |
| 8 | 12024591 | TERMOSTATO LIMITADOR 10/21 | LIMITER THERMOSTAT10/21 | 1 | 1 | 1 | | | |
| 9 | 12024884 | TERMOSTATO LIMITADOR CORTE | THERMOSTAT LIMITER | - | 1 | 1 | | | |
| 11 | 12041014 | CONTAC. 230V AC 50/60Hz 40A3V | CONTAC. 230V AC 50/60Hz 40A3 | 6 | 6 | 6 | | | |
| 15 | 12024106 | VENTILADOR 230V AC 1N 50/60Hz 36KV | FAN 230V AC 1N 50/60Hz 36KW | 2 | 2 | 2 | | | |
| 17 | 12041634 | CON.TERMOPAR VAPOR (Tv) | STEAM THERMOCOUPLE UNIT (Tv) | 1 | 1 | - | | | |
| 17 | 12044609 | CONJ. TERMOPAR L425 (Tv) | L425 THERMOCOUPLE UNIT (Tv) | - | - | 1 | | | |
| 20 | 12024173 | TRANSFORMADOR 12-0-12-0,24-0 | TRANSFORMER 12-0-12-0,24-0 | 1 | 1 | 1 | | | |
| 1 | 12130672 | TARJETA CAMARA GRAB. LAVADO | RECORD. CHAMBER CARD WASH | 1 | 1 | 1 | | | |
| 2 | 12130674 | TARJ. PORTAM. GRABADA LAVADO | REC. COTRL PANEL CARD WASH | 1 | - | - | | | |
| 5 | 12044109 | SERIGRAFIA CONCEPT ADVANCE E. | SERIGRAPHY CONCEPT ADVAN | 1 | - | - | | | |
| 2 | 12130675 | REP PORTAM. ADVANCE LAVADO | RECORD. C. PANEL CARD WASH | - | 1 | - | | | |
| 3 | 12046670 | CONTROL TARJETA CALD. 12V AC 50/60 | CARD CONTROL 12V AC 50/60Hz | - | 1 | 1 | | | |
| 5 | 12043405 | ENCODER GAMA ADVANCE | ADVANCE RANGE ENCODER | - | 1 | - | | | |
| 7 | 12129465 | SERIGRAFIA ADVANCE LAVADO | ADVANCE SERIGRAPHY WASHING | - | 1 | - | | | |
| 1 | 12041815 | JUNTA PORTAMANDOS ADV PLUS | CONTROL PANEL SEAL ADV PLUS | 1 | 1 | 1 | | | |
| 4 | 12121349 | PLAT ADV PLUS CON SOFTWARE | ADV PLUS SOFTWARE PLATF. | - | - | 1 | | | |
| | | | | | | | | | |
| | | | | | | | | | |
| | | | | | | | | | |
| | | | | | | | | | |
| | | | | | | | | | |
| | | | | | | | | | |
| | | | | | | | | | |
| | | | | | | | | | |
| | | | | | | | | | |
| | | | | | | | | | |
| | | | | | | | | | |
| | | | | | | | | | |
| | | | | | | | | | |

3 ~ 400V

| | |
|----------|-----------|
| Mod. 101 | RC2=3x3KW |
| Mod. 201 | RC2=3x6KW |
| Mod. 102 | RC2=3x5KW |
| Mod. 202 | RC2=6x5KW |

| | |
|---------------|-----------|
| Mod. 061, 101 | RC1=3x3KW |
| Mod. 201 | RC1=3x6KW |
| Mod. 102 | RC1=3x5KW |
| Mod. 202 | RC1=6x5KW |

| | |
|---------------|-----------|
| Mod. 061, 101 | RV1=3x3KW |
| Mod. 201, 102 | RV1=6x3KW |
| Mod. 202 | RV1=9x3KW |
| Mod. 101, 102 | RV2=3x3KW |
| Mod. 202 | RV2=9x3KW |

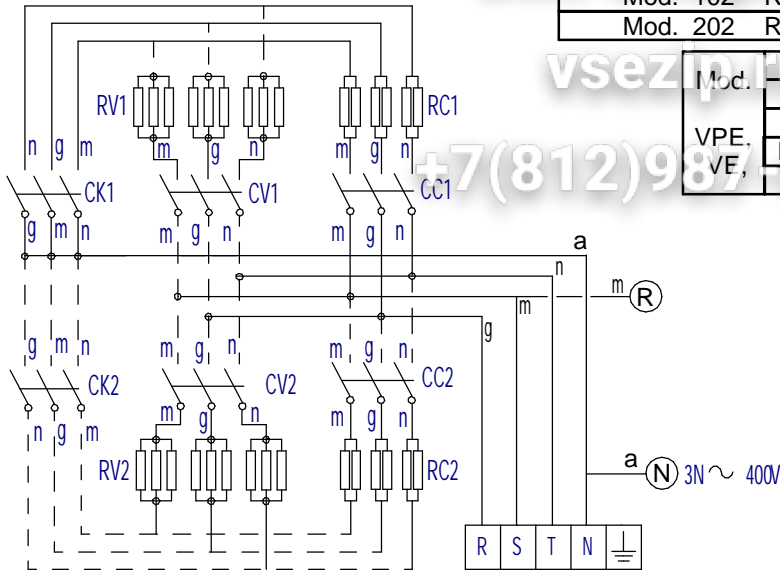

3 ~ 230V

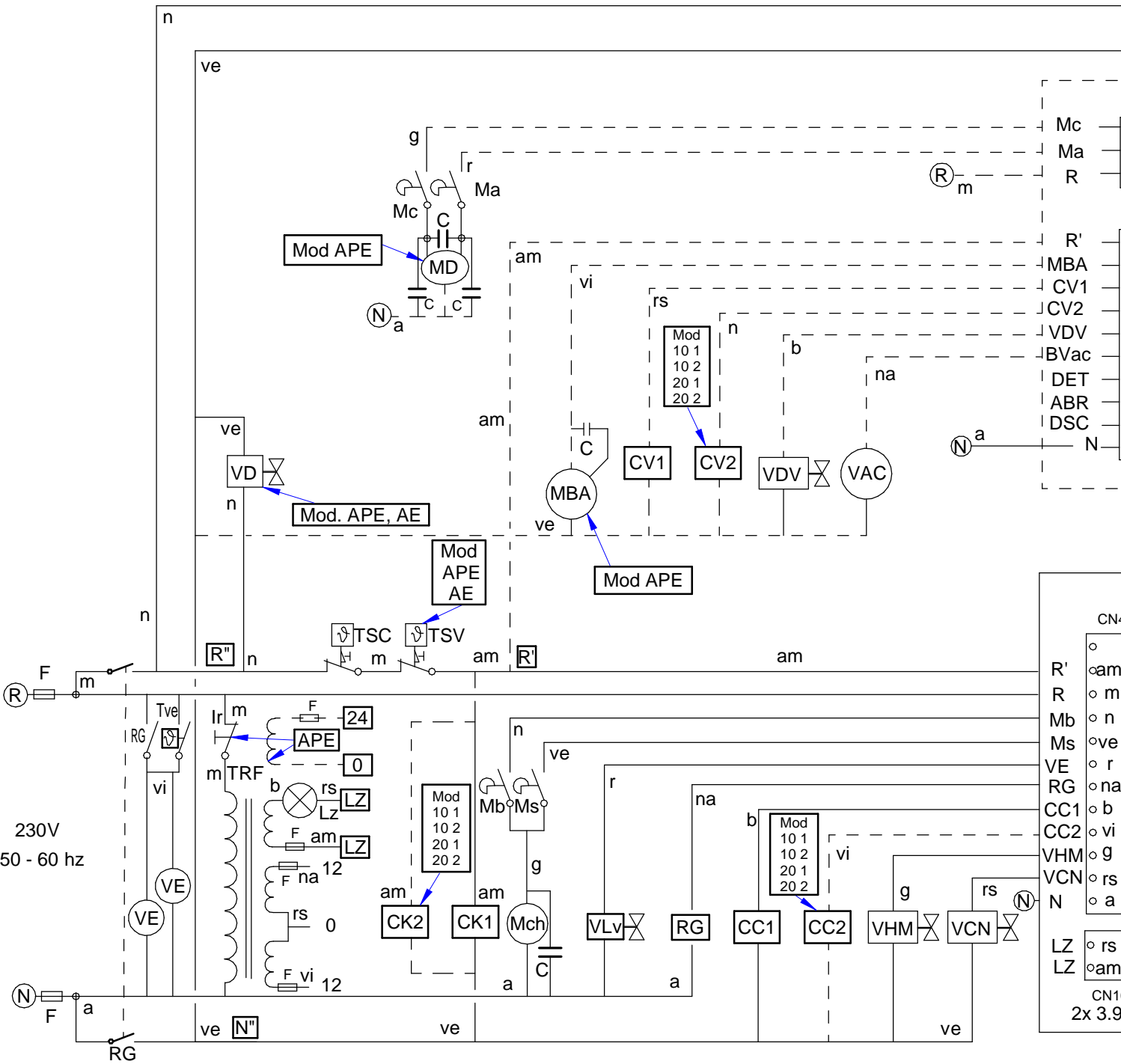
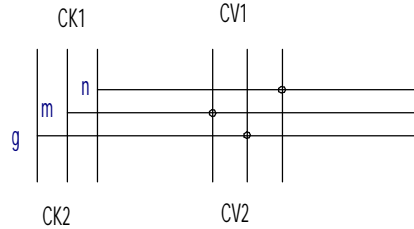

VE 061,101,102 12023862
 VE 201,202 12023862

Зип Общепит

vsezip.ru

+7(812)987-08-81

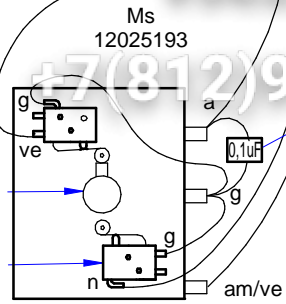
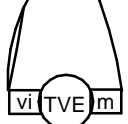
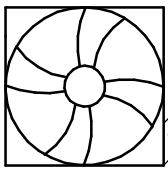

Mch 12018443
 Mb 12025193

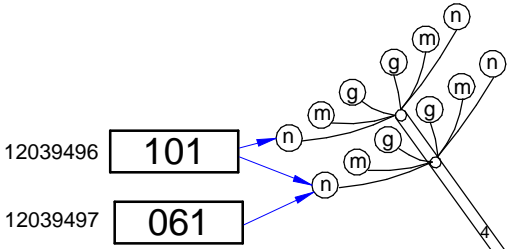
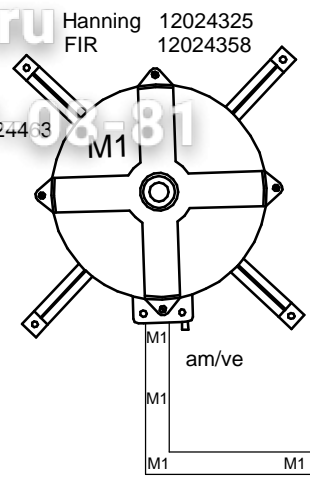

12039496
 12039497

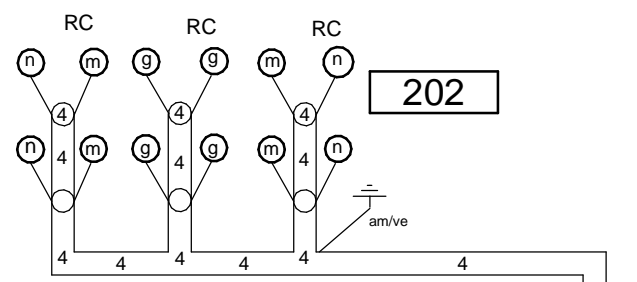
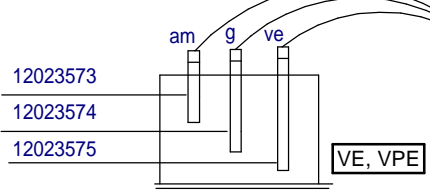

RC 202
 15+15 KW 12024349 + 12024359

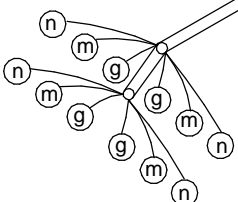

201

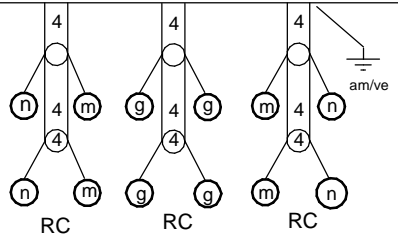

RC 102
 15+15 KW 12024349 + 12024359

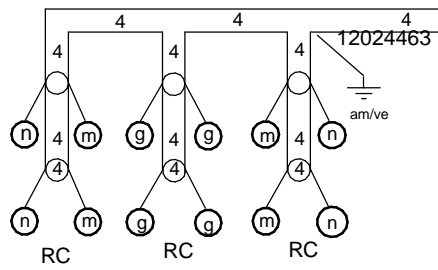
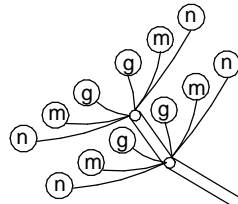

RC 202 15+15 KW
 12024349 + 12024359

TSV

Tg

RV 12024752
 APE, AE

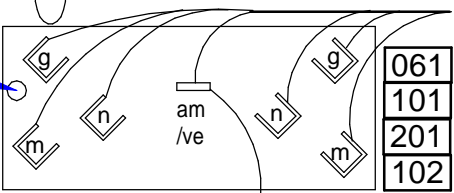

RV 12024752
 APE, AE

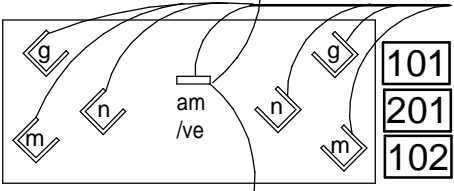

Hanning 12024325
 FIR 12024358

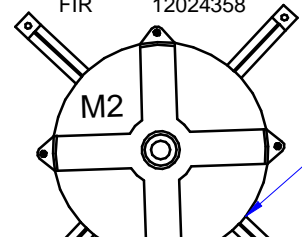

20X

Зип Общепит

| | |
|----------|-----------|
| Mod. 101 | RC2=3x3KW |
| Mod. 201 | RC2=3x6KW |
| Mod. 102 | RC2=3x5KW |
| Mod. 202 | RC2=6x5KW |

| | |
|---------------|---|
| Mod. 061, 101 | R |
| Mod. 201 | R |
| Mod. 102 | R |
| Mod. 202 | R |

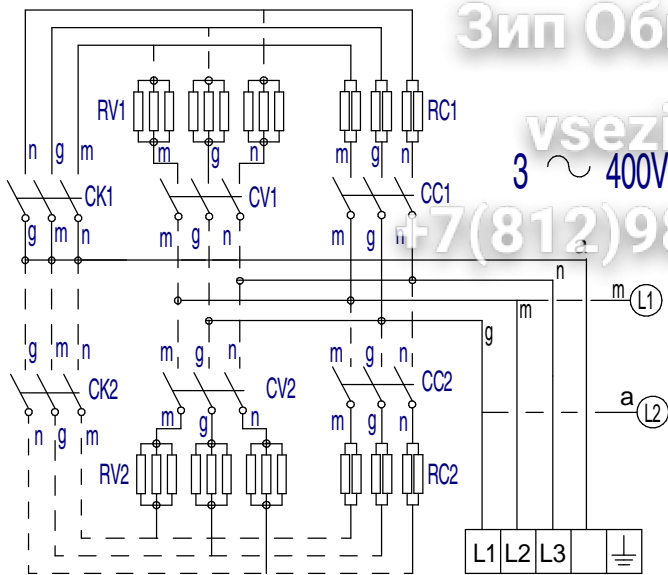

3 ~ 400V

7(812)987-08

| | | |
|------|--------------------|-----------|
| Mod. | Mod. 061, 101 | RV1=3x3KW |
| | Mod. 201, 102 | RV1=6x3KW |
| | Mod. 202 | RV1=9x3KW |
| VDE | Mod. 101, 102, 201 | RV2=3x3KW |
| VE | Mod. 202 | RV2=9x3KW |

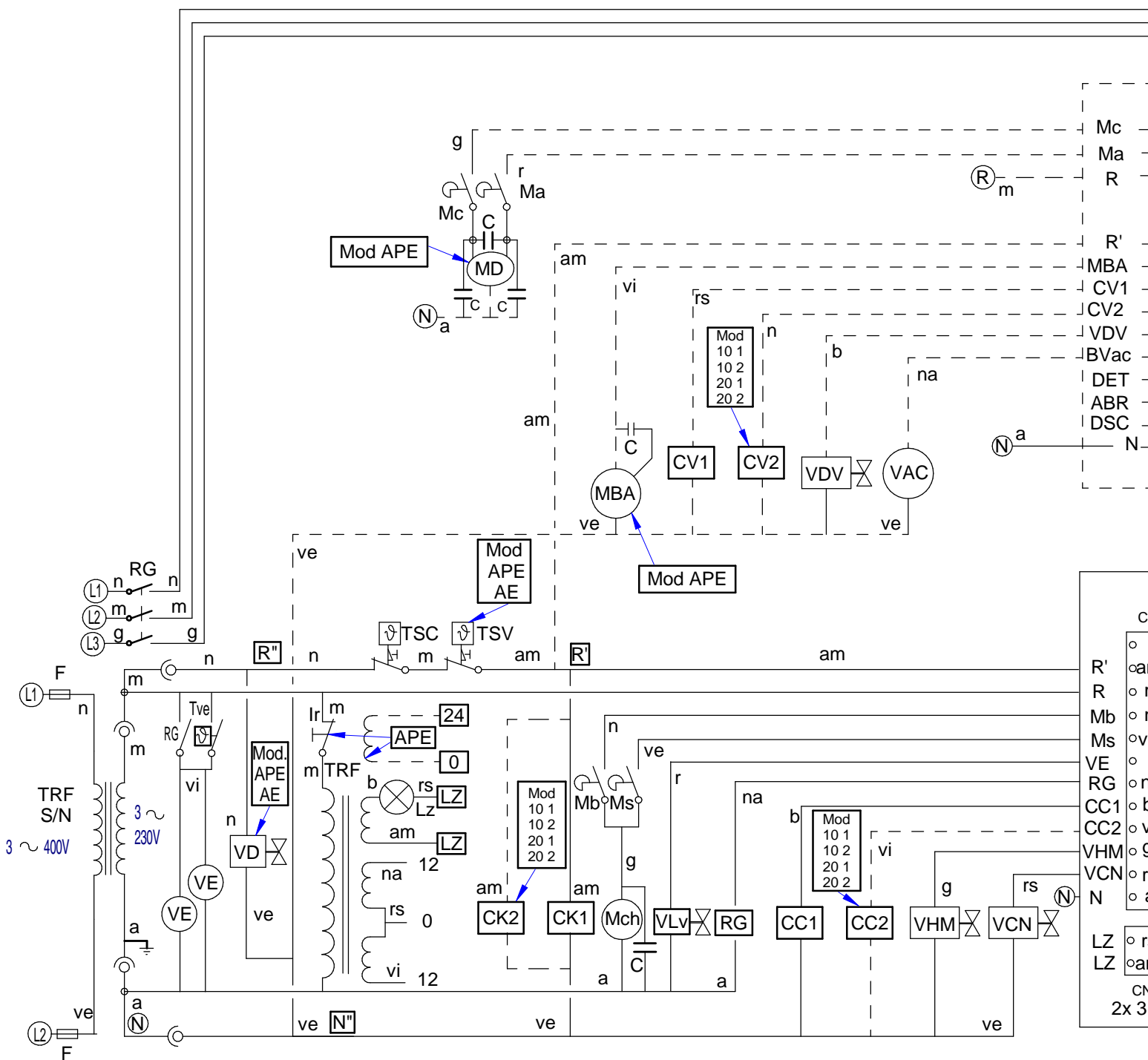

KIT 400V SIN NEUTRO HORNOS ELECTRICOS

400V KIT, WITHOUT NEUTRAL ELECTRIC OVENS

12004270

3 ~ 400 V Sin Neutro

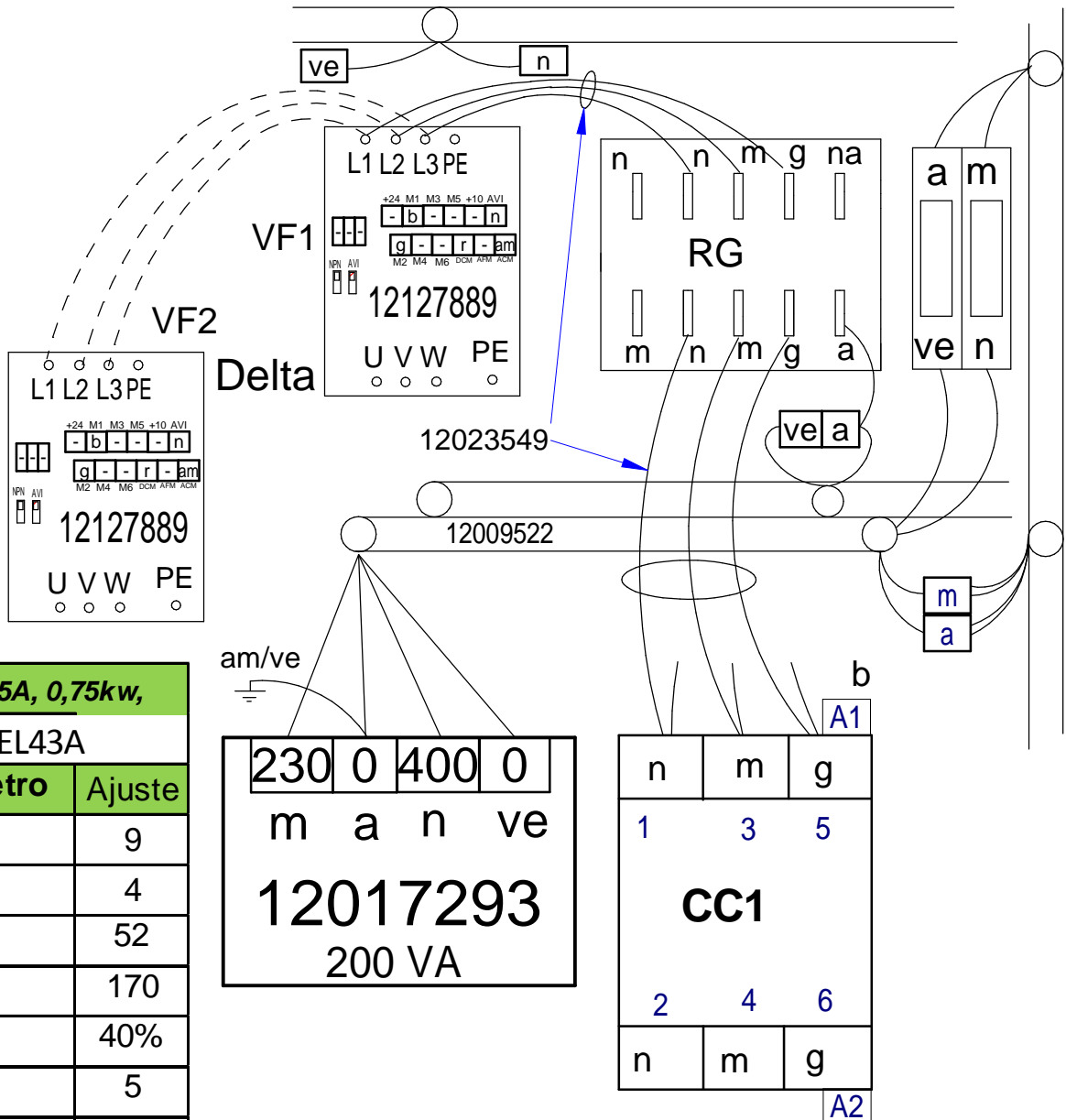

| 400V, 2,5A, 0,75kw, | |
|---------------------|--------|
| VFD007EL43A | |
| Parámetro | Ajuste |
| 00.02 | 9 |
| 00.04 | 4 |
| 01-00 | 52 |
| 01-02 | 170 |
| 01-08 | 40% |
| 01-09 | 5 |
| 01-10 | 5 |
| 02.03 | 12 |
| 02.05 | 2 |
| 04.04 | 1 |
| 06-02 | 100% |
| 06-06 | 1 |
| 08.15 | 3 |

Esquema Electrico 12093105

Nota: El cable azul que va a CK1, conectarlo a CV1 junto al cable gris.

Note: The blue wire that going to CK1, Connect to CV1 with gray wire together.

| | ESPAÑOL | ENGLISH | FRANÇAIS |
|----------------------|-----------------------------------|-----------------------------------|-------------------|
| BEC | Bujía Encendido Cámara | Chamber Spark Plug | Bougie Allumage |
| BEV | Bujía Encendido Caldera | Boiler Spark Plug | Bougie Allumage |
| C.C. | Control Camara | Chamber Control | Contrôle Chambr |
| C.E.C | Control Combustión Cámara | Chamber Combustion Control | Contrôle Comb |
| C.E.V | Control Combustión Caldera | Boiler Combustion Control | Contrôle Comb |
| C.G. | Control Gas | Control Gas | Contrôle Gaz |
| C.V. | Control Caldera | Boiler Control | Contrôle Chaud |
| CC1, CC2 | Contactador Resistencia Cámara | Chamber Heating Element Contactor | Contacteur Élém |
| CK1, CK2 | Contactador General Calentamiento | Heating Element Relay | Relais Élément |
| CV1, CV2 | Contactador Resistencias Caldera | Boiler Heating Element Contactor | Contacteur Élém |
| DEC | Detector Llama Cámara | Chamber Flame Detector | Détecteur Flam |
| DEV | Detector Llama Caldera | Boiler Flame Detector | Détecteur Flam |
| DN | Detector Nivel Caldera | Boiler Level Detector | Détecteur Nivea |
| E1, E2, E3 | Encendedor, generador de chispa | Spark generator | Générateur d'ét |
| F, F1, F2, F3, F4, F | Fusibles | Fuses | Fusibles |
| FI | Filtro Interferencias | Interference Filter | Filtre Interféren |
| FM | Térmico Motor | Thermal Engine | Thermique Mote |
| GV1, GV2 | Electro válvula Gas Cámara | Chamber Gas Solenoid Valve | Électrovanne G |
| GV3, GV4 | Electro válvula Gas Caldera | Boiler Gas Solenoid Valve | Électrovanne G |
| Ip | Interruptor Seguridad Puerta | Door Safety Switch | Interrupteur Sé |
| Lz | Luz Interior | Inner Light | Éclairage Intérie |
| M, M2 | Motor Turbina | Turbine Engine | Moteur Turbine |
| Ma | Interruptor Micro Abierto | Open Microswitch | Microrupteur Ou |
| Mb | Interruptor Micro Bajada | Drop Microswitch | Microrupteur De |
| Mc | Interruptor Micro Cerrado | Closed Microswitch | Microrupteur Fe |
| Mch | Motor Chimenea | Stack Engine | Moteur Chemin |
| MD | Motor Desague | Drain Engine | Moteur évacuat |
| Ms | Interruptor Micro Subida | Rise Microswitch | Microrupteur M |
| RC | Resistencias Cámara | Chamber Heating Element | Éléments Chau |
| RG | Rele General | Main Relay | Relais Général |
| RV | Resistencias Caldera | Boiler Heating Element | Éléments Chau |
| Tc | Sonda Cámara | Chamber Probe | Sonde Chambr |
| TCN | Termostato Condensación | Condensation Thermostat | Thermostat Cor |
| Tg | Sonda Caldera | Boiler Probe | Sonde Chaudièr |
| Tn | Sonda Núcleo | Core Probe | Sonde Noyau |
| TRF | Transformador | Transformer | Transformateur |
| TSC | Termostato Seguridad Cámara | Chamber Safety Thermostat | Thermostat Sé |
| TSV | Termostato Seguridad Caldera | Boiler Safety Thermostat | Thermostat Sé |
| Tv | Sonda Vapor | Steam Probe | Sonde Vapeur |
| VAC | Bomba Vaciado | Vacuum Pump | Pompe Vidange |
| MBA | Moto Bomba Aclarado | Rinsing Pump | Pompe Rinçage |
| VC1, VC2 | Ventilador Soplante Camara | Blowing Fan | Ventilateur Sou |
| VCN | Electro válvula Condensación | Condensation Solenoid Valve | Électrovanne C |
| VDV | Electro válvula Llenado Caldera | Chamber Filling Solenoid Valve | Électrovanne R |
| VE | Ventilador Cuadro Eléctrico | Fan Switchboard | Ventilateur Tabl |
| VF1, VF2 | Variador de Frecuencia | Speed Variator | Variateur Vites |
| VHM | Electro válvula Humidificador | Humidifier Solenoid Valve | Électrovanne H |
| Vv | Ventilador Soplante Caldera | Boiler Blowing Fan | Ventilateur sou |
| | COLORES | COLOUR | COULEURS |
| a / BLU | Azul | Blue | Bleu |
| am / YEL | Amarillo | Yellow | Jaune |
| am ve / YEL GRN | Amarillo/verde | Yellow / green | Jaune / vert |
| b / WHT | Blanco | White | Blanc |
| g / GRY | Gris | Grey | Gris |
| m / BRN | Marrón | Brown | Marron |
| n / BLK | Negro | Black | Noir |
| na / ORG | Naranja | Orange | Orange |
| r / RED | Rojo | Red | Rouge |
| rs / PNK | Rosa | Pink | Rose |
| ve / GRN | Verde | Green | Vert |
| vi / PRP | Violeta | Purple | Violet |