

Зип Общепит

vsezip.ru

+7(812)987-08-81



31PIE6

Edition 20110101-

Зип Общепит

vsezip.ru

+7(812)987-08-81

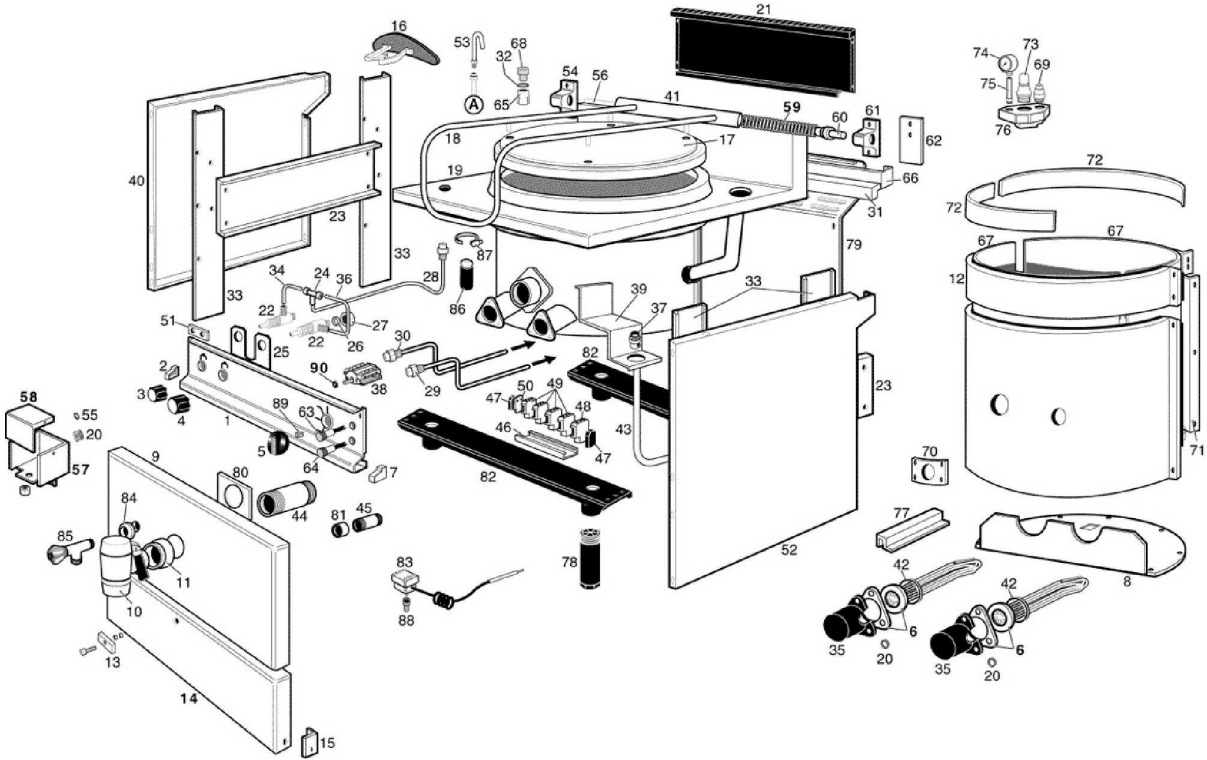

Pos	Code	Description	Info
001	35B7010	UPPER CONTROL BOARD	01/09/1996-
002	36D3430	LH END SIDE	01/09/1996-
003	36M2642	RED RING KNOB	01/01/2011-
004	36M2632	BLUE RING KNOB	01/01/2011-
005	36M2400	ELECTRIC CONTROL	01/09/1996-
006	32G1931	KNOB HEATING EL.	01/09/1996-
007	36D3420	RH END SIDE	01/09/1996-
008	35Q7690	LOWER INS. PANEL	01/09/1996-
009	35B7021	COVER UPPER FRONT PANEL	01/09/1996-
010	33D2291	"DRAIN COCK 2""	01/10/2008-
011	37M0580	COVER RING Ø 112	01/09/1996-
012	35Q8000	INS. PANEL COVERING	01/09/1996-
013	35T9780	FLAT BRACKET	01/09/1996-
014	35B7031	LOWER FRONT PANEL	01/09/1996-
015	35V1980	"L" BRACKET	01/09/1996-
016	30Q0450	FILTER	01/09/1996-
017	35G6910	PAN LID	01/09/1996-
018	36M5200	HANDLE	01/09/1996-
019	30W3030	STEAM-JACKETED EL. PAN	01/09/1996-
020	32X0120	GROMMETØ 21	01/09/1996-
021	35B9740	FLUE REAR	01/09/1996-
022	33D0590	"COCK 3/8""	01/09/1996-
023	35V1890	"U" CROSS MEMBER	01/09/1996-
024	33Q0140	"T" JOINT	01/09/1996-
025	35V1950	COCKS SUPPORT	01/09/1996-
026	36Q0080	BICONE Ø 10X6.5	01/09/1996-
027	36Q0140	BICONE NUT Ø 10	01/09/1996-
028	30Z8050	WATER PIPE ASS. Y	01/09/1996-
029	30Z8060	WATER PIPE ASS. Y	01/09/1996-
030	30Z8070	WATER PIPE ASS. Y	01/09/1996-
031	35V3270	STIFFENING	01/09/1996-
032	3150800	"O" RING Ø 20.22	01/09/1996-
033	35V3380	RISER	01/09/1996-
034	35X1910	PIPE	01/09/1996-
035	3150320	HEAT. ELEM. PROTECTION	01/09/1996-
036	35X1930	PIPE "U"	01/09/1996-
037	32D0810	JOINT 3/4"	01/09/1996-
038	32W3260	SWITCH	01/09/1996-
039	35V1970	SUPPORT	01/09/1996-
040	35B2161	LH PANEL	01/09/1996-
041	36G6680	LID HINGE	01/09/1996-
042	3150430	"O" RING Ø 56.52	01/09/1996-
043	35X1860	CABLE INLET PIPE	01/09/1996-
044	33M1090	DRAIN PIPE 2" G.	01/09/1996-
045	33M1110	PIPE 1/2" G.	01/09/1996-
046	32D0500	"C" BRACKET	01/09/1996-
047	32D0060	TERMINAL CLAMPING BOARD	01/09/1996-
048	32D0480	GROUND TERMINAL	01/09/1996-
049	32D0470	LIVE TERMINAL	01/09/1996-
050	32D0490	TERMINAL END COVER	01/09/1996-
051	35T9650	FLAT BRACKET	01/09/1996-

Pos	Code	Description	Info
052	35B2170	RH PANEL	01/09/1996-
053	33Q2582	WATER SPOUT	01/09/1996-
054	36D2800	LH HINGE SUPPORT	01/09/1996-
055	32X0130	GROMMET Ø29-Ø37	01/09/1996-
056	36G2650	HINGE SHAFT	01/09/1996-
057	35Q2490	THERMOSTAT GUARD	01/09/1996-
058	35G7380	COVER	01/09/1996-
059	36G1300	SPRING	01/09/1996-
060	36G2680	SPRING PIN	01/09/1996-
061	36D2790	RH HINGE SUPPORT	01/09/1996-
062	35U3760	STIFFENING	01/09/1996-
063	3106710	GREEN LIGHT 230V	23/05/2007-
064	3106720	RED LIGHT 230V	23/05/2007-
065	33Q2711	MANIFOLD	01/09/1996-
066	35V3260	HINGE SUPPORT	01/09/1996-
067	37Q7380	INSULATING PANEL	01/09/1996-
068	33Q2701	"PLUG 3/4""	01/09/1996-
069	33G0170	VACUUM VALVE 3/4"	01/09/1996-
070	35G1510	FLAT BRACKET	01/09/1996-
071	35Q7680	INS. PANEL COVERING	01/09/1996-
072	37Q7610	INSULATING PANEL	01/09/1996-
073	33G0200	PRESS. RELEASE VALVE	01/09/1996-
074	32Z0060	PRESSURE GAUGE 0-1 BAR	01/09/1996-
075	33G0040	GAUGE SOCKET	01/09/1996-
076	33G0130	VERT. EXPANSION BOX	01/09/1996-
077	35V3680	HEATING ELEMENT GUARD	01/09/1996-
078	36D4000	ADJUSTABLE FOOT	01/09/1996-
079	35B4020	REAR PANEL	01/09/1996-
080	35Q1000	FLAT BRACKET	01/09/1996-
081	33Q0690	"SOCKET 1/2""	01/09/1996-
082	30T2571	FOOT HOUSING ASS. Y	01/09/1996-
083	32Z2710	SAFETY THERMOSTAT	01/09/1996-
084	37M0590	COVER RING Ø 57	01/09/1996-
085	3028010	"COCK 1/2""	01/09/1996-
086	111AA06	PIPE Ø 25 Ø 15	01/09/1996-
087	3140320	PIPE CLAMP	01/09/1996-
088	37Q3270	SWITCH COVER	01/09/1996-
089	3170290	KNOB SPRING	01/09/1996-
090	3150790	THERMOSTAT PROTECT.	01/09/1996-
091	32Q3610	ELECTRIC CABLE 31PIE	01/09/1996-