

# MOD: XF135

Зип Общепит

# EXPLODED VIEW DISEGNO ESPLOSO



vsezip.ru

+7(812)987-08-81

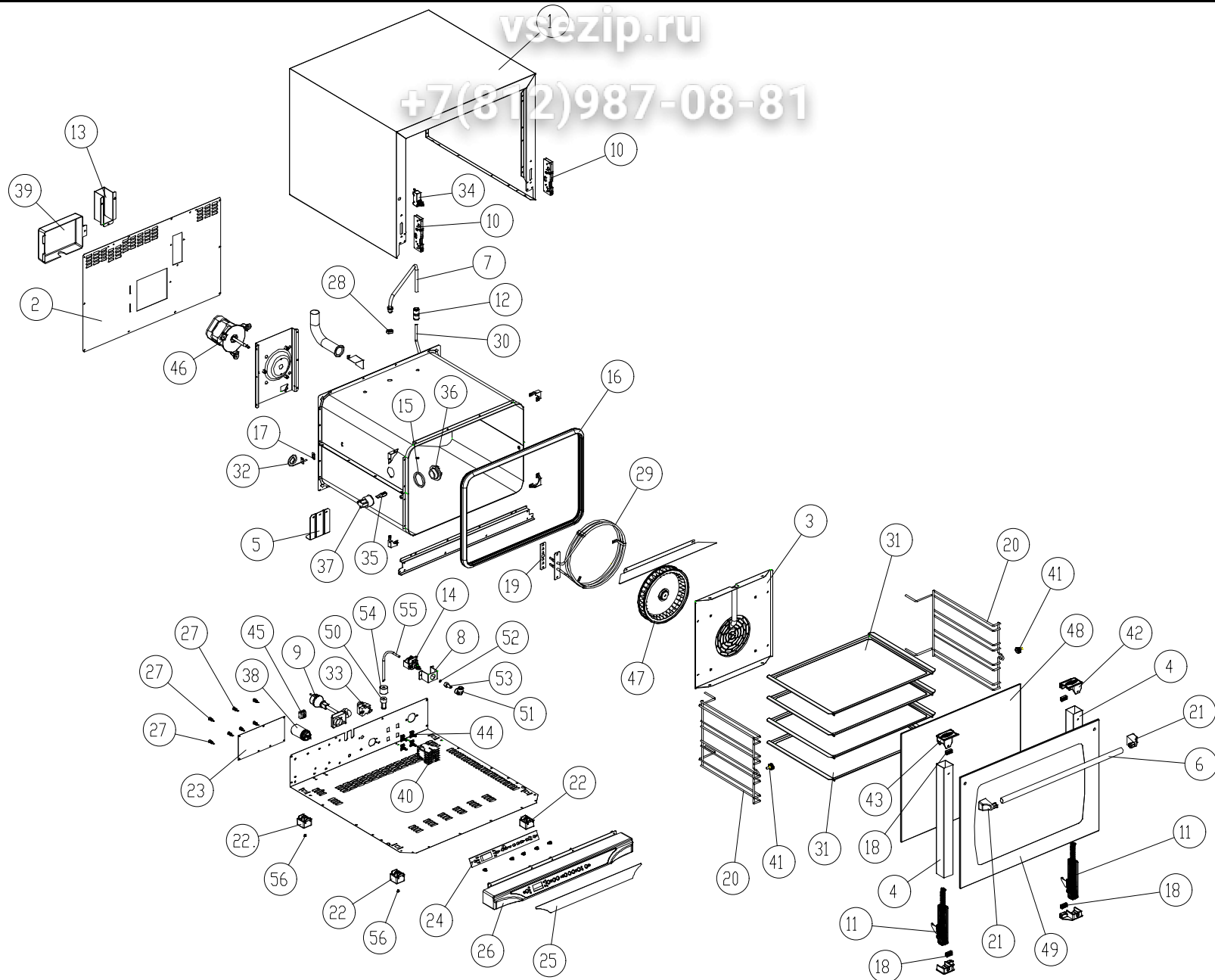

### LEGEND - LEGENDA

1	OD1275A2	56	VM1095A0
2	OF1085A1		
3	OG1110B0		
4	OH1425B0		
5	OH1455A0		
6	OH1925A0		
7	OH1990A0		
8	OH113		
9	CE116		
10	CR1000A0		
11	CR1015A0		
12	EL1055A0		
13	VM1065A0		
14	EL070		
15	GN1065A1		
16	GN110A2		
17	GN1120A0		
18	GN1130A0		
19	GN224		
20	GRL1010A1		
21	MG1015A0		
22	PD1000A0		
23	PE1175B0		
24	PE1195B1		
25	PE1250A1		
26	PE1310A0		
27	PE1345A1		
28	RC1170A0		
29	RS1130A0		
30	TB008		
31	TG305		
32	TR1015A0		
33	TR254		
34	VE086B		
35	VE1005A1		
36	VE1010A0		
37	VE1015A1		
38	VE1145A0		
39	VE1102A0		
40	VE1115A0		
41	VI1035A1		
42	VM1045B0		
43	VM1046B0		
44	VM1075A1		
45	VM250		
46	VN1035A0		
47	VN1050A2		
48	VT1060A0		
49	VT1061A2		
50	EL071		
51	EL1185A0		
52	GN207		
53	RC1180A2		
54	RC493		
55	TB009		

# MOD: XF135

## Зип Общепит

# EXPLODED VIEW DISEGNO ESPLOSO



### DESCRIZIONE CODICI

vsezip.ru

### DESCRIPTION

1	OD1275A2	MANTELLO INOX L.M. ARIANNA
2	OF1085A1	SCHIENA ZINCATA L.M. ARIANNA
3	OG1110B0	CARTER ARIA INOX L.M. ARIANNA
4	OH1425B0	
5	OH1455A0	STAFFA SOSTEGNO MUFFOLA L.M.
6	OH1925A0	TUBO MANIGLIA D-est=18 Sp=1 L=518 INOX L.M. 600
7	OH1990A0	TUBO ESTERNO UMIDITA + RACCORDO INOX SALDATO L.M.
8	OH113	SUPPORTO POMPA EL070
9	CE116	CAVO 3x1,5 H07RN-F MT1,5+K1/3+SCHUK
10	CR1000A0	ATTACCO CERNIERA PORTA FORNO RIBALTA L.M.
11	CR1015A0	CERNIERA PORTA FORNO RIBALTA L.M. ARIANNA
12	EL1055A0	RIDUZIONE J.G. DA D=10 A D=8 PM201008E
13	VM1065A0	CUFFIA COPRI CAMINO FUMI L.M.
14	EL070	POMPA NMEIC+ATT SUP POMPA M10 09.02.060/B
15	GN1065A1	GUARNIZIONE PORTALAMPADA DE=53.2 DI=44.2 SP=3.2 PTFE P
16	GN1110A2	GUARNIZIONE PORTA PROFLO 248 LINEMISS-XCH030
17	GN1120A0	GUARNIZIONE SONDA DI TEMPERATURA NTC
18	GN1130A0	GUARNIZIONE SUPPORTO VETRO L.M. L=23mm
19	GN224	GUARN.PTFE+CARB 100x22x0,8sp-c/fori 1999
20	GRL1010A1	GRIGLIA LATERALE DX/SX CROMATA 4TG 460X330 L.M. ARIANNA
21	MG1015A0	TERMINALE MANIGLIA L.M.
22	PD1000A0	PIEDINO QUADRO 35X35 H26 NYLON CARICATO VETRO GRIGIO
23	PE1175B0	SCHEDA POTENZA L.M. DYNAMIC 230V
24	PE1195B1	SCHEDA CONTROLLO LINE MISS SERIE 1 F.W. 2.02
25	PE1250A1	MASCHERINA SERIGRAFATA PE 180° L.M. 600 DYNAMIC
26	PE1310A0	CRUSCOTTO COMANDI IN PLASTICA L.M. 600
27	PE1345A1	DISTANZIALE NYLON INCASTRO MASCHIO-INCASTRO MASCHIO
28	RC1170A0	RACCORDO M14 H=7 CH=20 INOX
29	RS1130A0	RESISTENZA CIRCOLARE D=230 3 SPIRE H46 2900W 230V
30	TB008	TUBO PE 7,93x4,75 TRASPARENTE
31	TG305	TEGLIA 460x330 PIANA ALLUMINIO
32	TR1015A0	SONDA DI TEMP. NTC UL
33	TR254	TERM.SIC.BIP.335°C RIARMO MANUALE
34	VE086B	MICROINTERRUTTORE PORTA MF09 16A
35	VE1005A1	LAMPADA ALOGENA 40W 230V
36	VE1010A0	VETRO PORTALAMPADA VAPORE BOROSILICATO
37	VE1015A1	PORTA LAMPADA SERIE 2 PER LAMPADA ALOGENA
38	VE1145A0	CONDENSATORE 3,5 µf 450 Vac 50/60 Hz
39	VE1102A0	CUFFIA COPRI MOTORE IN PLASTICA L.M. CRI-STE-ARI
40	VE1115A0	MINICONTATTORE QUADRIPOLORE 20 A 230 V
41	VI1035A1	NOTTOLINO M6x12,5 CON TAGLIO OTT.CROM.FERMA GRIGIE X
42	VM1045B0	TAPPO SUP. DX COLONNINA PORTA VETRO INTERNO L.M.
43	VM1046B0	TAPPO SUP. SX COLONNINA PORTA VETRO INTERNO L.M.
44	VM1075A1	CLIP DI FISSAGGIO PER Teleruttori
45	VM250	MORSETT A PETTINE
46	VN1035A0	MOTORE SISME 230 Vac LINE MISS
47	VN1050A2	VENTOLA D=196 H=32 38 PALE INOX DADO M6
48	VT1060A0	VETRO INTERNO 515X414X4 BETFL L.M. ARIANNA
49	VT1061A2	VETRO ESTERNO SER. GIALLO 598X424X5 TFL L.M. ARIANNA
50	EL071	FILTRO 009A D=7,75mm
51	EL1185A0	RACCORDO A GOMITO J.GUEST Ø8 - Ø8
52	GN207	O-RING GOMMA NBR70/75SH R=4
53	RC1180A2	RIDUZIONE M10X1 FEMM-Ø8 INOX
54	RC493	AFFONDATE FILTRO POMPA UMIDIF.
55	TB009	TUBO POLIPROPILENE TRASP. 6x4mm

56	VM1095A0	TAPPO IN GOMMA NERO D=35 H=6,5
----	----------	--------------------------------

+7(812)987-08-81

1	OD1275A2	STAINLESS STEEL OUTER CASING L.M. ARIANNA
2	OF1085A1	ZINCED BACK PANEL L.M. ARIANNA
3	OG1110B0	
4	OH1425B0	
5	OH1455A0	L.M. MUFFLE SUPPORT
6	OH1925A0	STAINLESS STEEL TUBE HANDLES D-est=18 Sp=1 L=518 L.M. STEF-
7	OH1990A0	EXTERNAL WATER PIPE + WELDED STAINLESS STEEL CONNECTION
8	OH113	PUMP EL070 SUPPORT
9	CE116	EL.CABLE 3x1.5 H07RN-F MT1,5+K1/3+SCHUKO
10	CR1000A0	HINGE LATCH L.M.
11	CR1015A0	HINGE L.M. ARIANNA
12	EL1055A0	J.G. REDUCTION FROM D=10 TO D=8 PM201008E
13	VM1065A0	PLASTIC COVER FOR FUMES CHIMNEY L.M.
14	EL070	PUMP NMEIC+ATT SUP PUMP M10 09.02.060/B
15	GN1065A1	
16	GN1110A2	DOOR GASKET PROFILE 248 LINE MISS-XCH030
17	GN1120A0	TEMPERATURE PROBE NTC SEAL
18	GN1130A0	INT. GLASS SEAL L.M. L=22mm
19	GN224	PTFE+CARB 100x22x0,8sp-w/holes 1999 GASKET
20	GRL1010A1	RIGHT/LEFT LATERAL GRID CHROM.PLATED 4 TRAYS 460x330 L.M
21	MG1015A0	HANDLE END L.M.
22	PD1000A0	GREY SQUARE FOOT 35x35 H26 NYLON WITH GLASS
23	PE1175B0	POWER CARD L.M. DYNAMIC 230V
24	PE1195B1	LINE MISS CONTROL CARD SERIE 1 F.W. 2.02
25	PE1250A1	STICKER WITH SERIGRAPHY PE 180° L.M. 600 DYNAMIC
26	PE1310A0	PLASTIC CONTROL PANEL L.M. 600
27	PE1345A1	NYLON SPACER MALE-MALE H=14
28	RC1170A0	STAINLESS STEEL CONNECTION M14 H=7 CH=20
29	RS1130A0	CIRC. HEAT ELEMENT D=230 3 TURNS H46 2900W 230V
30	TB008	TRANSPARENT TUBE PE 7,93x4,75
31	TG305	TRAY 460x330 FLAT ALUMINIUM
32	TR1015A0	TEMPERATURE PROBE NTC UL
33	TR254	SECURITY THERMOSTAT BIP. 335°C
34	VE086B	DOOR MICROSWITCH MF09 16A
35	VE1005A1	HALOGEN LAMP 40W
36	VE1010A0	BOROSILICATE LIGHT BULB GLASS COVER
37	VE1015A1	LAMP HOLDER SERIE 2 FOR HALOGEN LAMP
38	VE1145A0	CONDENSER 3.5 µf 450 Vac 50/60 Hz
39	VE1102A0	PLASTIC COVER FOR MOTOR L.M. CRI-STE-ARI
40	VE1115A0	MINICONTACTOR WITH 4 POLES 20 A 230 V
41	VI1035A1	CHROMIUM PLATED BRASS NUT M6x12,5 TO STOP LATERAL SUP
42	VM1045B0	RIGHT UPPER LID FOR COLUMN FOR INTERNAL GLASS L.M.
43	VM1046B0	LEFT UPPER LID FOR COLUMN FOR INTERNAL GLASS L.M.
44	VM1075A1	PLASTIC CLIP TO FIX CONTACTORS
45	VM250	"COMB" TERMINAL BOARD
46	VN1035A0	MOTOR 230 Vac LINE MISS
47	VN1050A2	FAN D=196 H=32 38 STAINLESS STEEL BLADES NUT M6
48	VT1060A0	INNER GLASS 515x414x4 BETFL L.M. ARIANNA
49	VT1061A2	
50	EL071	FILTER 009A D=7,75mm
51	EL1185A0	ELBOW CONNECTION J. GUEST Ø8 - Ø8
52	GN207	RUBBER O-RING NBR70/75SH R=4
53	RC1180A2	STAINLESS STEEL M10x1 FEMALE REDUCTION Ø8
54	RC493	BALLAST FOR FILTER FOR WATER PUMP
55	TB009	CLEAR POLYPROPYLENE PIPE 6x4mm

56	VM1095A0	BLACK RUBBER LID D=3.5 H=6.5
----	----------	------------------------------