

PF7604

- CONVECTION HUMIDITY OVEN 4 TRAYS 600X400 - GN 1/1

3-й этаж
vcezip.ru
(price of 10/0/2017)

+7(812)987-08-81

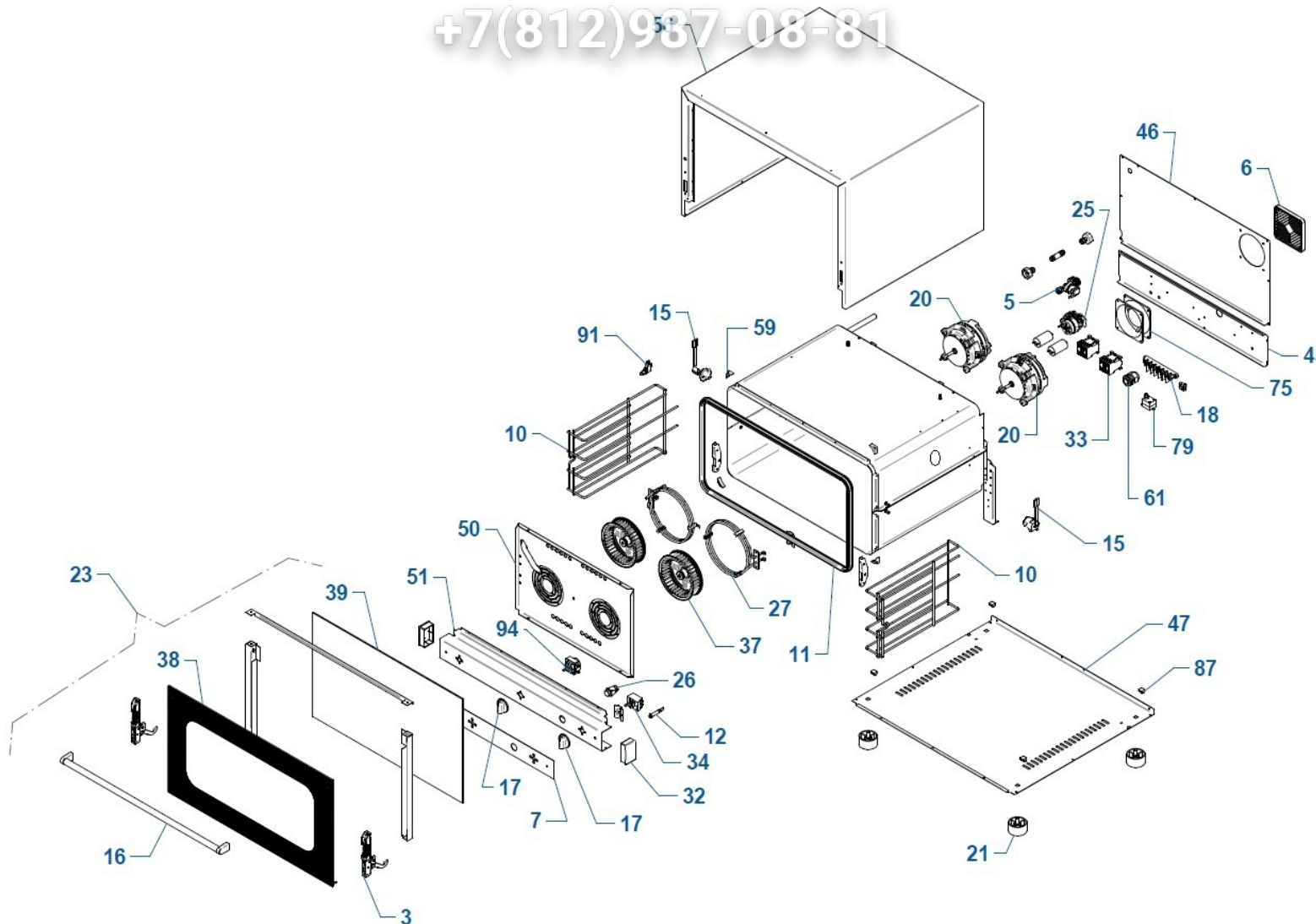

| N | ITEM | N | ITEM |
|----|----------|---|------|
| 3 | CER30011 | | |
| 3 | CER30012 | | |
| 5 | ELE30004 | | |
| 6 | FIL30004 | | |
| 7 | FRO30038 | | |
| 10 | GRI30008 | | |
| 11 | GUA30002 | | |
| 12 | IND30002 | | |
| 15 | LAM00003 | | |
| 16 | MAG30037 | | |
| 17 | MAN30014 | | |
| 18 | MOR30004 | | |
| 20 | MOT30006 | | |
| 21 | PIE30004 | | |
| 23 | POR00120 | | |
| 25 | PRG30005 | | |
| 26 | PUL30003 | | |
| 27 | RES30005 | | |
| 33 | TEL30007 | | |
| 34 | TER30003 | | |
| 37 | VEN30002 | | |
| 38 | VET00120 | | |
| 39 | VET30014 | | |
| 45 | SCN00052 | | |
| 46 | SCN00053 | | |
| 47 | FON30134 | | |
| 50 | DEF30083 | | |
| 51 | CRU60154 | | |
| 56 | CPR00043 | | |
| 59 | TAP30013 | | |
| 61 | PPC30001 | | |
| 75 | MOT30009 | | |
| 79 | TER30013 | | |
| 87 | DAD30010 | | |
| 91 | PUL30006 | | |
| 94 | PRG30001 | | |

PF7604

- CONVECTION HUMIDITY OVEN 4 TRAYS 600X400 - GN 1/1

PIRON
your professional cooking

| N | ITEM | DESCRIPTION (ENG) | N | ITEM | DESCRIPTION (ENG) |
|----|----------|---|---|------|-------------------|
| 3 | CER30011 | DOOR HINGE | | | |
| 3 | CER30012 | HINGE BRACKET | | | |
| 5 | ELE30004 | ELECTROVALVE 1 WAY | | | |
| 6 | FIL30004 | AIR FILTER | | | |
| 7 | FRO30038 | ***FRONTALINO POLIC. G800U PIRON (FRO30312) | | | |
| 10 | GRI30008 | LATERAL SUPPORT FOR P/G -800-804 | | | |
| 11 | GUA30002 | GASKET | | | |
| 12 | IND30002 | ORANGE LIGHT | | | |
| 15 | LAM00003 | COMPLETE LAMP | | | |
| 16 | MAG30037 | DOOR HANDLE | | | |
| 17 | MAN30014 | KNOB | | | |
| 18 | MOR30004 | TERMINAL | | | |
| 20 | MOT30006 | MOTOR | | | |
| 21 | PIE30004 | ADJUSTABLE FOOT | | | |
| 23 | POR00120 | COMPLETE DOOR | | | |
| 25 | PRG30005 | TIMER SWITCH FOR MOTOR REVERSE | | | |
| 26 | PUL30003 | HUMIDIFIER BUTTON | | | |
| 27 | RES30005 | HEATING ELEMENT 3000W Ø186 | | | |
| 33 | TEL30007 | CONTACTOR | | | |
| 34 | TER30003 | THERMOSTAT | | | |
| 37 | VEN30002 | FAN | | | |
| 38 | VET00120 | EXTERNAL GLASS | | | |
| 39 | VET30014 | INTERNAL GLASS 800 SERIES | | | |
| 45 | SCN00052 | LOWER/REAR OF OVEN | | | |
| 46 | SCN00053 | HIGHER/REAR OF OVEN | | | |
| 47 | FON30134 | LOWER SIDE FOR FEET SUPPORT | | | |
| 50 | DEF30083 | DEFLETTORE ARIA PF7604 | | | |
| 51 | CRU60154 | FRONTAL PANEL | | | |
| 56 | CPR00043 | EXTERNAL COVER | | | |
| 59 | TAP30013 | PLASTIC CORNER | | | |
| 61 | PPC30001 | CABLE GLAND M25x1,5 + NUT | | | |
| 75 | MOT30009 | COOLING FAN MOTOR | | | |
| 79 | TER30013 | SECURITY THERMOSTAT | | | |
| 87 | DAD30010 | NUT FOR FEET | | | |
| 91 | PUL30006 | DOOR MICRO SWITCH | | | |
| 94 | PRG30001 | TIMER 0-120 MINUTES | | | |