

FQE-41  
FQE-41L  
FQE-41L2

**SERIE 600**

Вип Общепит  
vsezip.ru

FRIGGITRICE ELETTRICA  
ELECTRIC HEATED FRYER  
FRITEUSE ELECTRIQUE  
ELEKTRO FRITEUSE  
FREIDORA ELECTRICA

FQE-41 10.401.941-20  
FQE-41L 10.401.943-20  
FQE-41L2 10.402.002-10

+7(812)987-08-81

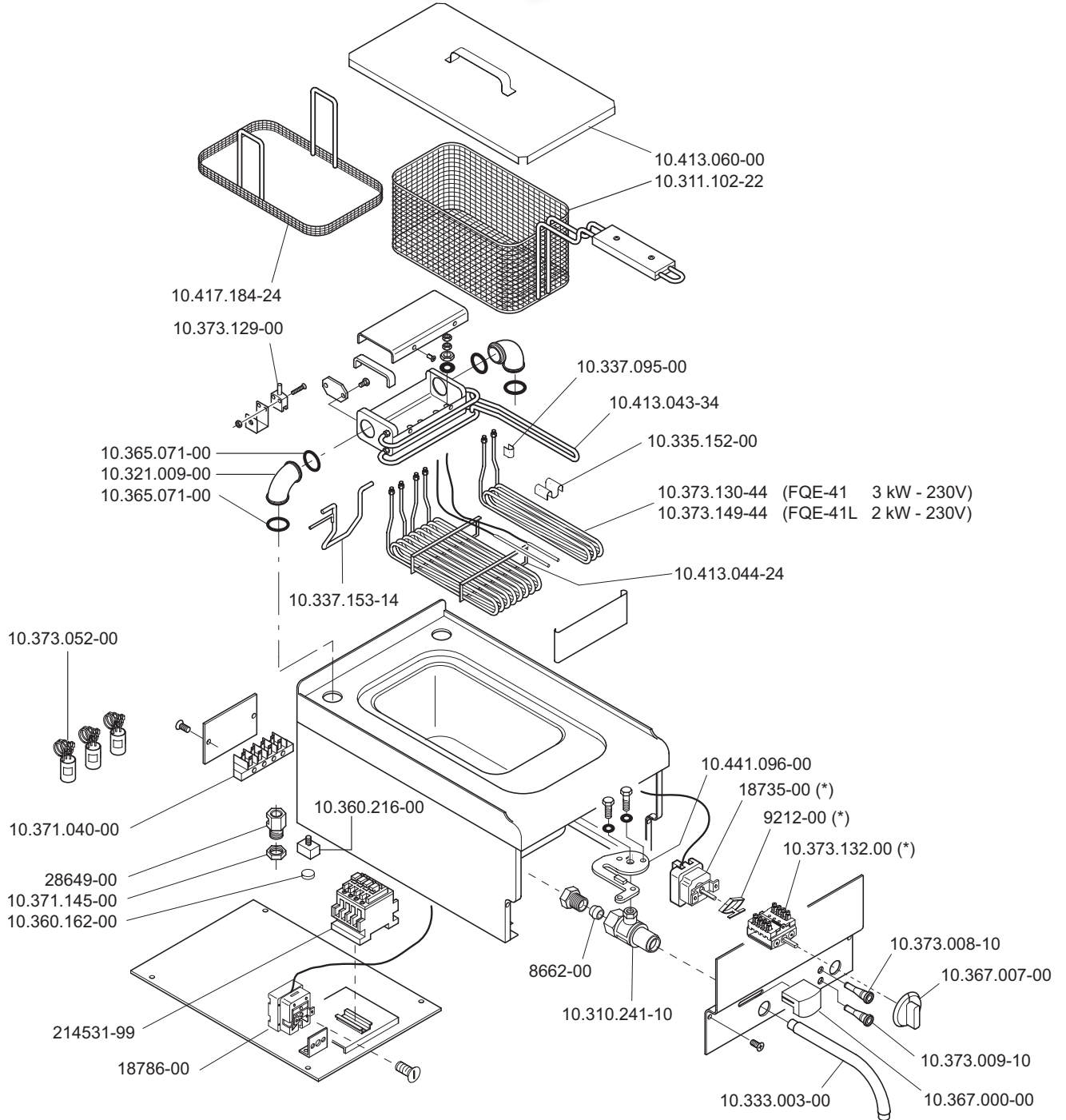

(\*) 18737-00 = 18735-00 + 9212-00 + 10.373.132.00

<p>MARENO INDUSTRIE ALI spa Mareno di Piave (TV)</p>	ELABORATO:	APPROVATO:	GRUPPO:	DENOMINAZIONE:		
	<i>Plinetti</i>		Serie CE 600 (Snack)	Impianto elettrico		
	DATA:	DATA:	PARTICOLARE:	REV. N.	DEL	DISEGNO N.
	10 Giu 96	10 Giu 96	Disegno esploso per ricambi	▼	▼	▼
SOST. DIS.	M01 - 9606.3.6.00.F4E		<b>M 0 1 - 9 6 0 6 . 3 . 6 . 0 0 . F 4 E</b>			

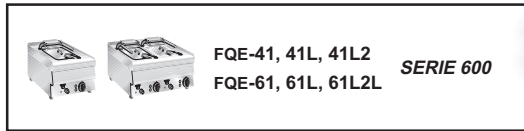

Вит Общепит  
vsezip.ru

FRIGGITRICE ELETTRICA  
ELECTRIC HEATED FRYER  
FRITEUSE ELECTRIQUE  
ELEKTRO FRITEUSE  
FREIDORA ELECTRICA

FQE-41 10.401.941-30  
FQE-41L 10.401.943-30  
FQE-41L2 10.402.002-20

FQE-61 10.401.942-30  
FQE-61L 10.401.944-30  
FQE-61L2 10.402.003-20

+7(812)987-08-81

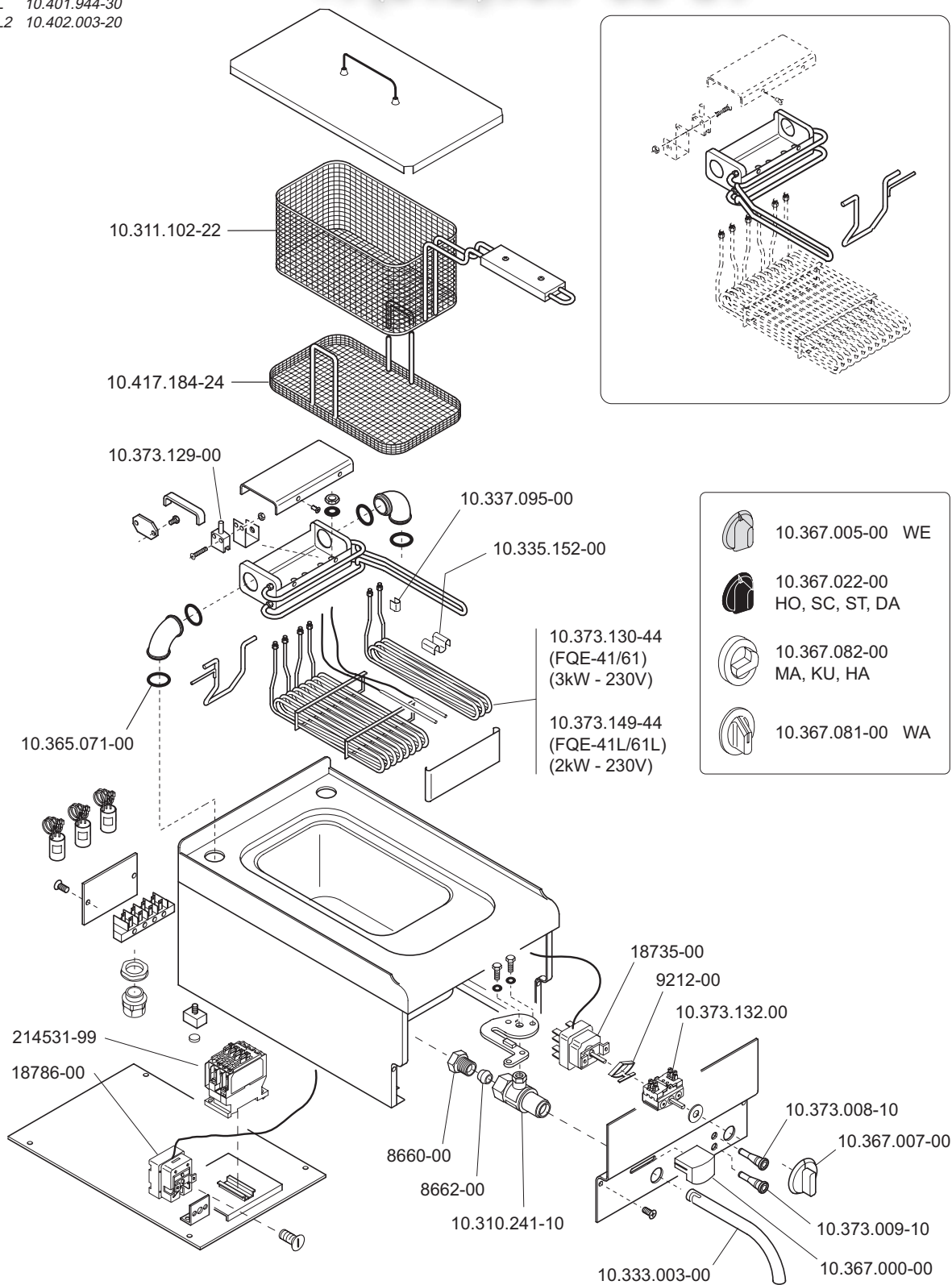

<p>MARENO INDUSTRIE ALI spa Mareno di Piave (TV)</p>	ELABORATO:	APPROVATO:	GRUPPO:	DENOMINAZIONE:		
	<i>Plinetti</i>		Serie CE 600 (snack)	Impianto elettrico e mobile		
	DATA:	DATA:	PARTICOLARE:	REV. N.	DEL	DISEGNO N.
	10 Nov 96	10 Nov 96	Disegno esploso per ricambi	▼	▼	▼
SOST. DIS.	Z00 - 9611.3.6.42.F41		Z00 - 9611.3.6.42.F41			



FQE-41, 41L, 41L2  
FQE-61, 61L, 61L2

SERIE 600

Вит Общепит



vsezip.ru

FRIGGITRICE ELETTRICA  
ELECTRIC HEATED FRYER  
FRITEUSE ELECTRIQUE  
ELEKTRO FRITEUSE  
FREIDORA ELECTRICA

FQE-41 10.401.941-30  
FQE-41L 10.401.943-30  
FQE-41L2 10.402.002-20

FQE-61 10.401.942-30  
FQE-61L 10.401.944-30  
FQE-61L2 10.402.003-20

+7(812)987-08-81

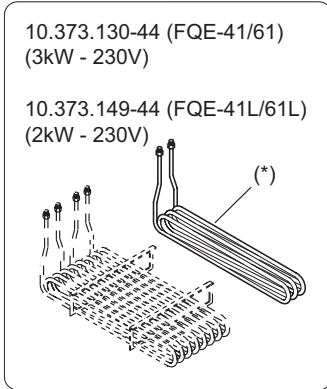

10.373.130-44 (FQE-41/61)  
(3kW - 230V)

10.373.149-44 (FQE-41L/61L)  
(2kW - 230V)

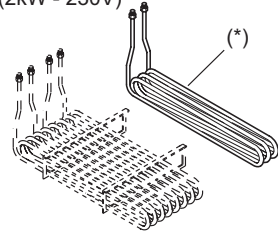

Fino a - Jusqu'à - Bis - Up to  
04-1998

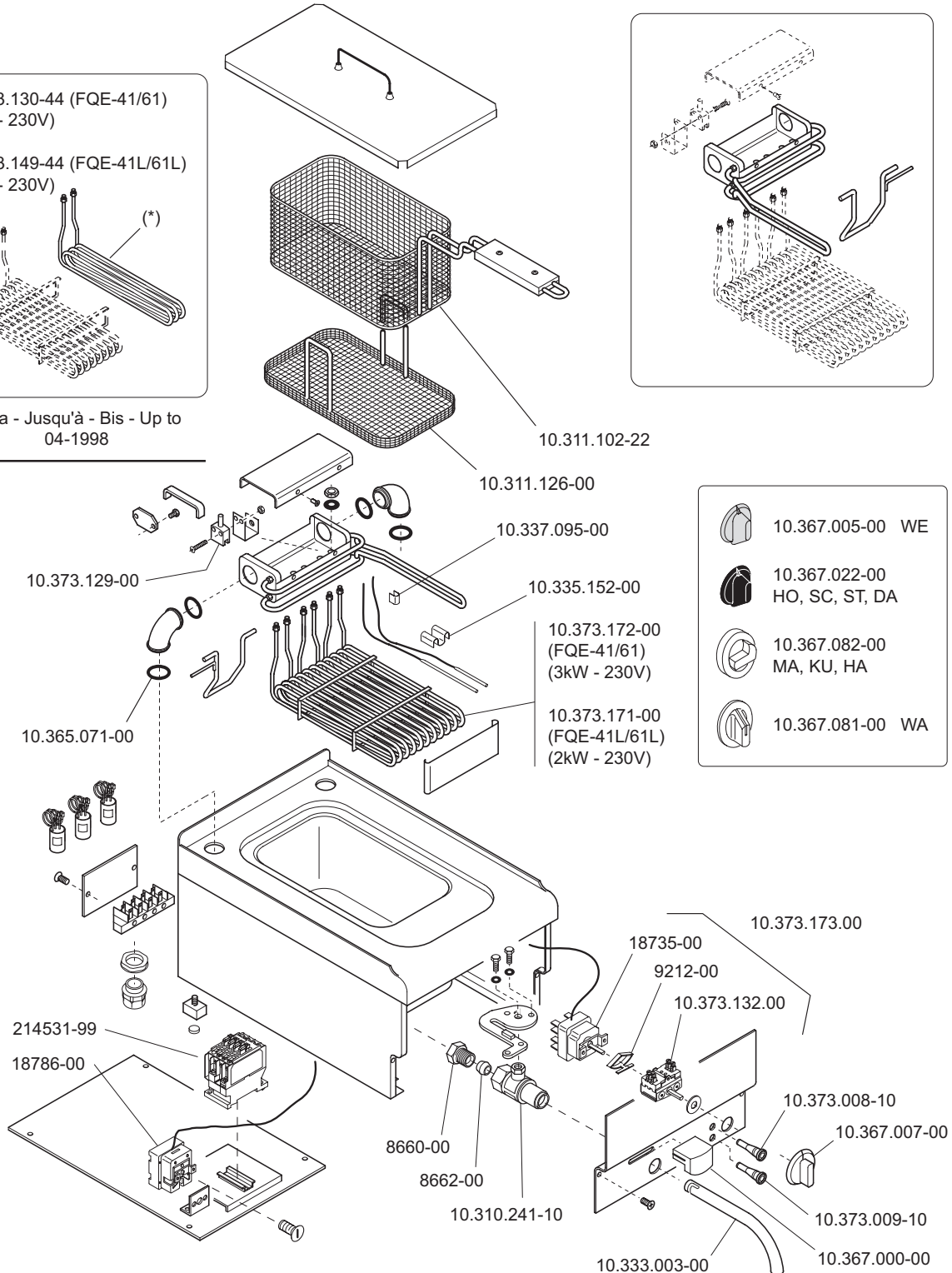
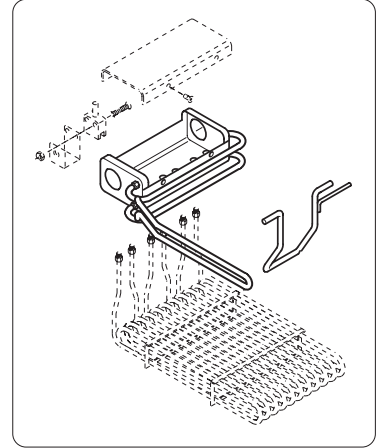

- 10.367.005-00 WE
- 10.367.022-00 HO, SC, ST, DA
- 10.367.082-00 MA, KU, HA
- 10.367.081-00 WA

 <b>MARENO INDUSTRIE ALI spa</b> Mareno di Piave (TV)	ELABORATO:	APPROVATO:	GRUPPO:	DENOMINAZIONE:		
	<i>Platt</i>		Serie CE 600 (snack)	Impianto elettrico e mobile		
	DATA:	DATA:	PARTICOLARE:	REV. N.	DEL	DISEGNO N.
	19 Nov 98	19 Nov 98	Disegno esploso per ricambi	▼	▼	▼
SOST. DIS.	Z00 - 9611.3.6.42.F41		Z 0 1 - 9 8 1 1 . 3 . 6 . 4 2 . F 4 1			

**OFQE-41, FQE 41** 1040194130  
**FQE 41L** 1040194330  
**FQE 41L2** 1040200220

**OFQE-61, FQE 61** 1040194230  
**FQE 61L** 1040194430  
**FQE 61L2** 1040200320

**FRIGGITRICI ELETTRICHE**  
**ELECTRIC HEATED FRYERS**  
**FRITEUSES ELECTRIQUES**  
**ELEKTROBEHEIZTE FRITUSEN**

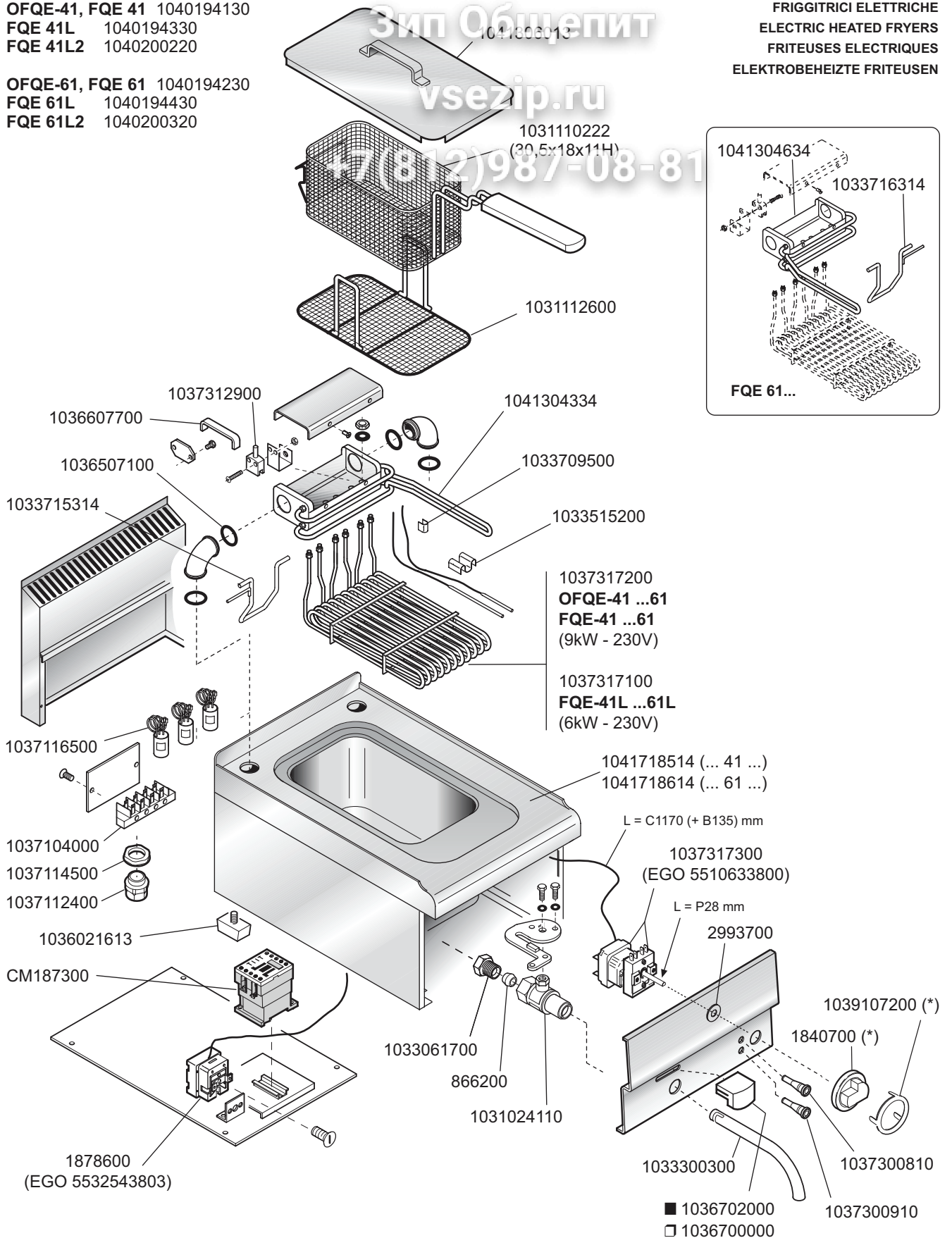

CR0502150 (Metos)    
 CR0502150 (Bartscher)    
 CM188600 (Franke)    
 1036700500 WE    
 1036702200 HO, SC, ST, DA    
 1036708200 MA (\*)    
 ■ Nero - Black - Schwarz - Noir    
 □ Verde - Green - Grün - Vert

 <b>MARENO INDUSTRIE ALI spa</b> Mareno di Piave (TV)	ELABORATO:	APPROVATO:	GRUPPO:	DENOMINAZIONE:		
	G.Z.		Serie 600 Snack	Impianto elettrico - Mobile		
	DATA:	DATA:	PARTICOLARE:	REV. N.	DEL	DISEGNO N.
	05 Dic 2000	05 Dic 2000	Disegno esploso per ricambi	Z02	0106	3.6.42.FQE
SOST. DIS.	Z01.9811.3.6.42.F41		CE			



OFQE-41, FQE 41 1040194130  
 FQE 41L 1040194330  
 FQE 41L2 1040200220

OFQE-61, FQE 61 1040194240  
 FQE 61L 1040194440  
 FQE 61L2 1040200330

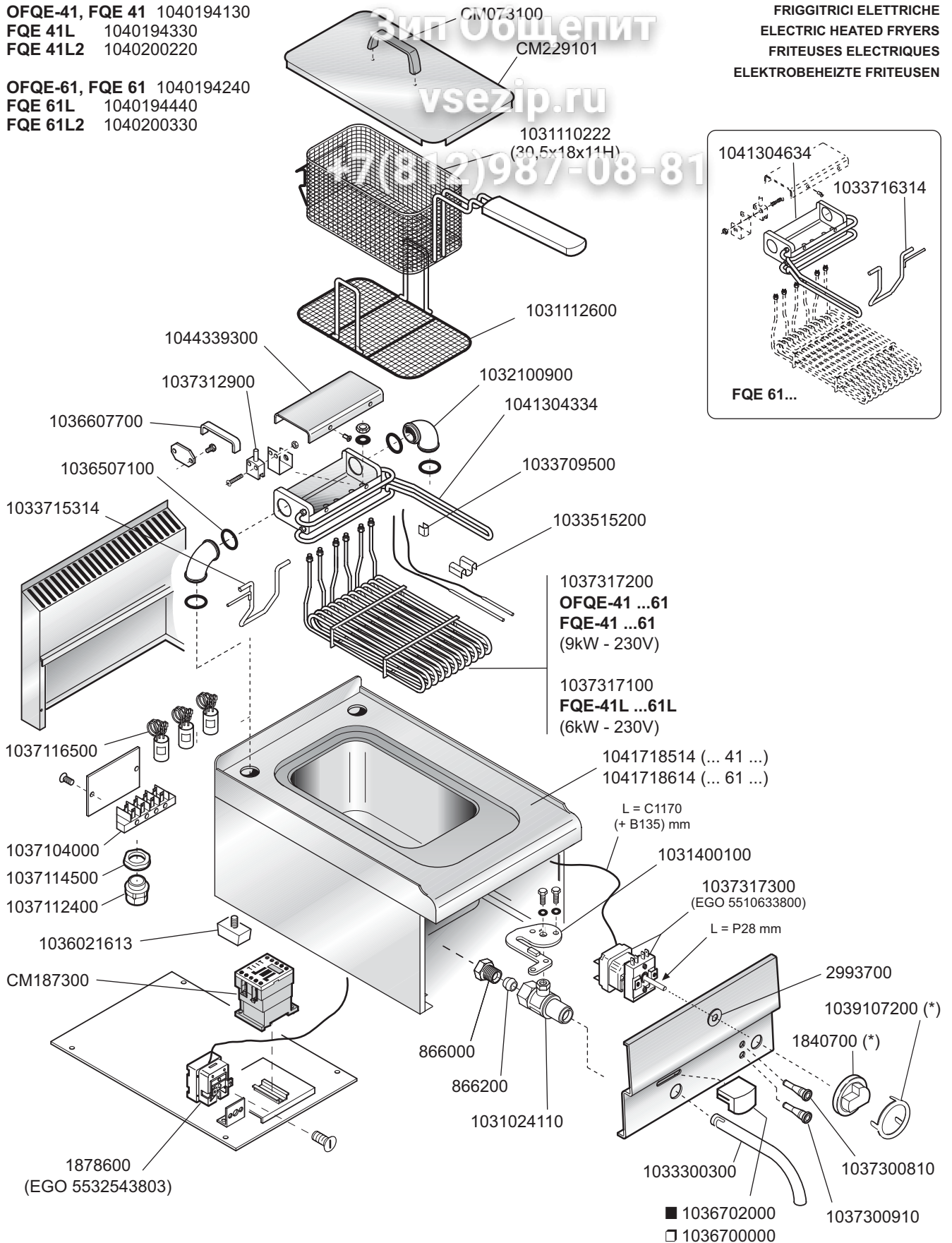
FRIGGITRICI ELETTRICHE  
 ELECTRIC HEATED FRYERS  
 FRITEUSES ELECTRIQUES  
 ELEKTROBEHEIZTE FRITUSEN



CR0502150 (Metos)    1036700500 WE    1036702200 HO, SC, ST, DA    1036708200 MA (\*)    ■ Nero - Black - Schwarz - Noir  
 CR0502150 (Bartscher)    1036700000                            □ Verde - Green - Grün - Vert  
 CM188600 (Franke)

 <b>MARENO INDUSTRIE ALI spa</b> Mareno di Piave (TV)	ELABORATO:	APPROVATO:	GRUPPO:	DENOMINAZIONE:		
			Serie 600 Snack	Impianto elettrico - Mobile		
	DATA:	DATA:	PARTICOLARE:	REV. N.	DEL	DISEGNO N.
	05 Dic 2000	05 Dic 2000	Disegno esploso per ricambi	Z02	0106	3.6.42.FQE
SOST. DIS.	Z01.9811.3.6.42.F41		