

Зип Общепит

vsezip.ru

DESPLIEGUE TECNICO 08-81

NOVIEMBRE 1991

**COCINA**  
**CUISINIERE**  
**RANGE**

MODELO: CG/HP-20

Hostelería y Lavandería Industrial

Grandes Cuisines et Buanderie

Catering and Laundry Equipment

Fagor Industrial, S. Coop. - Oñati

**FAGOR**



Зип Общепит

vsezip.ru

+7(812)987-08-81

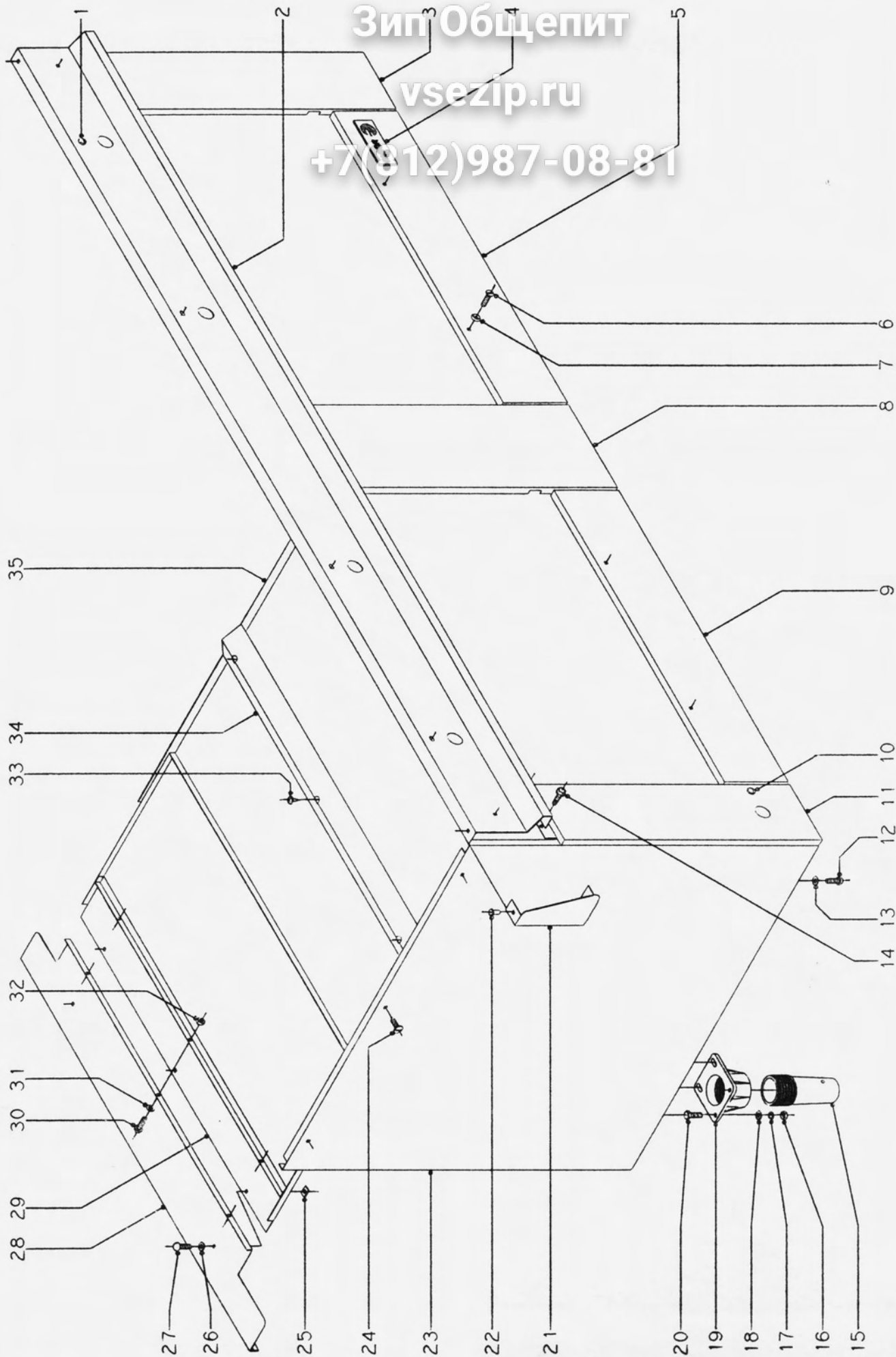

N plano  
B-449

Firma

Facho  
X-91

Aparato  
COCINA CG/HP-20

Lamina  
1

Fager Industrial S.Coop. **FAGOR**  
Onate

| N.  | CODIGO   | CONCEPTO : DESPIECE EXTERIOR<br>SUJET : PIECES EXTERIEURES<br>CONCEPT : EXTERNAL PARTS |                            |                              | LAMINA N. | HOJA N.   |
|-----|----------|--|----------------------------|------------------------------|-----------|-----------|
|     |          | APARATO - APPAREIL - APPLIANCE : COCINA DE HORNO PASANTE                               |                            |                              | VUE N. 1  | PAGE N. 1 |
|     |          | DENOMINACION   | DENOMINATION               | DESCRIPTION                  | CG/HP-20  | PAGE N.   |
| 1   | U-320307 | Indicador de mando   | Voyant disp. commande      | Control indicator            | 8         |           |
| s/n | Q-221026 | Clips sujeción indicador   | Fixation voyant            | Indicator fastening          | 8         |           |
| 2   | U-112816 | Panel portamandos  | Panneau de commande        | Control panel                | 2         |           |
| 3   | U-112806 | Panel frontal derecho  | Panneau frontal droit      | Right front panel            | 2         |           |
| 4   | U-262805 | Escudo FAGOR   | Ecusson FAGOR              | FAGOR shield                 | 2         |           |
| s/n | Q-221023 | Clips sujeción escudo  | Fixation ecusson           | Shield fastening             | 4         |           |
| 5   | 917600   | Panel inferior frontal dcho.   | Panneau inf.frontal droit  | Right lower front panel      | 2         |           |
| 6   | Q-071133 | Tornillo g.s. M.5x20   | Vis g.s. M.5x20            | Screw g.s. M.5x20            | 12        |           |
| 7   | Q-303107 | Arandela ovalillo nº 13  | Rondelle spéciale nº 13    | Special washer nº 13         | 12        |           |
| 8   | U-112808 | Panel frontal central  | Panneau frontal central    | Central front panel          | 2         |           |
| 9   | U-112805 | Panel inferior frontal izdo.   | Panneau inf.frontal gauche | Left lower front panel       | 2         |           |
| 10  | U-320306 | Indicador de termostato  | Voyant disp. thermostat    | Thermostat indicator         | 2         |           |
| s/n | Q-221026 | Clips sujeción indicador   | Fixation voyant            | Indicator fastening          | 2         |           |
| 11  | U-112815 | Panel frontal izquierdo  | Panneau frontal gauche     | Left front panel             | 2         |           |
| 12  | Q-011432 | Tornillo exagonal M.5x15   | Vis hexagonal M.5x15       | Hexagonal screw M.5x15       | 24        |           |
| 13  | Q-301309 | Arandela plana 16x6x1,2  | Rondelle plate 16x6x1,2    | Flat washer 16x6x1,2         | 24        |           |
| 14  | Q-151323 | Tornillo broca 4,8x16  | Vis 4,8x16                 | Screw 4,8x16                 | 32        |           |
| 15  | 910030   | Apoyo regulable  | Pied réglable              | Adjustable leg               | 6         |           |
| 16  | Q-161440 | Tuerca exagonal M.6  | Ecrou hexagonal M.6        | Hexagonal nut M.6            | 24        |           |
| 17  | Q-261040 | Arandela muelle A.6  | Rondelle ressort A.6       | Spring washer A.6            | 24        |           |
| 18  | Q-301309 | Arandela plana 16x6x1,2  | Rondelle plate 16x6x1,2    | Flat washer 16x6x1,2         | 24        |           |
| 19  | 910020   | Porta-apoyo  | Port-appui                 | Leg support bracket          | 6         |           |
| 20  | Q-011342 | Tornillo exagonal M.6x15   | Vis hexagonal M.6x15       | Hexagonal screw M.6x15       | 24        |           |
| 21  | U-112804 | Cantonera izquierda  | Cantonnère gauche          | Control panel curb bar-left  | 2         |           |
| s/n | U-112803 | Cantonera derecha  | Cantonnère droite          | Control panel curb bar-right | 2         |           |
| 22  | Q-419005 | Remache tubular c/bástago  | Rivet tubulaire avec tige  | Tubular rivet with stem      | 12        |           |
| 23  | U-112811 | Panel lateral  | Panneau latéral            | Side panel                   | 2         |           |
| 24  | Q-151105 | Tornillo amarre M.6x13   | Vis M.6x13                 | Screw M.6x13                 | 6         |           |
| 25  | Q-221303 | Tuerca rectangular M.5   | Ecrou M.5                  | Nut M.5                      | 12        |           |
| 26  | Q-231330 | Arandela plana A.5   | Rondelle plate A.5         | Flat washer A.5              | 12        |           |
| 27  | Q-021331 | Tornillo redondo M.5x10  | Vis rond M.5x10            | Screw M.5x10                 | 12        |           |



Зип Общепит

vsezip.ru

+7(812)987-08-81

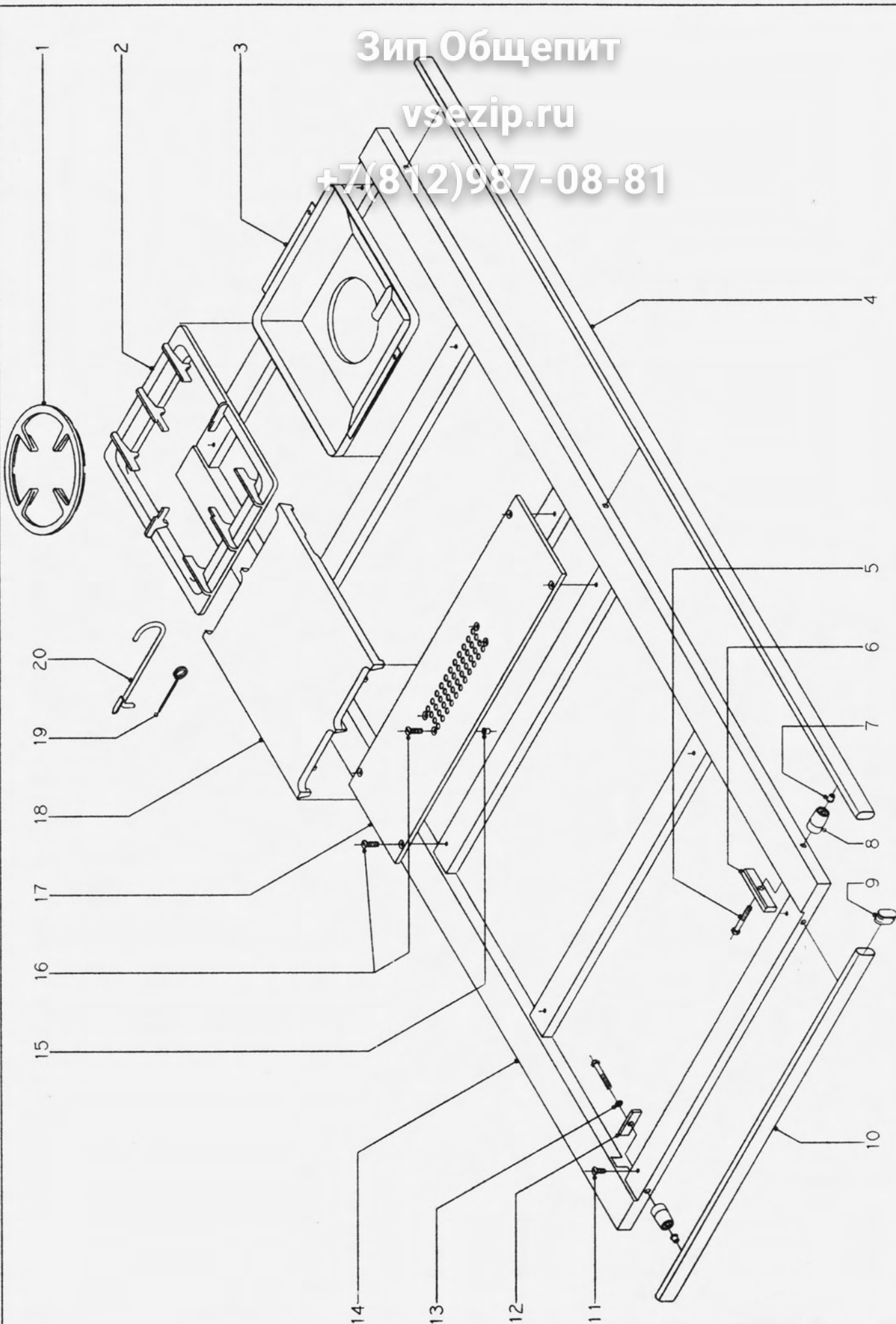

|         |           |        |                 |        |                                       |
|---------|-----------|--------|-----------------|--------|---------------------------------------|
| N plano | Filigrano | Foglio | Aparato         | Lamina | Fagor Industrial S.Coop. <b>FAGOR</b> |
| B-450   |           | X-91   | COCINA CG/HP-20 | 2      | Onote                                 |

# Зип Ощепит

vsezip.ru

+7(812)987-08-81

| N. | CODIGO   | CONCEPTO : DESPIECE MESA DE TRABAJO<br>SUJET : TABLE DE TRAVAIL<br>CONCEPT : WORK TABLE |                       |                         | LAMINA N. | HOJA N.   |
|----|----------|---|-----------------------|-------------------------|-----------|-----------|
|    |          | APARATO - APPAREIL - APPLIANCE : COCINA DE HORNO PASANTE                                |                       |                         | VUE N. 2  | PAGE N. 1 |
|    |          | DENOMINACION  | DENOMINATION          | DESCRIPTION             | CG/HP-20  | PAGE N.   |
| 1  | U-125419 | Parrilla de reducción   | Grille reduction      | Grate ring              | 1         |           |
| 2  | U-125410 | Parrilla  | Grille                | Grate                   | 4         |           |
| 3  | U-125405 | Vertedero   | Déversoir             | Spillplate              | 8         |           |
| 4  | U-115455 | Pasamanos frontal   | Rampe frontal         | Front handrail          | 2         |           |
| 5  | Q-011369 | Tornillo exagonal M.10x70   | Vis hexagonal M.10x70 | Hexagonal screw M.10x70 | 10        |           |
| 6  | U-110108 | Suplemento refuerzo frontal   | Suplement             | Supplement              | 10        |           |
| 7  | Q-411401 | Remache roscado M.10  | Rivet fileté M.10     | Threaded rivet M.10     | 6         |           |
| 8  | U-125409 | Soporte distanciador  | Support séparateur    | Separator               | 10        |           |
| 9  | U-055407 | Tapón de pasamanos  | Bouchon               | Side cap                | 8         |           |
| 10 | U-115456 | Pasamanos lateral   | Rampe latéral         | Handrail                | 2         |           |
| 11 | Q-041431 | Tornillo avellanado M.5x10  | Vis M.5x10            | Screw M.5x10            | 8         |           |
| 12 | U-115457 | Suplemento refuerzo lateral   | Suplement             | Supplement              | 4         |           |
| 13 | Q-261060 | Arandela muelle A.10  | Rondelle A.10         | Washer A.10             | 4         |           |
| 14 | U-115430 | Mesa de trabajo   | Table de travail      | Work table              | 1         |           |
| 15 | Q-221304 | Remache roscado M.5   | Rivet M.5             | Rivet M.5               | 4         |           |
| 16 | Q-041133 | Tornillo avellanado M.5x20  | Vis M.5x20            | Screw M.5x20            | 8         |           |
| 17 | U-115436 | Separador de placas   | Séparateur de plaques | Hot-plate separator     | 1         |           |
| 18 | U-125411 | Placa   | Plaque                | Hot-plate               | 4         |           |
| 19 | 0623500  | Aguja de limpieza   | Aiguille de nettoyage | Cleaning needle         | 1         |           |
| 20 | 0623600  | Palanca levantaplacas   | Levier pour plaques   | Lever for plates        | 1         |           |

Зип Общепит

vsezip.ru

+7(812)987-08-81

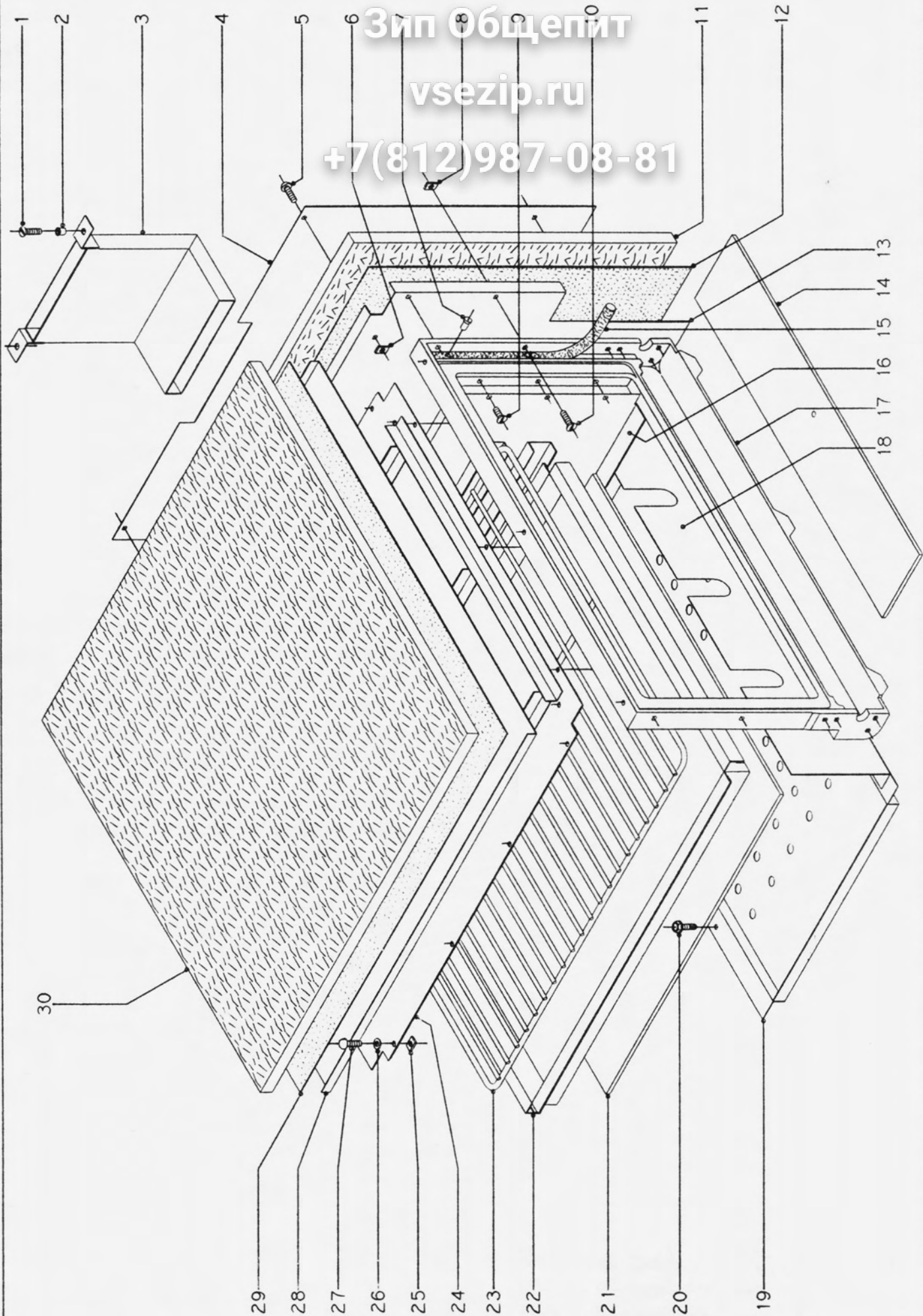

N plano  
B-451

Firma

Fecha  
X-91

Aparato

COCINA CG/HP-20

Lamina  
3

Fagor Industrial S. Coop. **FAGOR**

Oñate

# Зип Ощепит

vsezip.ru

+7(812)987-08-81

| N.  | CODIGO   | CONCEPTO : DESPIECE DE HORNO<br>SUJET : PIECES DU FOUR<br>CONCEPT : OVEN PARTS |                                |                                | LAMINA N. | HOJA N.   |
|-----|----------|--|--------------------------------|--------------------------------|-----------|-----------|
|     |          | APARATO - APPAREIL - APPLIANCE : COCINA DE HORNO PASANTE                       |                                |                                | VUE N. 3  | PAGE N. 1 |
|     |          | DENOMINACION   | DENOMINATION                   | DESCRIPTION                    | CG/HP-20  | PAGE N.   |
| 1   | Q-041133 | Tornillo avellanado M.5x20   | Vis à tête fraisée M.5x20      | Countersink screw M.5x20       | 4         |           |
| 2   | Q-221304 | Remache roscado M.5  | Rivet M.5                      | Rivet M.5                      | 4         |           |
| 3   | U-115650 | Chimenea completa  | Cheminée complète              | Complete chimney               | 2         |           |
| 4   | U-165601 | Sujeción vitrofib horno  | Fixation vitrofib four         | Oen insulator fastening        | 4         |           |
| 5   | Q-021435 | Tornillo redondo M.5x30  | Vis rond M.5x30                | Screw M.5x30                   | 16        |           |
| 6   | Q-221303 | Tuerca rectangular M.5   | Ecrou M.5                      | Nut M.5                        | 16        |           |
| 7   | Q-419005 | Remache tubular c/vástago  | Rivet tubulaire avec tige      | Tubular rivet wilh stem        | 40        |           |
| 8   | Q-221303 | Tuerca rectangular M.5   | Ecrou M.5                      | Nut M.5                        | 16        |           |
| 9   | Q-041142 | Tornillo avellanado M.6x15   | Vis à tête fraisée 6x15        | Countersink screw M.6x15       | 24        |           |
| 10  | Q-041133 | Tornillo avellanado M.5x20   | Vis à tête fraisée M.5x20      | Countersink screw M.5x20       | 16        |           |
| 11  |          | Aislante lateral (vitrofib)  | Isolement lateral (vitrofib)   | Side insulator (vitrofib)      | 4         |           |
| 12  |          | Aislante lateral (barlan)  | Isolement lateral (barlan)     | Side insulator (barlan)        | 4         |           |
| 13  | U-115647 | Costado central de horno   | Côté central de four           | Oven central side              | 2         |           |
| s/n | U-115646 | Costado exterior de horno  | Côté exterior de four          | Oven exterior side             | 2         |           |
| 14  | 9132300  | Cabeza de placa horno  | Tête plaque de four            | Plate                          | 2         |           |
| 15  | U-050508 | Junta cierre puerta  | Joint fermeture porte          | Junction cross section         | 4         |           |
| 16  | U-115600 | Panel lateral interior horno   | Panneau latéral int. four      | Oven int. side panel           | 4         |           |
| 17  | 9172300  | Marco de horno   | Marc de four                   | Oven farne                     | 4         |           |
| 18  | U-115654 | SopORTE quemador horno   | Support brûleur four           | Oven burner suppor             | 4         |           |
| 19  | U-115645 | Base de horno  | Basse de four                  | Oven base                      | 2         |           |
| 20  | Q-151323 | Tornillo broca 4,8x16  | Vis 4,8x16                     | Screw 4,8x16                   | 8         |           |
| 21  | 9132200  | Placa horno  | Plaque de four                 | Oven hot-plate                 | 2         |           |
| 22  | 9107100  | Bandeja de horno   | Plateau de four                | Oven tray                      | 2         |           |
| 23  | 9107900  | Parrilla de horno  | Grill de four                  | Oven grill                     | 2         |           |
| 24  | U-115640 | Techo de horno completo  | Plafond de four complet        | Complete oven roof             | 2         |           |
| 25  | Q-221303 | Tuerca rectangular M.5   | Ecrou M.5                      | Nut M.5                        | 14        |           |
| 26  | Q-301309 | Arandela plana 16x6x1,2  | Rondelle plate 16x6x1,2        | Flat washer 16x6x1,2           | 14        |           |
| 27  | Q-021435 | Tornillo redondo M.5x30  | Vis rond M.5x30                | Screw M.5x30                   | 14        |           |
| 28  | U-115648 | Chapa protección horno   | Tôle protection four           | Oven protection plate          | 2         |           |
| 29  |          | Aislante superior horno  | Isolement sup. four (barlan)   | Oven upper insulator (barlan)  | 2         |           |
| 30  |          | Aislante sup.horno (vitrofib)  | Isolement sup. four (vitrofib) | Oven upper insulator(vitrofib) | 4         |           |



Зип Общепит

vsezip.ru

+7(812)987-08-81

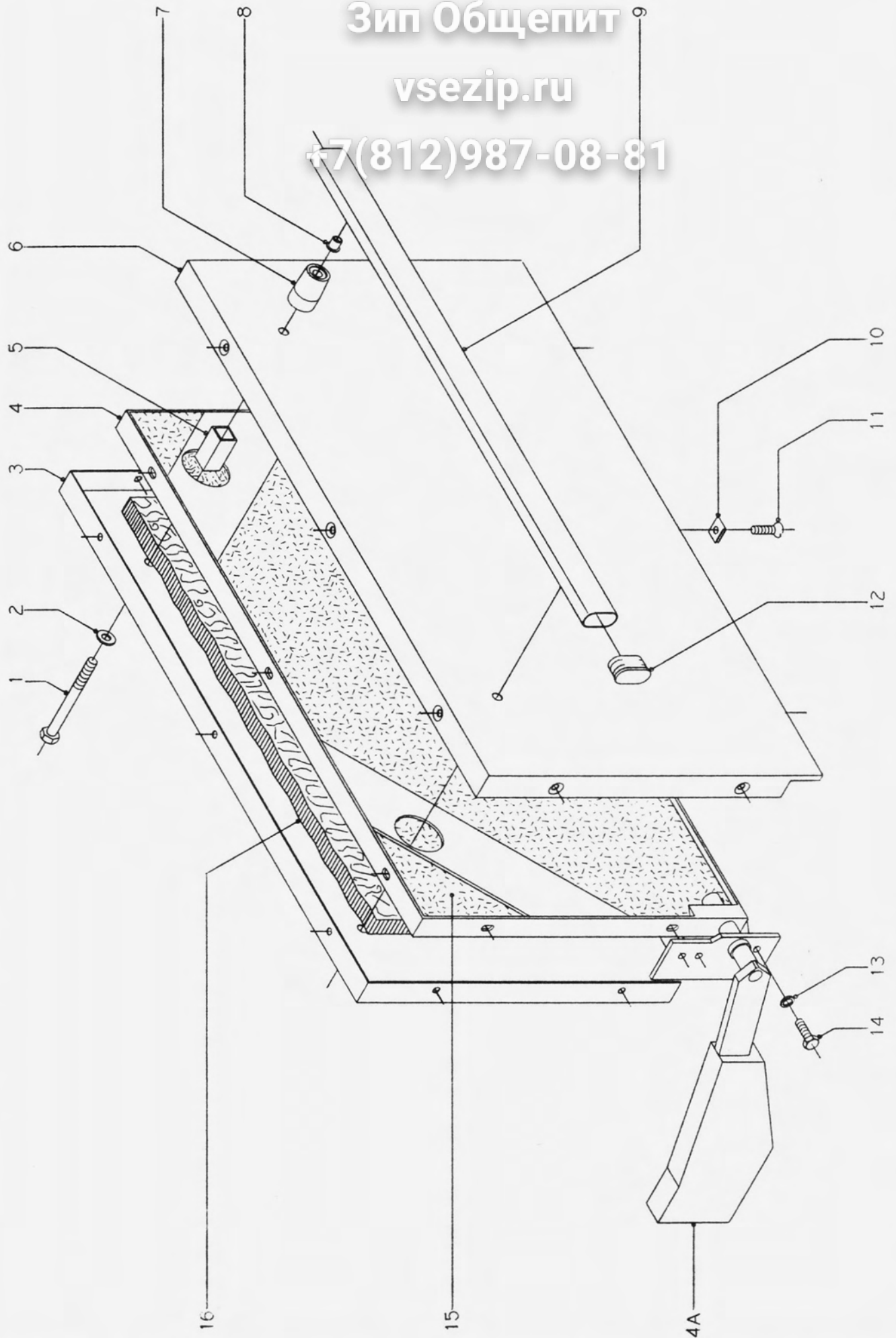

|         |       |       |                 |        |  |
|---------|-------|-------|-----------------|--------|--|
| N plano | Firma | Fecha | Aparato         | Lamina | Fagor Industrial S. Coop. <b>FAGOR</b> |
| B-452   |       | X-91  | COCINA CG/HP-20 | 4      | Onate                                  |

| N.  | CODIGO   | CONCEPTO : DESPIECE PUERTA DE HORNO<br>SUJET : PORTE DU FOUR<br>CONCEPT : OVEN DOOR |                             |                          | LAMINA N. | HOJA N.   |
|-----|----------|---|-----------------------------|--------------------------|-----------|-----------|
|     |          | APARATO - APPAREIL - APPLIANCE : COCINA DE HORNO PASANTE                            |                             |                          | VUE N. 4  | PAGE N. 1 |
|     |          | DENOMINACION  | DENOMINATION                | DESCRIPTION              | CG/HP-20  | PAGE N.   |
| 1   | Q-151319 | Tornillo exagonal M.10x100  | Vis hexagonal M.10x100      | Hexagonal screw M.10x100 | 8         |           |
| 2   | Q-231360 | Arandela plana A.10   | Rondelle plate A.10         | Flat washer A.10         | 8         |           |
| 3   | 9175600  | Contrapuerta  | Contre-porte                | Oven door liner          | 4         |           |
| 4   | 9175500  | Contrabastidor derecho  | Châsis porte droite         | Right frame              | 2         |           |
| s/n | U-050501 | Contrabastidor izquierdo  | Châsis porte gauche         | Left frame               | 2         |           |
| 4a  | 9179500  | Contrapeso completo   | Contrepoids                 | Counterweight            | 4         |           |
| s/n | 9421400  | Chapa porta-eje   | Plate suport d'axe          | Shaft support            | 8         |           |
| 5   | U-050504 | Distanciador 20x42  | Separateur 20x42            | Separator 20x42          | 8         |           |
| 6   | U-050500 | Puerta de horno   | Porte four                  | Oven door                | 4         |           |
| 7   | U-125409 | Distanciador  | Separateur                  | Separator                | 8         |           |
| 8   | Q-411401 | Remache roscado M.10  | Rivet fileté M.10           | Threaded rivet M.10      | 8         |           |
| 9   | U-050505 | Asa puerta horno  | Pognée de four              | Oven handle              | 4         |           |
| 10  | Q-221009 | Tuerca rápida M.5   | Ecrou M.5                   | Nut M.5                  | 56        |           |
| 11  | Q-071132 | Tornillo g.s. M.5x15  | Vis g.s. M.5x15             | Screw g.s. M.5x15        | 56        |           |
| 12  | U-055407 | Tapón   | Bouchon                     | Side cap                 | 8         |           |
| 13  | Q-261040 | Arandela muelle A.6   | Rondelle ressort A.6        | Spring washer A.6        | 32        |           |
| 14  | Q-113420 | Tornillo exagonal M.6x15  | Vis hexagonal M.6x15        | Hexagonal screw M.6x15   | 32        |           |
| 15  | U-050503 | Aislante puerta (barlan)  | Isolement de porte (barlan) | Door insulator (barlan)  | 8         |           |

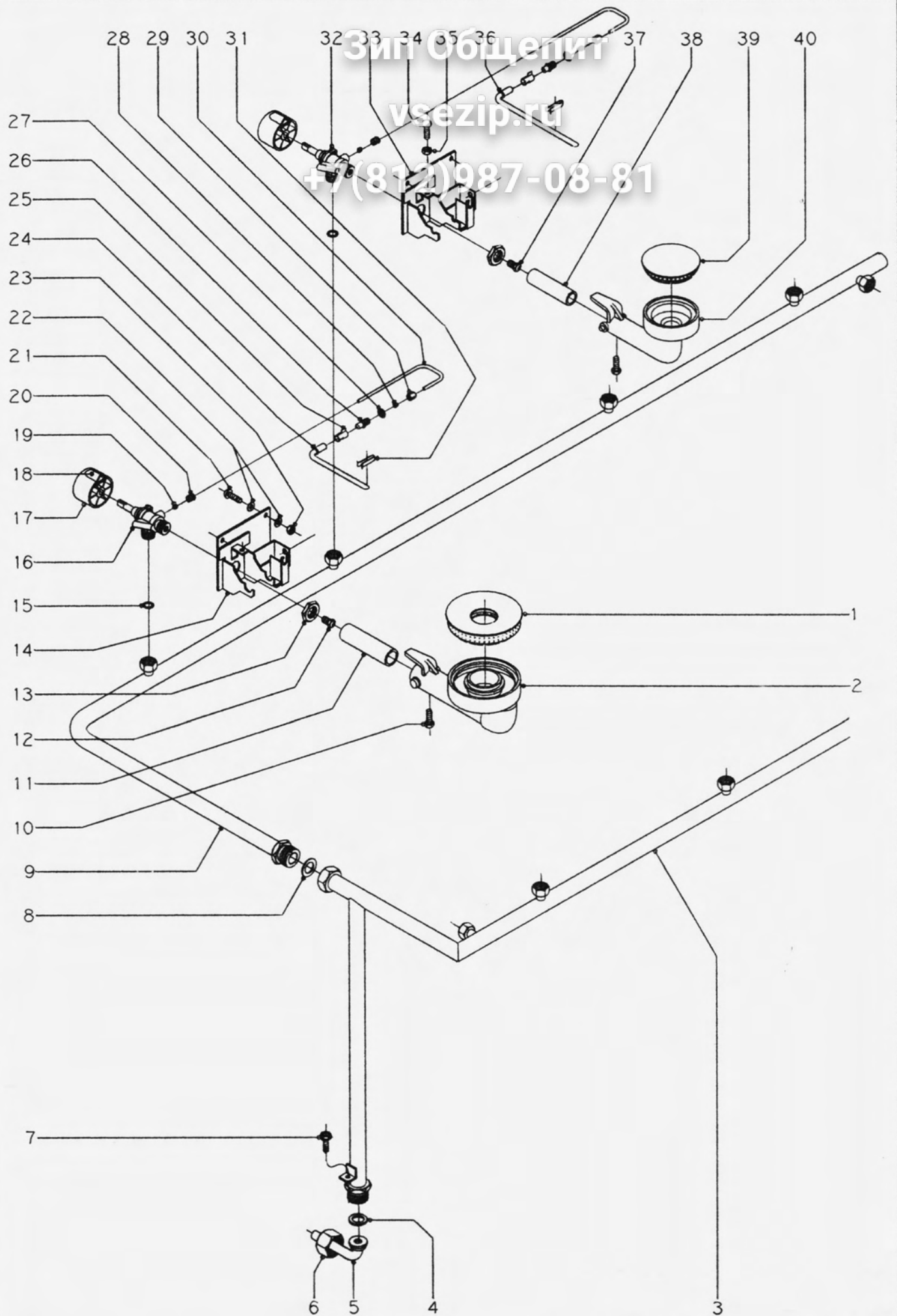

N plano  
B-453

Fabris  
*Ornato*

Modello  
X-91

Abbraccio

COCINA CG/HP-20

Lamina  
5

Fagor Industrial S.Coop. **FAGOR**

Disegnato

# Зип Ощепит

vsezip.ru

+7(812)987-08-81

| N. | CODIGO   | CONCEPTO : PIEZAS DE LA MESA DE TRABAJO<br>SUJET : PIECES DE LA TABLE DE TRAVAIL<br>CONCEPT : WORK TABLE PARTS |                               |                              | LAMINA N. | HOJA N.            |
|----|----------|--|-------------------------------|------------------------------|-----------|--------------------|
|    |          | APARATO - APPAREIL - APPLIANCE : COCINA DE HORNO PASANTE   |                               |                              | VUE N. 5  | PAGE N. 1          |
|    |          | DENOMINACION   | DENOMINATION                  | DESCRIPTION                  | CG/HP-20  | ILUSTR. N. PAGE N. |
| 1  | U-135702 | Quemador 8000 kcal.  | Brûleur 8000 kcal.            | Burner 8000 kcal.            | 2         |                    |
| 2  | U-135701 | Cuerpo mezclador 8000 kcal.  | Corps brûleur 8000 kcal.      | Body of burner 8000 kcal.    | 2         |                    |
| 3  | U-115010 | Tubo conducción anterior   | Conduit anterieur             | Front conductor              | 1         |                    |
| 4  | Q-306030 | Arandela junta 30x21x3   | Arandela joint 30x21x3        | Joint washer 30x21x3         | 1         |                    |
| 5  | 9212800  | Codo de entrada  | Coude entrée                  | Intake elbow                 | 1         |                    |
| 6  | Q-221013 | Tuerca cierre 1"   | Ecrou fermeture 1"            | Locking nut 1"               | 1         |                    |
| 7  | Q-151323 | Tornillo broca 4,8x16  | Vis 4,8x16                    | Screw 4,8x16                 | 1         |                    |
| 8  | Q-306030 | Arandela junta 30x21x3   | Arandela joint 30x21x3        | Joint washer 30x21x3         | 1         |                    |
| 9  | U-115020 | Tubo conducción posterior  | Conduit posterieur            | Rear conductor               | 1         |                    |
| 10 | Q-011432 | Tornillo exagonal M.5x15   | Vis hexagonal M.5x15          | Hexagonal screw M.5x15       | 8         |                    |
| 11 | U-135703 | Venturi quemador 8000  | Venturi brûleur 8000          | Burner 8000 venturi          | 2         |                    |
| 12 | 9105100  | Tobera 1,50 (8000/but.prop.)   | Buse 1,50 (8000/but.pro.)     | Nozzle 1,50 (8000/but.prop.) | 2         |                    |
| 13 | Q-221326 | Tuerca exagonal 1/2"   | Ecrou hexagonal 1/2"          | Hexagonal nut 1/2"           | 8         |                    |
| 14 | U-165036 | Conjunto soporte quemador  | Support brûleur               | Support burner               | 2         |                    |
| 15 | Q-300012 | Arandela junta 18x13x1,5   | Rondelle joint 18x13x1,5      | Joint washer 18x13x1,5       | 8         |                    |
| 16 | 1011900  | Grifo CAM-11400 (min. 0,90)  | Robinet CAM-11400 (min. 0.90) | Cock CAM-11400 (min. 0,90)   | 2         |                    |
| 17 | U-012104 | Botón de mando Ø 10  | Bouton de commande Ø 10       | Control button Ø 10          | 8         |                    |
| 18 | U-322113 | Indicador de botón   | Indicateur de commande        | Button indicator             | 8         |                    |
| 19 | U-135023 | Bicono Ø 5   | Bicone Ø 5                    | Double cone Ø 5              | 8         |                    |
| 20 | 0652600  | Manguito   | Raccord fixation              | Joint sleeve                 | 8         |                    |
| 21 | Q-021435 | Tornillo redondo M.5x30  | Vis rond M.5x30               | Screw M.5x30                 | 16        |                    |
| 22 | Q-301309 | Arandela plana 16x6x1,2  | Rondelle plate 16x6x1,2       | Flat washer 16x6x1,2         | 32        |                    |
| 23 | Q-161330 | Tuerca exagonal M.5  | Ecrou hexagonal M.5           | Hexagonal nut M.5            | 16        |                    |
| 24 | 1012000  | Piloto de 8000   | Veilleuse 8000                | Pilot 8000                   | 2         |                    |
| 25 | U-125025 | Regulador de aire  | Regulateur air                | Air regulator                | 8         |                    |
| 26 | U-122401 | Tobera piloto 0,20 (GLP)   | Buse 0,20 (veilleuse/GLP)     | Nozzle 0,20 (pilot/GLP)      | 8         |                    |
| 27 | Q-223025 | Tuerca exagonal M.10x1   | Ecrou hexagonal M.10x1        | Hexagonal nut M.10x1         | 8         |                    |
| 28 | U-135023 | Bicono Ø 5   | Bicone Ø 5                    | Double cone Ø 5              | 8         |                    |
| 29 | Q-221017 | Tuerca M.10x1  | Ecrou M.10x1                  | Nut M.10x1                   | 8         |                    |
| 30 | U-115065 | Tubo piloto Ø 5  | Conduite à veilleuse Ø 5      | Tube pilot Ø 5               | 8         |                    |
| 31 | U-125026 | Pinza resorte  | Pince ressort                 | Spring clamp                 | 8         |                    |



Зип Общежит

vsezip.ru

+7(812)987-08-81

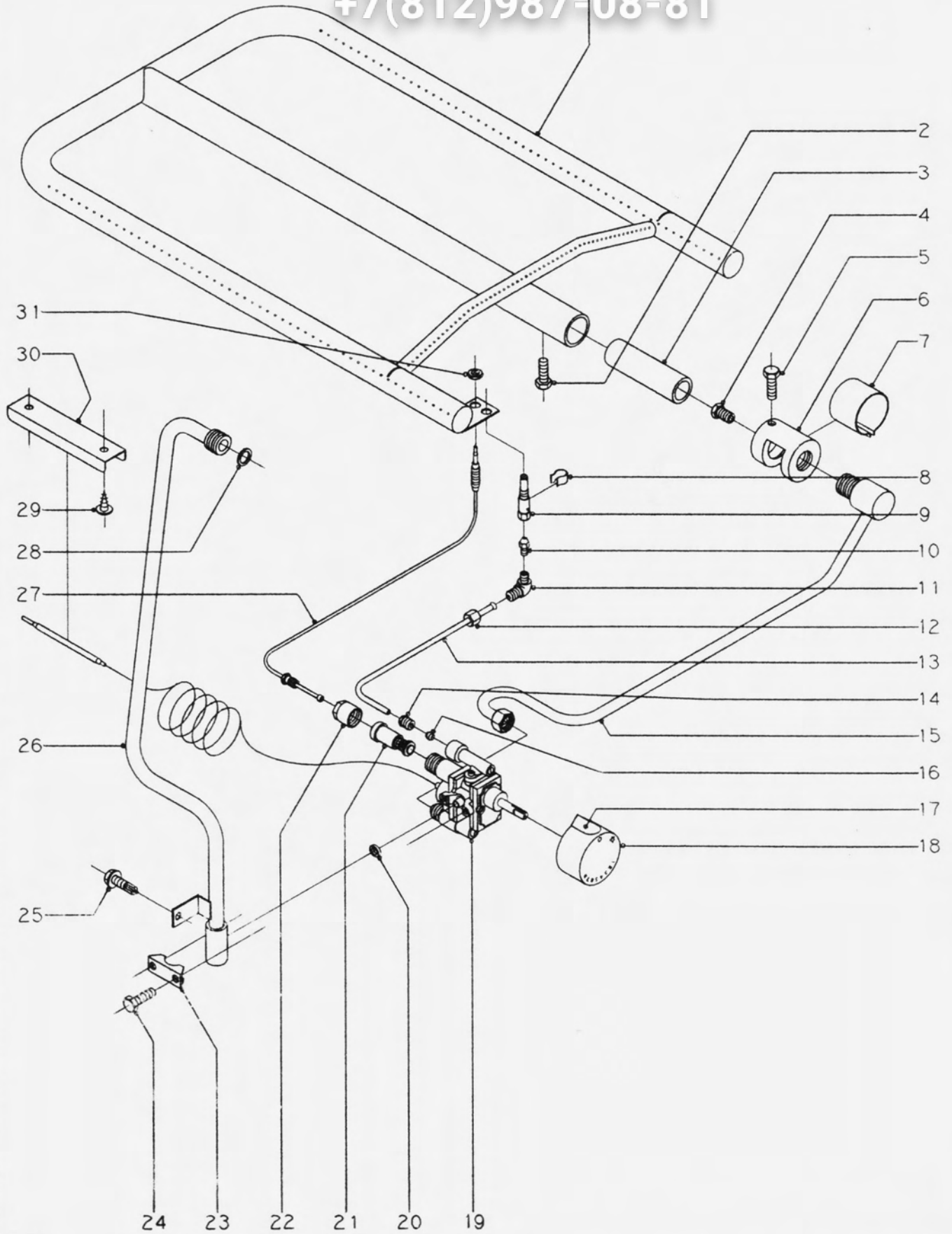

# Зип Общепит

vsezip.ru

+7(812)987-08-81

| N. | CODIGO   | CONCEPTO : PARTES FUNCIONALES DEL HORNO<br>SUJET : PIECES FONCTIONELLES DU FOUR<br>CONCEPT : OVEN GAS SYSTEM |                               |                                | LAMINA N. | HOJA N.   |
|----|----------|--|-------------------------------|--------------------------------|-----------|-----------|
|    |          | APARATO - APPAREIL - APPLIANCE : COCINA DE HORNO PASANTE <td>VUE N. 6</td> <td>PAGE N. 1</td>                |                               |                                | VUE N. 6  | PAGE N. 1 |
|    |          | DENOMINACION   | DENOMINATION                  | DESCRIPTION                    | CG/HP-20  |           |
| 1  | U-115701 | Quemador de horno  | Brûleur four                  | Oven burner                    | 2         |           |
| 2  | Q-011432 | Tornillo exagonal M.5x15   | Vis hexagonal M.5x15          | Hexagonal screw M.5x15         | 2         |           |
| 3  | U-135711 | Venturi  | Venturi                       | Venturi                        | 2         |           |
| 4  | U-112401 | Tobera 1,55 (horno/but.prop.)  | Buse 1,55 (four/but.prop.)    | Nozzle 1,55 (burner/but.prop.) | 2         |           |
| 5  | Q-011432 | Tornillo exagonal M.5x15   | Vis hexagonal M.5x15          | Hexagonal screw M.5x15         | 4         |           |
| 6  | U-135704 | Cámara de mezcla   | Melanger                      | Mixing chamber                 | 2         |           |
| 7  | 9473200  | Regulador de aire quemador   | Regulateur air four           | Oven air regulator             | 2         |           |
| 8  | 0614200  | Regulador de aire piloto   | Regulateur air veilleuse      | Air light regulator            | 2         |           |
| 9  | 0607600  | Venturi piloto   | Venturi veilleuse             | Pilot venturi                  | 2         |           |
| 10 | 0624103  | Tobera 0,25 (piloto h/but.pr)  | Buse 0,25 (veill.four/but.pr) | Nozzle 0,25 (burner pilot)     | 2         |           |
| 11 | 0607602  | Codo venturi piloto  | Porte-venturi veilleuse four  | Oven light venturi             | 2         |           |
| 12 | Q-221017 | Tuerca M.10x1  | Ecrou M.10x1                  | Nut M.10x1                     | 2         |           |
| 13 | 9173600  | Tubo piloto de horno   | Conduite à veilleuse four     | Line to oven pilot             | 2         |           |
| 14 | 0652600  | Manguito   | Raccord fixation              | Joint sleeve                   | 2         |           |
| 15 | U-115060 | Tubo conducción a horno  | Conduite à brûleur four       | Line to oven burner            | 2         |           |
| 16 | U-135023 | Bicono Ø 5   | Bicône Ø 5                    | Double cone Ø 5                | 2         |           |
| 17 | U-322113 | Indicador de botón   | Indicateur commande           | Control knob indicator         | 2         |           |
| 18 | U-322110 | Botón de mando Ø 8   | Bouton de commande Ø 8        | Control knob Ø 8               | 2         |           |
| 19 | U-112100 | Termostato (min. 0,85)   | Thermostat (min. 0,85)        | Thermostat (min. 0,85)         | 2         |           |
| 20 | Q-307034 | Arandela de estanqueidad   | Joint d'etancheité            | Water tight joint              | 2         |           |
| 21 | 9122901  | Grupo electromagnético   | Groupe electromagnetique      | Electromagnetic unit           | 2         |           |
| 22 | 9122902  | Tuerca grupo electromagnético  | Ecrou groupe electromagn.     | Electromagnetic unit nut       | 2         |           |
| 23 | Z-982018 | Brida amarre termostato  | Bride de thermostat           | Thermostat bridle              | 2         |           |
| 24 | Q-151417 | Tornillo exagonal M.5x0,8x22   | Vis hexagonal M.5x0,8x22      | Hexagonal screw M.5x0,8x22     | 4         |           |
| 25 | Q-151323 | Tornillo broca 4,8x16  | Vis 4,8x16                    | Screw 4,8x16                   | 2         |           |
| 26 | U-115050 | Tubo conducción a termostato   | Conduite à thermostat         | Line to thermostat             | 2         |           |
| 27 | 5113300  | Termopar L= 700 mm.  | Thermo-couple L= 700 mm.      | Termocouple L= 700 mm.         | 2         |           |
| 28 | Q-300012 | Arandela junta 18x13x1,5   | Rondelle joint 18x13x1,5      | Joint washer 18x13x1,5         | 2         |           |
| 29 | Q-151401 | Tornillo alomado   | Vis bombée                    | Conical screw                  | 4         |           |
| 30 | U-055610 | Conjunto fijación bulbo  | Ensemble fixation palpeur     | Bulb fastening                 | 2         |           |
| 31 | Q-223022 | Tuerca exagonal M.8x1  | Ecrou hexagonal M.8x1         | Hexagonal nut M.8x1            | 6         |           |

Зип Общепит

vsezip.ru

+7(812)987-08-81

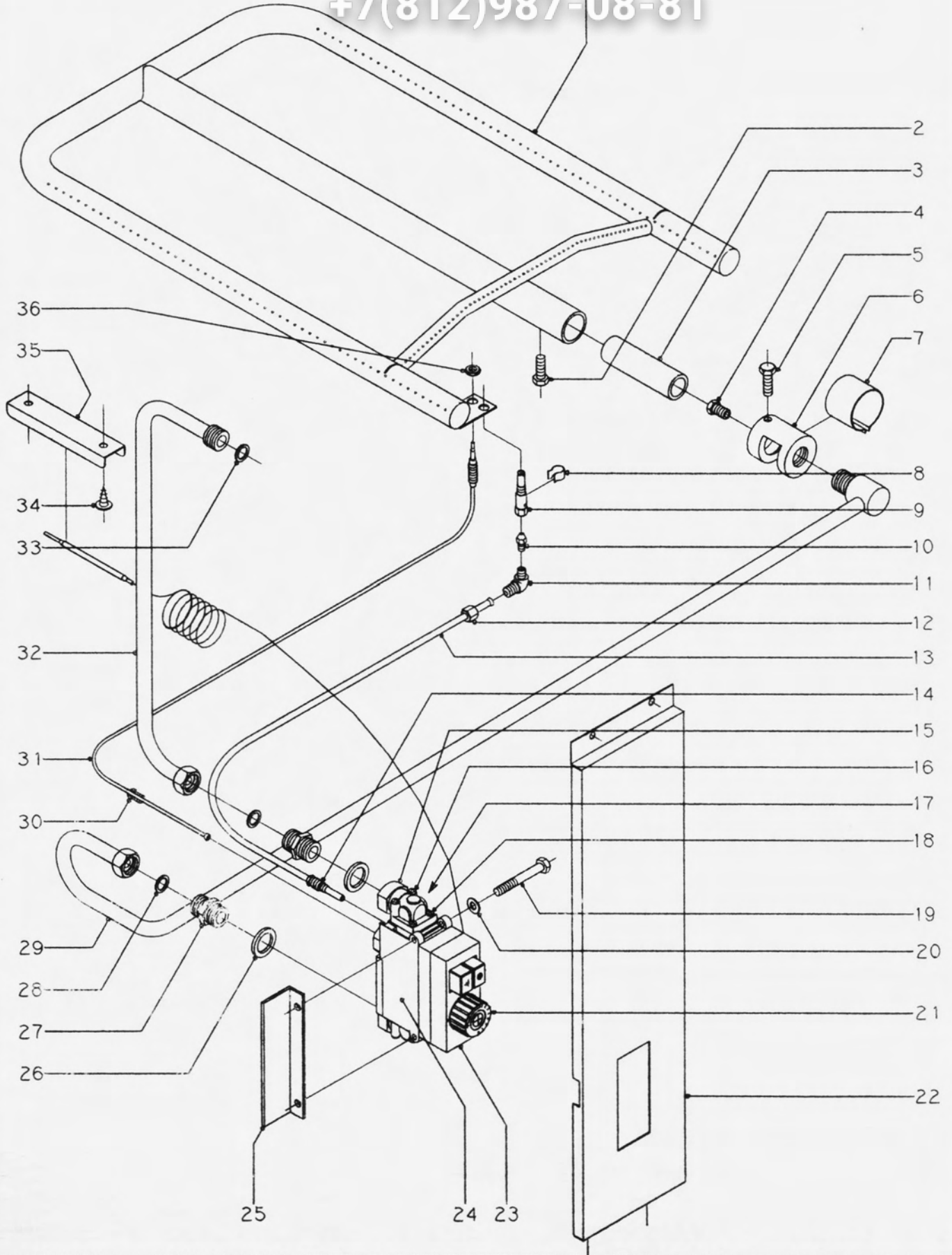

|         |       |        |                 |        |                         |
|---------|-------|--------|-----------------|--------|-------------------------|
| N plano | Firma | Facile | Aspirato        | Lamina | Fagor Industrial S.Coop |
| B-455   |       | X-91   | COCINA CG/HP-20 | 7      | <b>FAGOR</b>            |
|         |       |        |                 |        | Onote                   |



# Зип Ощепит

ysezip.ru

+7(812)987-08-81

| N.  | CODIGO   | CONCEPTO : PARTES FUNCIONALES DEL HORNO (VERSION SIT)<br>SUJET : PIECES FONCTIONELLES DU FOUR (VERSION SIT)<br>CONCEPT : OVEN GAS SYSTEM (SIT VERSION) |                               |                                | LAMINA N. | HOJA N.   |
|-----|----------|--|-------------------------------|--------------------------------|-----------|-----------|
|     |          | APARATO - APPAREIL - APPLIANCE : COCINA DE HORNO PASANTE   |                               |                                | VUE N. 7  | PAGE N. 1 |
|     |          | DENOMINACION   | DENOMINATION                  | DESCRIPTION                    | CG/HP-20  | PAGE N.   |
| 1   | U-115701 | Quemador de horno  | Brûleur four                  | Oven burner                    | 2         |           |
| 2   | Q-011432 | Tornillo exagonal M.5x15   | Vis hexagonal M.5x15          | Hexagonal screw M.5x15         | 2         |           |
| 3   | U-135711 | Venturi  | Venturi                       | Venturi                        | 2         |           |
| 4   | U-112401 | Tobera 1,55 (horno/but.prop.)  | Buse 1,55 (four/but.prop.)    | Nozzle 1,55 (burner/but.prop.) | 2         |           |
| 5   | Q-011432 | Tornillo exagonal M.5x15   | Vis hexagonal M.5x15          | Hexagonal screw M.5x15         | 4         |           |
| 6   | U-135704 | Cámara de mezcla   | Melanger                      | Mixing chamber                 | 2         |           |
| 7   | 9473200  | Regulador de aire quemador   | Regulateur air four           | Oven air regulator             | 2         |           |
| 8   | 0614200  | Regulador de aire piloto   | Regulateur air veilleuse      | Air light regulator            | 2         |           |
| 9   | 0607600  | Venturi piloto   | Venturi veilleuse             | Pilot venturi                  | 2         |           |
| 10  | 0624103  | Tobera 0,25 (piloto h/but.pr)  | Buse 0,25 (veill.four/but.pr) | Nozzle 0,25 (burner pilot)     | 2         |           |
| 11  | 0607602  | Codo venturi piloto  | Porte-venturi veilleuse four  | Oven light venturi             | 2         |           |
| 12  | Q-221406 | Tuerca M.10x1  | Ecrou M.10x1                  | Nut M.10x1                     | 2         |           |
| 13  | U-119205 | Tubo piloto horno  | Conduite à veilleuse four     | Line to oven pilot             | 2         |           |
| 14  | U-134323 | Racord c/bicono Ø 6  | Raccord-bicône Ø 6            | Raccord-bicône Ø 6             | 2         |           |
| 15  | U-134319 | Racord 1/2"  | Raccord 1/2"                  | Raccord 1/2"                   | 4         |           |
| 16  | U-134322 | Tornillo amarre racord   | Vis                           | Screw                          | 8         |           |
| 17  | U-134320 | Junta tórica   | Joint torique                 | O-ring seal                    | 4         |           |
| 18  | U-134321 | Tornillo amarre  | Vis                           | Screw                          | 8         |           |
| 19  | Q-011348 | Tornillo exagonal M.6x60   | Vis                           | Screw                          | 4         |           |
| 20  | Q-261040 | Arandela plana A.6   | Rondelle                      | Washer                         | 4         |           |
| 21  | U-134317 | Mando negro  | Commande                      | Knob                           | 2         |           |
| 22  | U-119200 | Panel frontal izquierdo  | Panneau frontal gauche        | Left front panel               | 2         |           |
| 23  | U-134318 | Cubierta   | Couvercle                     | Cover                          | 2         |           |
| 24  | U-134316 | Cuerpo de válvula  | Corps de soupape              | Valve main part                | 2         |           |
| s/n | U-134311 | Válvula SIT completa   | Soupape complete              | Complet valve                  | 2         |           |
| 25  | U-119206 | Soporte de válvula   | Support de soupape            | Valve support                  | 2         |           |
| 26  | Q-306030 | Arandela plana 30x21x3   | Rondelle plate 30x21x3        | Flat washer 30x21x3            | 4         |           |
| 27  | S-205023 | Manguito doble 1/2"  | Manchon double 1/2"           | Double racord 1/2"             | 4         |           |
| 28  | Q-306012 | Arandela junta 18x13x1,5   | Rondelle 18x13x1,5            | Washer 18x13x1,5               | 4         |           |
| 29  | U-119203 | Conducción a quemador  | Conduite a brûleur            | Line to burner                 | 2         |           |
| 30  | U-264301 | Racord   | Raccord                       | Racord                         | 2         |           |





# Зип Ощепит

vsezip.ru

+7(812)987-08-81

| N.  | CODIGO   | CONCEPTO :PIEZAS PARA LOS DIFERENTES GASES<br>SUJET : PIECES POUR LES DIVERS GAZ<br>CONCEPT : PARTS FOR DIFFERENT GASES |                           |                          | LAMINA N. | HOJA N. |
|-----|----------|---|---------------------------|--------------------------|-----------|---------|
|     |          | APARATO - APPAREIL - APPLIANCE : COCINA DE HORNO PASANTE  |                           |                          | VUE N.    | PAGE N. |
|     |          | DENOMINACION  | DENOMINATION              | DESCRIPTION              | CG/HP-20  |         |
|     |          | BUTANO PROPANO  | BUTANE PROPANE            | BUTANE PROPANE           |           |         |
| 12  | 9105100  | Tobera 1,50 (8000 kcal.)  | Gicleur 1,50 (8000 kcal.) | Nozzle 1,50 (8000 kcal.) | 2         |         |
| 26  | U-122401 | Tobera 0,20 (piloto)  | Gicleur 0,20 (veilleuse)  | Nozzle 0,20 (pilot)      | 8         |         |
| 37  | U-122407 | Tobera 1,05 (4000 kcal.)  | Gicleur 1,05 (4000 kcal.) | Nozzle 1,05 (4000 kcal.) | 6         |         |
| 4   | U-112401 | Tobera 1,55 (horno)   | Gicleur 1,55 (four)       | Nozzle 1,55 (oven)       | 2         |         |
| 10  | 0624103  | Tobera 0,25 (piloto horno)  | Gicleur 0,25 (veill.four) | Nozzle 0,25 (pilot oven) | 2         |         |
| s/n | U-136501 | Indicador de gas  | Indicateur de gaz         | Gas indicator            | 1         |         |
|     |          | GAS NATURAL   | GAZ NATUREL               | NATURAL GAS              |           |         |
| 12  | 1011600  | Tobera 2,25 (8000 kcal.)  | Gicleur 2,25 (8000 kcal.) | Nozzle 2,25 (8000 kcal.) | 2         |         |
| 26  | U-122406 | Tobera 0,35 (piloto)  | Gicleur 0,35 (veilleuse)  | Nozzle 0,35 (pilot)      | 8         |         |
| 37  | U-112401 | Tobera 1,55 (4000 kcal.)  | Gicleur 1,55 (4000 kcal.) | Nozzle 1,55 (4000 kcal.) | 6         |         |
| 4   | 1011600  | Tobera 2,25 (horno)   | Gicleur 2,25 (four)       | Nozzle 2,25 (oven)       | 2         |         |
| 10  | 0101300  | Tobera 0,35 (piloto horno)  | Gicleur 0,35 (veill.four) | Nozzle 0,35 (pilot oven) | 2         |         |
| s/n | U-134402 | Indicador de gas  | Indicateur de gaz         | Gas indicator            | 1         |         |
|     |          | GAS CIUDAD  | GAZ DE VILLE              | TOWN GAS                 |           |         |
| 12  | 9424600  | Tobera 4,23 (8000 kcal.)  | Gicleur 4,23 (8000 kcal.) | Nozzle 4,23 (8000 kcal.) | 2         |         |
| 26  | U-122404 | Tobera 0,55 (piloto)  | Gicleur 0,55 (veilleuse)  | Nozzle 0,55 (pilot)      | 8         |         |
| 37  | U-122408 | Tobera 2,95 (4000 kcal.)  | Gicleur 2,95 (4000 kcal.) | Nozzle 2,95 (4000 kcal.) | 6         |         |
| 4   | 9424600  | Tobera 4,23 (horno)   | Gicleur 4,23 (four)       | Nozzle 4,23 (oven)       | 2         |         |
| 10  | 0622801  | Tobera 0,85 (piloto horno)  | Gicleur 0,85 (veill.four) | Nozzle 0,85 (pilot oven) | 2         |         |
| s/n | U-134310 | Indicador de gas  | Indicateur de gaz         | Gas indicator            | 1         |         |

# Зип Общепит

vsezip.ru

## RELACION DE PIEZAS RECOMENDADAS

### COCINA CG/HP-20

| <u>REFERENCIA</u> | <u>DENOMINACION</u>                    |
|-------------------|--|
| U-115419          | Asa de bandeja derecha                 |
| U-115420          | Asa de bandeja izquierda               |
| U-115416          | Bandeja recoge grasas                  |
| 9100200           | Porta-apoyo                            |
| 9100300           | Pata regulable                         |
| U-125419          | Parrilla de reducción                  |
| U-125410          | Parrilla                               |
| U-125411          | Placa                                  |
| U-125405          | Vertedero                              |
| U-135702          | Difusor de quemador 8000 kcal.         |
| U-135701          | Cuerpo de quemador 8000 kcal.          |
| U-125715          | Difusor de quemador 4000 kcal.         |
| U-125716          | Cuerpo de quemador 4000 kcal.          |
| U-125021          | Piloto de 4000 kcal.                   |
| 1012000           | Piloto de 8000 kcal.                   |
| U-125025          | Regulador de aire de piloto            |
| 1011900           | Grifo CAM-11400 mín. 0,90 (8000 kcal.) |
| U-125420          | Grifo CAM-11400 mín. 0,55 (4000 kcal.) |
| U-012104          | Botón de mando                         |
| U-322113          | Indicador amarillo                     |
| U-112100          | Termostato                             |
| U-322110          | Botón de mando termostato              |
| 9473200           | Regulador de aire horno                |

### VERSION VALVULA MINISIT

|          |                           |
|----------|---------------------------|
| U-134316 | Cuerpo de válvula Minisit |
| U-134318 | Cubierta de válvula       |
| U-134317 | Botón de mando            |
| U-134311 | Válvula Minisit completa  |
| 5113300  | Termopar 700 mm.          |