

Зип Общепит

vsezip.ru

+7(812)987-08-81

PIN CANWASHER

ELECTRONICAL SWITCHES
LOWER AND UPPER WASHER

TYPE: 85S

Accessories
DVGW VALVE SYSTEM
BOOSTER PUMP

Spare parts Manual



INFORMAZIONI GENERALI

Questo catalogo serve per richiedere con esattezza le parti di ricambio

Nelle ordinazioni indicare:

- 1) il numero dei codici dei particolari seguito dalla descrizione e la quantità desiderata;
- 2) Il codice alfa-numerico presente nella seconda colonna della tabella ;

I disegni delle parti di ricambio sono solo indicativi e non rappresentano il pezzo in oggetto.

I dati contenuti in questo catalogo sono indicativi e possono essere soggetti a modifiche senza impegno di preavviso.

ALLGEMEINE INFORMATIONEN

Dieser Ersatzteilkatalog dient zur genauen Angabe der Teile bei Ersatzteilbestellungen.

Bei Ersatzbestellung ist folgendes anzugeben:

- 1) Die Bestellnummer der Ersatzteile mit der entsprechenden Beschreibung genaue Menge;
- 2) Der alpha-numerischer Code auf der zweiten Reihe in dein Schuld;

Die Zeichnungen der Ersatzteile sind nur als Hinweise gedacht und stellen nicht das betroffene Teil dar.

Bei den im Katalog angeführten Daten handelt es sich um Anhaltsdaten, die jederzeit, ohne Vorankündigung, geändert werden können.

GENERAL INFORMATION

The present spare parts order exactly the right spare parts

When ordering specify:

- 1) the part's code number followed by its description and quantity needed;
- 2) The alpha-numeric code is in the second column in the chart;

Spare parts drawings are general and do not represent the part.

The contents of this catalogue are general and can undergo changes without prior notice.

INFORMACIONES GENERALES

El presente catálogo sirve para pedir con exactitud las partes de repuesto

En los pedidos se debe indicar:

- 1) el número de código de la parte y a continuación la descripción cantidad deseada;
- 2) El código alfanumerico presente en la segnada columna de la tabla;

Los diseños de las partes de recambio son solo indicativos y no representan la pieza en cuestión.

Los datos contenidos en el presente catálogo son indicativos y pueden modificarse sin aviso previo.

INFORMATIONS GENERALES

Ce catalogue permet de commander correctement les pièces détachées

Les commandes doivent être passées en indiquant:

- 1) le numero de code des pièces détachées suivi de leur description quantité désirée;
- 2) le code alphanumérique dans la deuxième colonne du tableau;

Les plans des pièces détachées sont fournis seulement à titre indicatif et ne représentent pas la pièce concernée.

Les données de ce catalogue sont citées seulement à titre indicatif et peuvent être l'objet de modifications sans avis préalable.

**ESEMPIO
EXAMPLE
EXEMPLE
BEISPIEL**

| Rif. | Codici |
|--------------------|---------|
| MODULE:Particolari | |
| 10505 | 540903 |
| 10510 | 540908 |
| 10515 | 15065/A |
| 10520 | 540086 |
| 10525 | 540028 |

Note

Tutte le informazioni riportate si intendono aggiornate alla data di stampa. Il Produttore si riserva il diritto di apportare qualsiasi modifica richiesta dallo sviluppo evolutivo dei suddetti prodotti.

Per la sicurezza ,la garanzia, l'affidabilità ed il valore della lavastoviglie usa solo ricambi originali. **Per alcuni codici, sono richieste quantità minime d'ordine.**

Attenzione

Questo libretto è parte integrante della lavastoviglie e, in caso di passaggio di proprietà, deve essere consegnato al nuovo acquirente.

Remarque

Toutes les informations contenues dans ce manuel s'entendent mises à jour à la date d'impression. En raison du développement constant de ses produits, usine se réserve le droit d'apporter à tout instant les modifications qu'elle jugera utiles.

Pour la sécurité, la garantie, la fiabilité et la valeur de votre lavevaisselles n'utilisez que des pièces de rechange d'origine. **Pour quelque référence on demande un minimum de pièces par commande**

Attention

Ce manuel doit être considéré comme partie intégrante de la lavevaisselles, en cas de transfert de propriété, doit toujours être remis au nouveau propriétaire.

Note

The information contained herein is valid at the time of going to print. The Company reserves the right to make any changes required by the future development of the above-mentioned products.

For your safety, as well as to preserve the warranty reliability and worth of your dishwashers , use original spare parts only. **For some codes a minimum quantity for order is required.**

Warning

This manual forms an integral part of the dishwashers and - if a transfer of title occurs - must always be handed over to the new owner.

Hinweis

Die Der Hersteller behält sich das Recht vor, jegliche, durch eine Weiterentwicklung der genannten Produkte bedingte Änderungen vornehmen zu können.

Verwenden Sie für Ihre Sicherheit, die Garantie, die Zuverlässigkeit und den Wert Ihrer machine originale Ersatzteile. **Für bestimmte Code nummer werden mindesten bestellungen verlangt.**

Achtung

Diese Betriebsanleitung ist Bestandteile des machine und muss bei seinem Weiterverkauf dem neuen Besitzer ausgehändigt werden.







Code DW 999XXYYYY **CL/Part**

Model DESCRIPTION

S/N DW A 1015770 Type

400V 3N 50HZ 8A
3500W 500W



IPX3 16A 200-500 kPa

Pressione Dinamica alimentazione idrica
Pression dynamique arrivée d'eau
Dynamic pressure water supply
Dynamischer Druck asserreinlauf

Pressione dinamica vapore saturo
Pression dynamique vapore satueèè
Dymanischer Druck gesattigter Dampf
Pression Dinamica Vapor Saturado

TECHICAL SPECIFICATION



MADE IN ITALY

Temperatura massima acqua in ingresso 60°C
Temperature max eau a l'entre
Maximale Temperatur Wasseranschlü
Maximum Water temperature in-feeding

Model 

S/N 



Spare parts

Зип Общепит

vsezip.ru

+7(812)987-08-81

vsezip.ru

+7(812)987-08-81

1. Spare parts

| | |
|------------------------------------|----|
| Electric parts..... | 9 |
| General parts | 11 |
| Economizer components | 13 |
| Curtains group components | 15 |
| Electric control components..... | 17 |
| Solenoid valve group | 19 |
| DVGW valve | 21 |
| Entry shelf components | 23 |
| Exit shelf components | 25 |
| Pre-rinsing system components..... | 29 |
| Rinsing system components..... | 31 |
| Internal components | 33 |
| Chain components | 35 |
| Closing panels | 37 |
| Booster pump..... | 39 |
| Accessory..... | 41 |

vsezip.ru

+7(812)987-08-81

1.1 Voltage codes

| Volt | Voltage code |
|------|-------------------------|
| A | 3/N/PE~380-400V 50-60Hz |
| D | 3/PE~200-210V 50-60Hz |
| F | 2/PE~220-240V 50-60Hz |
| G | 3/N/PE~415V 50-60Hz |
| H | 3/PE~220-230V 50-60Hz |
| K | 3/PE~380-400V 50-60Hz |
| L | 3/PE~415V 50-60Hz |
| M | 3/PE~440V 60Hz |
| P | 1/N/PE~220-230V 50-60Hz |
| R | 2/PE~220-240V 50-60Hz |
| U | 1/N/PE~240V 50-60Hz |
| V | 3/PE~240V 50-60Hz |
| W | 1/N/PE~100-110V 50-60Hz |

1.2 Product codes

| Product code | Full name |
|-----------------|------------------------|
| Model codes | |
| e | ELECTRONICAL SWITCHES |
| uw | LOWER AND UPPER WASHER |
| Type codes | |
| 85S | 85S |
| Accessory codes | |
| dvgw | DVGW VALVE SYSTEM |
| bp | BOOSTER PUMP |

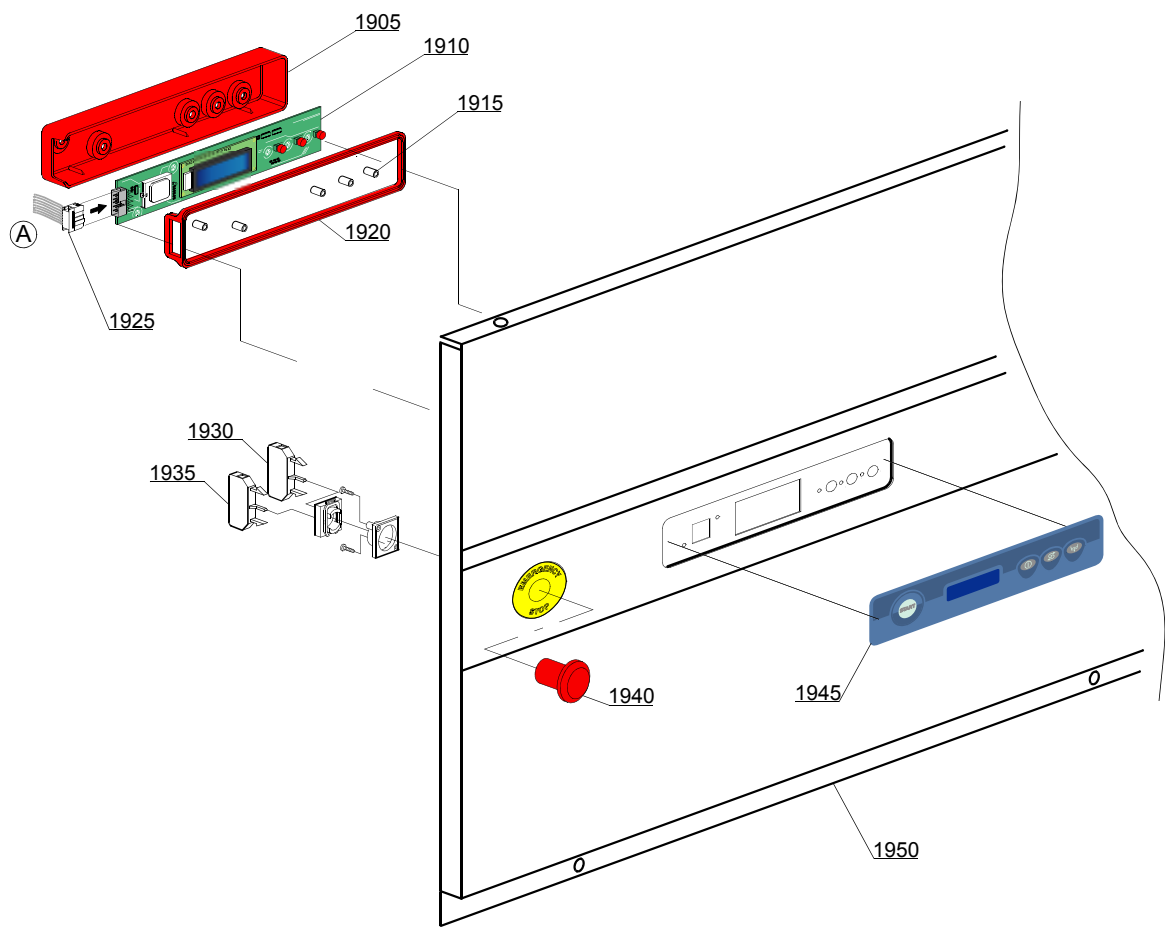

| ID | P-code | SN from | SN to | Mod. | Acces. | Volt | Description |
|---|----------|---------|-------|------|--------|------|--|
| Module:Electric parts [UX-110,BB 1100] | | | | | | | |
| 1905 | 560051/A | | - | e,uw | | A | Protective cover for board |
| 1910 | 560051 | | - | e,uw | | A | Compleat membrane push button-driver |
| 1915 | 50561 | | - | e,uw | | A | Board spacer |
| 1920 | 560051/B | | - | e,uw | | A | Gaskets for protective cover |
| 1925 | 50651 | | - | e,uw | | A | Plug |
| 1930 | 3002054 | | - | e,uw | | A | Green contact piece (NO) |
| 1935 | 3002056 | | - | e,uw | | A | Red contact piece (NC) |
| 1940 | 3002050 | | - | e,uw | | A | Emergency button |
| 1945 | 560048 | | - | e,uw | | A | Silkscreen processed grill membrane push button-driver |
| 1950 | 3020514 | | - | e,uw | | A | Front cover |

e=ELECTRONICAL SWITCHES, uw=LOWER AND UPPER WASHER

85S=85S

dvgw=DVGW VALVE SYSTEM, bp=BOOSTER PUMP

A=3/N/PE~380-400V 50-60Hz, D=3/PE~200-210V 50-60Hz, F=2/PE~220-240V 50-60Hz, G=3/N/PE~415V 50-60Hz, H=3/PE~220-230V 50-60Hz, K=3/PE~380-400V 50-60Hz, L=3/PE~415V 50-60Hz, M=3/PE~440V 60Hz, P=1/N/PE~220-230V 50-60Hz, R=2/PE~220-240V 50-60Hz, U=1/N/PE~240V 50-60Hz, V=3/PE~240V 50-60Hz, W=1/N/PE~100-110V 50-60Hz

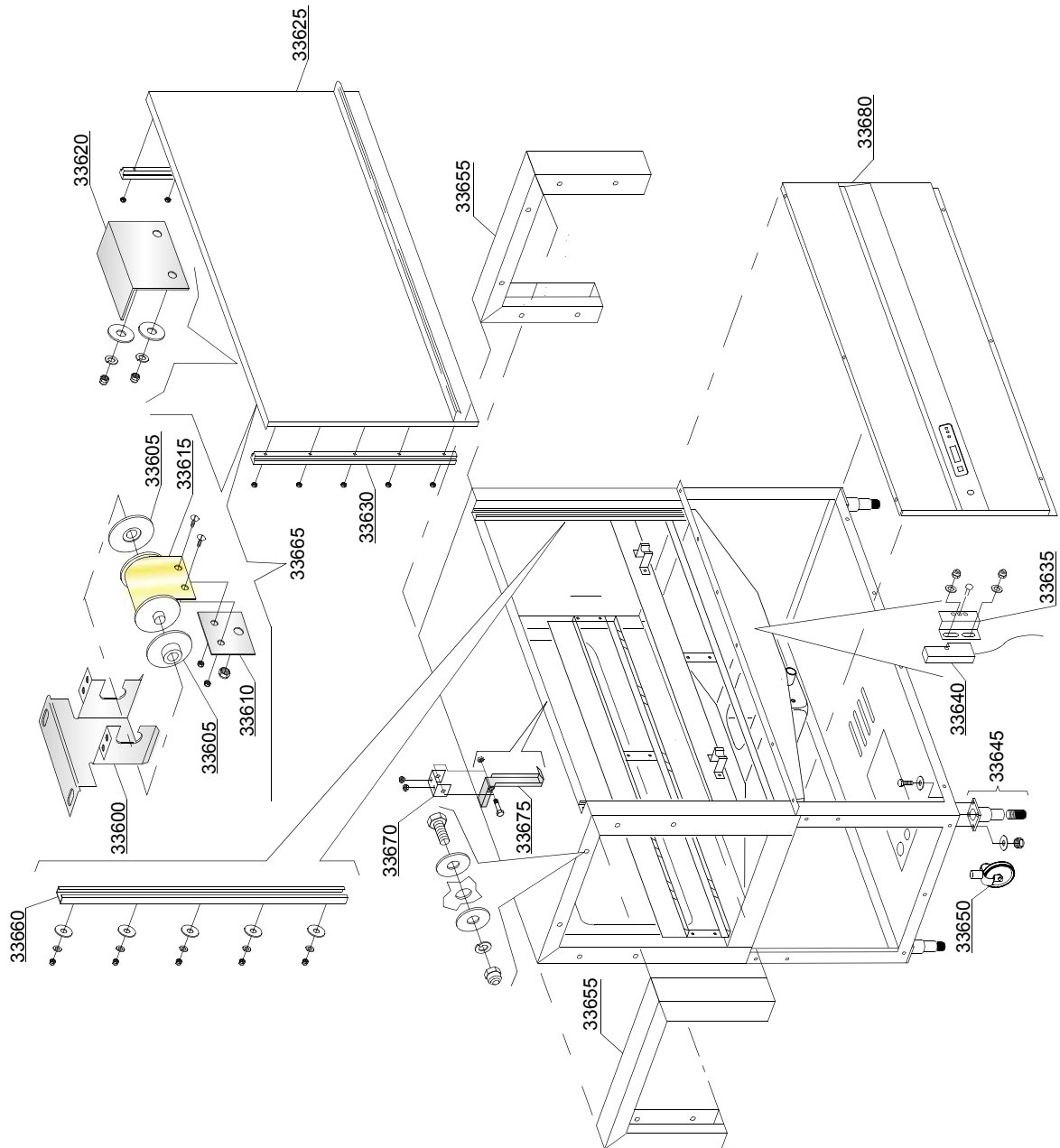

| ID | P-code | SN from | SN to | Mod. | Acces. | Volt | Description |
|--|-----------|---------|-------|------|--------|------|-------------------------|
| Module:General parts [UX-110,BB 1100] | | | | | | | |
| 33600 | 3009664 | | - | uw | | | Spring support |
| 33605 | 3004012 | | - | uw | | | Spring holder |
| 33610 | 3009555 | | - | uw | | | Spring clamping plate |
| 33615 | 3004010 | | - | uw | | | Door spring BBSR 21 |
| 33620 | 3009269 | | - | uw | | | Door stop |
| 33625 | 3009403 | | - | uw | | | Door assembly |
| 33630 | 3004026 | | - | uw | | | Door guide |
| 33635 | 3009112 | | - | uw | | | Microswitch support |
| 33640 | 3003112 | | - | uw | | | Door microswitch |
| 33645 | 80116 | | - | uw | | | Foot |
| 33650 | 999900509 | | - | uw | | | Wheels kit |
| 33655 | 3020004 | | - | uw | | | Splash zone |
| 33660 | 3009033 | | - | uw | | | Slideways |
| 33665 | 3009907 | | - | uw | | | Spring assembly BBSR 21 |
| 33670 | 3000324 | | - | uw | | | Hook support |
| 33675 | 3000323 | | - | uw | | | Hook door |
| 33680 | 3020514 | | - | uw | | | Front cover |

e=ELECTRONICAL SWITCHES, uw=LOWER AND UPPER WASHER

85S=85S

dvgw=DVGW VALVE SYSTEM, bp=BOOSTER PUMP

A=3/N/PE~380-400V 50-60Hz, D=3/PE~200-210V 50-60Hz, F=2/PE~220-240V 50-60Hz, G=3/N/PE~415V 50-60Hz, H=3/PE~220-230V 50-60Hz, K=3/PE~380-400V 50-60Hz, L=3/PE~415V 50-60Hz, M=3/PE~440V 60Hz, P=1/N/PE~220-230V 50-60Hz, R=2/PE~220-240V 50-60Hz, U=1/N/PE~240V 50-60Hz, V=3/PE~240V 50-60Hz, W=1/N/PE~100-110V 50-60Hz

03_104xe

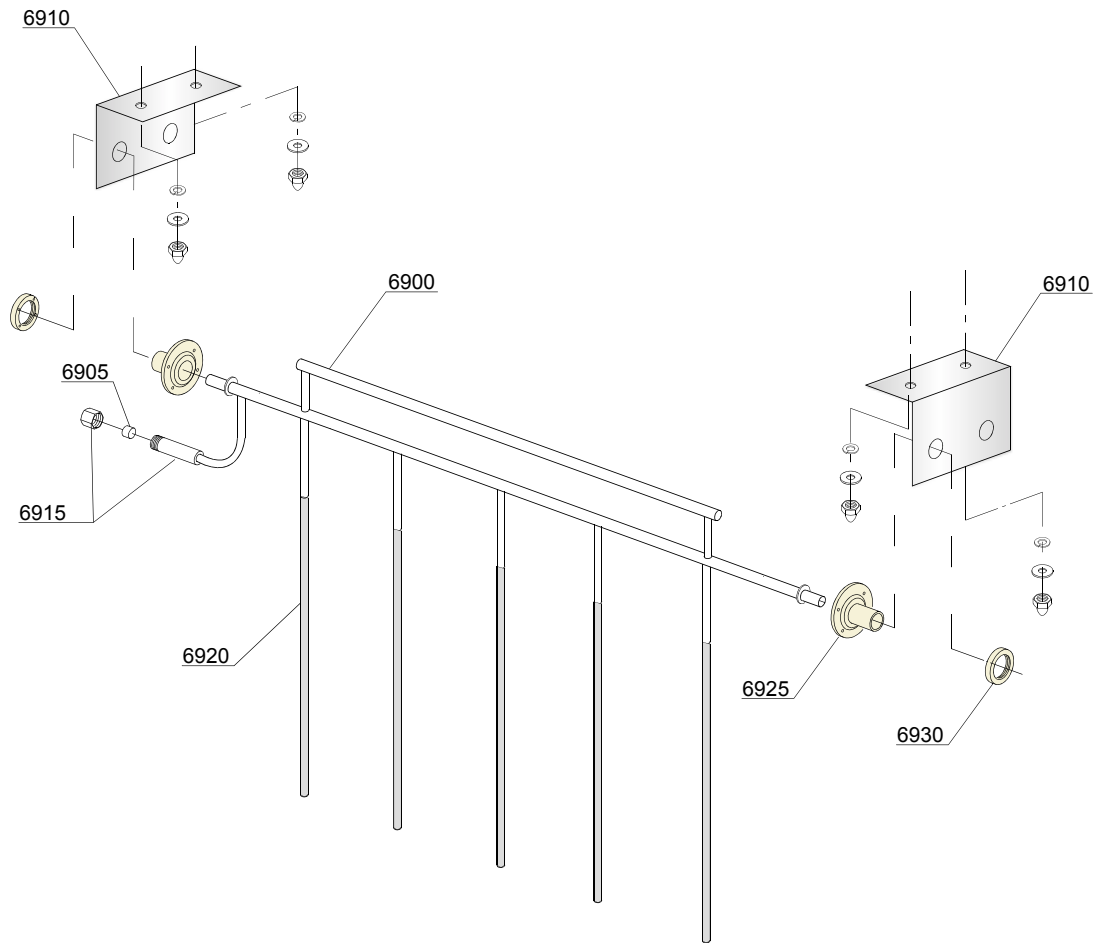

VALIDO PER VERSIONI DX E SX
VALID FOR EITHER RIGHT OR LEFT VERSION
VALABLE POUR VERSION DROITE ET GAUCHE

vsezip.ru

| ID | P-code | SN from | SN to | Mod. | Acces. | Volt | Description |
|--|---------|---------|-------|------|--------|------|------------------------|
| Module: Economizer components [UX-110, BE 1100] | | | | | | | |
| 6900 | 3020525 | | - | e,uw | | | Bar economizer support |
| 6905 | 3003113 | | - | e,uw | | | Magnet |
| 6910 | 3020527 | | - | e,uw | | | Economizer support |
| 6915 | 3060065 | | - | e,uw | | | Magnet holder |
| 6920 | 3060159 | | - | e,uw | | | Economizer bar |
| 6925 | 75320 | | - | e,uw | | | Holder |
| 6930 | 75317 | | - | e,uw | | | Nut |

e=ELECTRONICAL SWITCHES, uw=LOWER AND UPPER WASHER

85S=85S

dvgw=DVGW VALVE SYSTEM, bp=BOOSTER PUMP

A=3/N/PE~380-400V 50-60Hz, D=3/PE~200-210V 50-60Hz, F=2/PE~220-240V 50-60Hz, G=3/N/PE~415V 50-60Hz, H=3/PE~220-230V 50-60Hz, K=3/PE~380-400V 50-60Hz, L=3/PE~415V 50-60Hz, M=3/PE~440V 60Hz, P=1/N/PE~220-230V 50-60Hz, R=2/PE~220-240V 50-60Hz, U=1/N/PE~240V 50-60Hz, V=3/PE~240V 50-60Hz, W=1/N/PE~100-110V 50-60Hz

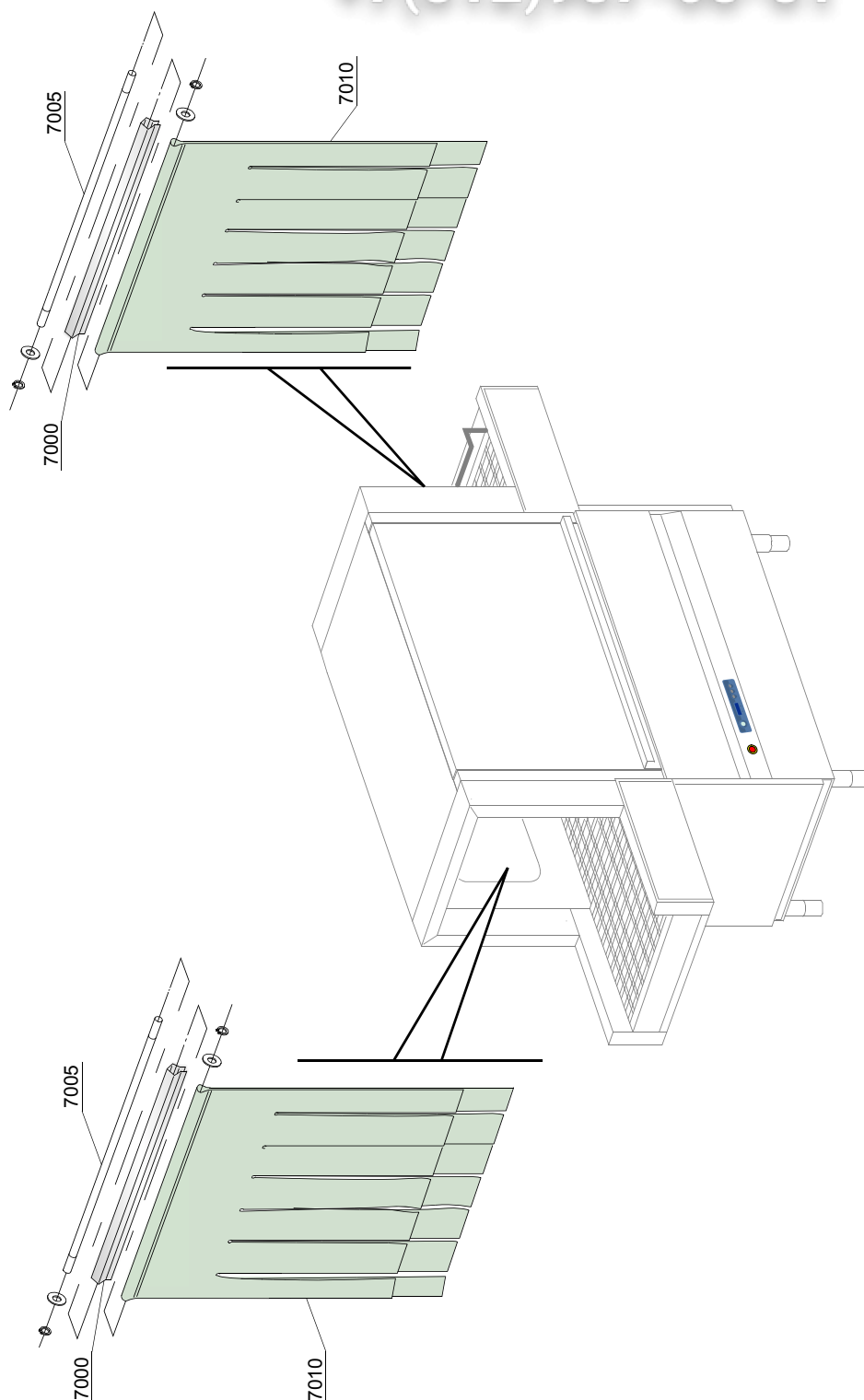

vsezip.ru

| ID | P-code | SN from | SN to | Mod. | Acces. | Volt | Description |
|---|---------|---------|-------|------|--------|------|------------------|
| Module: Curtains group components [UX-110, BL 110] | | | | | | | |
| 7000 | 3009109 | | - | e,uw | | | Curtain moulding |
| 7005 | 3004053 | | - | e,uw | | | Curtain rod long |
| 7010 | 3004052 | | - | e,uw | | | Curtain long |

e=ELECTRONICAL SWITCHES, uw=LOWER AND UPPER WASHER

85S=85S

dvgw=DVGW VALVE SYSTEM, bp=BOOSTER PUMP

A=3/N/PE~380-400V 50-60Hz, D=3/PE~200-210V 50-60Hz, F=2/PE~220-240V 50-60Hz, G=3/N/PE~415V 50-60Hz, H=3/PE~220-230V 50-60Hz, K=3/PE~380-400V 50-60Hz, L=3/PE~415V 50-60Hz, M=3/PE~440V 60Hz, P=1/N/PE~220-230V 50-60Hz, R=2/PE~220-240V 50-60Hz, U=1/N/PE~240V 50-60Hz, V=3/PE~240V 50-60Hz, W=1/N/PE~100-110V 50-60Hz

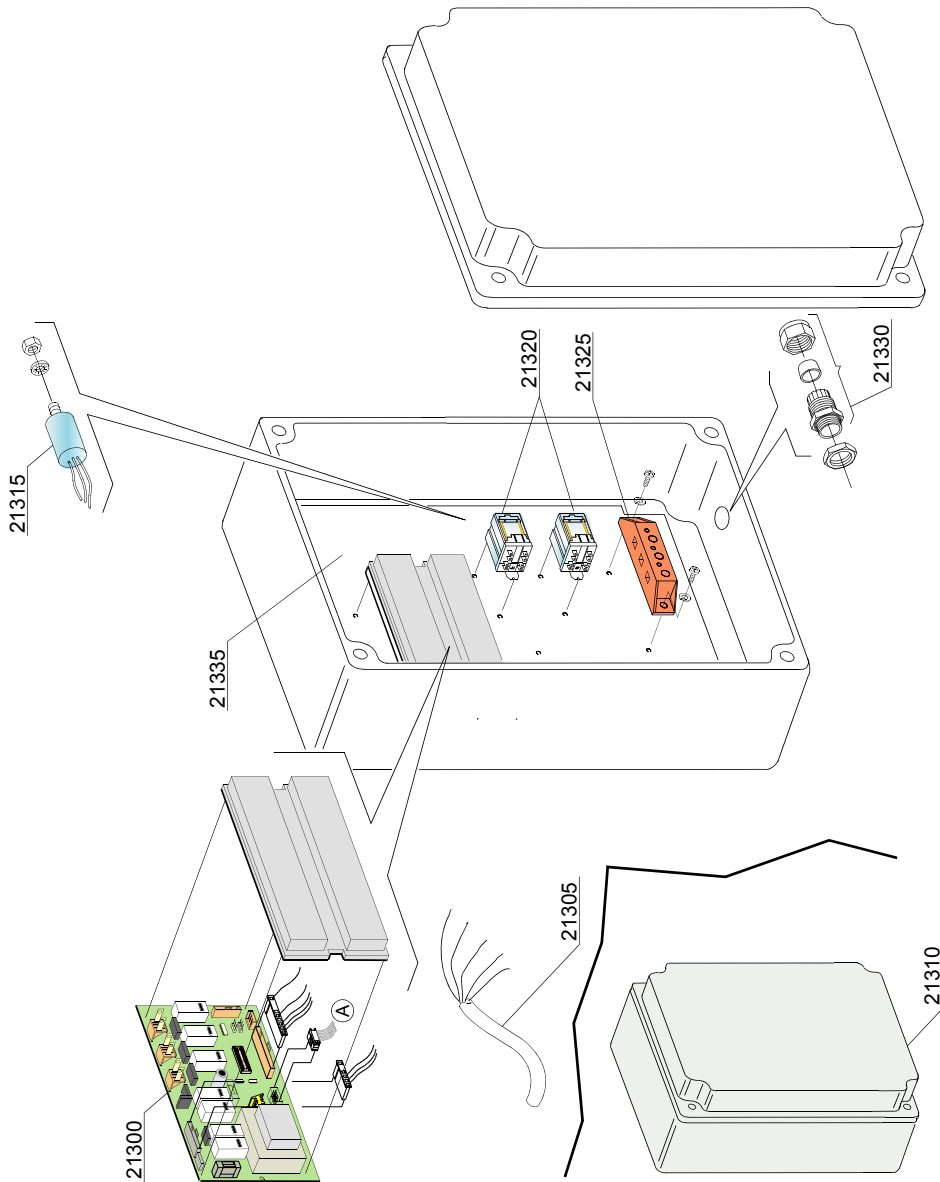

vsezip.ru

| ID | P-code | SN from | SN to | Mod | Acces | Volt | Description |
|--|----------|---------|-------|------|-------|------|--------------------------------|
| Module: Electric control components [UX-110, BE 1100] | | | | | | | |
| 21300 | 3020536 | | - | e,uw | | | Main board |
| 21305 | 10713 | | - | e,uw | | | 3x2,5x2500 cable |
| 21310 | 3020535 | | - | e,uw | | | Electric components box |
| 21315 | 15149 | | - | e,uw | | | Low noise filter F3 (0,3mF) |
| 21320 | 15620 | | - | e,uw | | | 16A bipolar relay in deviation |
| 21325 | 500550 | | - | e,uw | | | 3 poles terminal board |
| 21330 | 10300412 | | - | e,uw | | | Fairlead PG13 |
| 21335 | 3020518 | | - | e,uw | | | Electric components panel |

e=ELECTRONICAL SWITCHES, uw=LOWER AND UPPER WASHER

85S=85S

dvgw=DVGW VALVE SYSTEM, bp=BOOSTER PUMP

A=3/N/PE~380-400V 50-60Hz, D=3/PE~200-210V 50-60Hz, F=2/PE~220-240V 50-60Hz, G=3/N/PE~415V 50-60Hz, H=3/PE~220-230V 50-60Hz, K=3/PE~380-400V 50-60Hz, L=3/PE~415V 50-60Hz, M=3/PE~440V 60Hz, P=1/N/PE~220-230V 50-60Hz, R=2/PE~220-240V 50-60Hz, U=1/N/PE~240V 50-60Hz, V=3/PE~240V 50-60Hz, W=1/N/PE~100-110V 50-60Hz

05_003xe

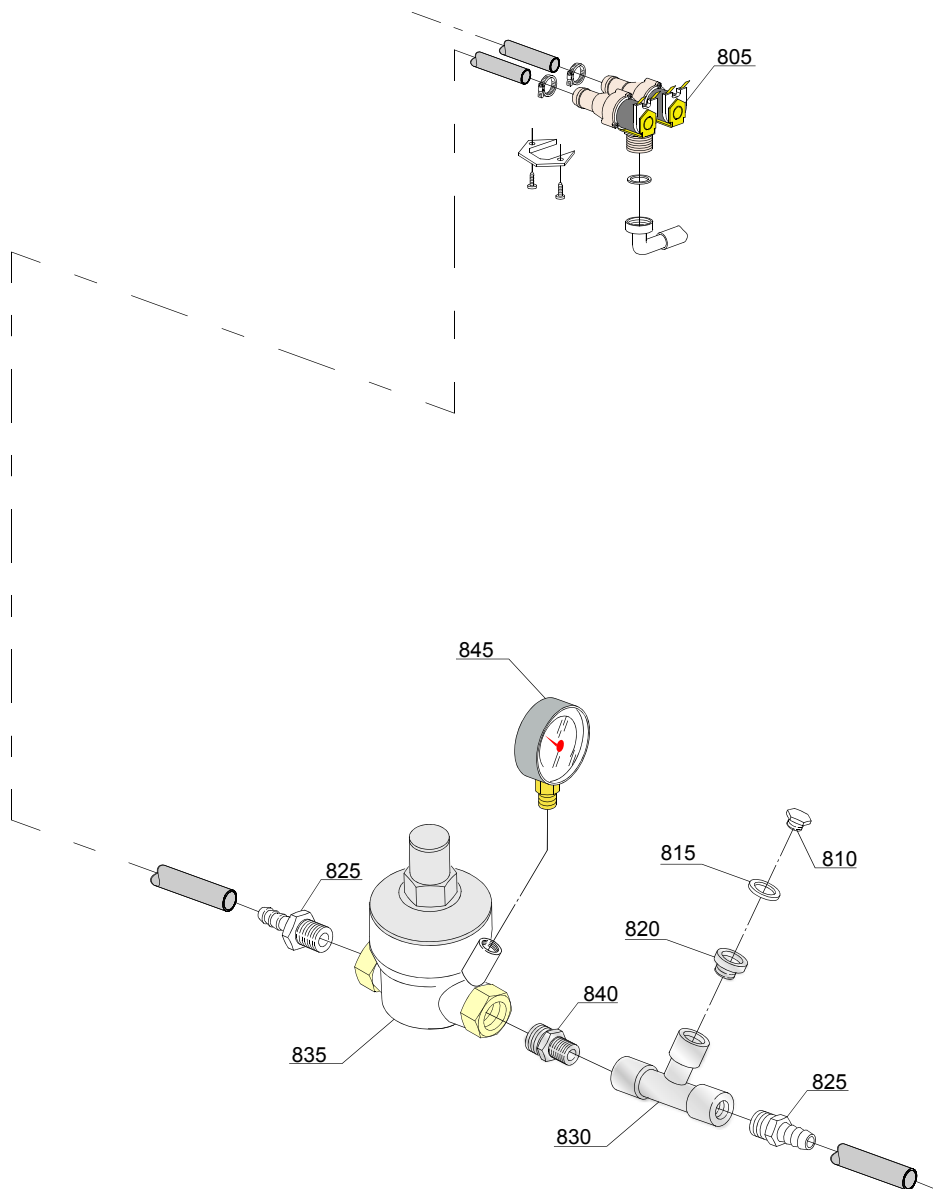

vsezip.ru

| ID | P-code | SN from | SN to | Mod | Acces. | Volt | Description |
|---|---------|---------|-------|------|--------|------|----------------------------------|
| Module:Solenoid valve group [UX-110,BB 1100] | | | | | | | |
| 805 | 2000094 | | - | e,uw | | | Double solenoid valve - Ø14 3/4" |
| 810 | 12002 | | - | e,uw | | | Plug |
| 815 | 13309 | | - | e,uw | | | Gasket 14x10x1,5 |
| 820 | 12032 | | - | e,uw | | | Rduction nipples |
| 825 | 12005 | | - | e,uw | | | Hose holder |
| 830 | 12008 | | - | e,uw | | | Connection "T" |
| 835 | 391025 | | - | e,uw | | | Pressure reduction valve |
| 840 | 12033 | | - | e,uw | | | 1/4M - 1/2 Reduction nipples |
| 845 | 2000244 | | - | e,uw | | | Pressure reduction gauge |

e=ELECTRONICAL SWITCHES, uw=LOWER AND UPPER WASHER

85S=85S

dvgw=DVGW VALVE SYSTEM, bp=BOOSTER PUMP

A=3/N/PE~380-400V 50-60Hz, D=3/PE~200-210V 50-60Hz, F=2/PE~220-240V 50-60Hz, G=3/N/PE~415V 50-60Hz, H=3/PE~220-230V 50-60Hz, K=3/PE~380-400V 50-60Hz, L=3/PE~415V 50-60Hz, M=3/PE~440V 60Hz, P=1/N/PE~220-230V 50-60Hz, R=2/PE~220-240V 50-60Hz, U=1/N/PE~240V 50-60Hz, V=3/PE~240V 50-60Hz, W=1/N/PE~100-110V 50-60Hz

vsezip.ru

+7(812)987-08-81

22_002.dwg

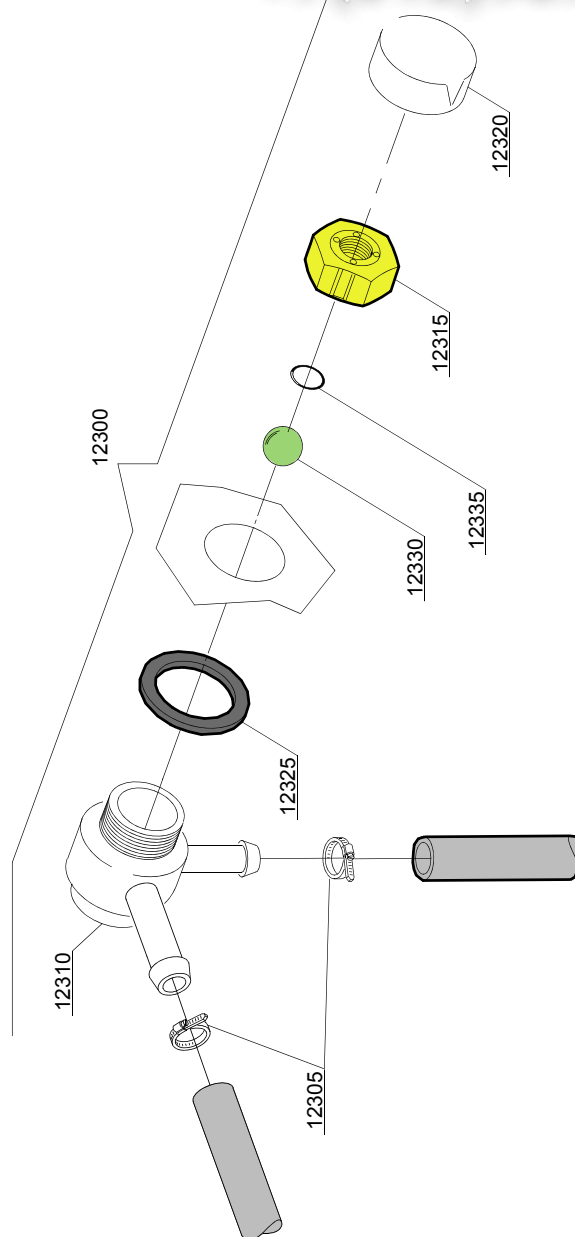

vsezip.ru

| ID | P-code | SN from | SN to | Mod | Acces. | Volt | Description |
|---|---------|---------|-------|------|--------|------|-----------------------|
| Module:DVGW valve [UX-110,BB 1100] | | | | | | | |
| 12300 | 9891710 | | - | e,uw | | | DVGW valvola assembly |
| 12305 | 11807 | | - | e,uw | | | Clamp aisi430 12/22 |
| 12310 | 15280 | | - | e,uw | | | Valve body center |
| 12315 | 15281 | | - | e,uw | | | Flat valve |
| 12320 | 15282 | | - | e,uw | | | Flat valve cover |
| 12325 | 15283 | | - | e,uw | | | Valve gasket |
| 12330 | 15284 | | - | e,uw | | | Sphere |
| 12335 | 15285 | | - | e,uw | | | O-ring 115 KTW |

e=ELECTRONICAL SWITCHES, uw=LOWER AND UPPER WASHER

85S=85S

dvgw=DVGW VALVE SYSTEM, bp=BOOSTER PUMP

A=3/N/PE~380-400V 50-60Hz, D=3/PE~200-210V 50-60Hz, F=2/PE~220-240V 50-60Hz, G=3/N/PE~415V 50-60Hz, H=3/PE~220-230V 50-60Hz, K=3/PE~380-400V 50-60Hz, L=3/PE~415V 50-60Hz, M=3/PE~440V 60Hz, P=1/N/PE~220-230V 50-60Hz, R=2/PE~220-240V 50-60Hz, U=1/N/PE~240V 50-60Hz, V=3/PE~240V 50-60Hz, W=1/N/PE~100-110V 50-60Hz

vsezip.ru

+7(812)987-08-81

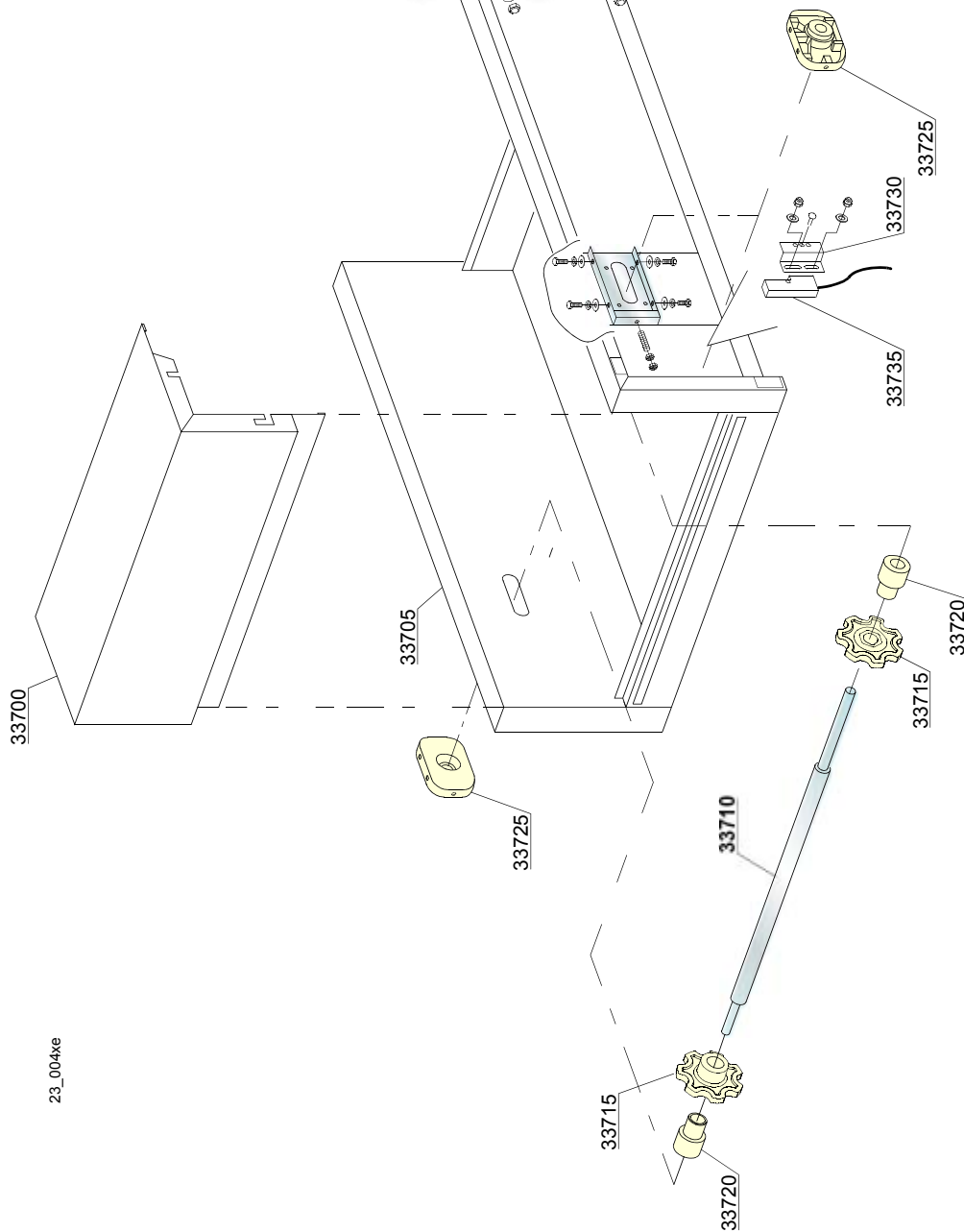

23_004xe

vsezip.ru

| ID | P-code | SN from | SN to | Mod | Acces. | Volt | Description |
|---|---------|---------|-------|-----|--------|------|-----------------------|
| Module:Entry shelf components [UX-110,BB 1100] | | | | | | | |
| 33700 | 3020510 | | - | uw | | | Bracket door |
| 33710 | 3020107 | | - | uw | | | Neutral shaft |
| 33715 | 3060134 | | - | uw | | | Neutral wheel |
| 33720 | 3060135 | | - | uw | | | Neutral wheel bushing |
| 33725 | 3060128 | | - | uw | | | Idle shaft support |
| 33730 | 3009112 | | - | uw | | | Support reed |
| 33735 | 3003112 | | - | uw | | | Safety door reed |

e=ELECTRONICAL SWITCHES, uw=LOWER AND UPPER WASHER

85S=85S

dvgw=DVGW VALVE SYSTEM, bp=BOOSTER PUMP

A=3/N/PE~380-400V 50-60Hz, D=3/PE~200-210V 50-60Hz, F=2/PE~220-240V 50-60Hz, G=3/N/PE~415V 50-60Hz,
 H=3/PE~220-230V 50-60Hz, K=3/PE~380-400V 50-60Hz, L=3/PE~415V 50-60Hz, M=3/PE~440V 60Hz, P=1/N/PE~220-
 230V 50-60Hz, R=2/PE~220-240V 50-60Hz, U=1/N/PE~240V 50-60Hz, V=3/PE~240V 50-60Hz, W=1/N/PE~100-110V
 50-60Hz

vsezip.ru

+7(812)987-08-81

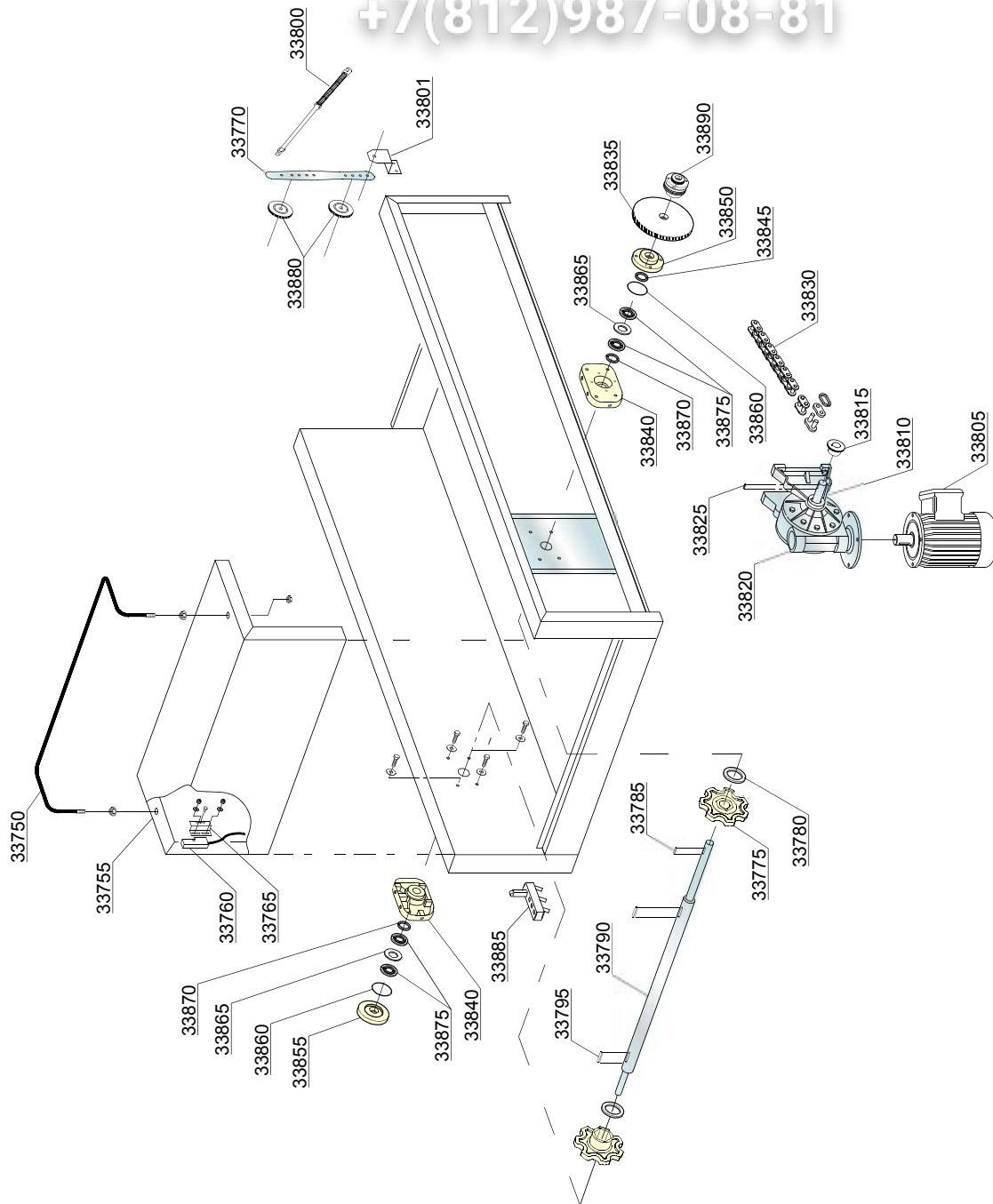

23_005xe

| ID | P-code | SN from | SN to | Mod | Acces | Volt | Description |
|--|---------|---------|-------|-----|-------|------|--|
| Module:Exit shelf components [UX-110,BB 1100] | | | | | | | |
| 33750 | 3020521 | | - | uw | | | End microswitch |
| 33755 | 3020511 | | - | uw | | | Bracket door |
| 33760 | 3003112 | | - | uw | | | Reed micro switch |
| 33765 | 3009112 | | - | uw | | | Reed supprt |
| 33770 | 3060136 | | - | uw | | | Bracket door pipe |
| 33775 | 3060022 | | - | uw | | | Capstan / Pulley |
| 33780 | 3060055 | | - | uw | | | Tape spacer |
| 33785 | 3060032 | | - | uw | | | Inox key 8x6x20 |
| 33790 | 3020106 | | - | uw | | | Capstan / Shaft |
| 33795 | 2001046 | | - | uw | | | Inox key 8x7x30 |
| 33800 | 560003 | | - | uw | | | Spring bracket door |
| 33801 | 3020529 | | - | uw | | | Chain tightener support |
| 33805 | 3020105 | | - | uw | | | Reduction motor gear 4/6P 400/415 V 50Hz |
| 33810 | 3060180 | | - | uw | | | SITI reducing tree |
| 33810 | 3060021 | | - | uw | | | BONFIGLIOLI reducing tree |
| 33815 | 3060168 | | - | uw | | | Pinion Z10 1/2" - 5/16" |
| 33820 | 3000210 | | - | uw | | | Right reduction 1:80 (DX) |
| 33825 | 2001046 | | - | uw | | | Inox key 8x7x30 |
| 33830 | 3060041 | | - | uw | | | Chaine 1/2" 088 |
| 33835 | 3060003 | | - | uw | | | Pinion Z50 1/2" - 5/16" |
| 33840 | 3060028 | | - | uw | | | Lateral support shaft |
| 33845 | 3060194 | | - | uw | | | Viton seal ring 20.30.5 M.INOX |
| 33850 | 3060129 | | - | uw | | | Cover with hole |
| 33855 | 3060130 | | - | uw | | | Cover without hole |
| 33860 | 13008 | | - | uw | | | Gasket OR-147 NBR |
| 33865 | 3060199 | | - | uw | | | Spacer bearing |
| 33870 | 3060167 | | - | uw | | | Chain tightener |
| 33875 | 3060131 | | - | uw | | | Bearing 6004 42-20-12 |

e=ELECTRONICAL SWITCHES, uw=LOWER AND UPPER WASHER

85S=85S

dvgw=DVGW VALVE SYSTEM, bp=BOOSTER PUMP

A=3/N/PE~380-400V 50-60Hz, D=3/PE~200-210V 50-60Hz, F=2/PE~220-240V 50-60Hz, G=3/N/PE~415V 50-60Hz, H=3/PE~220-230V 50-60Hz, K=3/PE~380-400V 50-60Hz, L=3/PE~415V 50-60Hz, M=3/PE~440V 60Hz, P=1/N/PE~220-230V 50-60Hz, R=2/PE~220-240V 50-60Hz, U=1/N/PE~240V 50-60Hz, V=3/PE~240V 50-60Hz, W=1/N/PE~100-110V 50-60Hz

vsezip.ru

+7(812)987-08-81

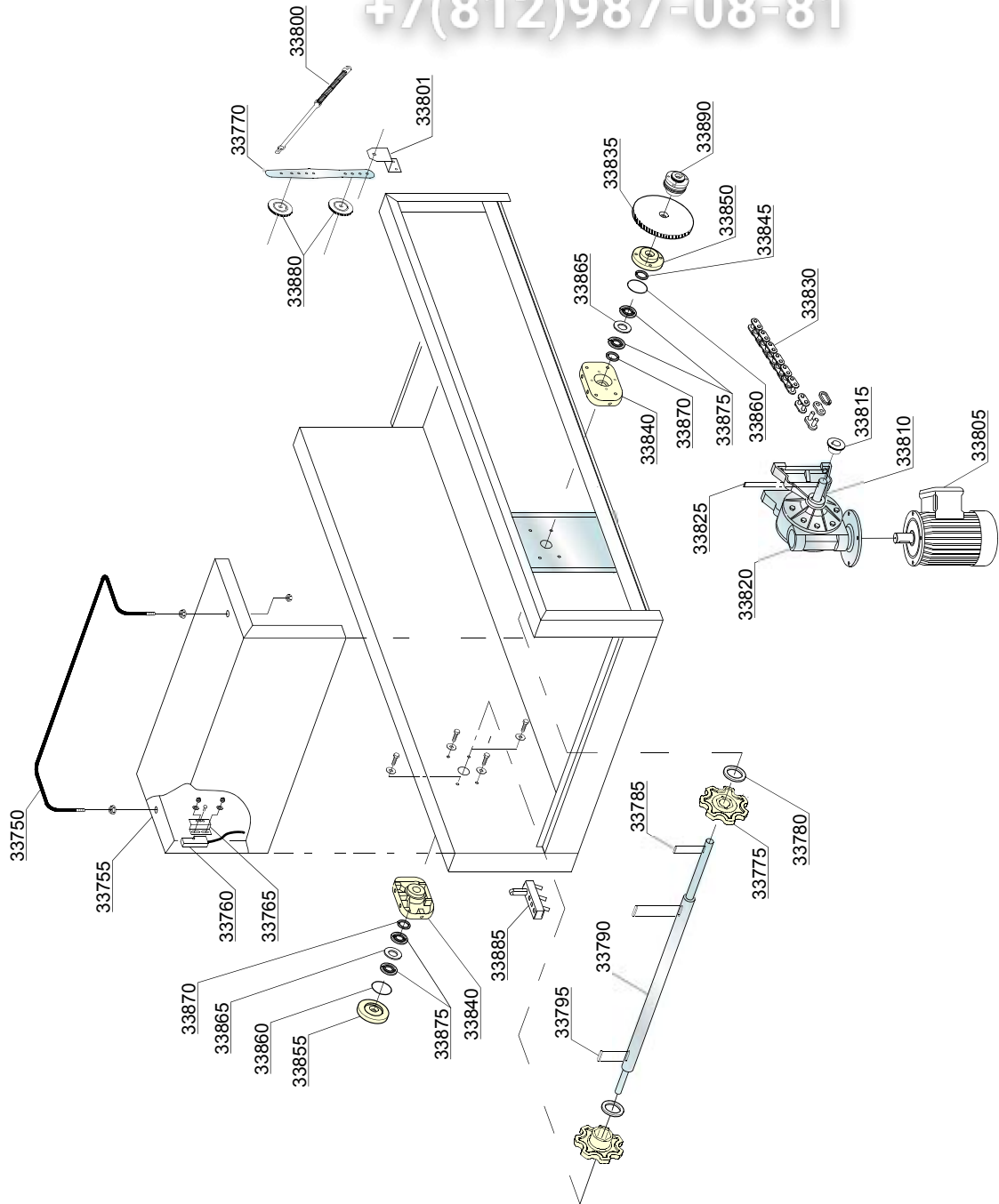

23_005xe

vsezip.ru

| ID | P-code | SN from | SN to | Mod | Acces. | Volt | Description |
|---|---------|---------|-------|-----|--------|------|------------------------|
| Module:Exit shelf components [UX-110,BB 110] | | | | | | | |
| 33880 | 3060042 | | - | uw | | | Chain tightener pinion |
| 33885 | 70305 | | - | uw | | | End switch |
| 33890 | 3020532 | | - | uw | | | Clutch kit |

e=ELECTRONICAL SWITCHES, uw=LOWER AND UPPER WASHER

85S=85S

dvgw=DVGW VALVE SYSTEM, bp=BOOSTER PUMP

A=3/N/PE~380-400V 50-60Hz, D=3/PE~200-210V 50-60Hz, F=2/PE~220-240V 50-60Hz, G=3/N/PE~415V 50-60Hz, H=3/PE~220-230V 50-60Hz, K=3/PE~380-400V 50-60Hz, L=3/PE~415V 50-60Hz, M=3/PE~440V 60Hz, P=1/N/PE~220-230V 50-60Hz, R=2/PE~220-240V 50-60Hz, U=1/N/PE~240V 50-60Hz, V=3/PE~240V 50-60Hz, W=1/N/PE~100-110V 50-60Hz

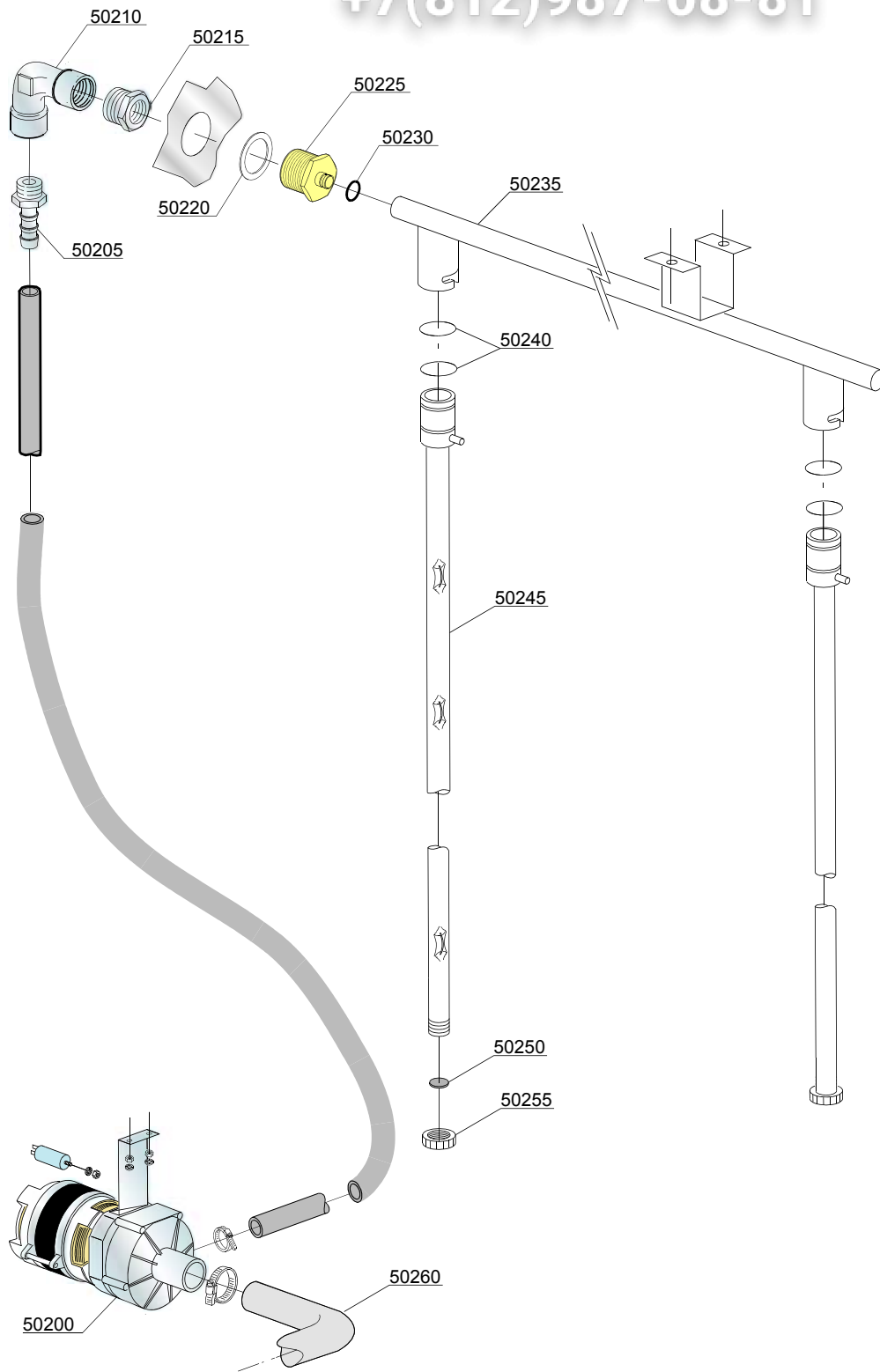

vsezip.ru

| ID | P-code | SN from | SN to | Mod | Acces. | Volt | Description |
|---|---------|---------|-------|------------------------|--------|------|---------------------------------|
| Module:Pre-rinsing system components | | | | [UX-11, BB 200] | | | |
| 50200 | 10501/C | | - | e,uw | | | Pump 0,10 HP |
| 50205 | 12023 | | - | e,uw | | | Rubber holder M 1/2 Ø12 |
| 50210 | 3003129 | | - | e,uw | | | 3/8"G Rubber holder elbow |
| 50215 | 12036 | | - | e,uw | | | Rdeuction nipples 1/2" - 3/8" F |
| 50220 | 3009387 | | - | e,uw | | | 12/10 Metal plain washer |
| 50225 | 3003127 | | - | e,uw | | | Rinsing graft arm G 3/8 Ø 12 |
| 50230 | 391032 | | - | e,uw | | | OR gasket 108 NBR |
| 50235 | 3020522 | | - | e,uw | | | Pre-rinsing ramp |
| 50240 | 13000 | | - | e,uw | | | O-ring 3125 |
| 50245 | 3020523 | | - | e,uw | | | Pre-rinsing inox arm 3 nozzle |
| 50250 | 2002051 | | - | e,uw | | | Gasket EPDM 17.5x1.5 |
| 50255 | 2002054 | | - | e,uw | | | Plug for arm |
| 50260 | 3020533 | | - | e,uw | | | Elbow coupling press. |

e=ELECTRONICAL SWITCHES, uw=LOWER AND UPPER WASHER

85S=85S

dvgw=DVGW VALVE SYSTEM, bp=BOOSTER PUMP

A=3/N/PE~380-400V 50-60Hz, D=3/PE~200-210V 50-60Hz, F=2/PE~220-240V 50-60Hz, G=3/N/PE~415V 50-60Hz, H=3/PE~220-230V 50-60Hz, K=3/PE~380-400V 50-60Hz, L=3/PE~415V 50-60Hz, M=3/PE~440V 60Hz, P=1/N/PE~220-230V 50-60Hz, R=2/PE~220-240V 50-60Hz, U=1/N/PE~240V 50-60Hz, V=3/PE~240V 50-60Hz, W=1/N/PE~100-110V 50-60Hz

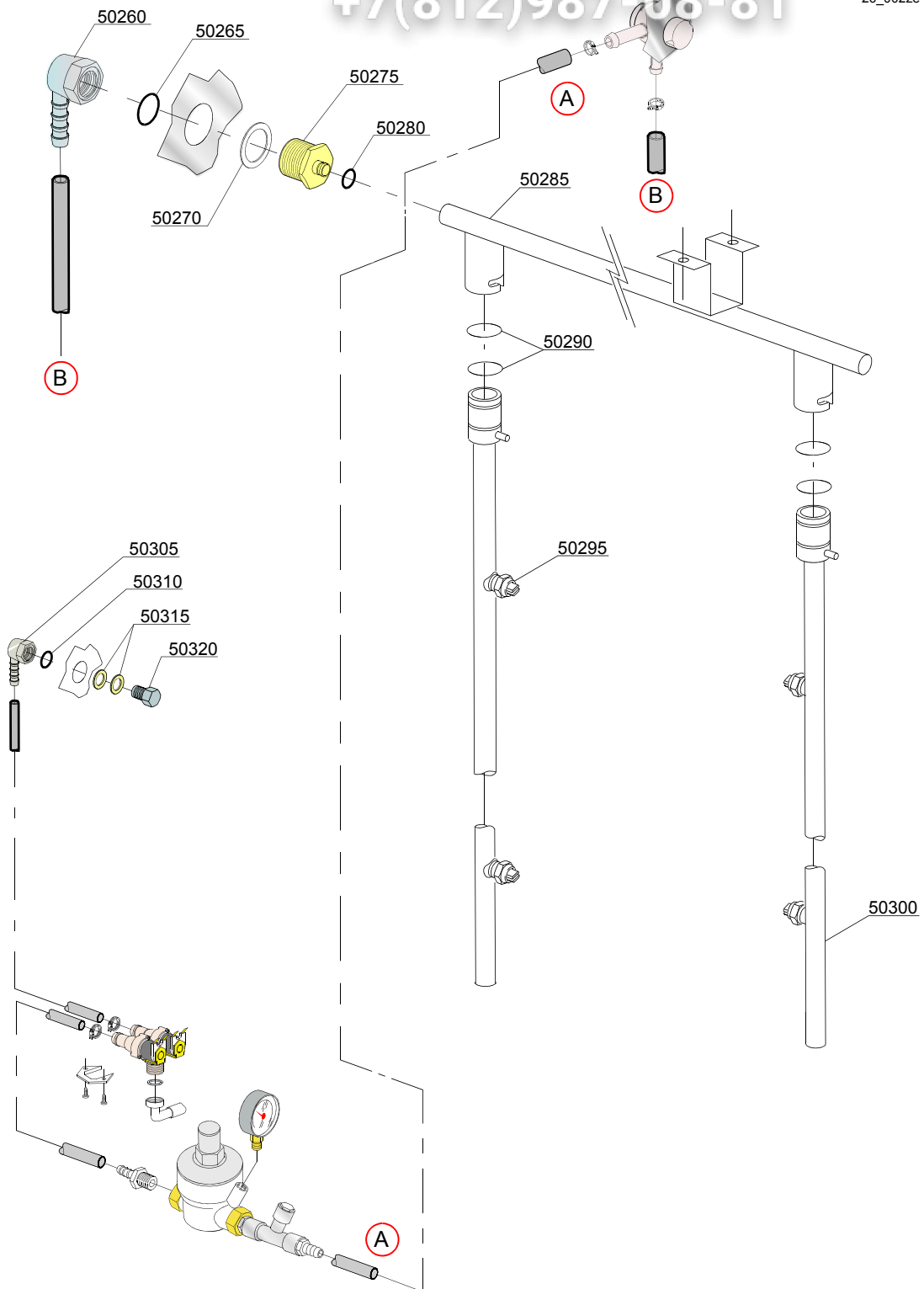

| ID | P-code | SN from | SN to | Mod. | Acces. | Volt | Description |
|--|----------|---------|-------|------|--------|------|------------------------------|
| Module:Rinsing system components [UX-110,BE 1100] | | | | | | | |
| 50260 | 3003129 | | - | e,uw | | | 3/8"G Rubber holder elbow |
| 50265 | 3003130 | | - | e,uw | | | OR gasket 123 NBR |
| 50270 | 3009387 | | - | e,uw | | | 12/10 Metal plain washer |
| 50275 | 3003127 | | - | e,uw | | | Rinsing graft arm G 3/8 Ø 12 |
| 50280 | 13025 | | - | e,uw | | | O-ring Gasket 2081 |
| 50285 | 3020537 | | - | e,uw | | | Rinsing ramp |
| 50290 | 13000 | | - | e,uw | | | OR gasket 108 NBR |
| 50295 | 2200119 | | - | e,uw | | | Pre-rinsing ramp |
| 50300 | 3020524 | | - | e,uw | | | O-ring 3125 |
| 50305 | 3003129 | | - | e,uw | | | 3/8"G Rubber holder elbow |
| 50310 | 3003130 | | - | e,uw | | | OR gasket 123 NBR |
| 50315 | 10200171 | | - | e,uw | | | FASIT gasket 25x17x2 |
| 50320 | 3003128 | | - | e,uw | | | G 3/8" load water elbow |

e=ELECTRONICAL SWITCHES, uw=LOWER AND UPPER WASHER

85S=85S

dvgw=DVGW VALVE SYSTEM, bp=BOOSTER PUMP

A=3/N/PE~380-400V 50-60Hz, D=3/PE~200-210V 50-60Hz, F=2/PE~220-240V 50-60Hz, G=3/N/PE~415V 50-60Hz, H=3/PE~220-230V 50-60Hz, K=3/PE~380-400V 50-60Hz, L=3/PE~415V 50-60Hz, M=3/PE~440V 60Hz, P=1/N/PE~220-230V 50-60Hz, R=2/PE~220-240V 50-60Hz, U=1/N/PE~240V 50-60Hz, V=3/PE~240V 50-60Hz, W=1/N/PE~100-110V 50-60Hz

vsezip.ru

+7(812)987-08-81

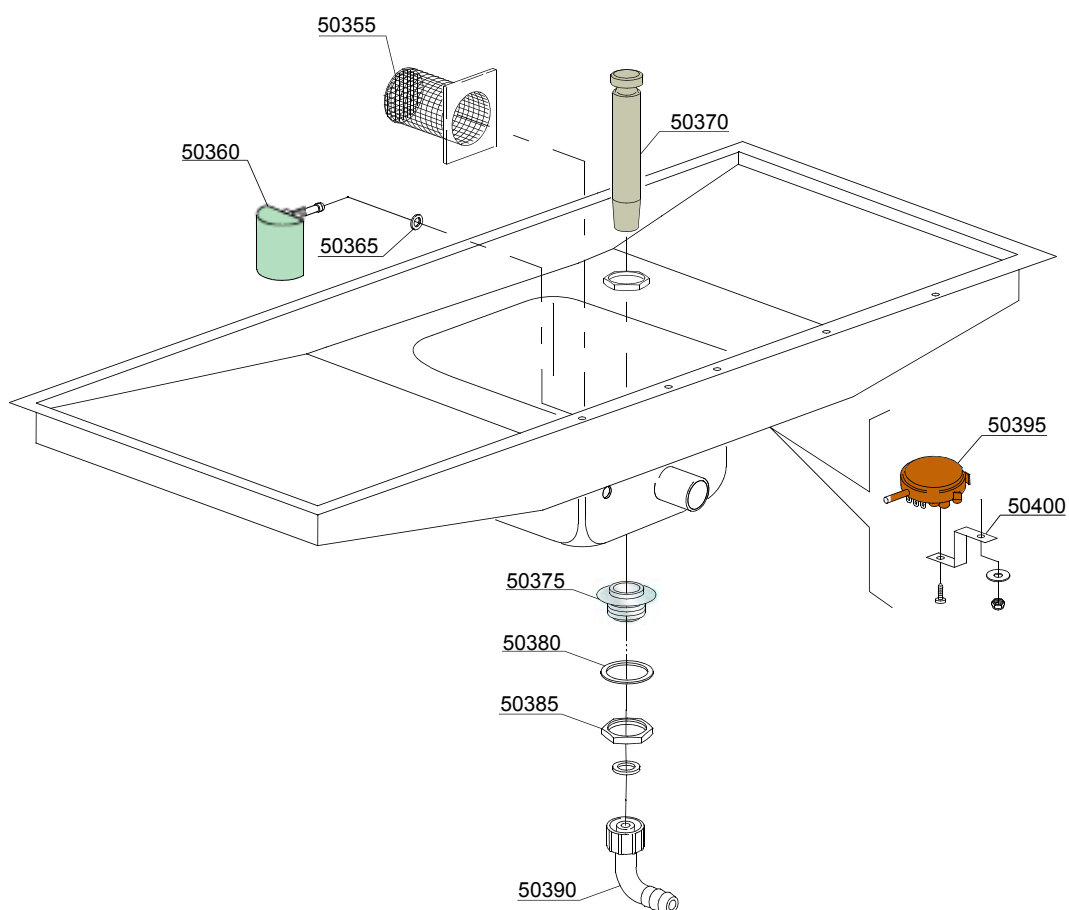
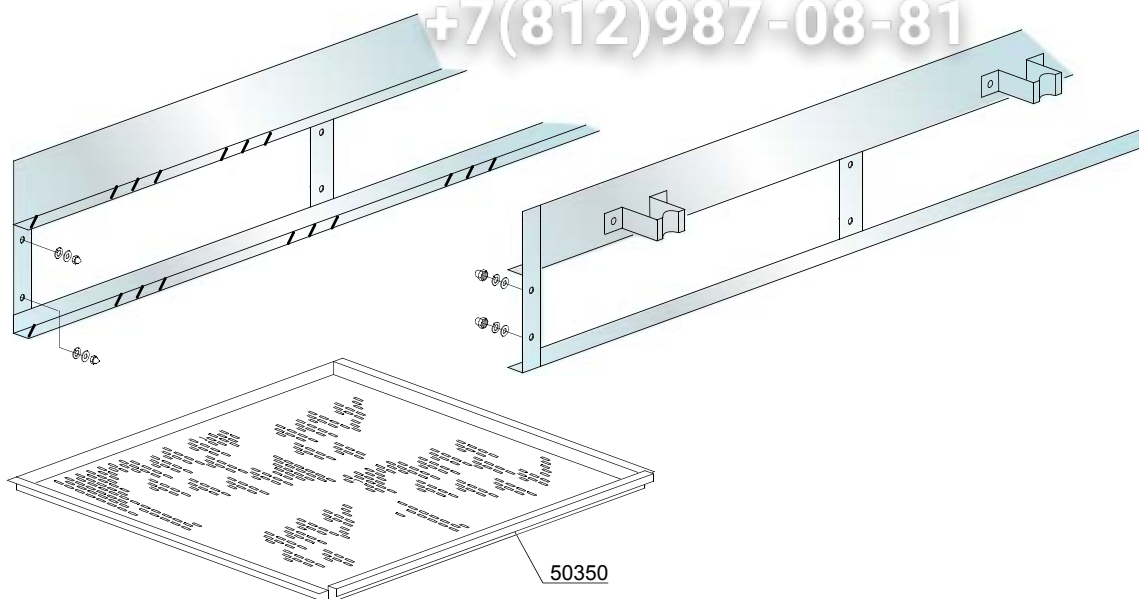

27_007xe

| ID | P-code | SN from | SN to | Mod | Acces. | Volt | Description |
|--|---------|---------|-------|------|--------|------|-----------------------------|
| Module: Internal components [UX-110, BB 1100] | | | | | | | |
| 50350 | 3020519 | | - | e,uw | | | Strainer plate |
| 50355 | 10914 | | - | e,uw | | | Pump suction-filter |
| 50360 | 135911 | | - | e,uw | | | Air trap |
| 50365 | 13301 | | - | e,uw | | | Gasket ROLMART 14x8x1.5 |
| 50370 | 25004 | | - | e,uw | | | Overflow pipe assembly |
| 50375 | 15063 | | - | e,uw | | | Stainless steel floor drain |
| 50380 | 13305 | | - | e,uw | | | Gasket 44x32x3 |
| 50385 | 11701/A | | - | e,uw | | | Nut |
| 50390 | 15613 | | - | e,uw | | | 1" 1/4x30 nylon elbow |
| 50395 | 10706/A | | - | e,uw | | | 47-27 pressure switch |
| 50400 | 3009363 | | - | e,uw | | | Pressure switch support |

e=ELECTRONICAL SWITCHES, uw=LOWER AND UPPER WASHER

85S=85S

dvgw=DVGW VALVE SYSTEM, bp=BOOSTER PUMP

A=3/N/PE~380-400V 50-60Hz, D=3/PE~200-210V 50-60Hz, F=2/PE~220-240V 50-60Hz, G=3/N/PE~415V 50-60Hz, H=3/PE~220-230V 50-60Hz, K=3/PE~380-400V 50-60Hz, L=3/PE~415V 50-60Hz, M=3/PE~440V 60Hz, P=1/N/PE~220-230V 50-60Hz, R=2/PE~220-240V 50-60Hz, U=1/N/PE~240V 50-60Hz, V=3/PE~240V 50-60Hz, W=1/N/PE~100-110V 50-60Hz

vsezip.ru

+7(812)987-08-81

30_005xe

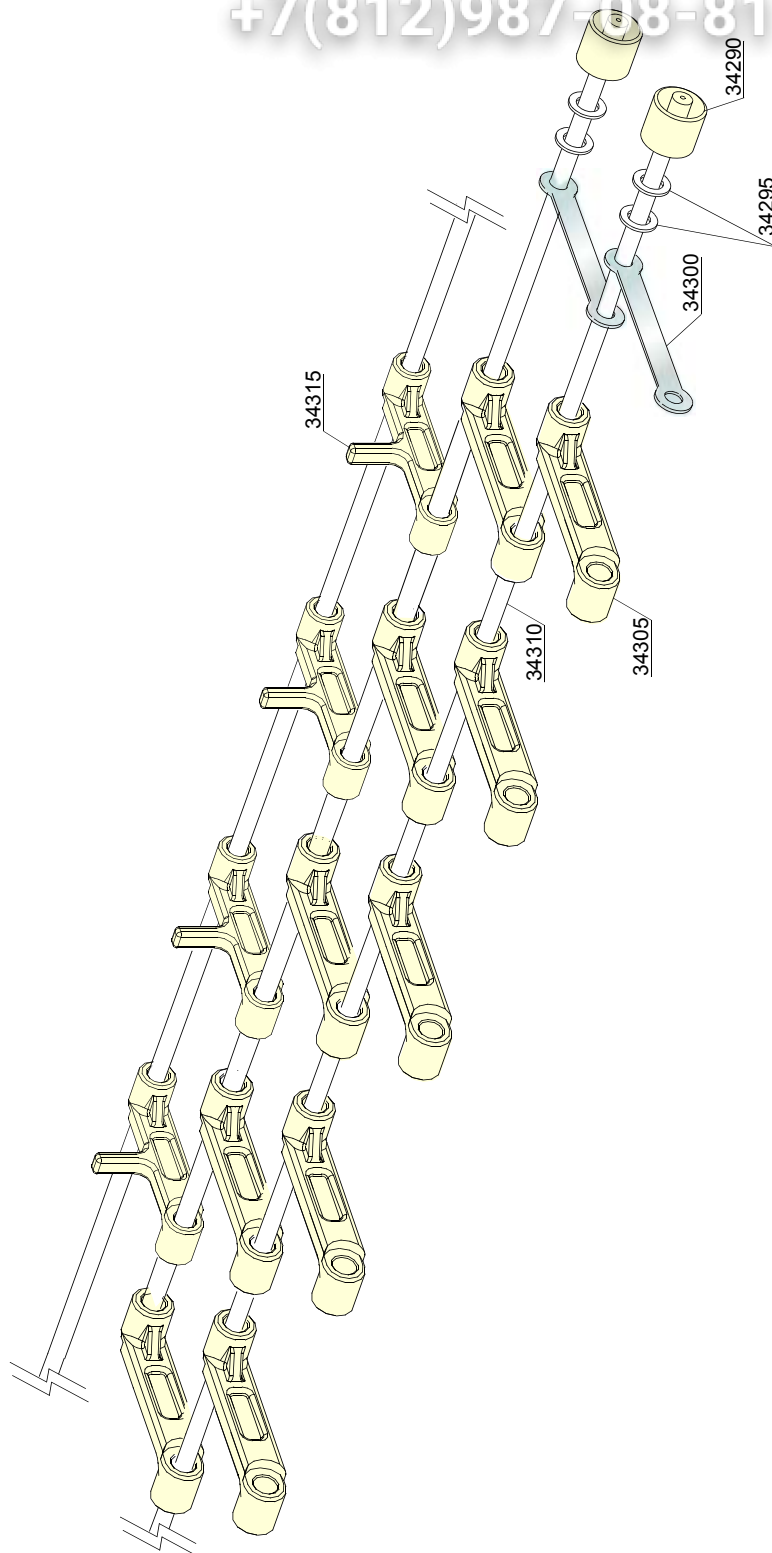

| ID | P-code | SN from | SN to | Mod. | Acces. | Volt | Description |
|---|---------|---------|-------|------|--------|------|-----------------------------|
| Module:Chain components [UX-110,BB 1100] | | | | | | | |
| 34290 | 3020109 | | - | uw | | | Wheel |
| 34295 | 11185 | | - | uw | | | Inox washer 8x16 |
| 34300 | 3060018 | | - | uw | | | Stainless steel link |
| 34305 | 3060037 | | - | uw | | | Flat shaped finger for belt |
| 34310 | 3020108 | | - | uw | | | Capstan shaft |
| 34315 | 3060036 | | - | uw | | | Shaped finger for belt |

e=ELECTRONICAL SWITCHES, uw=LOWER AND UPPER WASHER

85S=85S

dvgw=DVGW VALVE SYSTEM, bp=BOOSTER PUMP

A=3/N/PE~380-400V 50-60Hz, D=3/PE~200-210V 50-60Hz, F=2/PE~220-240V 50-60Hz, G=3/N/PE~415V 50-60Hz, H=3/PE~220-230V 50-60Hz, K=3/PE~380-400V 50-60Hz, L=3/PE~415V 50-60Hz, M=3/PE~440V 60Hz, P=1/N/PE~220-230V 50-60Hz, R=2/PE~220-240V 50-60Hz, U=1/N/PE~240V 50-60Hz, V=3/PE~240V 50-60Hz, W=1/N/PE~100-110V 50-60Hz

vsezip.ru

+7(812)987-08-81

35_002xe

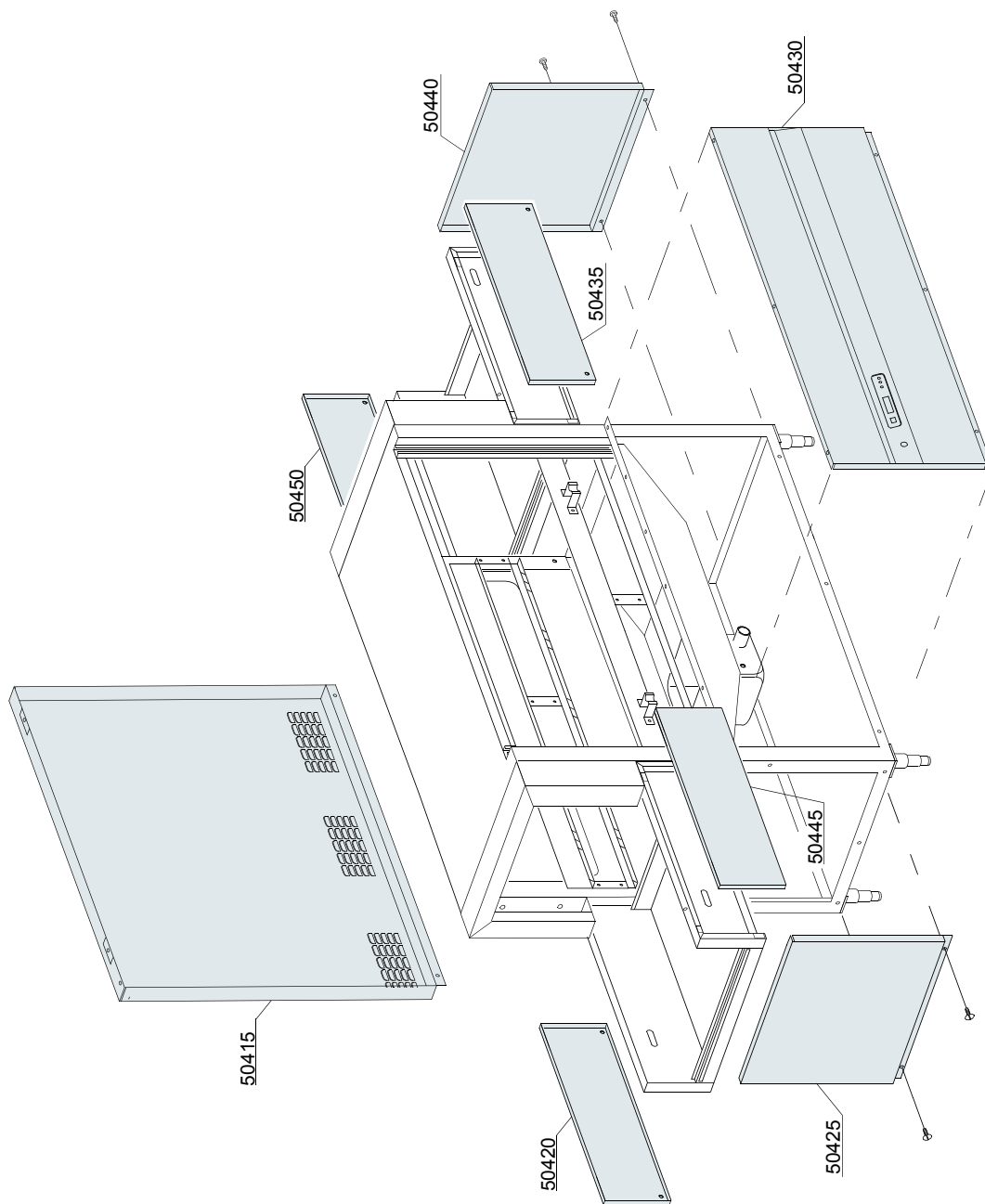

vsezip.ru

| ID | P-code | SN from | SN to | Mod. | Acces. | Volt | Description |
|---|---------|---------|-------|------|--------|------|----------------------------|
| Module: Closing panels [UX-110, BB 1100] | | | | | | | |
| 50415 | 3020515 | | - | uw | | | Back panel |
| 50420 | 3020508 | | - | uw | | | Cover for large left side |
| 50425 | 3020513 | | - | uw | | | Lateral panel left |
| 50430 | 3020514 | | - | uw | | | Front lower door panel |
| 50435 | 3020505 | | - | uw | | | Cover for tight right side |
| 50440 | 3020512 | | - | uw | | | Lateral panel right |
| 50445 | 3020506 | | - | uw | | | Cover for tight left side |
| 50450 | 3020507 | | - | uw | | | Cover for wide right side |

e=ELECTRONICAL SWITCHES, uw=LOWER AND UPPER WASHER

85S=85S

dvgw=DVGW VALVE SYSTEM, bp=BOOSTER PUMP

A=3/N/PE~380-400V 50-60Hz, D=3/PE~200-210V 50-60Hz, F=2/PE~220-240V 50-60Hz, G=3/N/PE~415V 50-60Hz, H=3/PE~220-230V 50-60Hz, K=3/PE~380-400V 50-60Hz, L=3/PE~415V 50-60Hz, M=3/PE~440V 60Hz, P=1/N/PE~220-230V 50-60Hz, R=2/PE~220-240V 50-60Hz, U=1/N/PE~240V 50-60Hz, V=3/PE~240V 50-60Hz, W=1/N/PE~100-110V 50-60Hz

vsezip.ru

+7(812)987-08-81

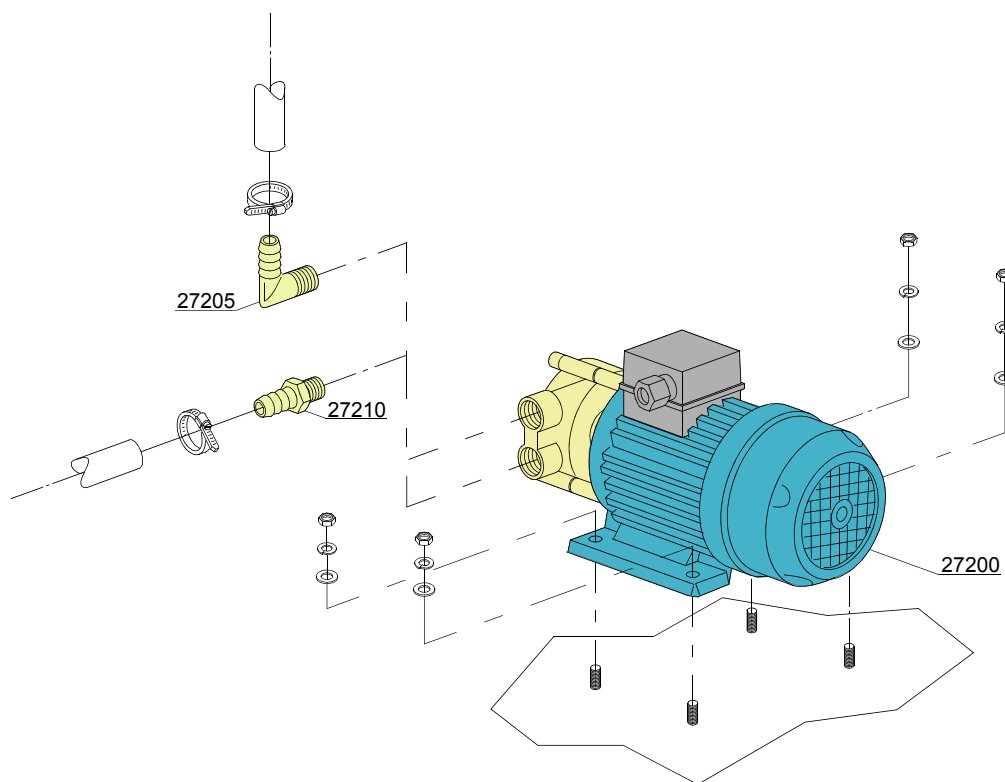
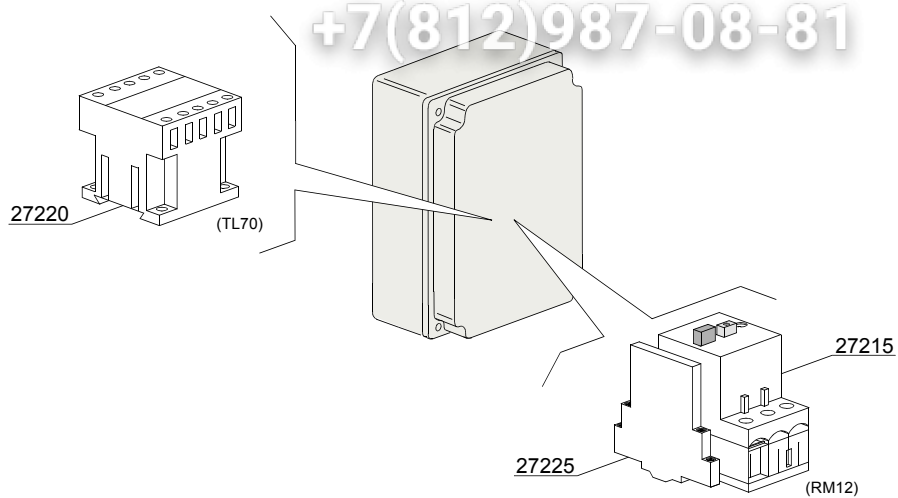

38_001xe

vsezip.ru

| ID | P-code | SN from | SN to | Mod. | Acces. | Volt | Description |
|---|----------|---------|-------|------|--------|------|-------------------------|
| Module: Booster pump [UX-110, BB-1100] | | | | | | | |
| 27200 | 15100 | | - | | bp | | Booster pump |
| 27205 | 12030 | | - | | bp | | Elbow pipe fitting |
| 27210 | 10221311 | | - | | bp | | Pipe fitting |
| 27215 | 2000394 | | - | | bp | | Motorprotector 2,5-4A |
| 27220 | 2000370 | | - | | bp | | Contactora MC9 |
| 27225 | 3006080 | | - | | bp | | Auxiliary contact LMS25 |

e=ELECTRONICAL SWITCHES, uw=LOWER AND UPPER WASHER

85S=85S

dvgw=DVGW VALVE SYSTEM, bp=BOOSTER PUMP

A=3/N/PE~380-400V 50-60Hz, D=3/PE~200-210V 50-60Hz, F=2/PE~220-240V 50-60Hz, G=3/N/PE~415V 50-60Hz, H=3/PE~220-230V 50-60Hz, K=3/PE~380-400V 50-60Hz, L=3/PE~415V 50-60Hz, M=3/PE~440V 60Hz, P=1/N/PE~220-230V 50-60Hz, R=2/PE~220-240V 50-60Hz, U=1/N/PE~240V 50-60Hz, V=3/PE~240V 50-60Hz, W=1/N/PE~100-110V 50-60Hz

vsezip.ru

+7(812)987-08-81

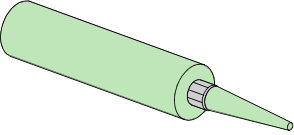
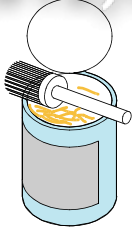
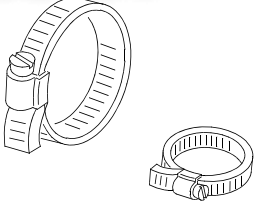
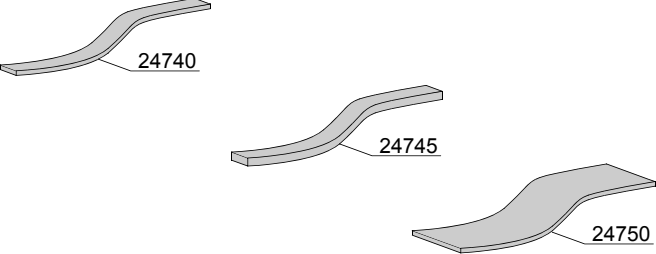
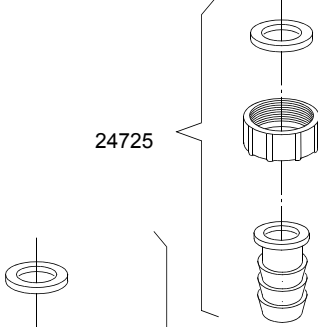
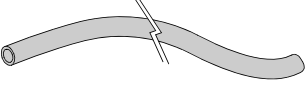
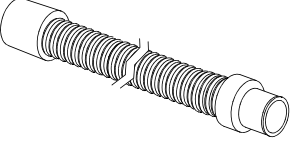
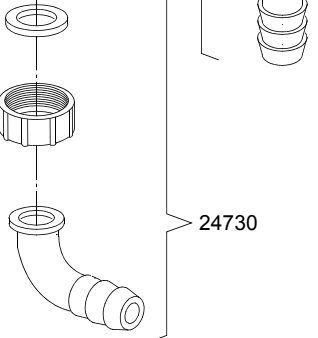
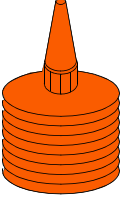
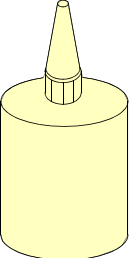
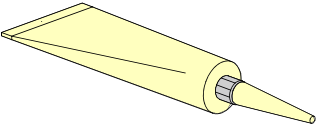
| | | |
|--|--|--|
|  <p>24700</p> |  <p>24705</p> |  <p>24760</p> |
|  <p>24740</p> <p>24745</p> <p>24750</p> | |  <p>24725</p> |
|  <p>24755</p> |  <p>24735</p> |  <p>24730</p> |
|  <p>24765</p> |  <p>24770</p> |  <p>24775</p> |

| ID | P-code | SN from | SN to | Mod | Acces. | Volt | Description |
|--|----------|---------|-------|-----|--------|------|---|
| Module: Accessory [UX-110, BB 1100] | | | | | | | |
| 24700 | --- | | - | | | | Silicone UNI 9610 - UNI 9611 |
| 24705 | --- | | - | | | | Grease for high temperatures CCIAA 629224 |
| 24705 | --- | | - | | | | Grease for food - Loctite 8104 Cat. N° 26560 |
| 24725 | 15613/A | | - | | | | Fitting exauster |
| 24730 | 15613 | | - | | | | 1" 1/4x30 nylon elbow |
| 24735 | 10727 | | - | | | | Exauster pipe Ø 24mm |
| 24735 | 10200112 | | - | | | | Exauster pipe Ø 32mm |
| 24740 | 15750 | | - | | | | 20x2 self-stick mousse |
| 24745 | 15751 | | - | | | | 20x4 self-stick mousse |
| 24750 | 15752 | | - | | | | 60x2 self-stick mousse |
| 24755 | 2907350 | | - | | | | Flexible pipe EPDM Ø12 |
| 24755 | 2907352 | | - | | | | Flexible pipe EPDM Ø12 - WRAS |
| 24755 | 2907353 | | - | | | | Flexible pipe EPDM Ø12 |
| 24760 | 11807 | | - | | | | Steel hose clamp 15/24 |
| 24760 | 11806 | | - | | | | Steel hose clamp 25/40 |
| 24760 | 11810 | | - | | | | Steel hose clamp 40/60 |
| 24760 | 11824 | | - | | | | Steel hose clamp 50/70 |
| 24760 | 2902491 | | - | | | | Steel hose clamp 60/80 |
| 24765 | --- | | - | | | | -50°C +150°C threads dope |
| 24770 | --- | | - | | | | Loctite 542 Cat.N° 54246 - DIN-DVGW 86.02 e 125 |
| 24770 | --- | | - | | | | Loctite 243 Cat.N° 18937 - 19386 |
| 24775 | --- | | - | | | | Loctite 511 Cat.N° 24003 - DIN-DVGW 86.01 e 125 |
| 24775 | --- | | - | | | | Loctite 577 Cat.N° 25392 |

e=ELECTRONICAL SWITCHES, uw=LOWER AND UPPER WASHER

85S=85S

dvgw=DVGW VALVE SYSTEM, bp=BOOSTER PUMP

A=3/N/PE~380-400V 50-60Hz, D=3/PE~200-210V 50-60Hz, F=2/PE~220-240V 50-60Hz, G=3/N/PE~415V 50-60Hz, H=3/PE~220-230V 50-60Hz, K=3/PE~380-400V 50-60Hz, L=3/PE~415V 50-60Hz, M=3/PE~440V 60Hz, P=1/N/PE~220-230V 50-60Hz, R=2/PE~220-240V 50-60Hz, U=1/N/PE~240V 50-60Hz, V=3/PE~240V 50-60Hz, W=1/N/PE~100-110V 50-60Hz