



G9F2ME - G9F2ME+A2

Зип Общепит

vsezip.ru

+7(812)987-08-81

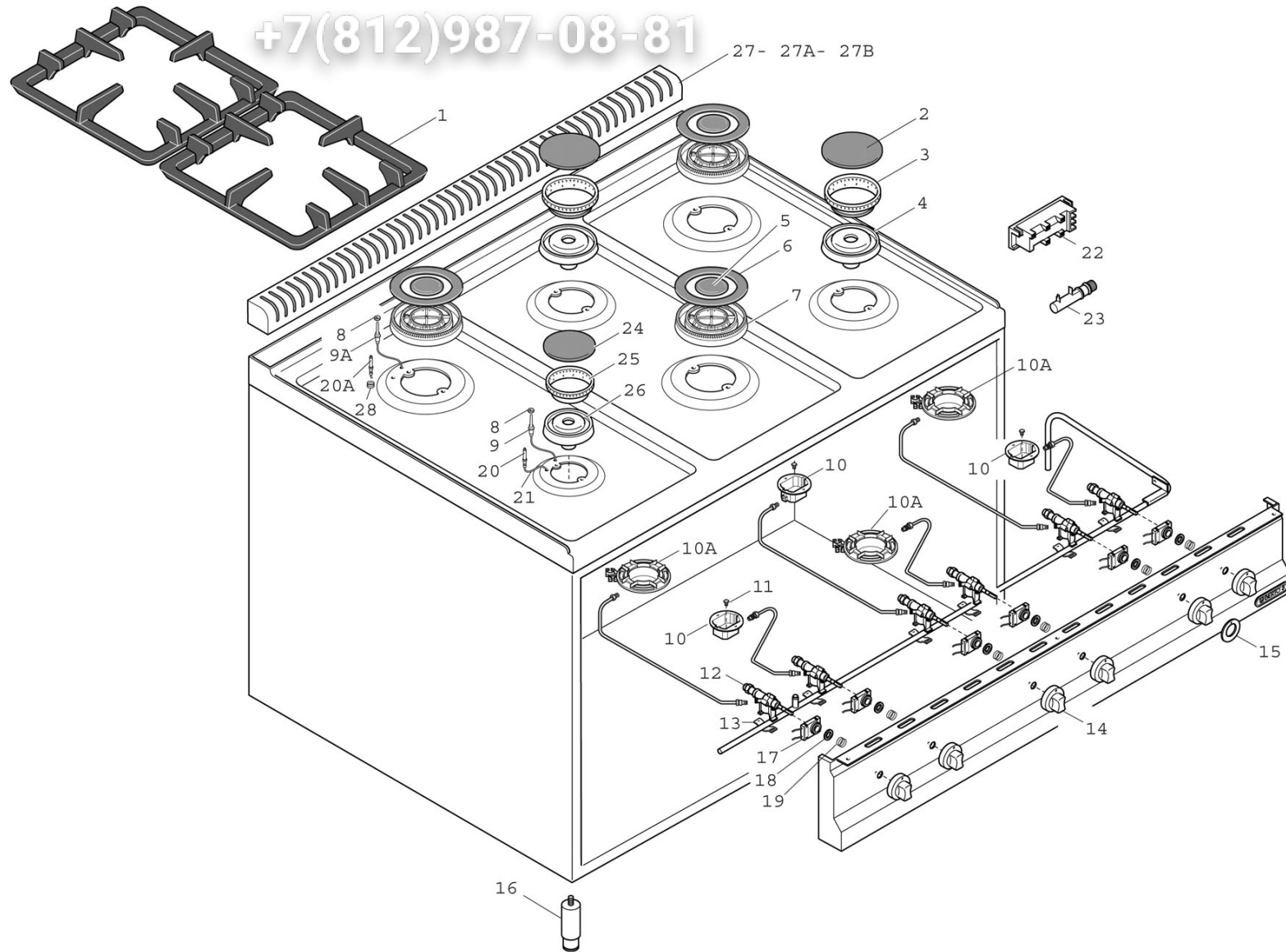



G9F2ME - G9F2ME+A2

Зип Общепит

vsezip.ru

+7(812)987-08-81

Pos. Item	Codice Code	Descrizione	Item Description	Designation articles	Artikelbeschreibung	Decripción artículos	N° pezzi - No. pieces				
1	35856700	Griglia rough nero 1 fuoc0 e	Rough grill 1 burner	Grille rough 1 bruleur	Rost rough	Parrilla rough 1 quemador					2
2	31281300	Coperc.bruc.ev.ult.rapid.	Burner cover	Couvercle bruleur	Deckel brenner	Tapa quemador					-
3	31280600	Anello spar.bruc.ev.ultra rap.	Burner flame divider ring	Couronne bruleur	Flamm. brenner	Aro repart. quemador					-
4	31280500	Supp.bruc.evoluz. ultra rapido	Burner support	Support bruleur	Brennerhalter	Soporte quemador					-
5	35281300	Coperchio centr. bruc. tc	Inner burner cover	Couvercle bruleur interieur	Deckel brenner innere	Tapa interna quemador					1
6	35281400	Coperchio est bruc. 3,8 kw	3,8 kw burner cover	Couvercle bruleur 3,8 kw	Deckel brenner 3,8 kw	Tapa quemador 3,8 kw					1
7	35280500	Supporto bruc. 3,8 kw	3,8 kw burner support	Support bruleur 3,8 kw	Brennerhalter 3,8 kw	Soporte quemador 3,8 kw					1
8	31807600	Dado x termocoppia e 0814	Nut for thermocouple	Ecrou pour thermocouple	Mutter fur thermoelement	Tuerca para termpoar					2
9	31289200	Termocoppia 750 mm cucina e	Thermocouple 750mm	Thermocouple 750mm	Thermoelemnt 750mm	Termopar 750mm					1
9A	35289200	Termocoppia 750mm bruciat. tc	Thermocouple 750mm (tc)	Thermocouple 750mm (tc)	Thermoelemnt 750mm (tc)	Termopar 750mm (tc)					1
10	31280100	Coppaxiniettore bruc.evoluz.	Housing for injecteur	Bloc pour injecteur	Becher fur einspritzduse	Copa para injector					1
10A	35280100	Coppa per bruciatore tc	Housing for injector	Bloc pour injecteur	Becher fur duse	Copa para injector					1
11	40000000	Ugello: indicare modello e tip	Injector: specify model and ga	Gliceur: specifier modele et g	Duese: modell und gas-typ zeig	Tobera: precisar modelo y tipo					1
12	31275000	Rubinetto x nuova microcat. by	Tap by-pass 52	Robinet by-pass 52	Hahn by-pass 52	Llave de paso by-pass 52					2
13	22966200	Briglia fissaggio rubinetto	Fixing tap clamp	Bride de fixation robinet	Bugel fur hahnbefestigung	Fiador ajuste llave de paso					2
14	35877000	Manopola rossa p.8x6,5 a 0° ra	Red knob p.8x6,5 0° ral3000	Manette rouge p.8x6,5 a 0° ral	Drehknopf p.8x6,5 a 0° ral3000	Mando rojo p.8x6,5 a 0° ral300					2
14	35875800	Manopola rossa p. 8x6,5 a 0°	Red knob 8x6,5 0°	Manette rouge 8x6,5 0°	Drehknopf 8x6,5 0°	Mando rojo 8x6,5 0°					2
15	31952000	Serig.rossa manop.gas evoluz.	Red gas knob serigraphy	Serigraphie manette rouge	Drehknopfserigraphie	Serigrafia mando rojo					2
16	24684500	Piedino inox 2 h-125/175	Foot 2 h-125/175	Pied 2 h-125/175	Stellfuss 2 h-125/175	Pata 2 h-125/175					4
17	31877800	Microcaten. 6f cuc. e	Catenary microswitch 6ring coo	Micro-interrupteur 6f cuisiniE	Mikroschalter 6f kochmulden	Micro catenaria 6f cocinas					-
17	31877600	Microcaten. 4f cuc. e nuova	Catenary microswitch 6ring coo	Micro-interrupteur 6f cuisinie	Mikroschalter 4f kochmulden -	Micro catenaria 4f cocinas - n					-
17	31877300	Microcaten. 2f cuc. e	Catenary microswitch 2ring coo	Micro-interrupteur 2f cuisinie	Mikroschalter 2f kochmulden	Micro catenaria 2f cocinas					1
18A	35856300	Ass. griglia camino 1200 aisi	Chimney grill 1200 aisi 304 12	Grille hotte 1200 aisi 304 12/	Grill kamin 1200 aisi 304 12/1	Parrilla chimenea 1200 aisi 30					-
18B	35856100	Ass. griglia camino 800 aisi 3	Chimney grill 800 aisi 304 12/	Grille hotte 800 aisi 304 12/1	Grill kamin 800 aisi 304 12/10	Parrilla chimenea 800 aisi 304					-
18	35857300	Ass. griglia camino 400 aisi 3	400 chimney grill	Grille hotte 400	Grill kamin 400	Parrilla chimenea 400					1
19	35879800	Molla fiss. cand. bruciat. tc	Spring for spark plug	Ressort pour bougie	Feder fur zundkerze	Muelle para bujia					1
20A	35187800	Candeletta accen. bruciat. tc	Ignition plug (tc)	Bougie d'allumage (tc)	Zundkerze (tc)	Bujia encendido (tc)					1
20	31187800	Candel.acc.cuc.el=600 molla	Ignition plug electr. cookers	Bougie d'allumage fourneaux el	Zundkerze el=60	Bujia de encendido cocinas ele					1
21	31189700	Cavetto accensione cucine ev.	Ignition wire for nevol. cooke	Cable allumage pour cuisines e	Zundkabel evoluzione herde	Cable encendido por cocinas ev					2
22	31915000	Portapila x accens. cucine e	Battery holder	Porte-pile	Batterienhalter	Portapila					1
23	31002400	Acc. elet. cand. cucine 6f e	Electric lighter 6f e	Allumeur electric 6f e	Elektro zund. 6f e	Encendido electr. 6f e					-
23	31002000	Acc. elet. cand. cucine 2f e	Electric lighter 2f e	Allumeur electric 2f e	Elektro zund. 2f e	Encendido electr. 2f e					1
23	31002200	Acc. elet. cand. cucine 4f e	Electric lighter 4f e	Allumeur electric 4f e	Elektro zund. 4f e	Encendido electr. 4f e					-
24	31281000	Coperchio bruc.ev.rapido	Burner cover	Couvercle bruleur	Deckel brenner	Tapa quemador					1
25	31280300	Anello spar.bruc.evoluz.rapido	Burner flame divider ring	Couronne bruleur	Flamm.brenner	Aro repart. quemador					1
26	31280200	Supp. bruciat. evoluz. rapido	Burner support evol.	Support bruleur evol.	Brennerhalter evol.	Soporte quemador evol.					1